

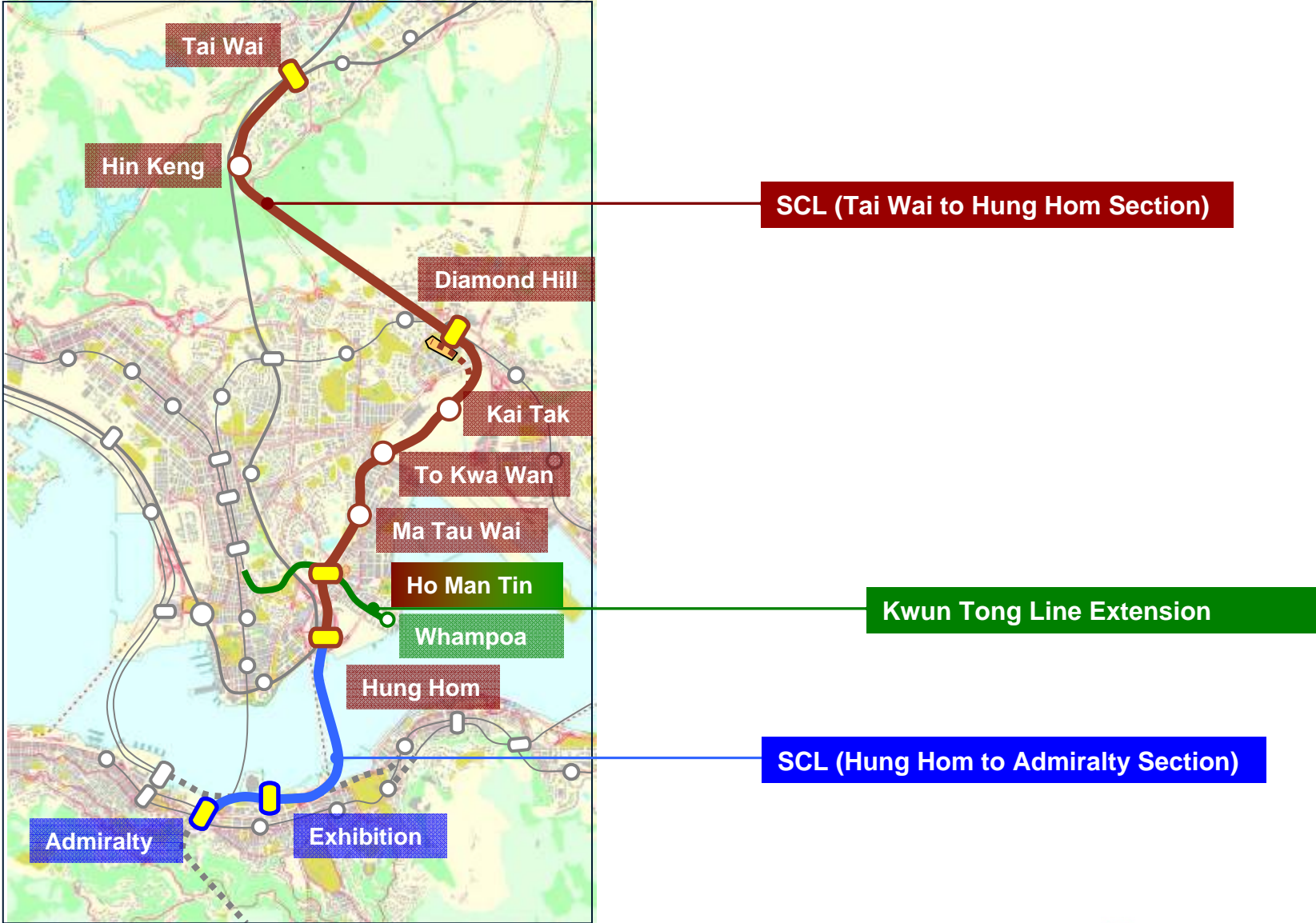

Briefing on the Development of Shatin to Central Link (SCL)

25 October 2010

SCL Alignment





North South Corridor

- Extension of East Rail Line across the harbour to Admiralty
- Provide direct cross-boundary train service to Hong Kong Island



East West Corridor

- Extension of Ma On Shan Line
- Through running to Wu Kai Sha by connecting to West Rail Line
- Serve Hin Keng, Kai Tak, Kowloon City, Ma Tau Wai, To Kwa Wan & Ho Man Tin areas

SCL Temporary Reclamation



 Temporary reclamation

SCL Permanent Facilities – Kai Tak



SCL

Permanent Facilities – Hung Hom



Hung Hom Station ventilation shafts



North Ventilation Building

SCL Permanent Facilities – Wan Chai North

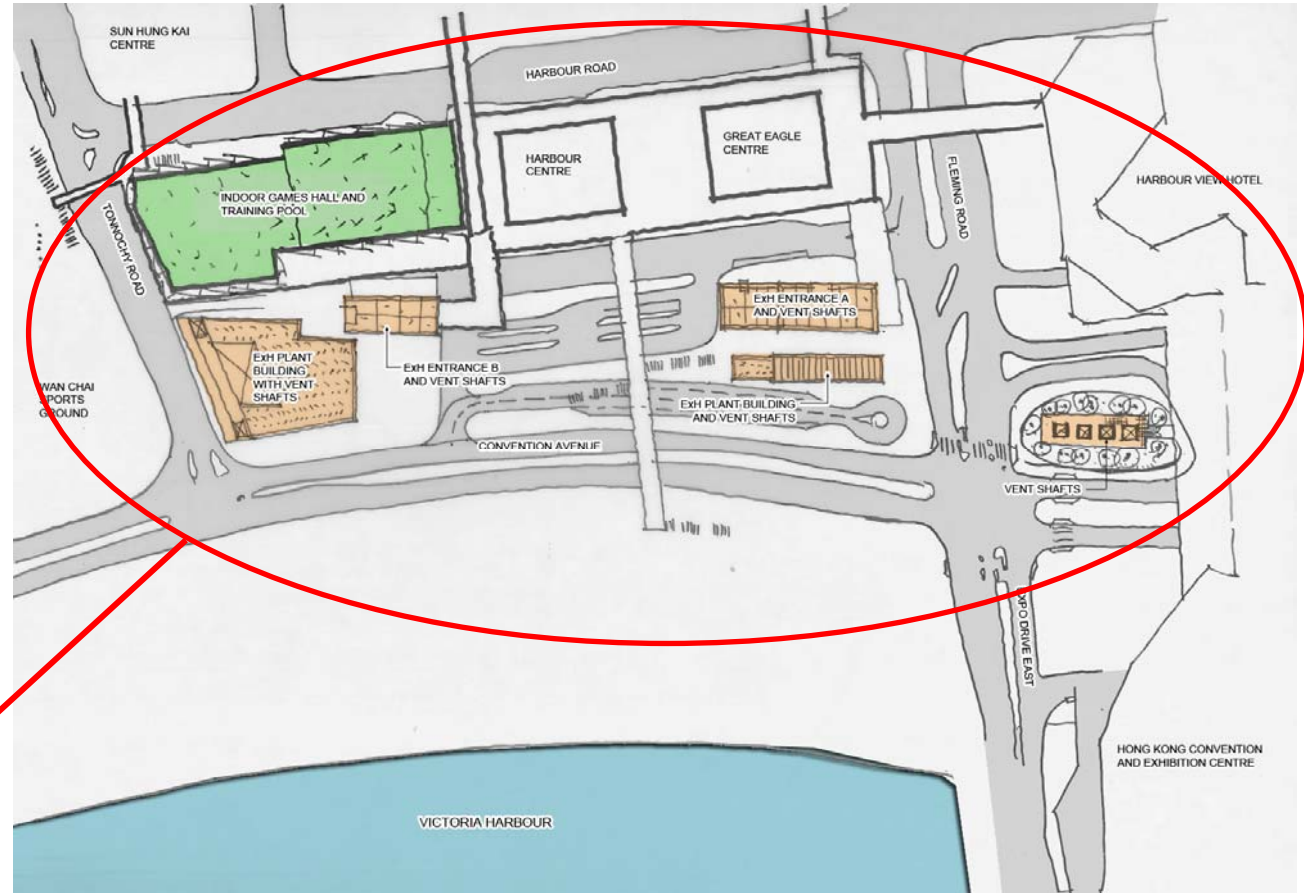

SCL

Permanent Facilities – Wan Chai North

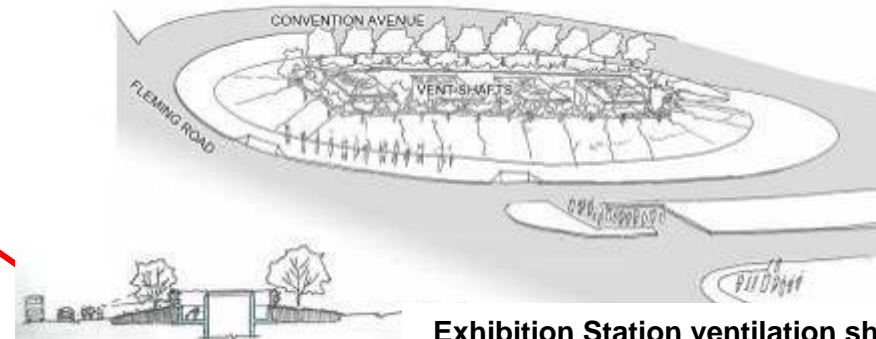
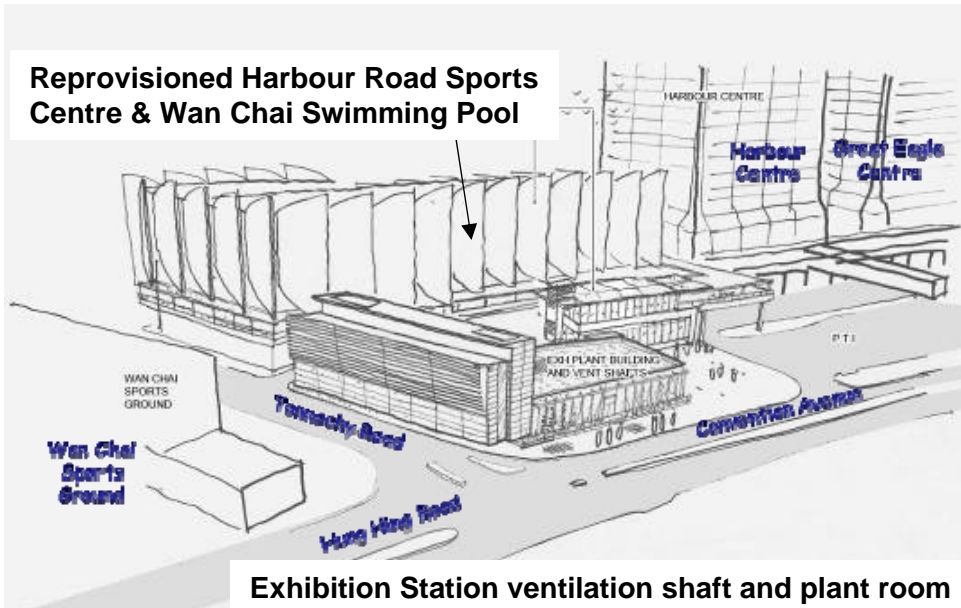

SCL

Permanent Facilities – Wan Chai North

Police Officers' Club cum South Ventilation Building



SCL

Temporary Facilities – Kai Tak

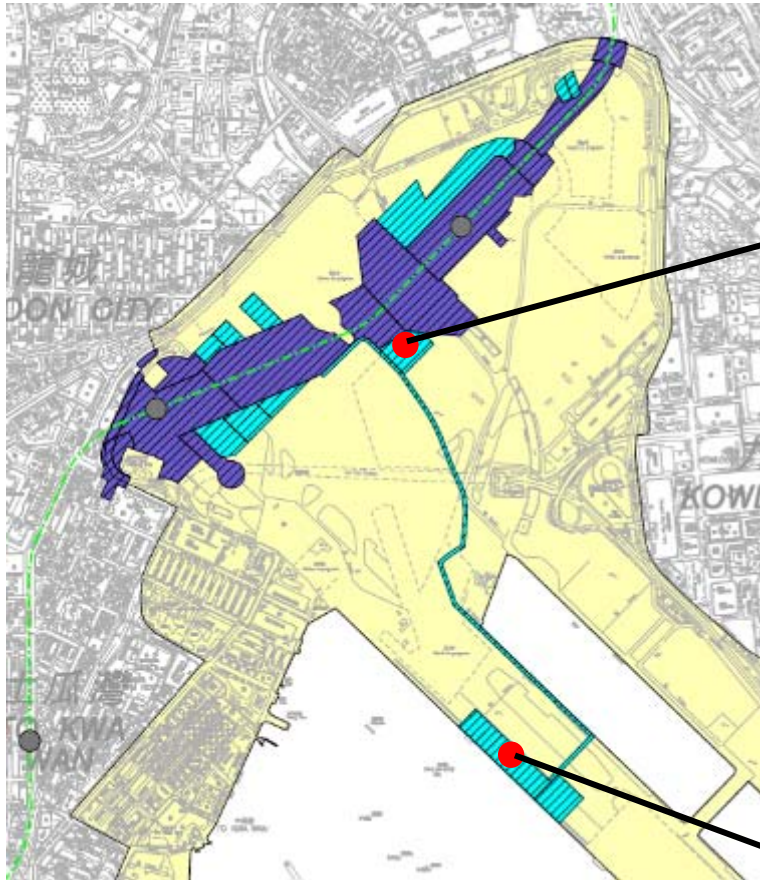

Works Area



Works Site



Concrete Batching Plant



Barging Point

SCL and KTE Temporary Facilities – Hung Hom

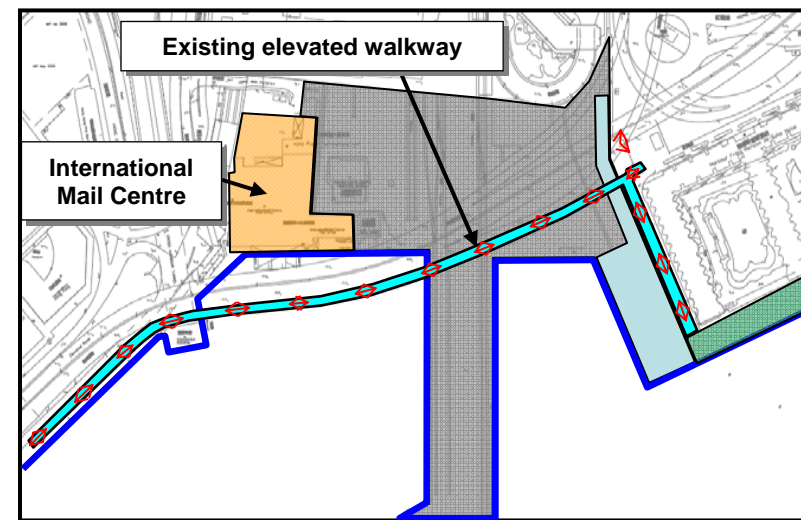
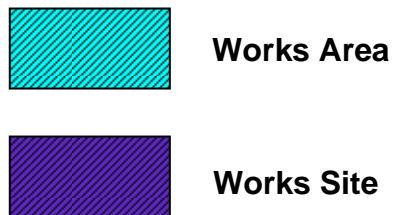
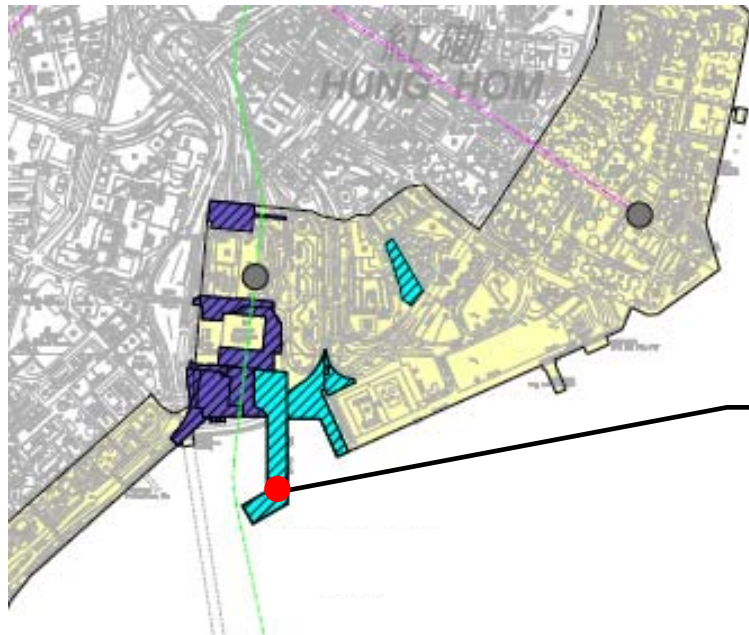

SCL

Temporary Facilities – Wan Chai North

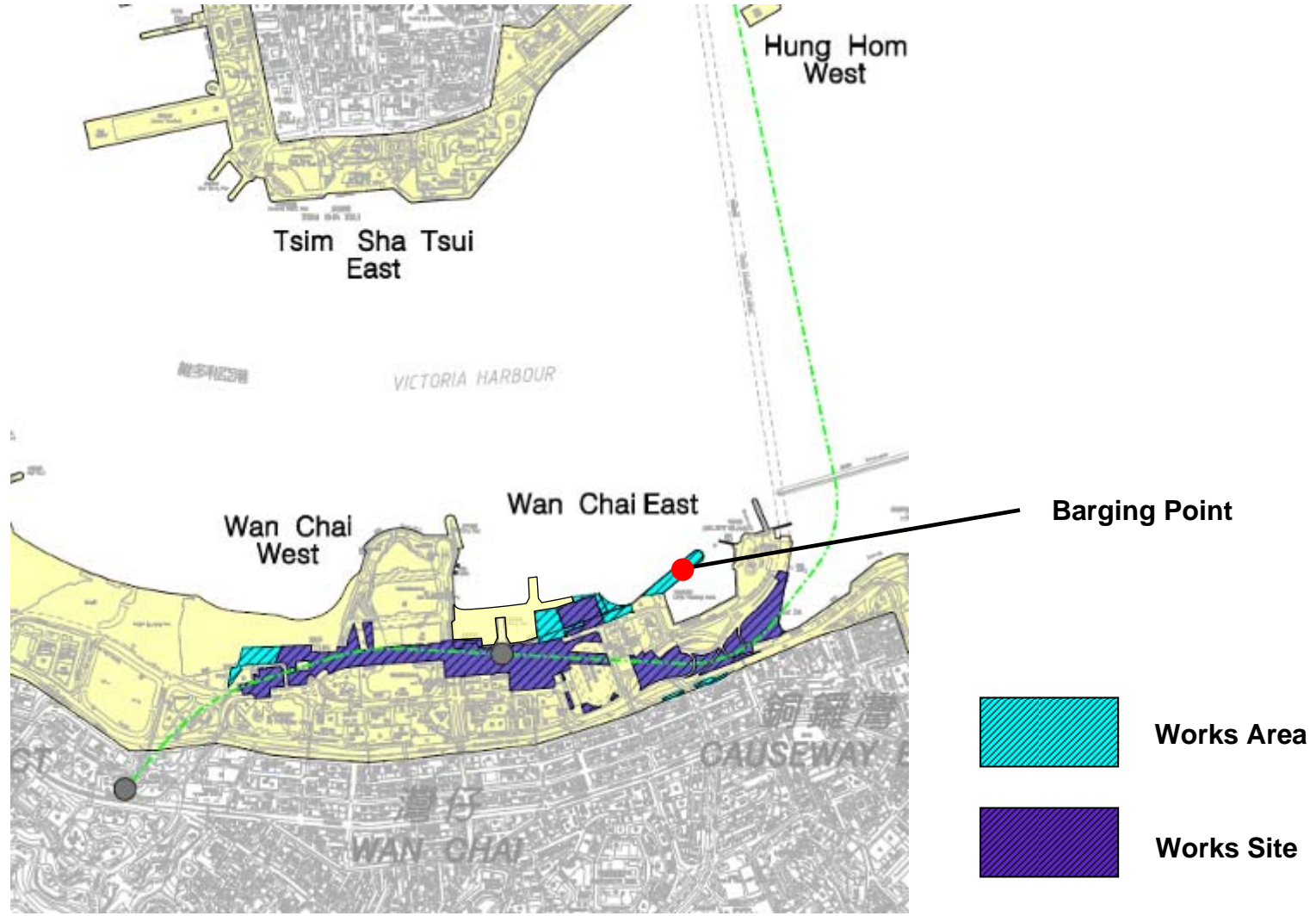

SCL and the Harbourfront Area

- LEGEND :
- HARBOUR LIMIT
 - HARBOURFRONT AREAS
 - PROPOSED SCL ALIGNMENT
 - PROPOSED STATION
 - WORKS SITE /WORKS AREA TO BE OCCUPIED BY MTR

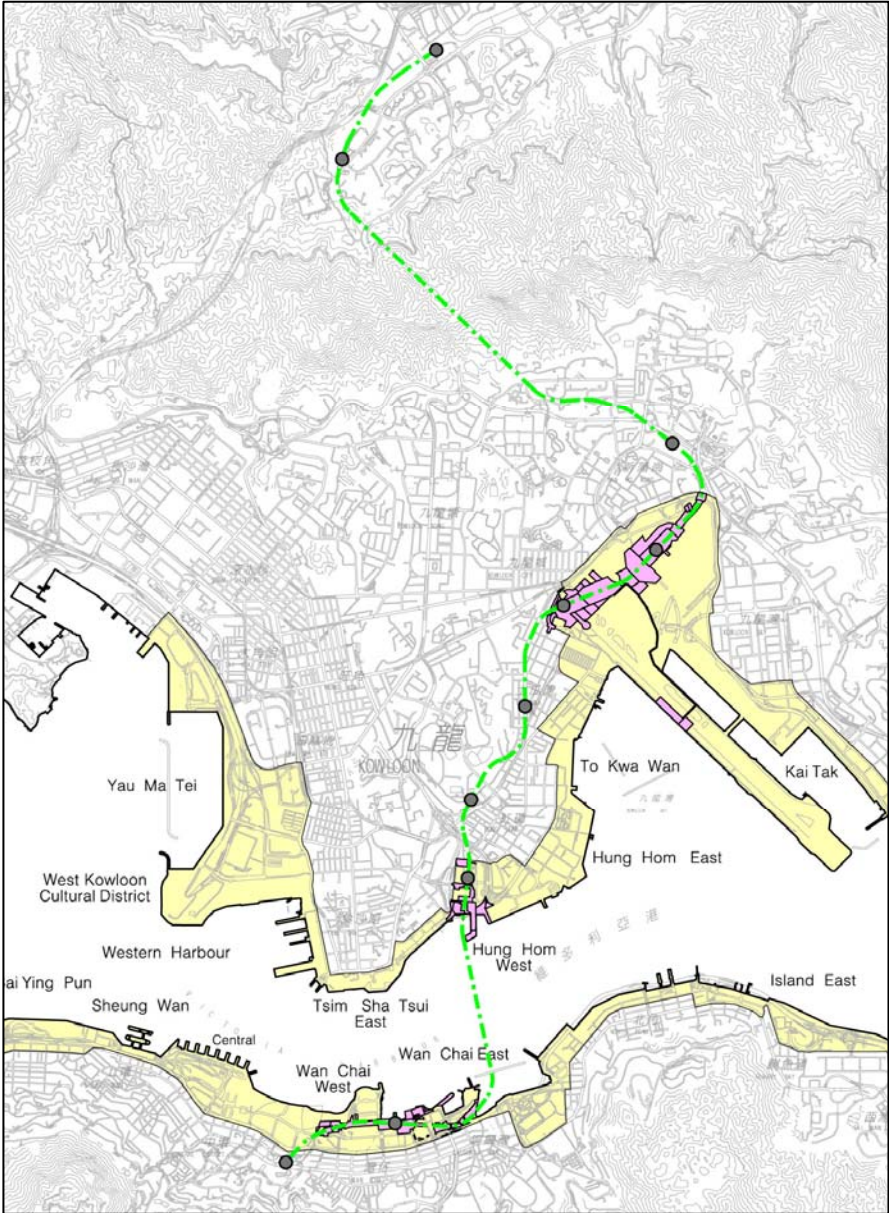



Thank you

Overview of Railway Works near the Harbourfront Areas

