

HAD 6th Minor Works Term Consultancy for Hong Kong East Region Consultancy Agreement No. 9AJ120

YTM-DMW366_ Provision of Avenue of Sports Stars at East Tsim Sha Tsui Waterfront

Design proposal

WCWP

Architecture
建筑

Interior Design
室内设计

Planning
规划

Avenue of Stars



Corridor connecting Tsim Sha Tsui to Hung Hom

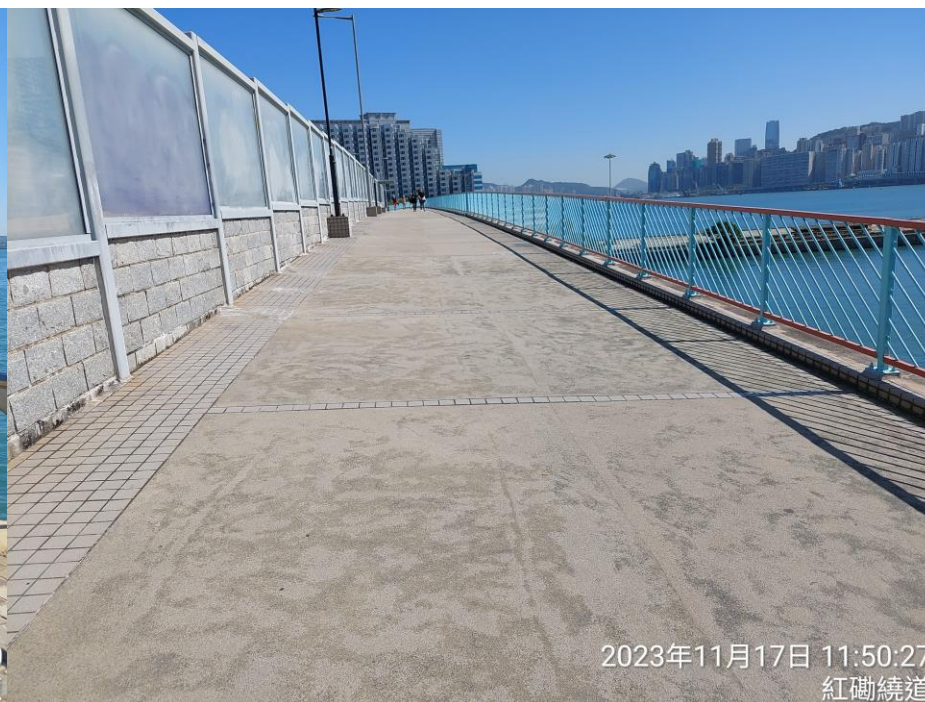
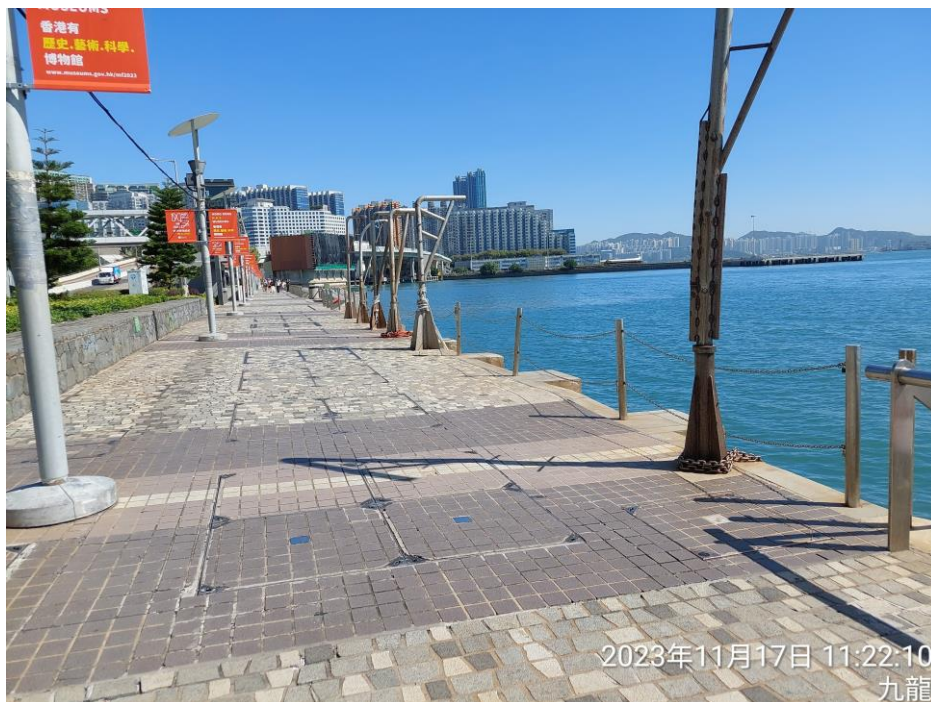

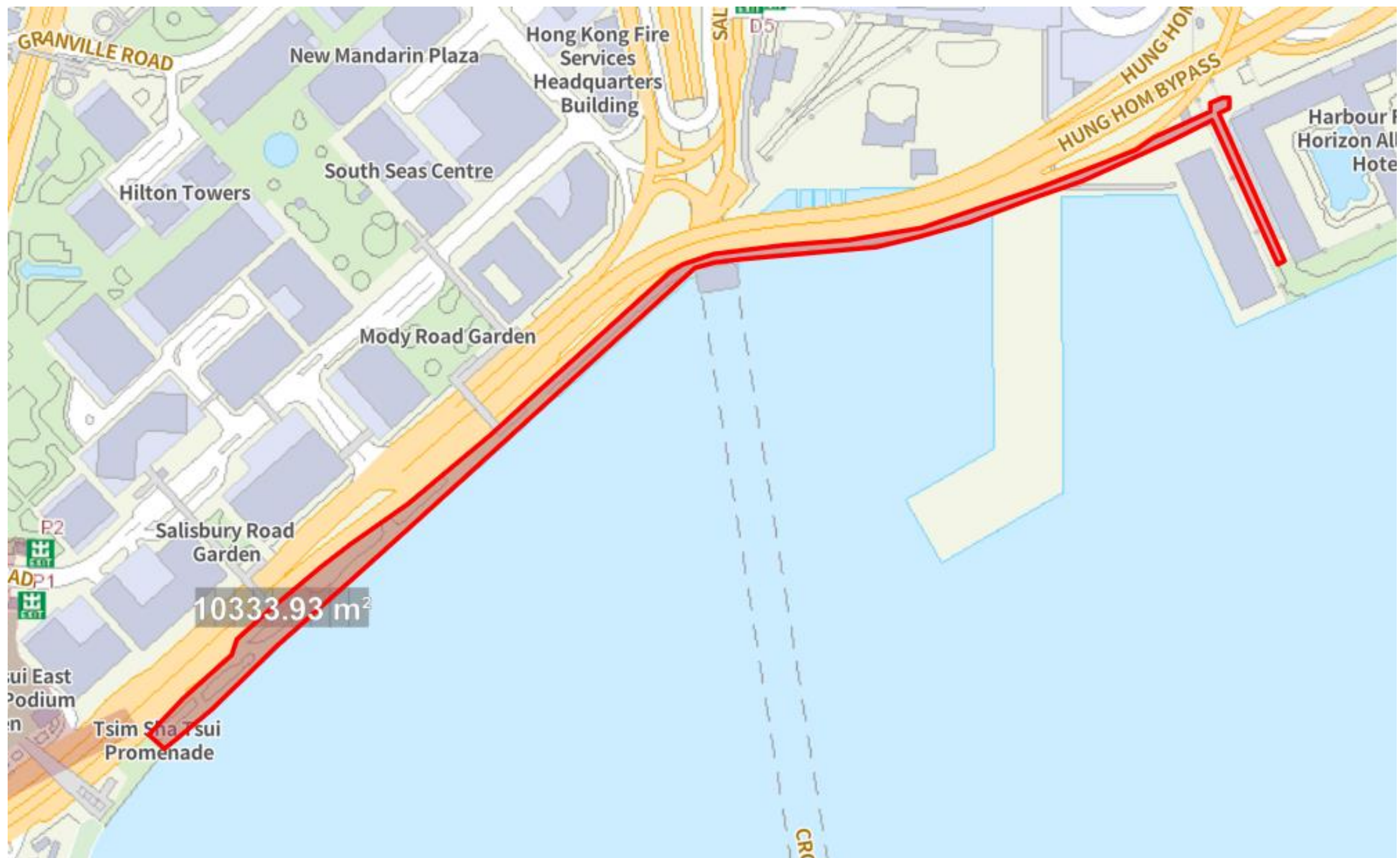

Site Location

Total Site area: 10333.93m²

Planter Area : 2097.87m²

Total Site Area (Extruding Planters) : 8236.06m²

Hong Kong Cityscape

North Point

Wan Chai

Central

Yau Tsim Mong

Skyline



Landmarks



AIA Tower



Hysan Place



HKECC



Bank of China



IFC



Shun Tak Centre

Main Scope of Works

PROVISION OF AVENUE OF SPORTS STARS AT EAST TSIM SHA TSUI WATERFRONT

Phase 1

1. Beautifying noise barriers
2. Installation of drinking fountains
3. Beautifying rain shelters and benches

Phase 2

1. Upgrading the floor finish
2. Placing planters along the footbridge
3. Installation of AED equipment

Zoning diagram

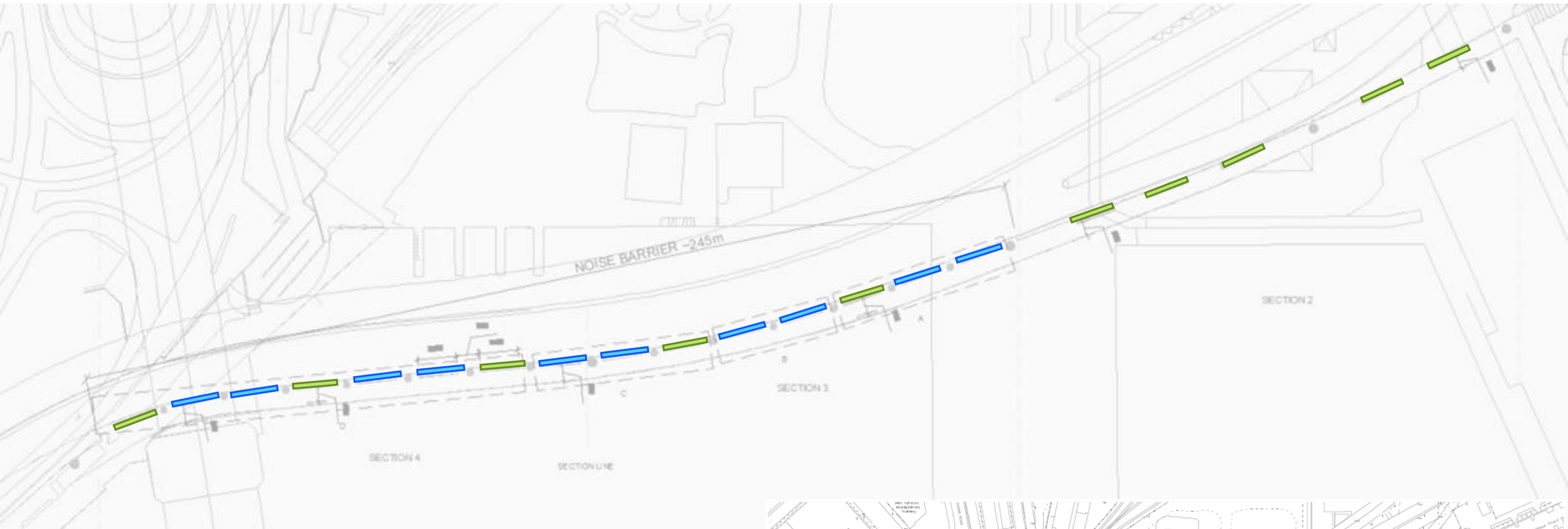

numbers

10



Urbanscape furniture

10



Green feature

2



AED equipment

2



Drinking Fountains

Photo 1



Photo 2

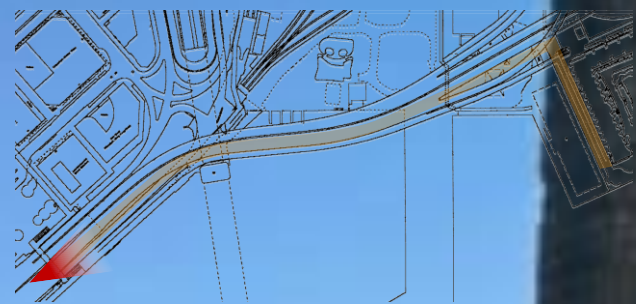

Photo 3



Photo 4





Key plan

Artist impression for preliminary design, the design is subject to further design development and further coordination with other parties. The graphic of the noise barrier and balustrade are subject to further coordination with Government Departments and relevant parties

View Promenade

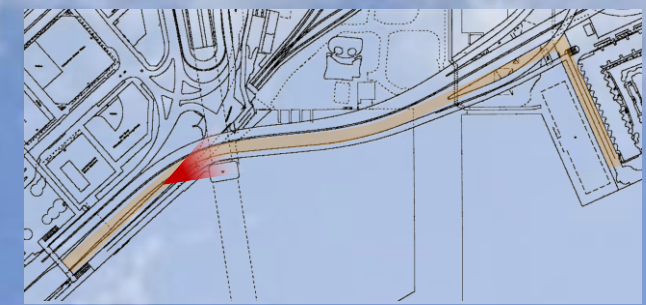

Key plan



Artist impression for preliminary design, the design is subject to further design development and further coordination with other parties. The graphic of the noise barrier and balustrade are subject to further coordination with Government Departments and relevant parties



Ramp



Key plan



Artist impression for preliminary design, the design is subject to further design development and further coordination with other parties. The graphic of the noise barrier and balustrade are subject to further coordination with Government Departments and relevant parties

Starting point



1000M

START

Artist impression for preliminary design, the design is subject to further design development and further coordination with other parties.
The graphic of the noise barrier and balustrade are subject to further coordination with Government Departments and relevant parties

Return Point option 1

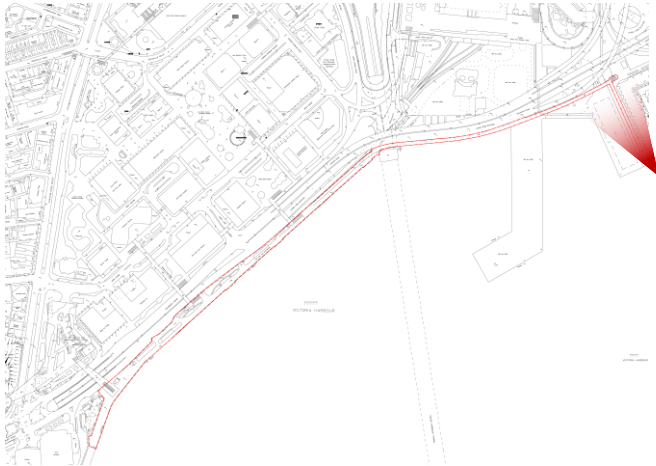
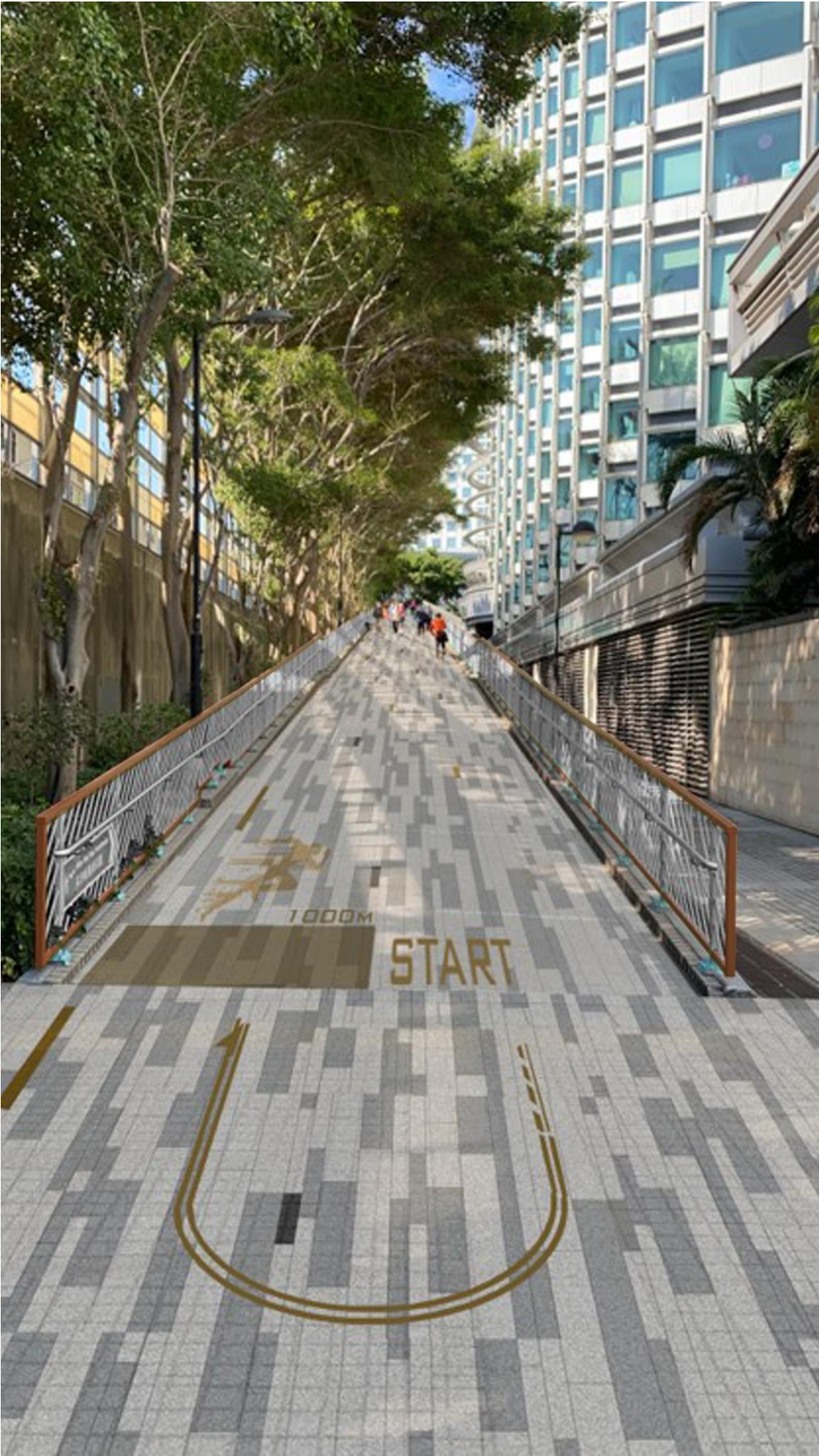

Return Point option 2

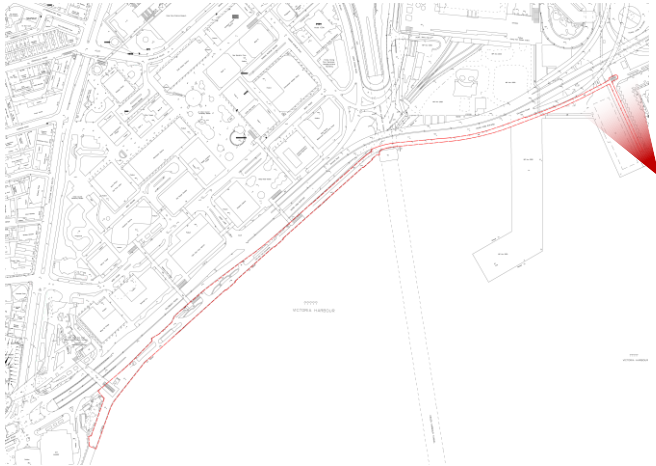

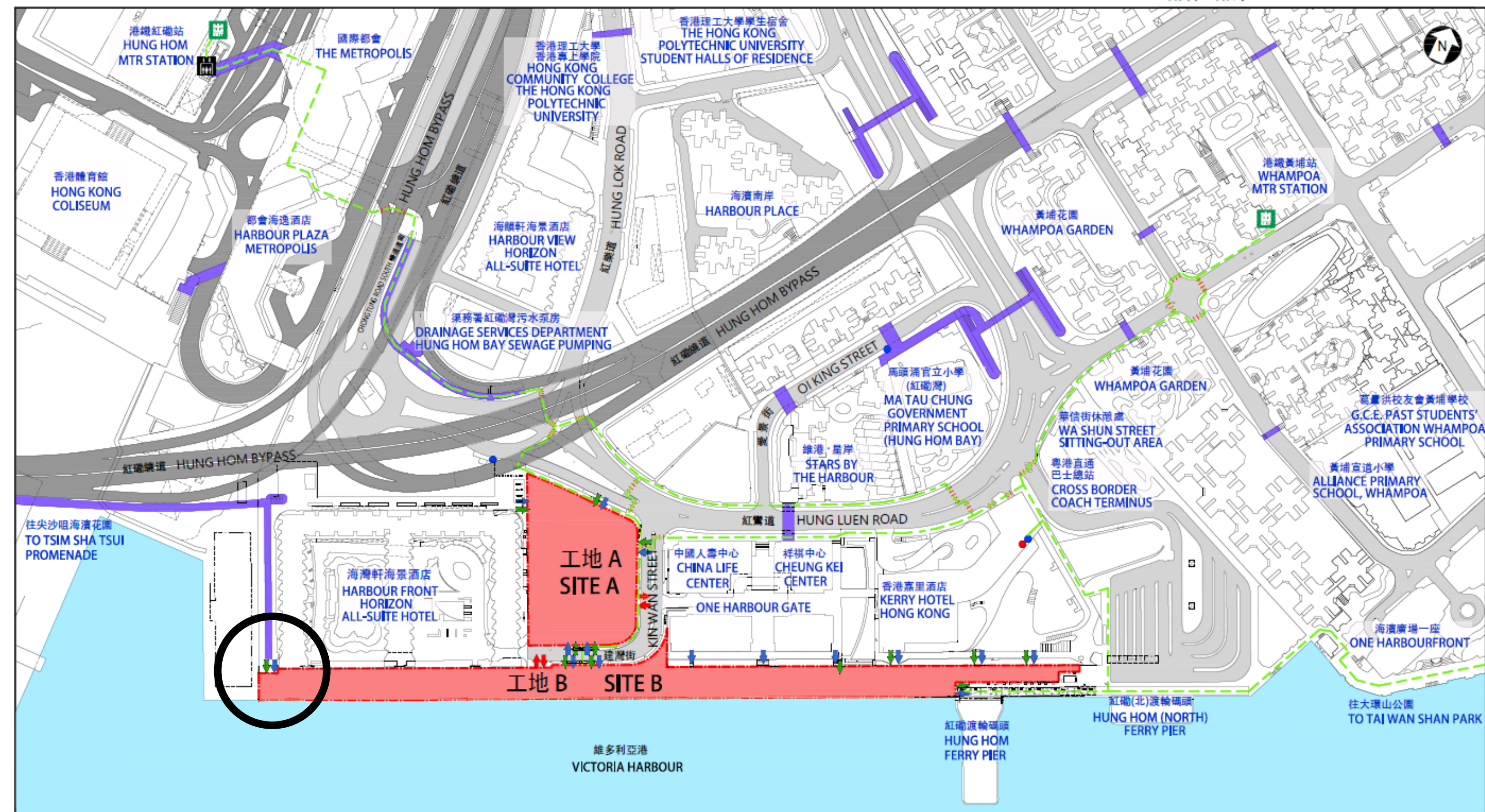

圖例 LEGEND

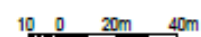

無障礙通道平面圖
PLAN OF BARRIER-FREE ACCESS

449RO
紅磡海濱休憩用地
OPEN SPACE AT HUNG HOM WATERFRONT



ARCHITECTURAL
SERVICES
DEPARTMENT 建築署



從東面望向休憩用地的構思透視圖
PERSPECTIVE VIEW FROM EASTERN DIRECTION (ARTIST'S IMPRESSION)

構思圖 一
ARTIST'S IMPRESSION 1

449RO
紅磡海濱休憩用地
OPEN SPACE AT HUNG HOM WATERFRONT



ARCHITECTURAL
SERVICES
DEPARTMENT 建築署



從西面望向觀景台及籃球場的構思透視圖
PERSPECTIVE VIEW OF THE VIEWING DECK AND BASKETBALL COURT FROM WESTERN DIRECTION



觀景點一的構思透視圖
PERSPECTIVE VIEW OF LOOKOUT POINT 1



觀景點二的構思透視圖
PERSPECTIVE VIEW OF LOOKOUT POINT 2

Tentative programme

	Works	Tentative Programme
Phase 1	Upgrading works for noise barrier, railings, new drinking water fountains and related works	Construction in Q2/2024 to Q1/2025
Phase 2	Upgrading works for floor finishes, shelters, seatings, landscaping, signages and related works.	Construction in Q4/2026 to Q4/2027

Thank you