

PROMENADE AND PUBLIC OPEN SPACE

*For Comprehensive Residential Development
At NKIL No. 6549, Cheung Sha Wan*

1. Statutory Submission & Approval
2. Design Development
3. Coherent Design with NKIL6550

1. Statutory Submission & Approval

2. Design Development

3. Coherent Design with NKIL6550

1. Statutory Submission & Approval

Submission and Approval Record	
Date	Description
03/2018	Submission of S16 Application for the Site including POS and PWP.
05/2018	Presentation of POS and PWP to Harbour Front Commission and approved.
11/2018	Landscape Proposal submitted and formal meetings with LCSD for detail design of POS and PWP was initiated.
11/2018	Approval of S 16 Application for the Site including POS and PWP
01/2019	Meeting with SHKP for design of PWP
03/2019	Joint presentation meeting with SHKP to updated PlanD on design of POS and PWP.
04/2019	Submission of revised LMP to PlanD.
05/2019	Approval of revised LMP by PlanD and deemed approval by LandsD for LMP.
06/2019	Revised Landscape Proposal to LCSD submitted.
11/2019	Detailed Design Submission of POS and PWP to LCSD.
01/2020	Coordination meeting with LCSD, DSD and PlanD regarding possibility of tree planting upon DR. It was agreed that tree planting was not accepted.
05/2020	Construction works for POS and PWP commenced.
05/2020	Revised LMP submitted to PlanD
06/2020	2 nd Detailed Design Submission and formal meeting with LCSD and relevant government departments regarding POS and PWP.
08/2020	LCSD confirmed no further comment for 2 nd Detailed Design Submission.
09/2020	Meeting with SHKP to update each other on PWP design
09/2020	Revised LMP approved by PlanD
10/2020	Revised LMP deem approved by LandsD
03/2021	3 rd Detailed Designed Submission and formal meeting with LCSD and relevant government departments regarding POS and PWP.
11/2021	Meeting with SHKP to update each other on PWP design
12/2021	Consolidated Detailed Design Submission submitted to LCSD and acknowledge no further comment on the proposal by LCSD
12/2021	Submission to PlanD for discharged of planning conditions for design of POS and PWP
06/2022	Construction works practically completed and arrange pre-handover inspection with LCSD for POS and PWP.

1. Statutory Submission & Approval

2. Design Development

3. Coherent Design with NKIL6550

L a n d s c a p e D e s i g n C o n c e p t

Landscape Design Concept

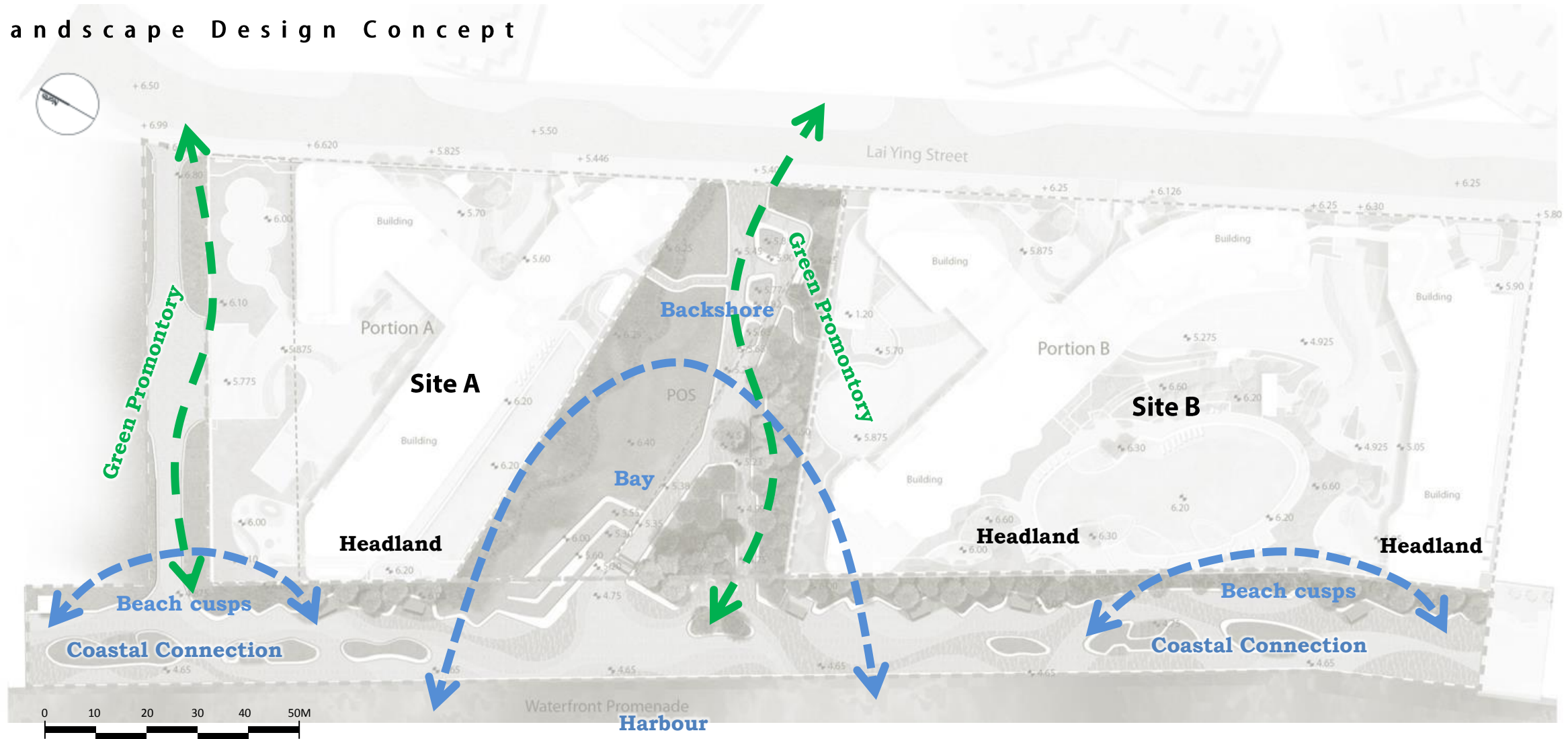

Conceptual landscape structure based on natural coastal forms which help establish a spatial rhythm along the waterfront

Landscape concept is an abstract celebration of the coast, with its organic natural forms and rich cultural tapestry

2. Design Development

Key Planning Parameters under S16

POS

- Not less than 3,600m²
- No buildings / structures
- A coherent theme with the POS at R(A)12 site to its northeast & the promenade
- Min. 50% green coverage

PWP

- 20m wide promenade
- Seamless integration with the adjoining "O" zone & the overall POS network
- Refreshment kiosk (not more than 10m²)
- Min. 30% green coverage

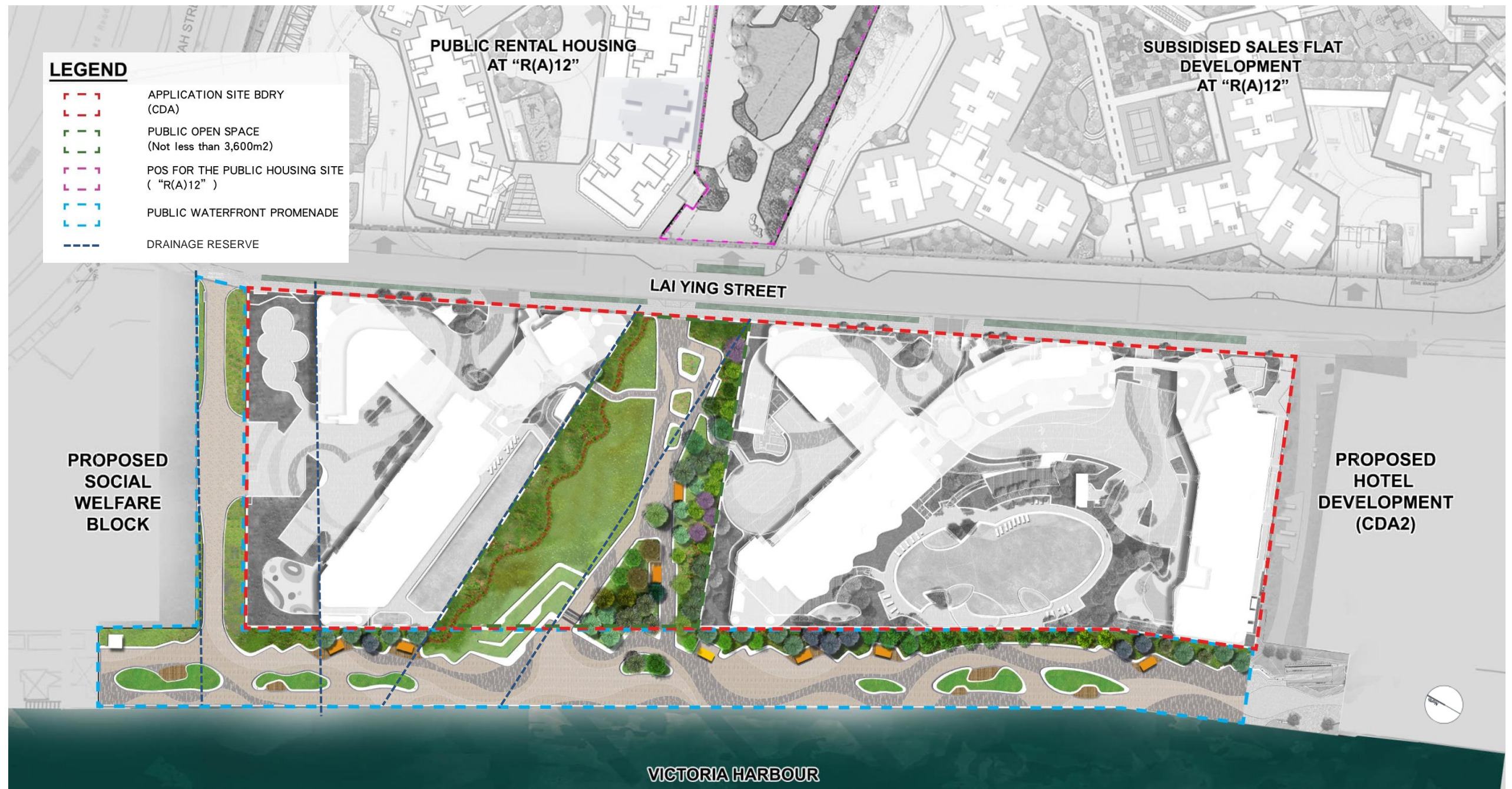

2. Design Development

Circulation and Landscape Buffer



Pedestrian access



4-8m wide landscape buffer planting



Min 4.5m wide potential vehicular access for management (shared pedestrian surface)



Min 3m wide pedestrian promenade

2. Design Development

Latest Landscape Plan



LEGEND

Application Site Boundary (CDA)

Public Open Space
(not less than 3,600 m²)

Waterfront Promenade

+xx.xx

Existing Levels

⊕xx.xx

Proposed Levels

Proposed Tree Planting

Proposed Shrub Planting

Proposed Lawn

Proposed Paving

Proposed Kiosk

Proposed Shelter

Proposed Store Room

Drainage Reserve

Key Landscape Provisions

1. Kiosk

2. Store Room

4. Seating with Shelter

5. Drinking Fountain

6. External Power Supply

7. Litter Bins

8. Hand Wash Basin

9. Greening Ratio

10. Trees

11. Lawn
- 1 no.

• 1 no.

• 2 nos. at Public Open Space (POS) & 5 nos. at Public Waterfront Promenade (PWP)

• 1 no.

• 1 no. (near the event space)

• Single litter bin (4 nos.) & Recycle bin (1 no.) & Pet waste bin (3 nos.)

• 1 no.

• Not less than 50% at POS / Not less than 30% at PWP

• 69 nos.

• Approx. 1,985m²

Quantity/Area

2. Design Development



Thematic Landscape Spaces in Curvilinear and Fluid Form



2. Design Development

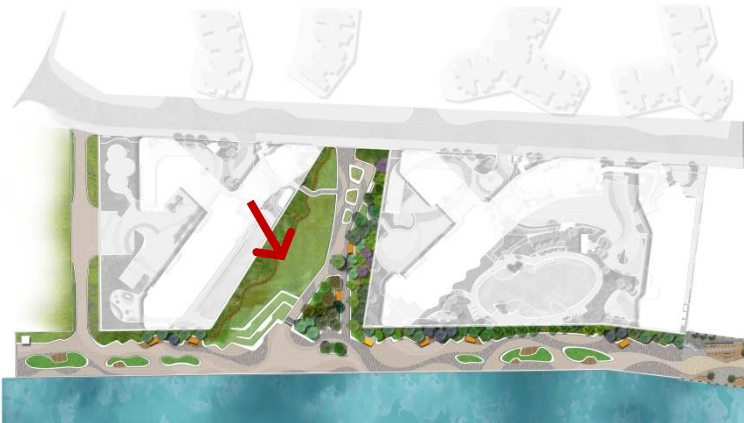

Integrated Landscape Context between PWP and POS



2. Design Development



Naturalistic Park with Visual Penetration to Harbour



2. Design Development



Sheltered Seating at PWP for Public Enjoyment



1. Statutory Submission & Approval
2. Design Development
- 3. Coherent Design with NKIL6550**

Coherent Design Principles

The design coherency is intended to be realised in a coordinated but not identical manner to uplift the overall waterfront experience. The PWP would carry a consistent and compatible ambience by means of wavy paving pattern with similar colour tone and co-ordinated planters and terrace design at the interface between NKIL No. 6549 and NKIL No. 6550.

- a. Overall design concept of natural and organic forms following the form of coastal waves
- b. Interface area
- c. Paving color tone
- d. Railing design
- e. Lighting ambience

3. Coherent Design with NKIL6550

a. Overall design concept of natural and organic forms following the form of coastal waves



3. Coherent Design with NKIL6550

c. Paving color tone



QUARZITI GLACIER QR 01
OR APPROVED EQUIVALENT



QUARZITI MOUNTAINS QR 02
OR APPROVED EQUIVALENT



QUARZITI WATERFALL QR 03
OR APPROVED EQUIVALENT

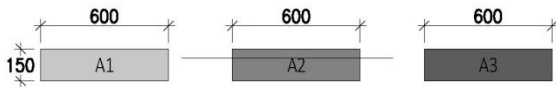

PLAN-TILE
SCALE 1:30

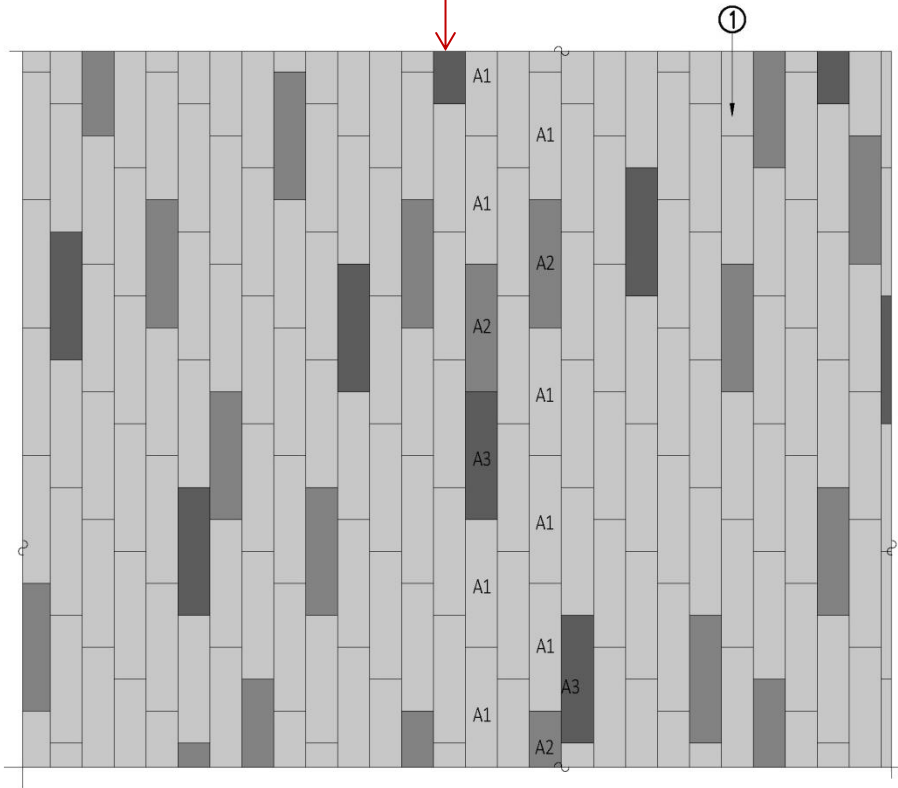

3. Coherent Design with NKIL6550

d. Railing design

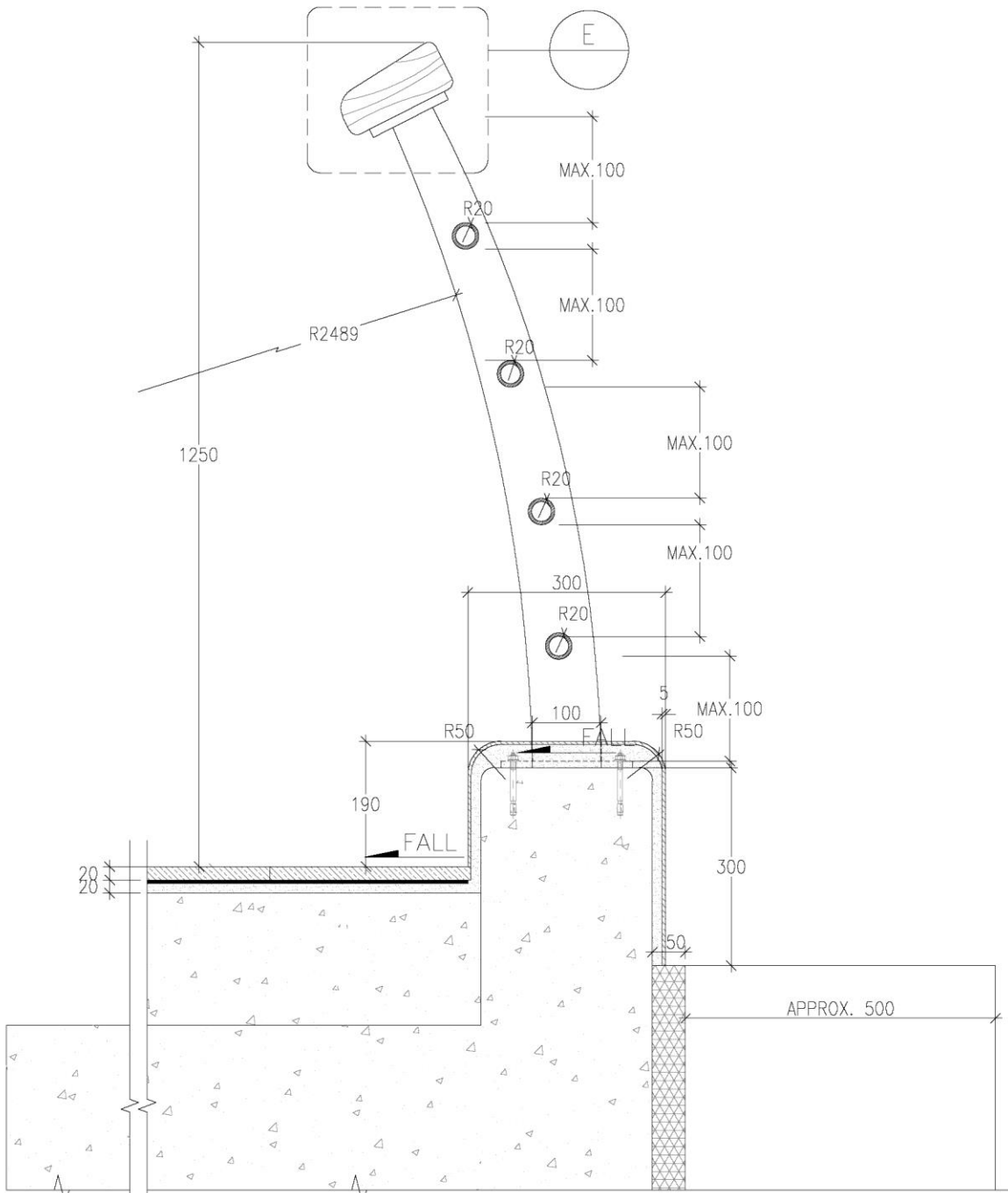

C SECTION DETAIL
SCALE 1:10

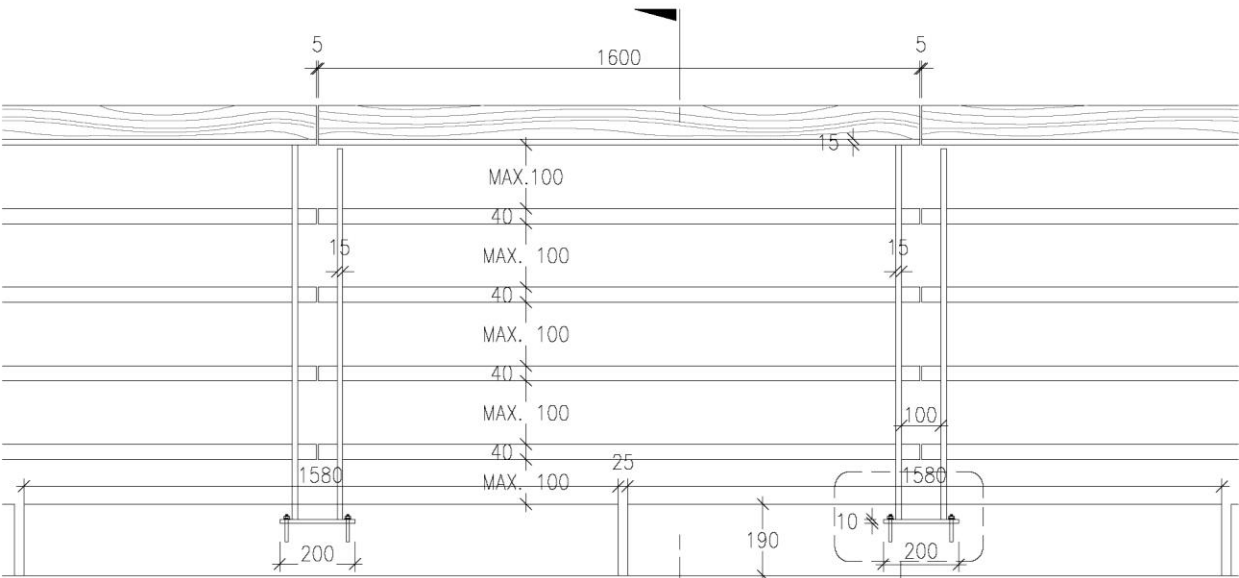

B ELEVATION
SCALE 1:20

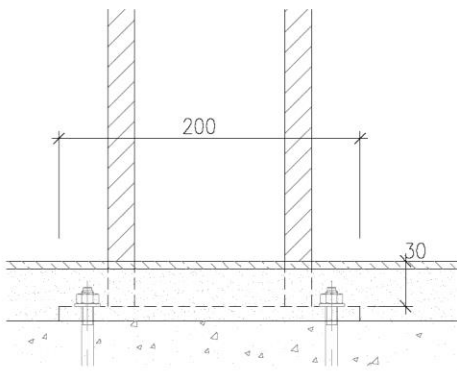

D BLOW-UP DETAIL
SCALE 1:5

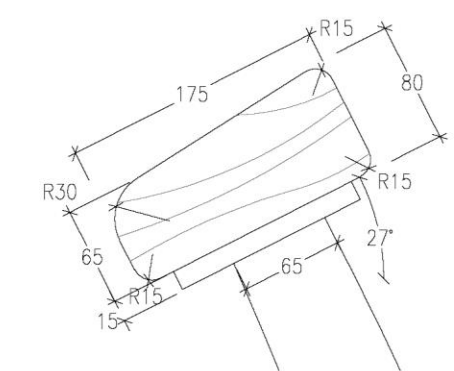

E BLOW-UP DETAIL
SCALE 1:5

3. Coherent Design with NKIL6550

e. Lighting ambience



Pole Light Provision along the Promenade



Color Temperature: 2700 - 3000k

5-10 Lux for Promenade in compliance to General Guide on Park Lighting Design, BSB/ArchSD

Thank You

