

**Presentation to
Task Force on Harbourfront Developments
in Kowloon, Tsuen Wan and Kwai Tsing
Meeting on 9 November 2015**

**Road and Infrastructural Works
at Lin Cheung Road Site, Sham Shui Po**

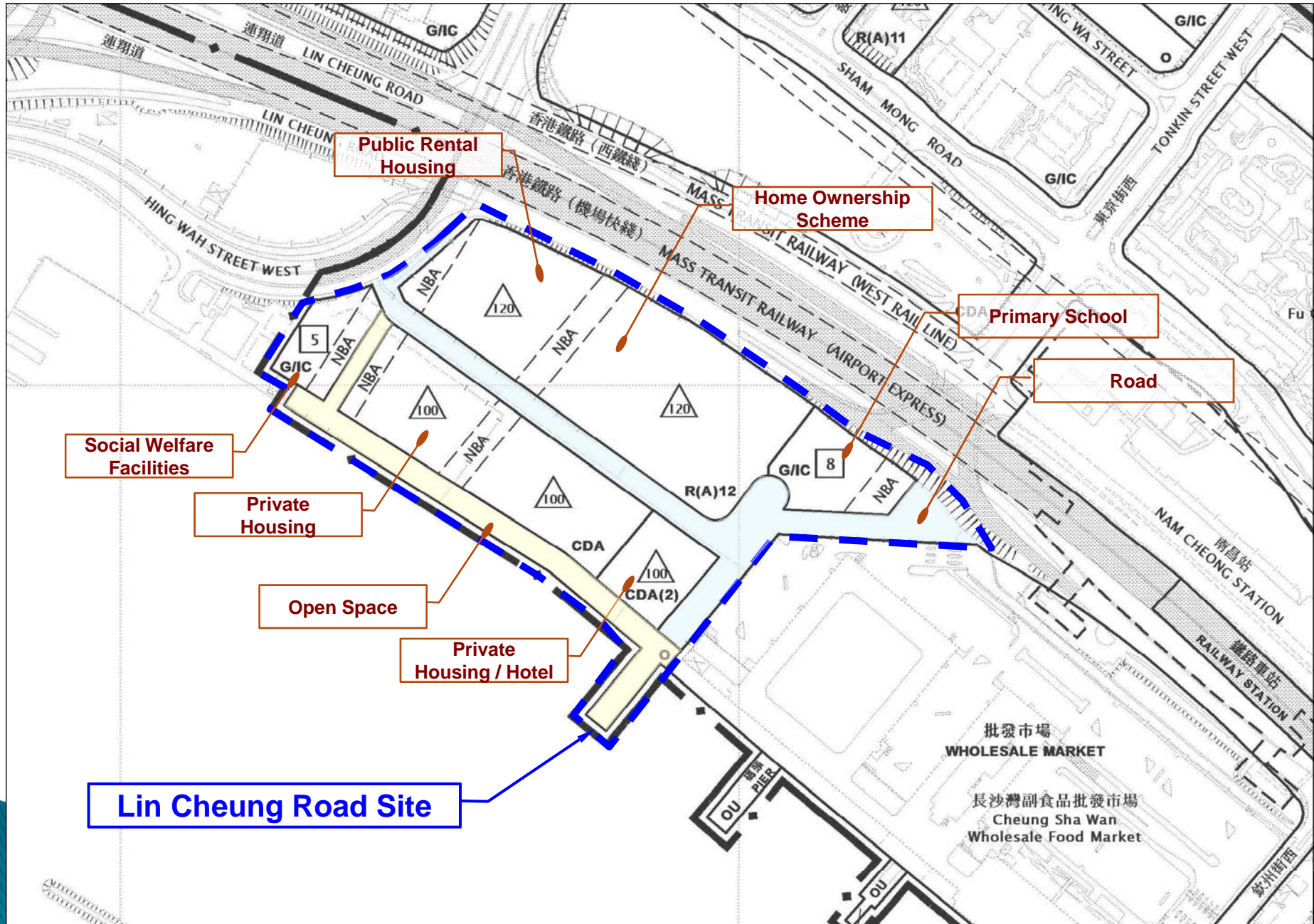

Approved South West Kowloon OZP No. S/K20/30



Project Scope & Programme

- Road scheme was gazetted on 17 & 24 July 2015 and no written objection was received
- Detailed design in progress and to be completed in Dec 2015

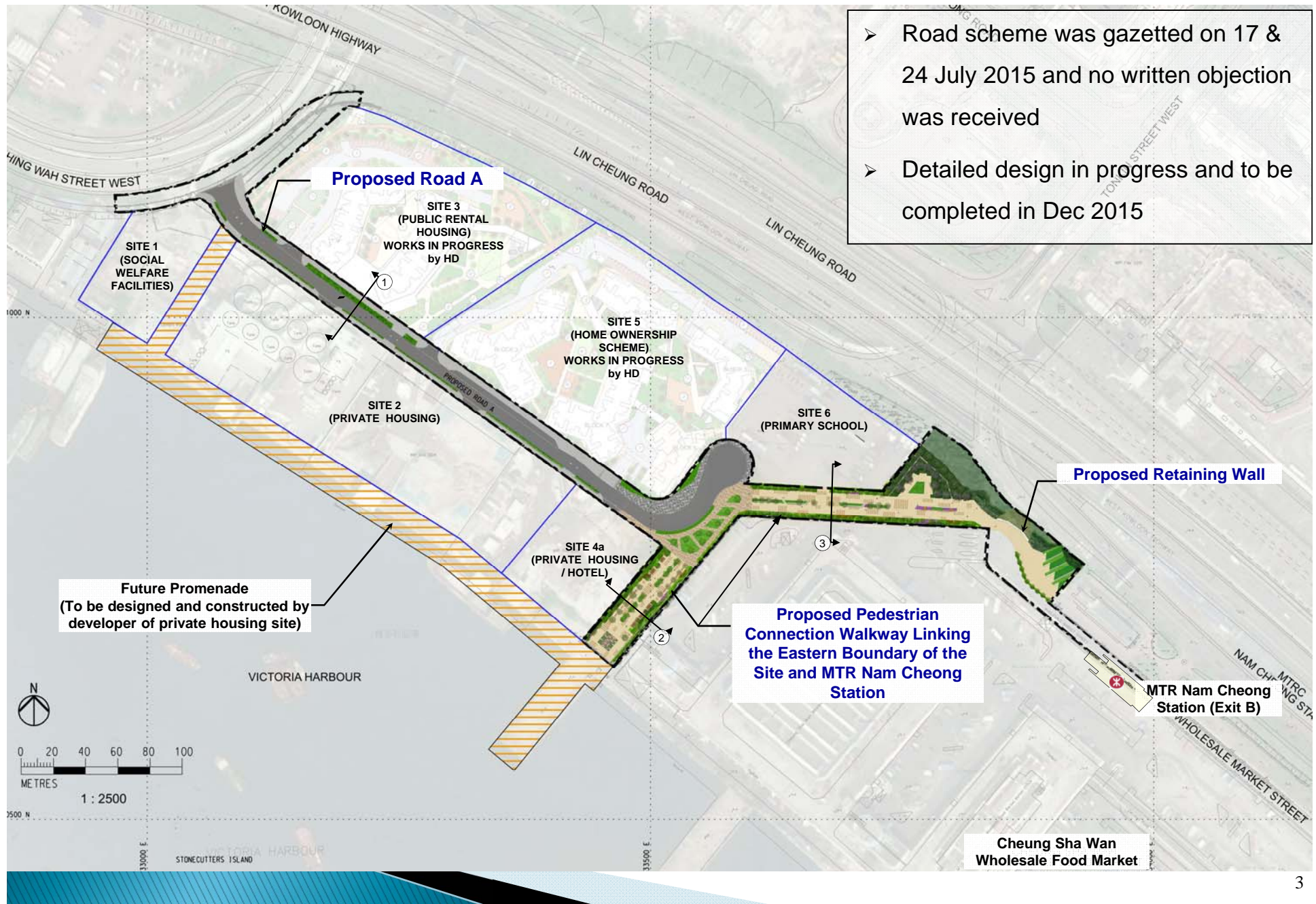

Typical Cut Section – Proposed Road A

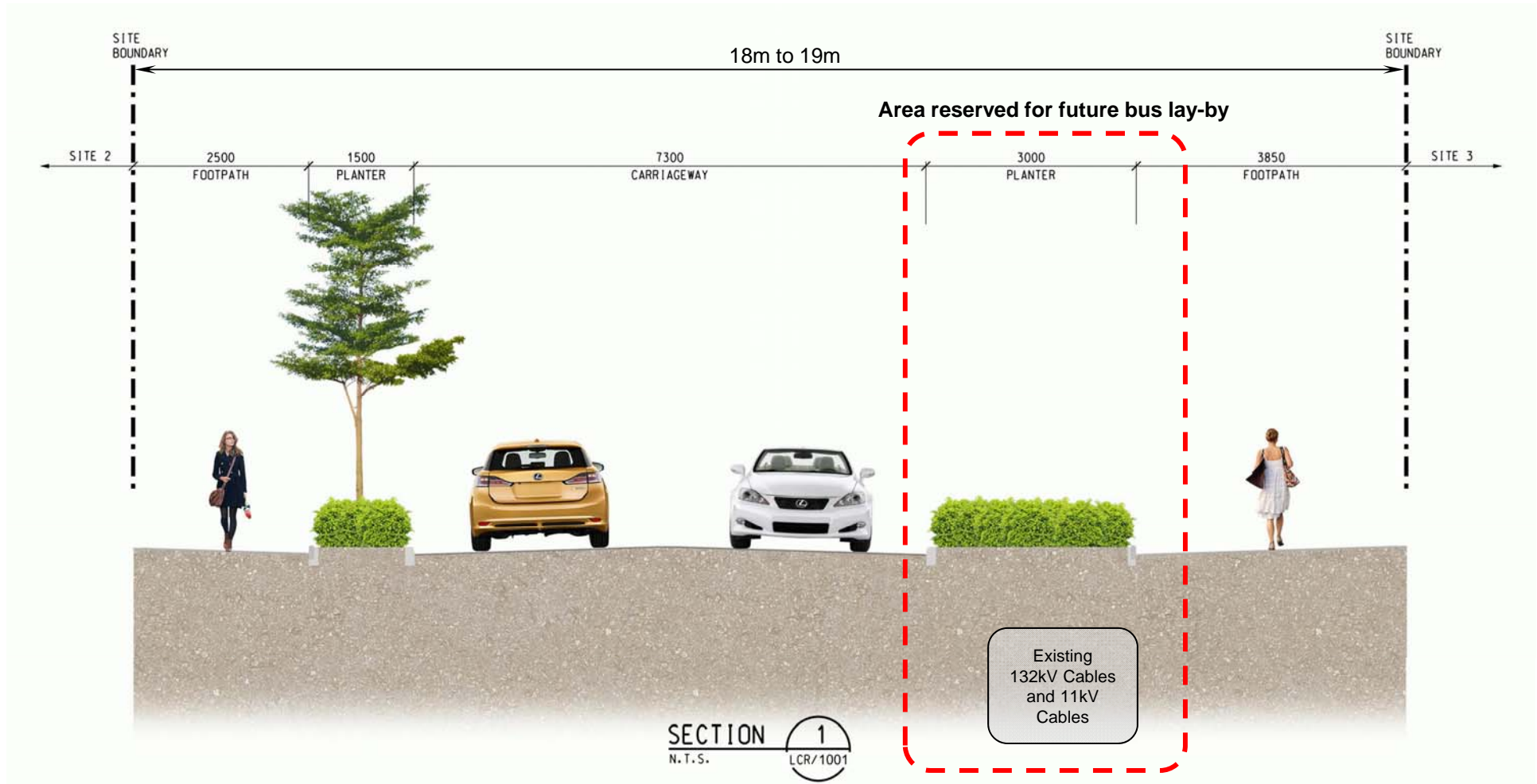

Typical Cut Section – Pedestrian Connection Walkway

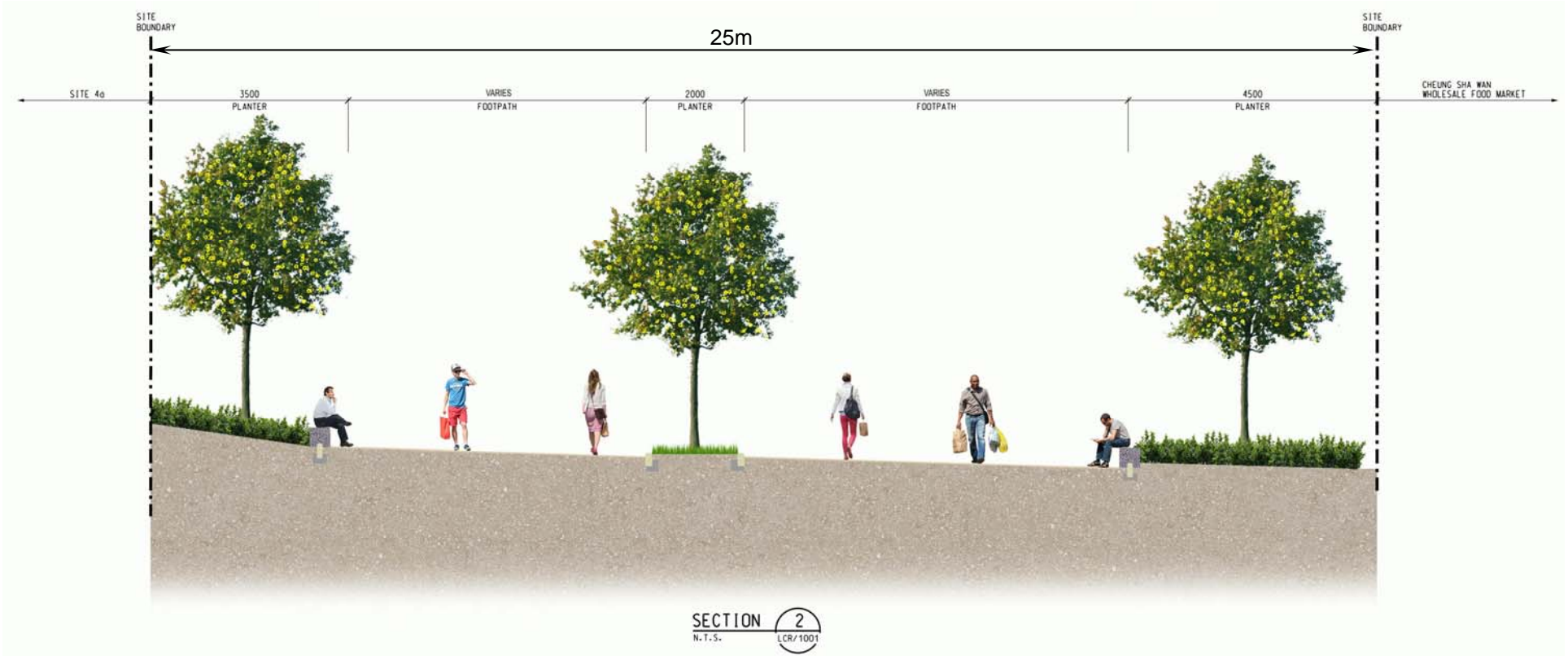

Typical Cut Section – Pedestrian Connection Walkway

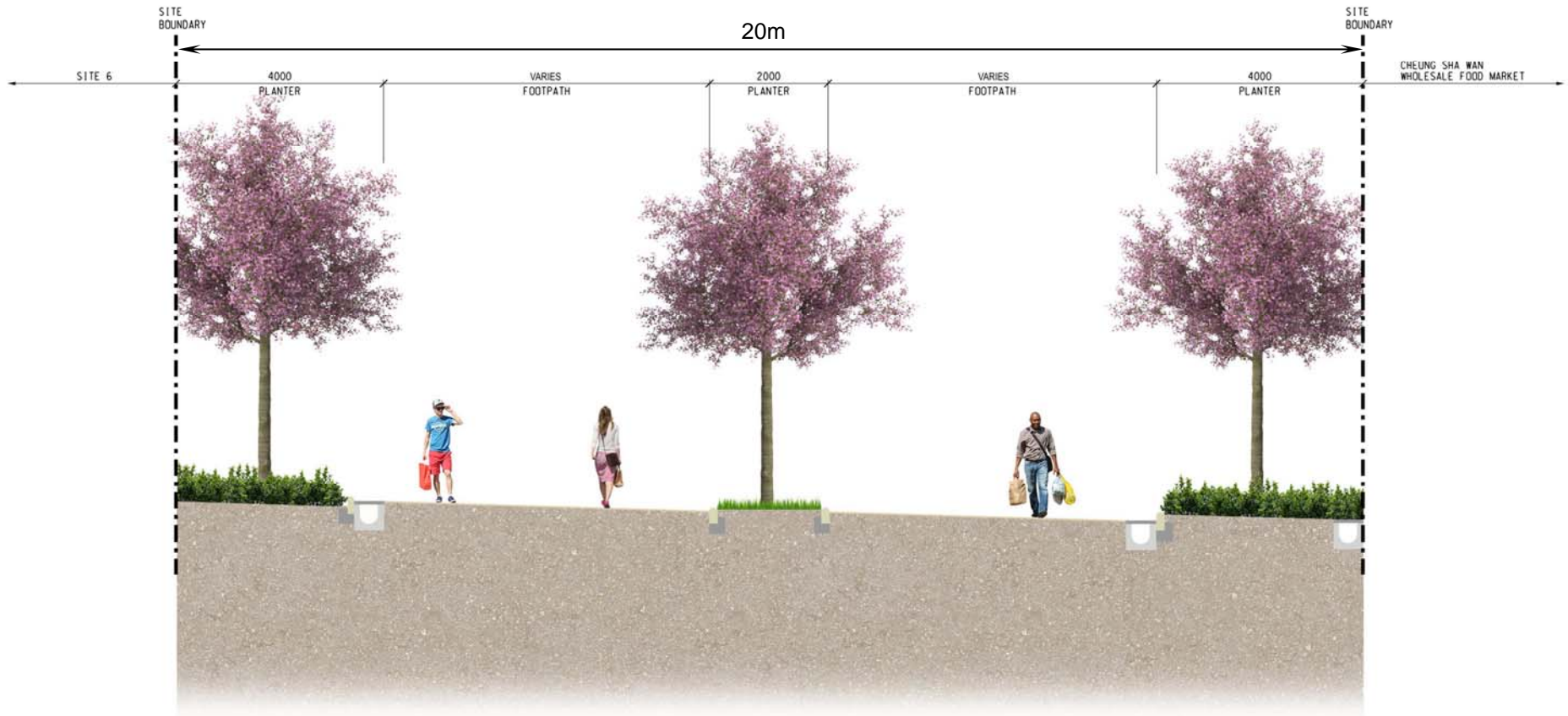

SECTION 3
N.T.S. LCR/1001

Pedestrian Connection Walkway – Preliminary Landscape Design Option



Landscape Design Theme – Detail A and Reference Images

Paving Design Concept _ Cargo

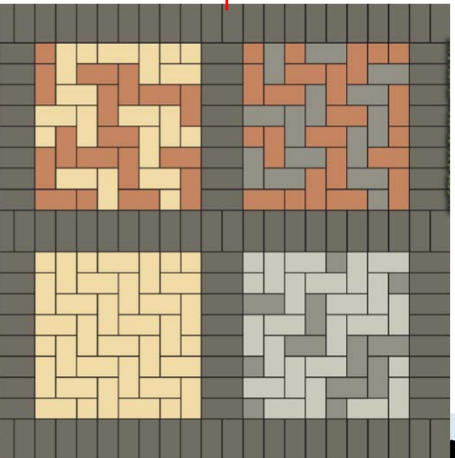
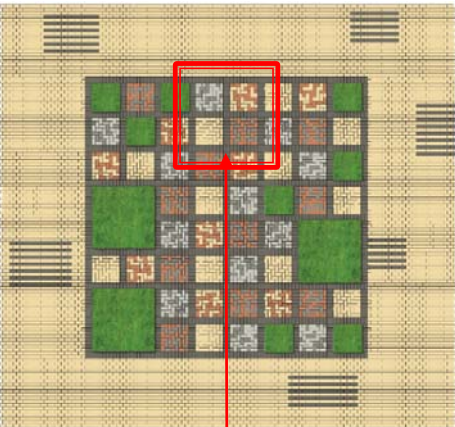

① Feature Paving

Landscape Design Theme – Detail B and Reference Images



① Feature Sitting Bench at Pocket Garden



Conceptual Images
Cargo Container

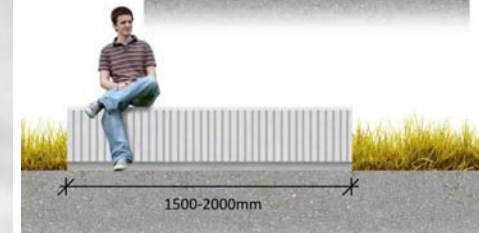

Tree Planting Proposal

Scientific Name	Chinese Name	Features
<i>Bauhinia variegata</i>	宮粉羊蹄甲	Deciduous. Pink flowers from April to May
<i>Tabebuia argentea</i>	銀鱗風鈴木	Deciduous. Light green leaves and Spectacular golden flowers in spring and fall.
<i>Wodyetia bifurata</i>	狐尾椰子	Feature palm with green leaves whole year

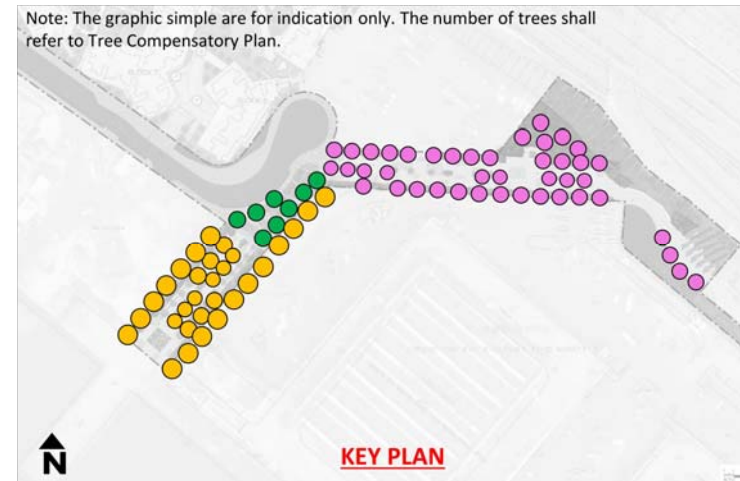

Bauhinia variegata



Tabebuia argentea



Wodyetia bifurata

Shrubs Planting Proposal

The planting design ideas inspired by the waves on the sea. Shrubs and ground-cover create the curve patterns which represent the sea waves.



Typical Shrub Planting Plan (Typology Type 1)



Reference Image



Typical Shrub Planting Plan (Typology Type 2)

Open Space Amenity Shrubs/ Ground-cover Planting

Shrubs or ground-cover with flowers or colorful foliage create wavy pattern

Scientific Name	Chinese Name	Features
<i>Codiaeum variegatum</i>	灑金榕	Shrub up to 3m tall with variegated Leaves
<i>Ixora chinensis</i>	龍船花	Evergreen. Red flowers July to November
<i>Melastoma malabathricum</i>	野牡丹	Bright purple to violet flowers from February to May
<i>Allamanda cathartica</i>	軟枝黃蟬	Shrubs trailing up to 4m, yellow flowers June to December
<i>Raphiolepis indica</i>	車輪梅	White or pink flowers from February to April
<i>Rhodomyrtus tomentosa</i>	桃金娘	Purplish red flowers from April to May
<i>Duranta erecta</i> 'Golden Leaves'	金葉假連翹	A sprawling shrub commonly grown as hedge. Light green leaves
<i>Rhododendron pulchrum</i>	錦繡杜鵑	Evergreen. Pink flowers March to May



Codiaeum variegatum



Ixora chinensis



Melastoma malabathricum

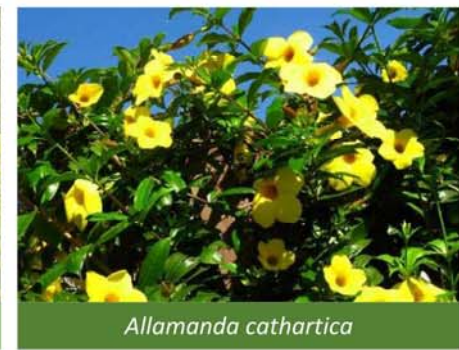

Allamanda cathartica



Raphiolepis indica



Rhodomyrtus tomentosa



Duranta erecta 'Golden Leaves'



Rhododendron pulchrum

Photomontage – View 1 (Near the Exit B of MTR Nam Cheong Station)



Photomontage – View 2 (Along pedestrian connection walkway)



Photomontage – View 3 (Along pedestrian connection walkway)



Connectivity – Within Lin Cheung Road Site to Promenade

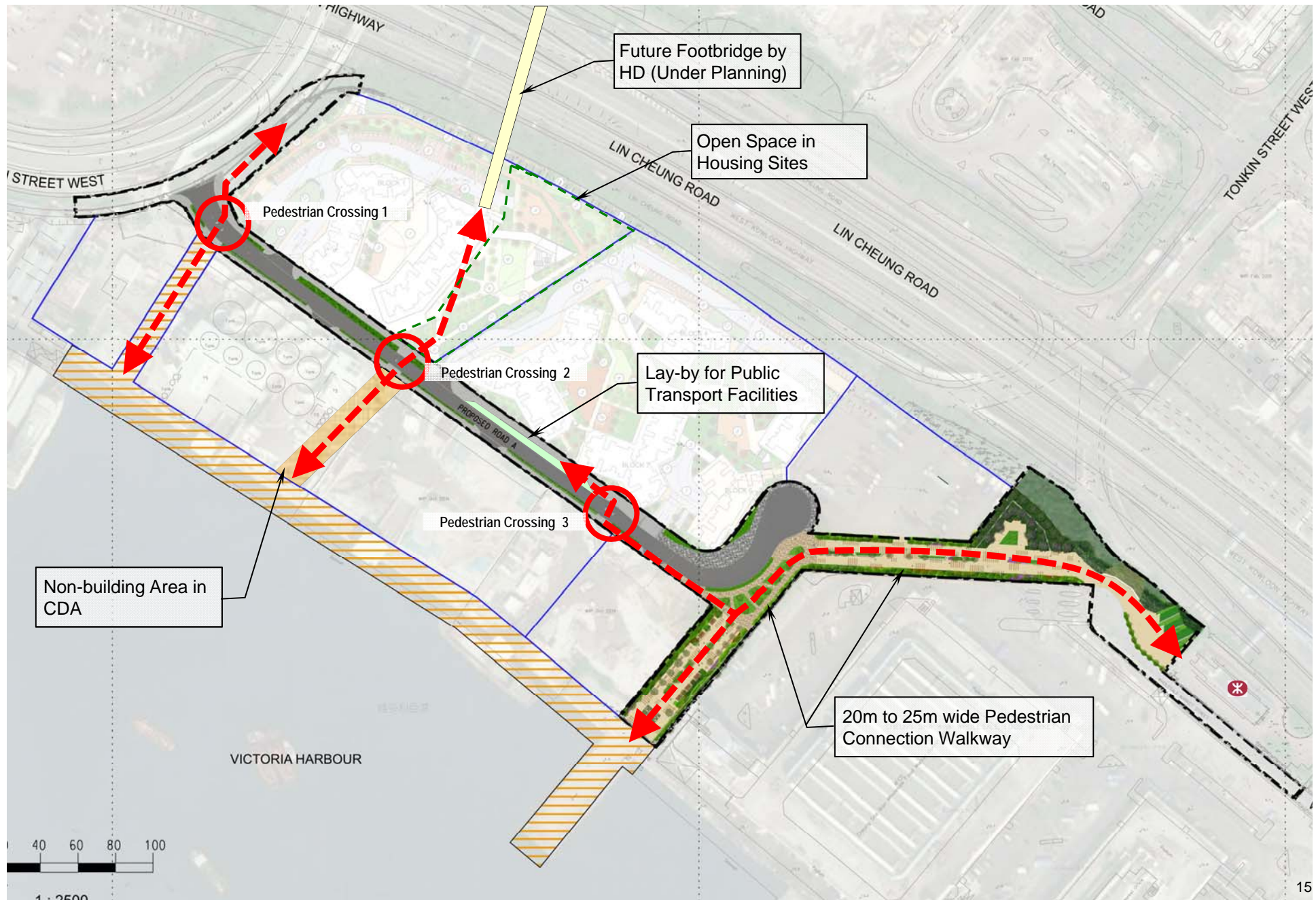

Connectivity – To area outside Lin Cheung Road Site

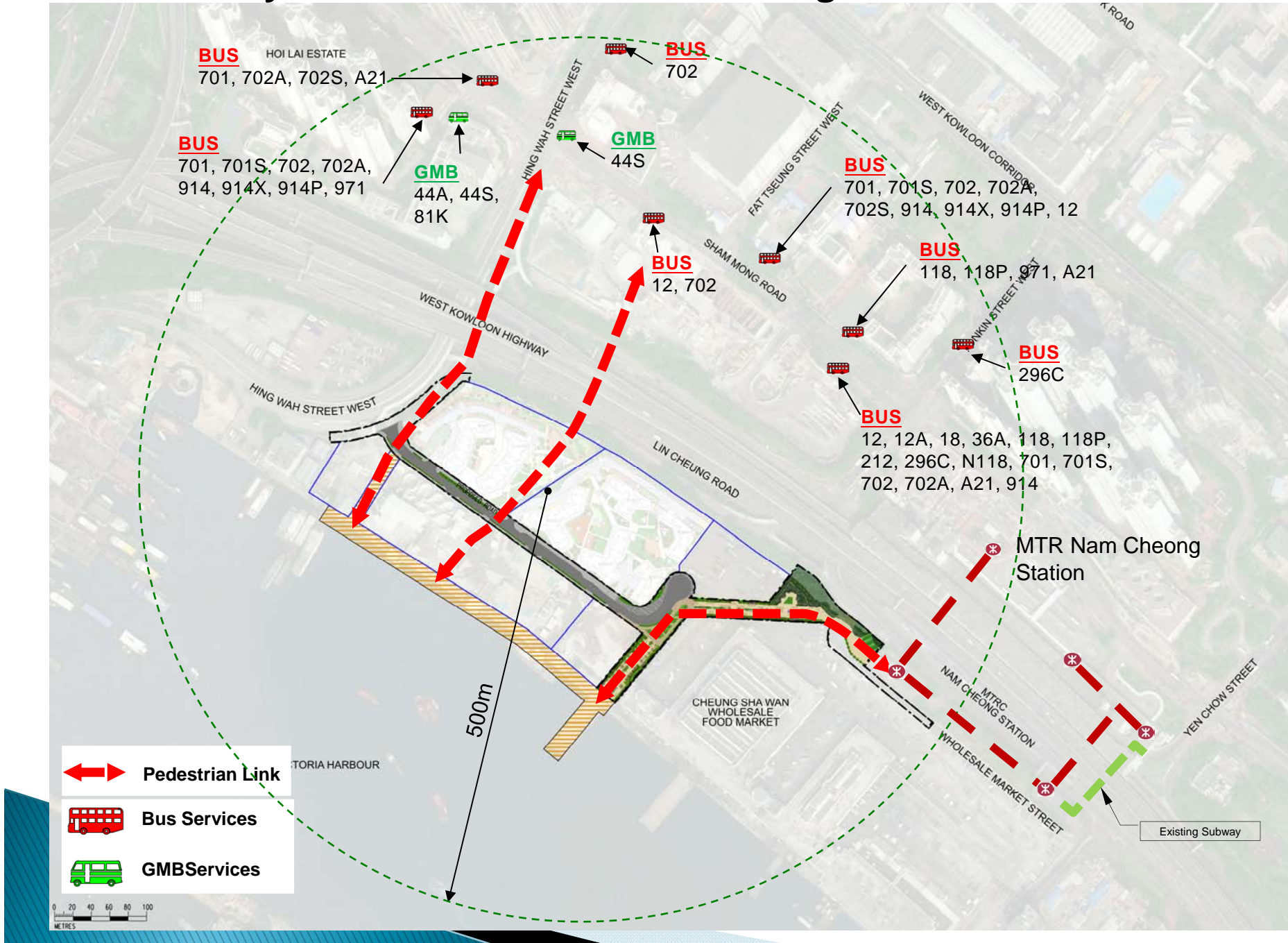

Thank you

