

PROGRESS UPDATE ON THE WEST KOWLOON CULTURAL DISTRICT

**Task Force on Harbourfront Developments in
Kowloon, Tsuen Wan and Kwai Tsing**

10 September 2014

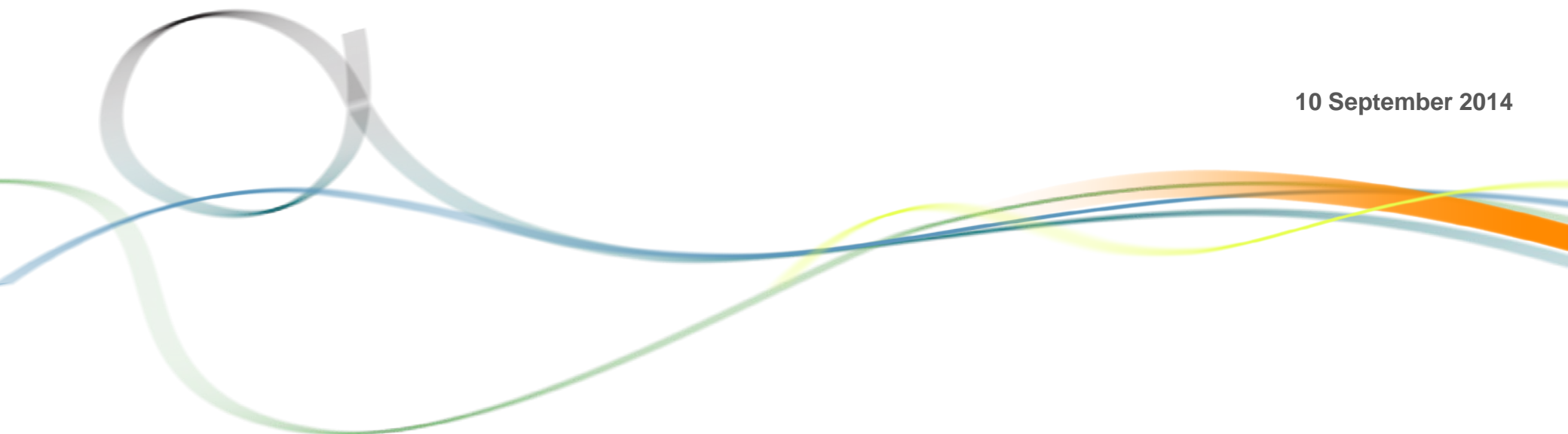

Purpose

Provide updates on:

- **Development progress of WKCD; and**
- **Proposed first phase of infrastructure works**

WKCD Masterplan



Note: Pontoons are subject to compliance with the Protection of the Harbour Ordinance (Cap. 531) and relevant Government departments' agreement

Progress of Key Development Initiatives

Xiqu Centre

- Built for xiqu (Chinese opera) performances
- Foundation works commenced in September 2013
- Target completion in mid 2017

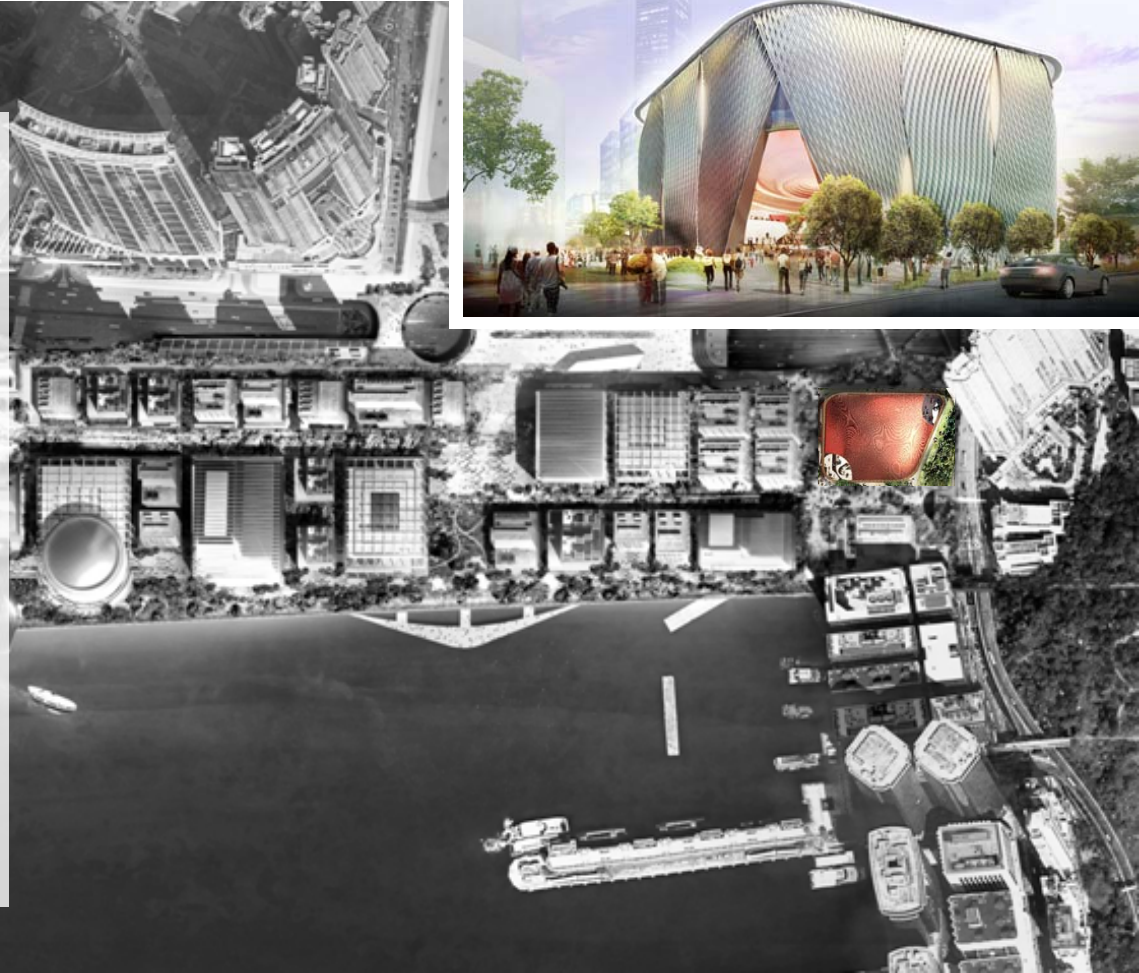

Progress of Key Development Initiatives

Artist Square Development Area (ASDA)



- “Mini-WKCD” including:
 - Arts & Cultural Facilities, e.g. M+, Lyric Theatre
 - Retail, Dining and Entertainment facilities
 - Office / Residential Developments
- Target completion by around 2020

Key development initiatives in ASDA



M+

- Museum for visual culture
- Design consultancy started in Sep 2013
- Completion in first half of 2018



Lyric Theatre

- 1,200 seats theatre
- Focus on all types of dance
- Completion by around 2020

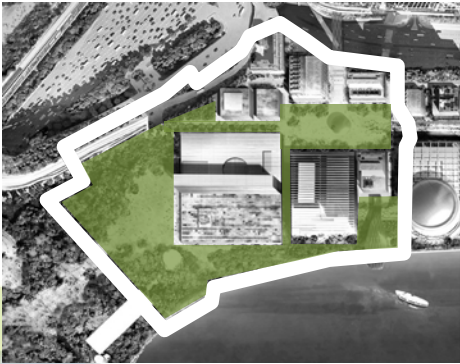

Public Spaces

- Park interface area with M+
- Artist Square
- Waterfront promenade

Progress of Key Development Initiatives

The Park



- Appointment of design team in February 2014
- Design team:
 - Dennis Lau & Ng Chun Man Architects & Engineers (Hong Kong) Ltd
 - West 8 (Netherlands)
 - ACLA (Hong Kong)
- Concept design stage

- 1 CULTURAL BOULEVARD 文化大道
- 2 ARTS PAVILION 小型藝術展館
- 3 BLACK BOX 黑盒劇場
- 4 OUTDOOR STAGE 戶外舞台
- 5 BIG LAWN 大型草坪
- 6 WATERFRONT PROMENADE 海濱長廊
- 7 WATERFRONT EVENT SPACE 海濱活動廣場
- 8 WHC VENTILATION BUILDING 西隧通風大樓
- 9 MTR VENTILATION BUILDING 港鐵通風大樓



Note: Pontoons are subject to compliance with the Protection of the Harbour Ordinance (Cap. 531) and relevant Government departments' agreement
 備註：浮橋須受《保護海港條例》（第531章）的限制及獲得相關政府部門的同意

PLAN
平面圖

WEST 8 DLN

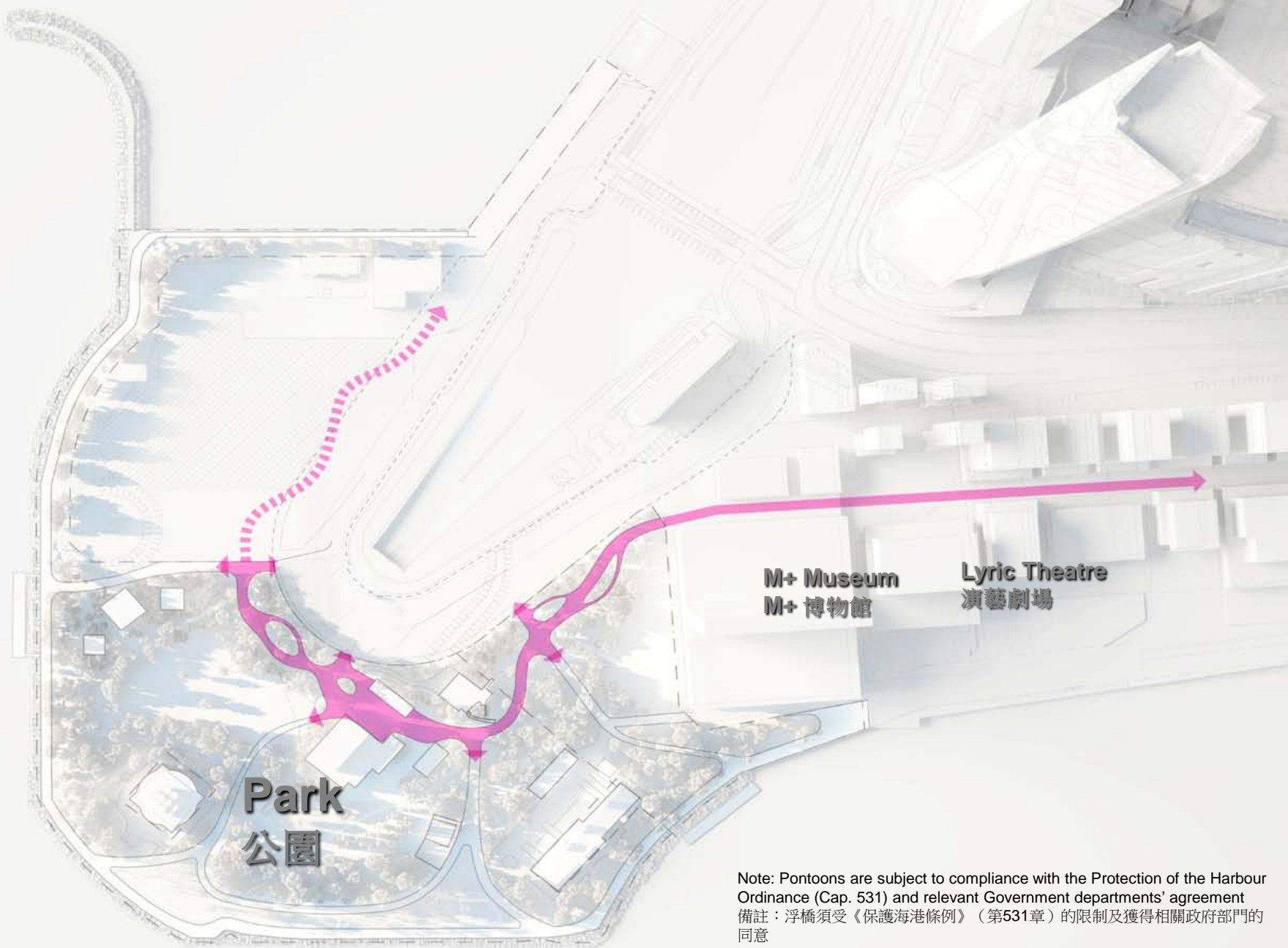

Note: Pontoons are subject to compliance with the Protection of the Harbour Ordinance (Cap. 531) and relevant Government departments' agreement
備註：浮橋須受《保護海港條例》（第531章）的限制及獲得相關政府部門的同意

CULTURAL BOULEVARD 文化大道

WEST 8 **DLN**



ARTIST IMPRESSION - CULTURAL BOULEVARD

效果圖 - 文化大道

WEST 8 DLN



ARTIST IMPRESSION - BIG LAWN
效果圖 - 大型草坪



EXHIBITIONS 展覽



PERFORMANCE VENUE 表演場地



CAFE 茶座



TREES AND SHADE 樹蔭

PROGRAMME ALONG CULTURAL BOULEVARD
文化大道功能布局

WEST 8 DLN

1.2 KM-LONG WATERFRONT PROMENADE PROVIDES SPECTACULAR VIEWS OF HONG KONG ISLAND IN A GREEN PEACEFUL SETTING

1.2 公里長的海濱長廊擁有寧靜綠色的環境，遊人可欣賞港島的美麗景色。



Note: Pontoons are subject to compliance with the Protection of the Harbour Ordinance (Cap. 531) and relevant Government departments' agreement
備註：浮橋須受《保護海港條例》（第531章）的限制及獲得相關政府部門的同意

WATERFRONT PROMENADE

海濱長廊

WEST 8 DLN



UNPRECEDENTED VIEW
前所未有的視野

WEST 8 **DLN**

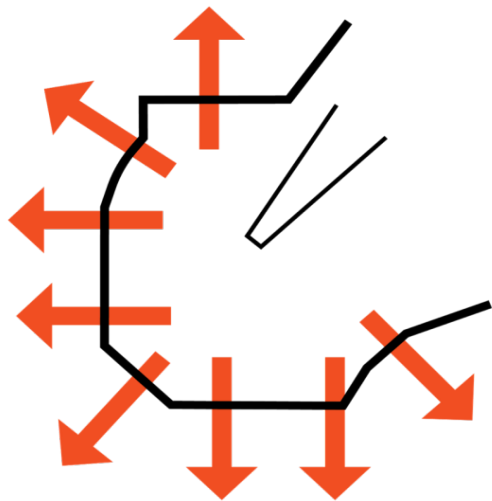

270 DEGREE VIEWS
270度遼闊海景

WEST 8 DLN



DOUBLE EDGE SECTION
雙層邊緣切面

WATERFRONT PROMENADE
海濱長廊

WEST 8 DLN



ARTIST IMPRESSION - WATERFRONT PROMENADE

效果圖 - 海濱長廊

WEST 8 DLN



Waterfront Plaza Market
海濱廣場市集



Food festival
美酒佳餚節

Event pavilions
臨時活動展館

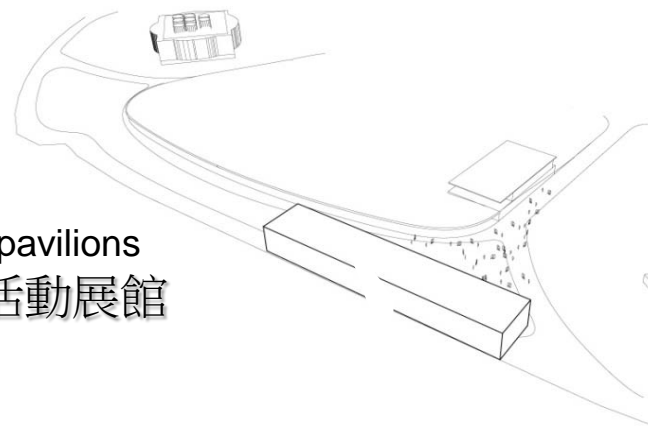
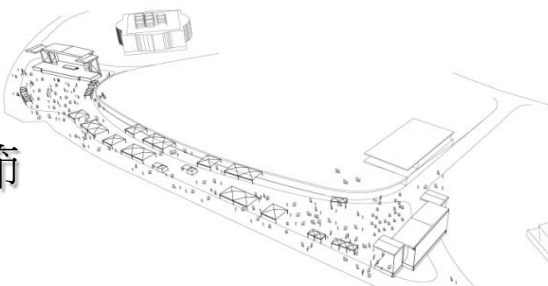
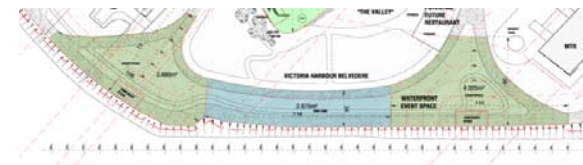



- **CULTURAL BOULEVARD** 文化大道
- **BIG LAWN** 大型草坪
- **GENTLY INCLINED LAWN** 斜草坪
- **SMALL LAWN** 小型草坪
- **WATERFRONT EVENT SPACE** 海濱活動廣場
- **WATERFRONT PROMENADE** 海濱長廊
- **BOTANIC GROVE** 植物花園



PARK EVENT SPACES 公園各式活動場地



ARTIST IMPRESSION - SMALL LAWN

效果圖 - 小型草坪

WEST 8 DLN



ARTIST IMPRESSION - VIEW TOWARDS M+
效果圖 - 由公園望向 M+



ARTS IN THE PARK 藝術與公園的結合

WEST 8 DLN

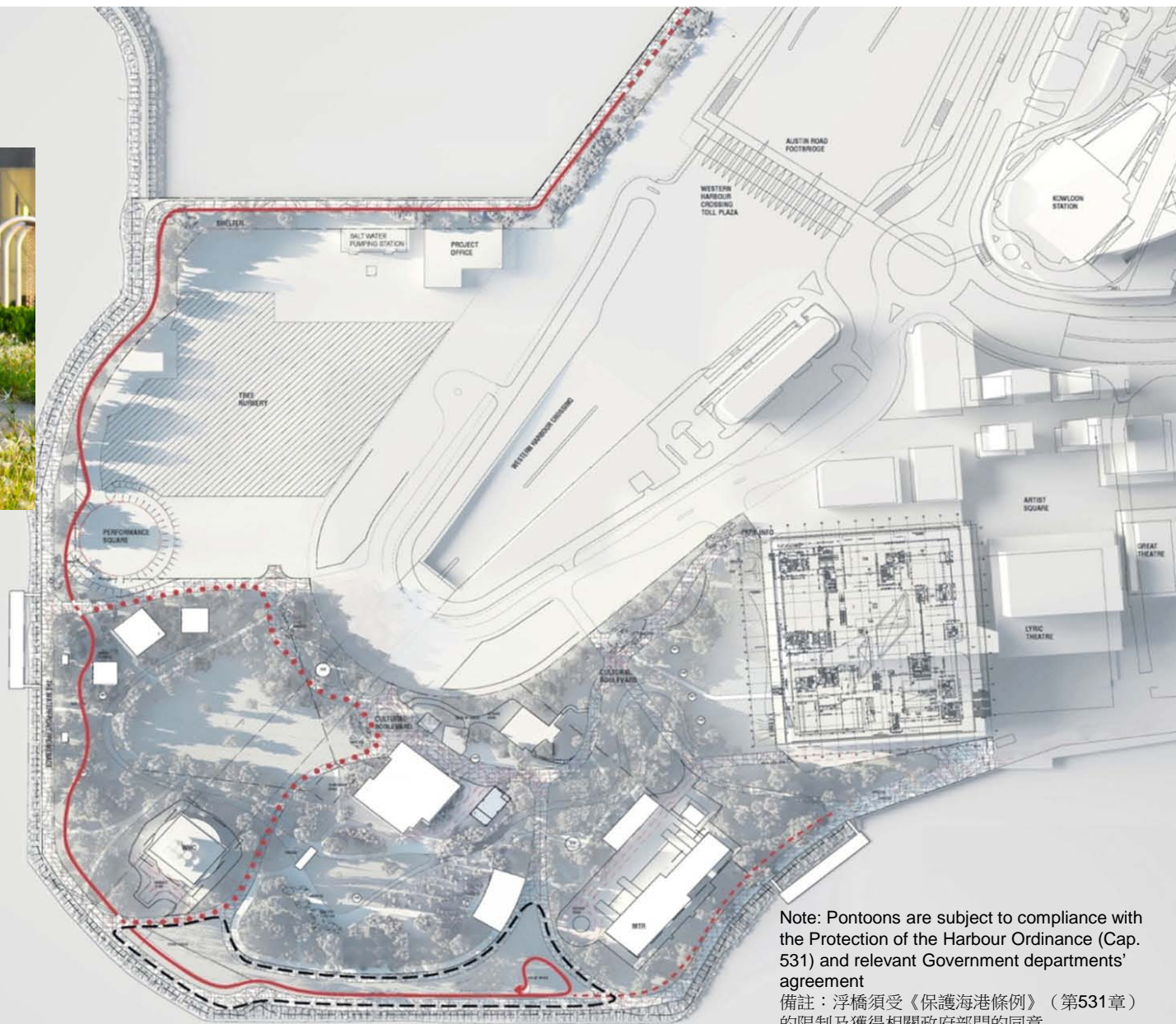

- BIKE ROUTE 單車徑
- - - FUTURE POSSIBLE EXTENSION 可行之單車徑延伸
- POSSIBLE ALTERNATIVE BIKE LOOP IN CASE OF EVENT
活動期間可行之單車徑改動
- - - WATERFRONT EVENT SPACE 海濱活動廣場

Note: Pontoons are subject to compliance with the Protection of the Harbour Ordinance (Cap. 531) and relevant Government departments' agreement
備註：浮橋須受《保護海港條例》（第531章）的限制及獲得相關政府部門的同意

BIKE ROUTE 單車徑

WEST 8 DLN



BOTANICAL THEMES

栽種主題



PALMETUM 棕櫚



SHADING TREES 遮蔭樹



BLOSSOMING TREES 大道風景樹



Infrastructure Works

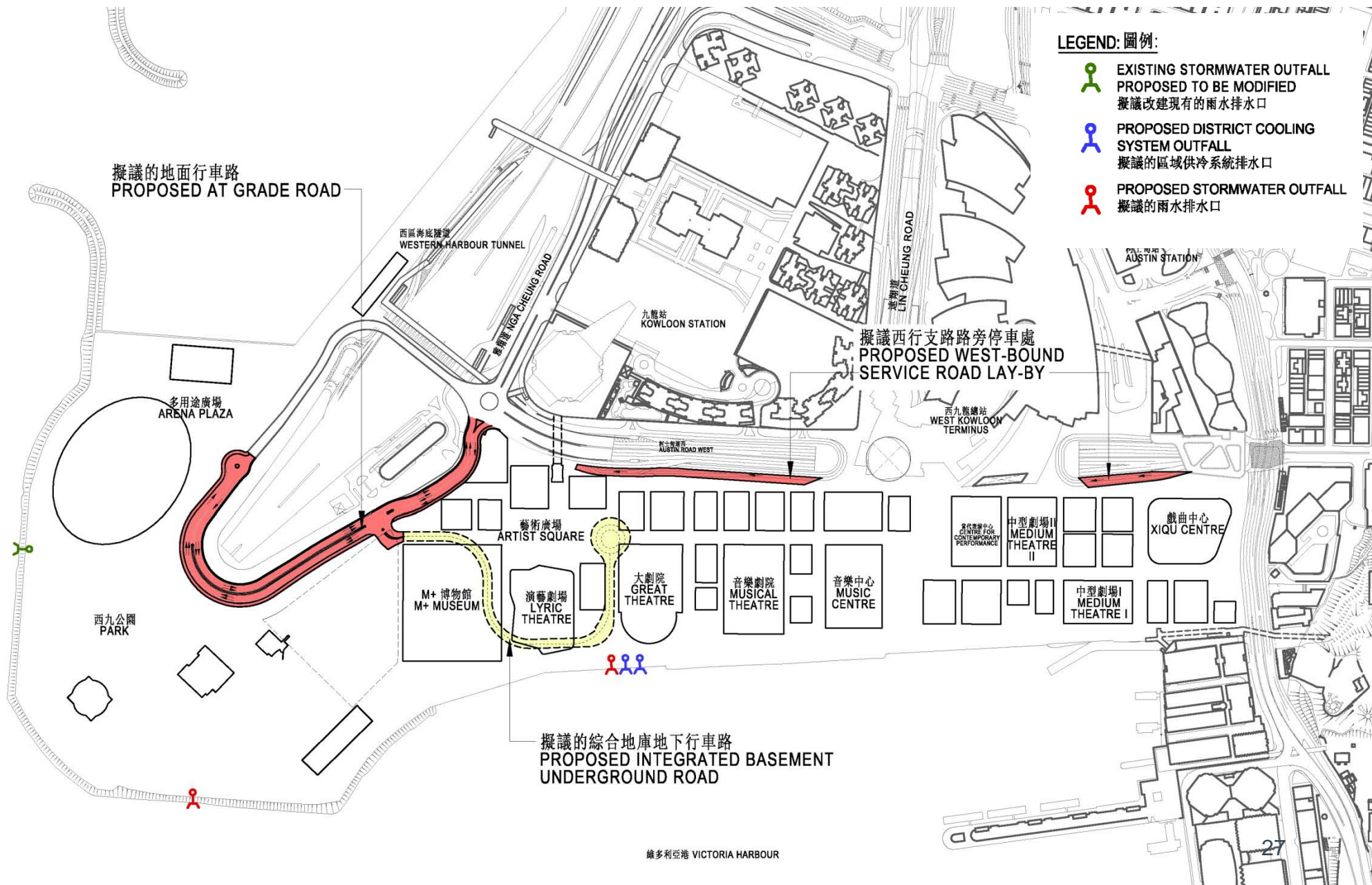

Advice Sought

Members are invited to provide comments on the progress update of the WKCD development and the proposed infrastructure works.

Thank You