

Task Force on Harbourfront Developments in Kowloon, Tsuen Wan and Kwai Tsing

For discussion
on 28 November 2023

TKF/06/2023

Proposed Provision of Avenue of Sports Stars at East Tsim Sha Tsui Waterfront

PURPOSE

This paper is to seek Members' views on the proposed Provision of Avenue of Sports Stars at East Tsim Sha Tsui Waterfront (the Project).

BACKGROUND

2. The District Minor Works (DMW) programme is to fund district-based works projects led by the Home Affairs Department and the Leisure and Cultural Services Department, costing up to \$50 million each to improve local facilities, living environment and hygienic conditions in the territory. District Offices has taken up the responsibility to propose such projects since December 2020, and Yau Tsim Mong District Office (YTMDO) has been actively exploring different projects.

3. The East Tsim Sha Tsui Waterfront is a walkway for residents to commute between Tsim Sha Tsui and Hung Hom and a popular jogging route, but the facility does not particularly cater for the needs of runners and other members of the public. YTMDO therefore proposes to provide such amenities and beautify the existing roadside noise barriers, with the theme of "Hong Kong Elite Athletes" to complement the adjacent Avenue of Stars. This has the support of locals and the sports sector. The Home Affairs Department commissioned a consultancy study on the feasibility of the proposed.

Task Force on Harbourfront Developments in Kowloon, Tsuen Wan and Kwai Tsing

For discussion
on 28 November 2023

TKF/06/2023

PROPOSED SCOPE OF WORKS

4. Having considered the aforementioned feasibility study and views of relevant stakeholders, the latest scope of works is as follows –

- a. beautifying roadside noise barriers on part of the Hung Hom Bypass to showcase photos of Hong Kong athletes with outstanding performance;
- b. beautifying the pavement with distance markings throughout the one-kilometre path to cater for the needs of joggers;
- c. providing drinking fountains and Automated External Defibrillators (AEDs) to cater for the needs of joggers and other users;
- d. providing rainshelters and benches to facilitate public appreciation of the Harbourfront; and
- e. incorporating greening elements to the rainshelters and benches, to enhance the outlook and air quality, given its close proximity to the Hung Hom Bypass which brings about dust and fine particles.

5. The schematic design of the Project is at the **Annex**.

6. An item proposed to be funded by the Capital Works Reserve Fund block allocation was created for this Project in January 2023. The beautifying of noise barriers and the provision of drinking fountains are tentatively scheduled to commence in Q2/2024, while the rest in Q4/2026.

7. Separately, the Harbour Office/Development Bureau is exploring implementation of quick-win enhancement work, such as beautifying the railings and staircase and adding the logos of Victoria Harbour, etc. at the elevated walkway adjacent to the Hung Hom Bypass, with the target completion in Q4/2024.

Task Force on Harbourfront Developments in Kowloon, Tsuen Wan and Kwai Tsing

For discussion
on 28 November 2023

TKF/06/2023

HARBOUR PLANNING PRINCIPLES

8. Harbour Planning Principles (HPPs) were developed as a set of guidelines for all individuals and organisations to facilitate the sustainable planning, preservation, development, and management of Victoria Harbour and the harbourfront areas. Further to the above discussions, the proposed has paid due respect to these principles as illustrated below –

(a) Preserving Victoria Harbour

The existing East Tsim Sha Tsui Waterfront (Waterfront) is built as an open space and the improvement works aim at beautifying the facilities to cater to frequent users, viz., nearby residents and joggers, and enhance public enjoyment to the Harbourfront;

(b) Stakeholder Engagement

In planning the design, the views of locals and other relevant stakeholders have been taken into account;

(c) Sustainable Development

the upgrading of facilities will meet the changing needs of the community, cater to the aspirations of different sectors of the community, utilise the open space, thus maximise the public enjoyment of the Waterfront;

(d) Integrated Planning, Proactive Harbour Enhancement, Vibrant Harbour and Public Enjoyment

The design of the improvement works has taken into account the Harbourfront setting and the needs of its frequent users to facilitate public appreciation of the Harbourfront.

Task Force on Harbourfront Developments in Kowloon, Tsuen Wan and Kwai Tsing

For discussion
on 28 November 2023

TKF/06/2023

(e) Public Consultation

Since 2021, YTMDO has sought the views of the sports sector (including the Sports Federation and Olympic Committee of Hong Kong, China and Hong Kong Association of Athletics Affiliates), the concerned Area Committee, the Yau Tsim Mong Youth Development and Civic Education Committee and other local stakeholders; members supported the proposal and urged for early implementation.

The views of the Yau Tsim Mong District Council and the Yau Tsim Mong District Youth Community Building Committee will soon be sought as well.

ADVICE SOUGHT

9. Members are invited to express their views and offer support on the proposed development.

ATTACHMENT

Annex Schematic design of the Project

**Yau Tsim Mong District Office
Home Affairs Department
November 2023**

HAD 6th Minor Works Term Consultancy for Hong Kong East Region Consultancy Agreement No. 9AJ120

YTM-DMW366_ Provision of Avenue of Sports Stars at East Tsim Sha Tsui Waterfront

Design proposal

WCWP

Architecture
建筑

Interior Design
室内设计

Planning
规划



Site Location

Total Site area: 10333.93m²

Planter Area : 2097.87m²

Total Site Area (Extruding Planters) : 8236.06m²



Skyline



Landmarks



AIA Tower



Hysan Place



HKECC



Bank of China



IFC



Shun Tak Centre

Holistic Approach



The site is sitting along the waterfront stretch of Kowloon, offering **spectacular views of Victoria Harbour**. It is indeed an area where people usually visit to have a **relaxing stroll or leisure runs**. There have been constant change and improvement along the years along the district and one of our aim is to **promote a strong connection of Hong Kong's rich leisure, sports, art & cultural heritage**.

Starting point



Artist impression for preliminary design, the design is subject to further design development, on site measurement and further coordination with other parties

View Promenade

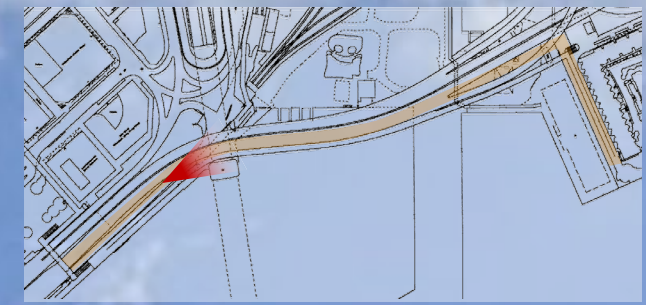

Key plan



Artist impression for preliminary design, the design is subject to further design development and further coordination with other parties. The graphic of the noise barrier and balustrade are subject to further coordination with Government Departments and relevant parties

View Promenade

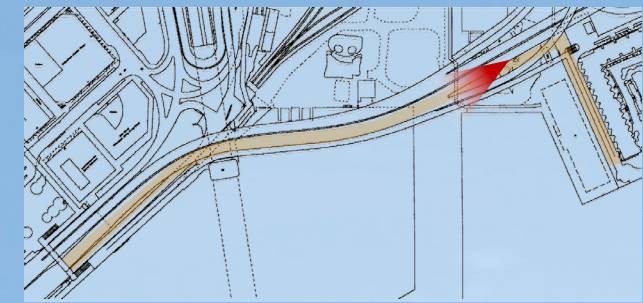

Key plan



Artist impression for preliminary design, the design is subject to further design development and further coordination with other parties. The graphic of the noise barrier and balustrade are subject to further coordination with Government Departments and relevant parties

Ramp



Key plan



Artist impression for preliminary design, the design is subject to further design development and further coordination with other parties

Return Point option 1

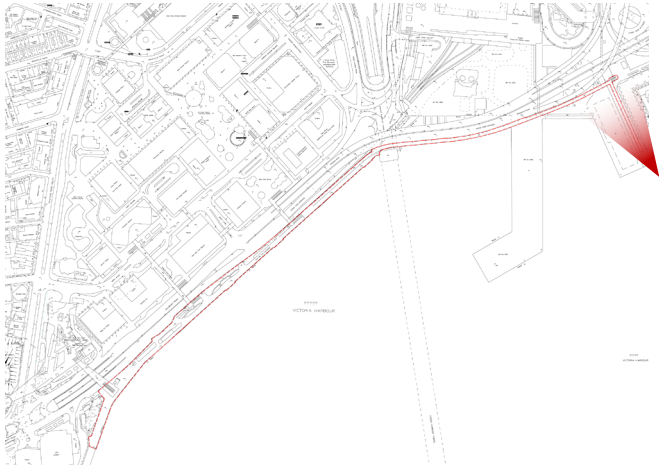

Return Point option 2

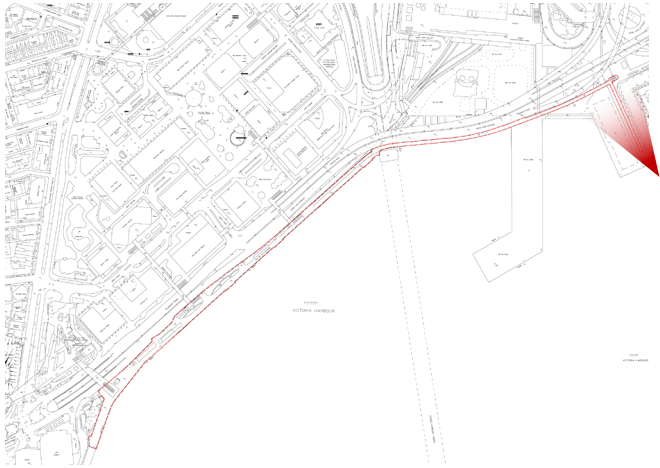

Proposed Location of Drinking Fountain -

LCSD provisions of plumbing and drainage

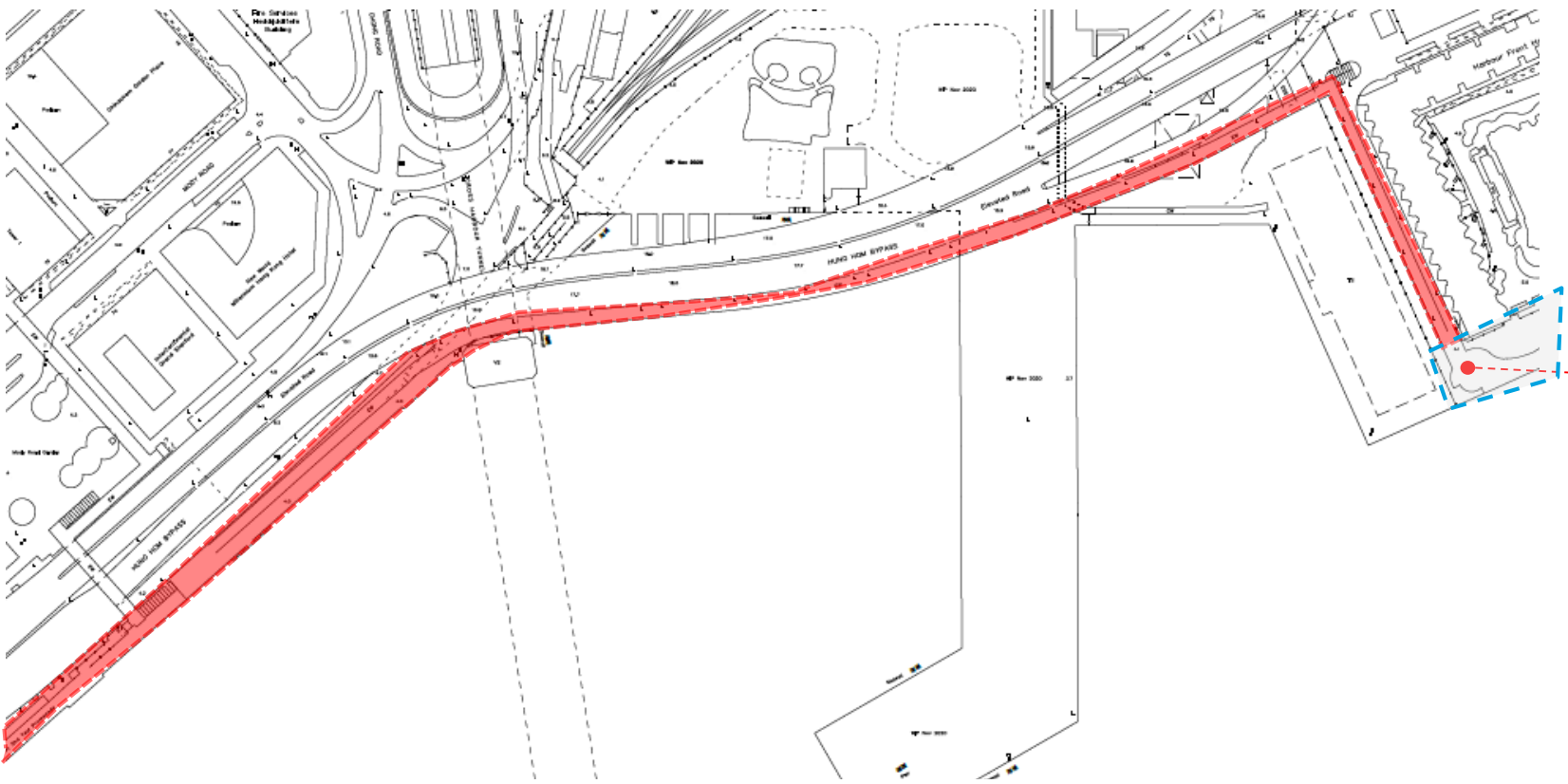

Site Location Plan

 Site Area

● Proposed Location of Drinking Fountain at Tsim Sha Tsui Promenade East



 Tsim Sha Tsui Promenade East

Proposed Drinking Fountain -

LCSD provisions of plumbing and drainage

