

# HK Harbourfront Commission Meeting Task Force on Harbourfront Developments in Kowloon, Tsuen Wan and Kwai Tsing

## Tsim Sha Tsui Waterfront Public Realm Enhancement

22 JANUARY 2013

prepared by:

james corner field operations  
475 tenth avenue, 10th floor  
new york, ny 10018



prepared for:

New World Development Company Limited  
30/F, New World Tower  
18 Queen's Road Central, Hong Kong



# **REVITALISING TSIM SHA TSUI WATERFRONT TASKFORCE ON HARBOURFRONT DEVELOPMENTS IN KOWLOON, TSUEN WAN AND KWAI TSING**

**22 January 2013**

# COMPREHENSIVE PUBLIC REALM ENHANCEMENT FOR THE TSIM SHA TSUI WATERFRONT





# TSIM SHA TSUI WATERFRONT ENHANCEMENT

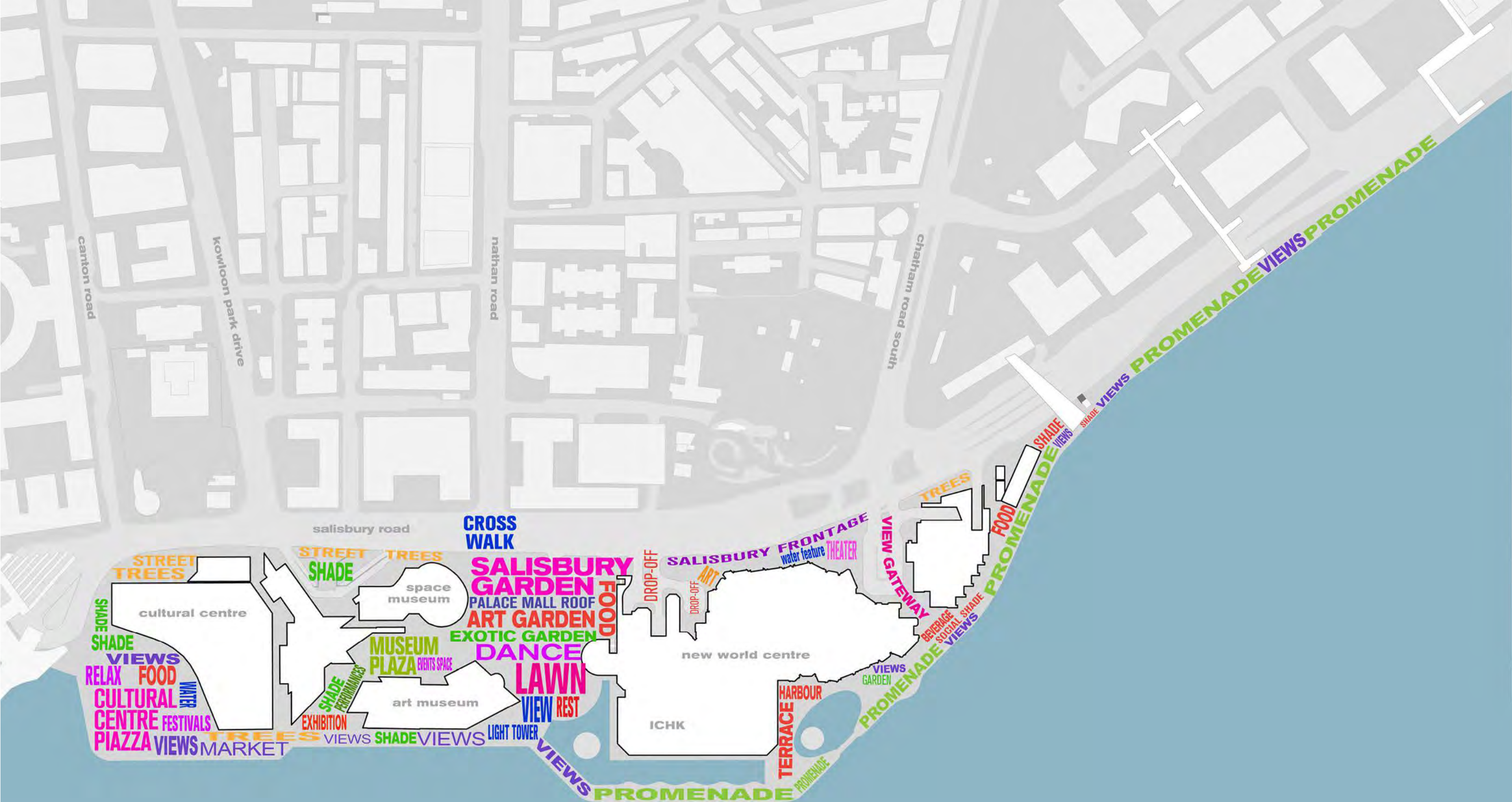

# POTENTIAL PROGRAMS

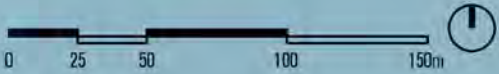

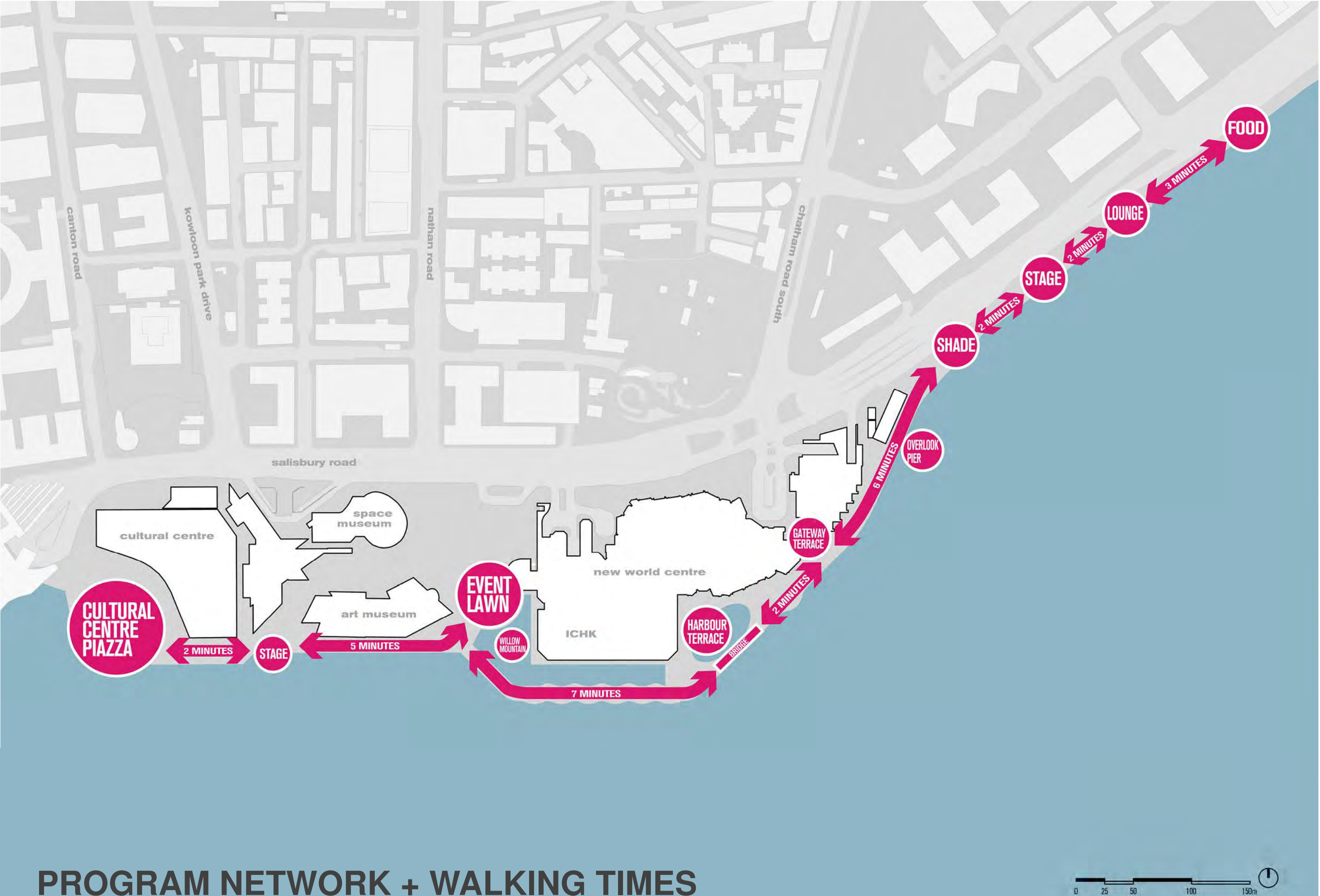

PROGRAM NETWORK + WALKING TIMES

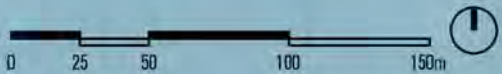



# PUBLIC REALM ENHANCEMENT

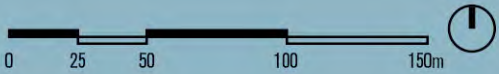

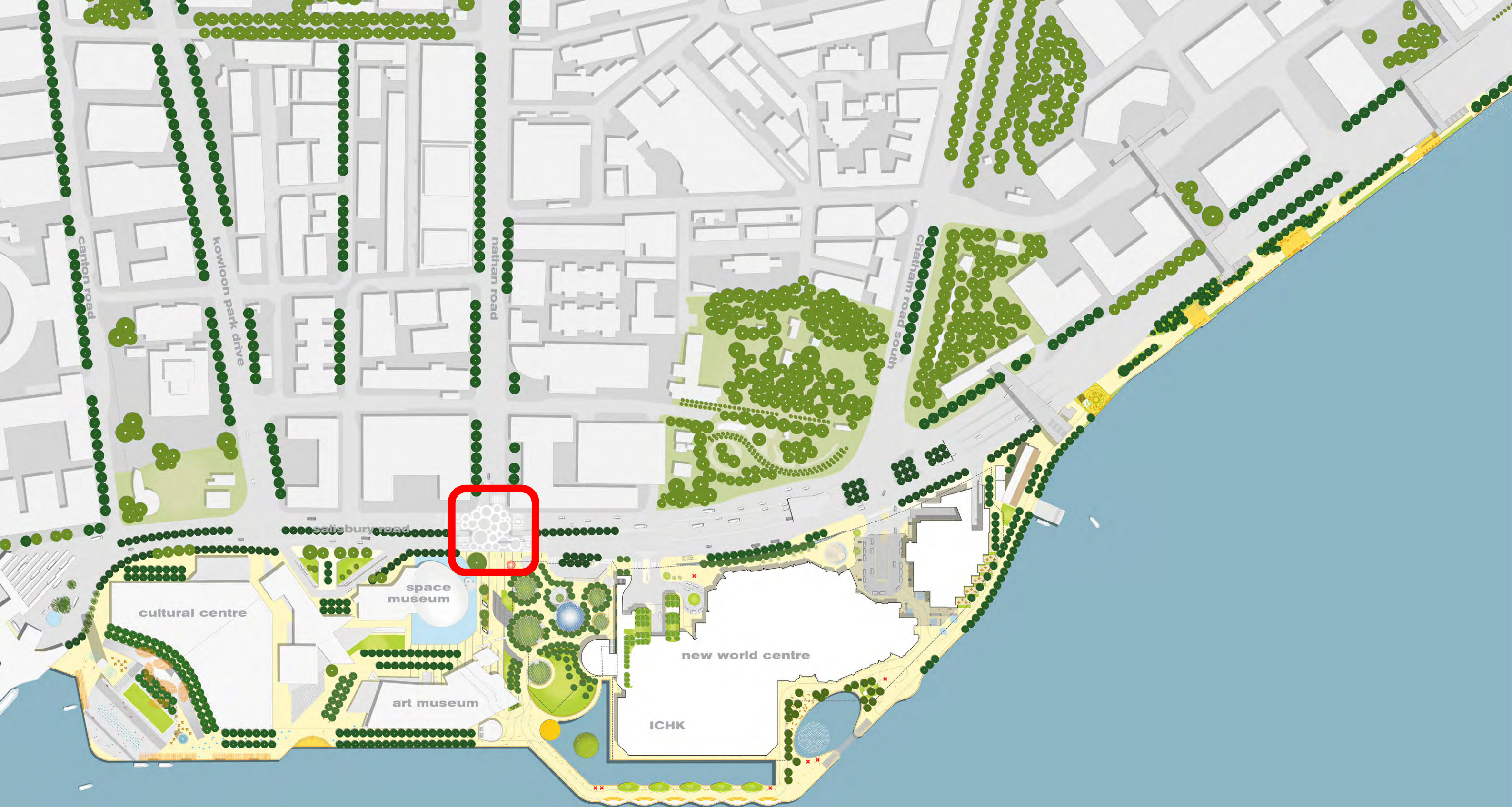

# PUBLIC REALM ENHANCEMENT – CROSSING

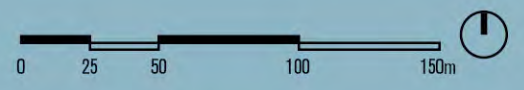

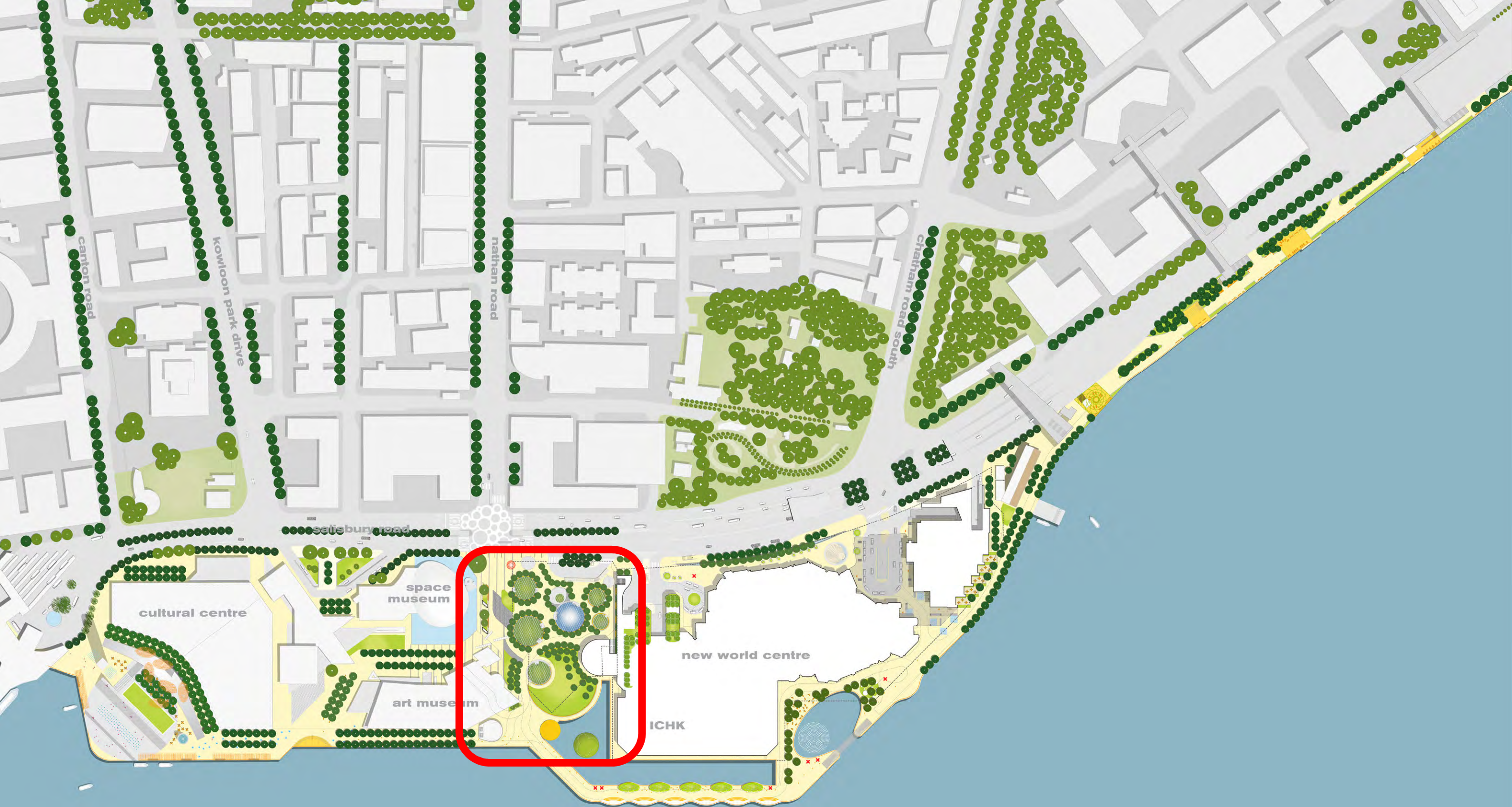

PUBLIC REALM ENHANCEMENT – SALISBURY GARDEN

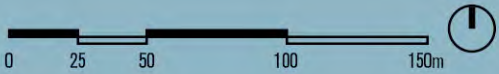



# PUBLIC REALM ENHANCEMENT – AVENUE OF STARS

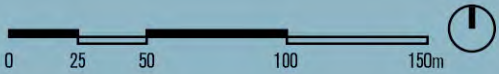

# RECONNECTING SALISBURY ROAD



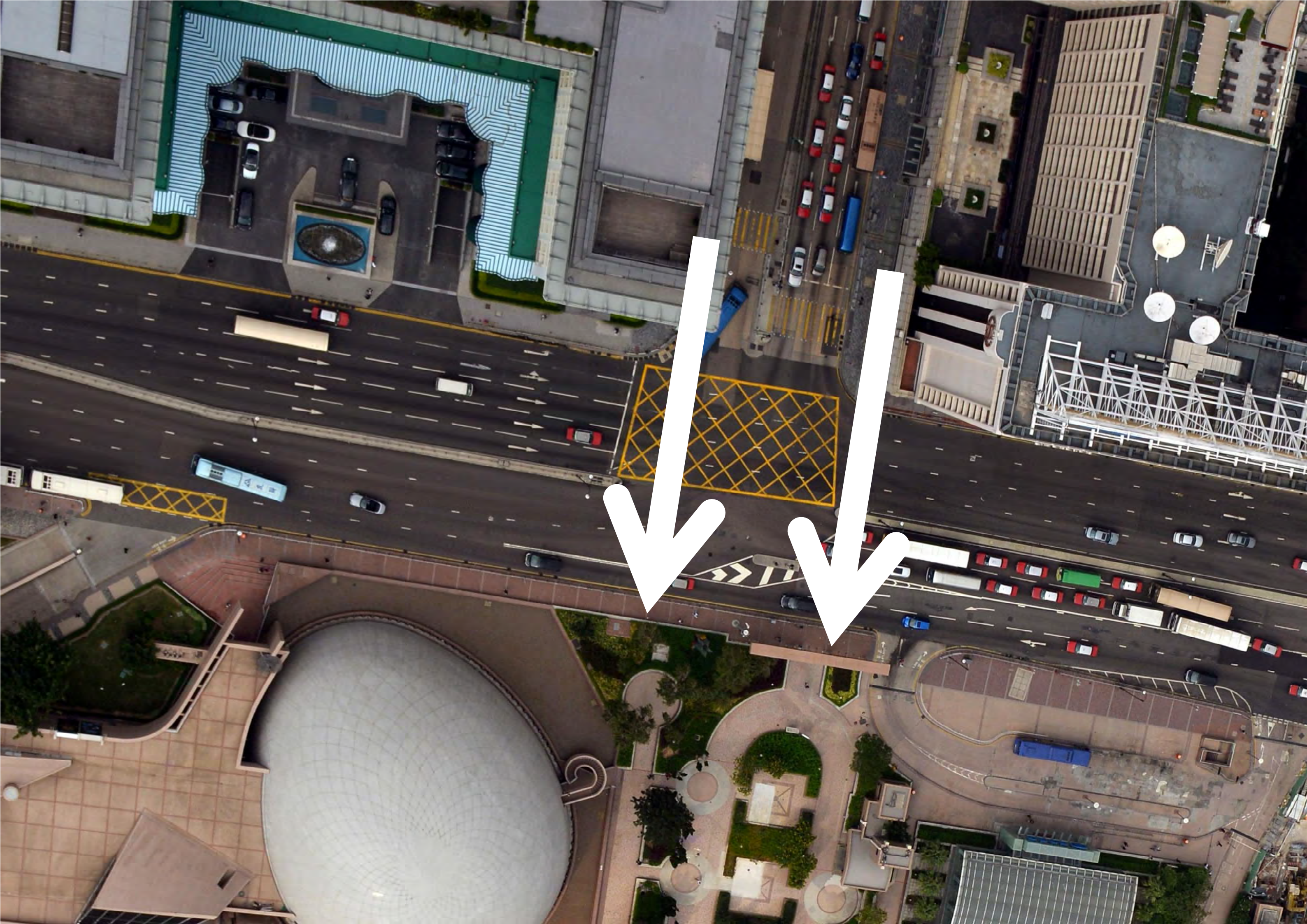



# CROSSWALKS





**DOUBLE-STRAIGHT CROSSING**

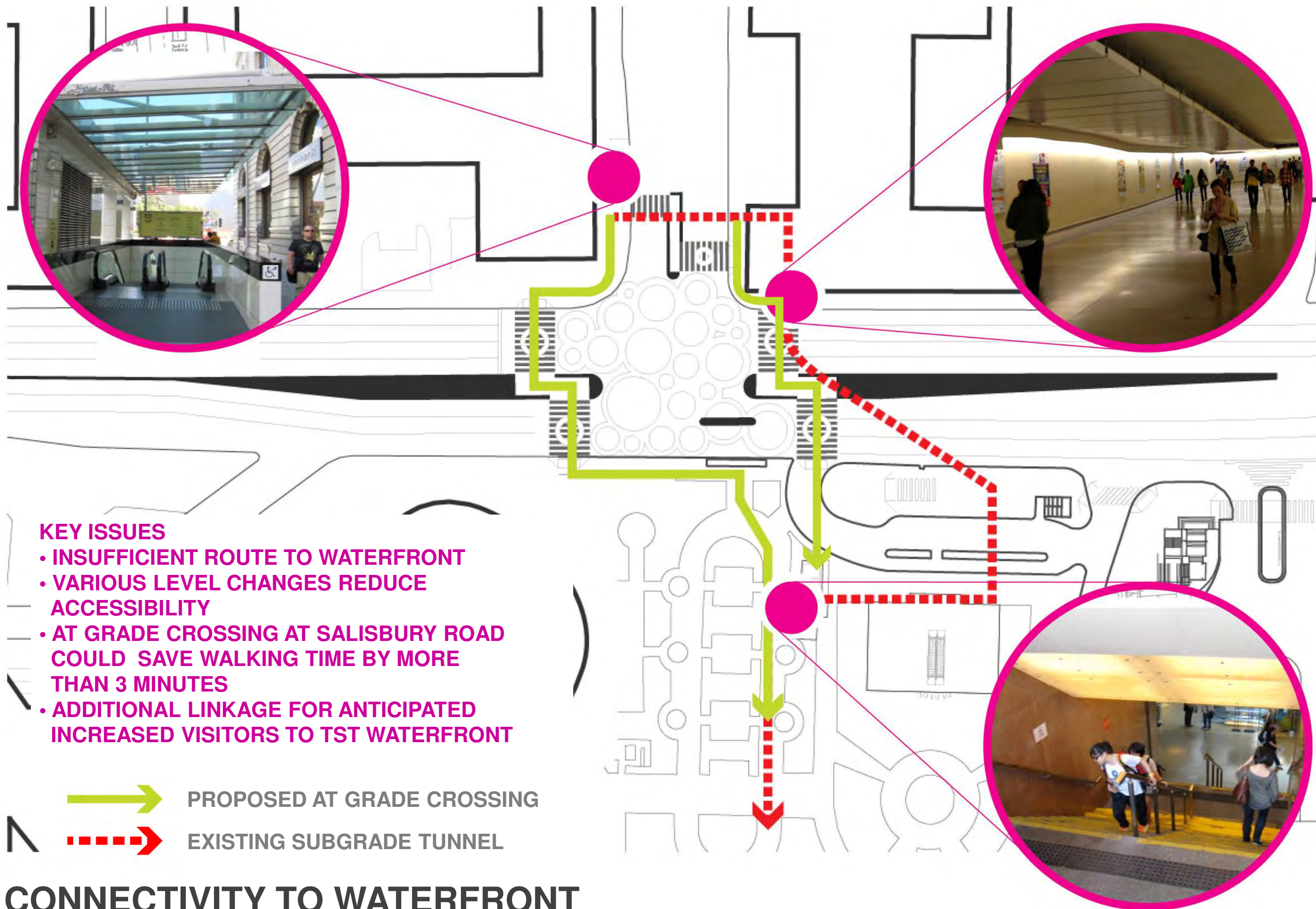

# PROVISION OF STAGGERED CROSSING 設置分段過路處

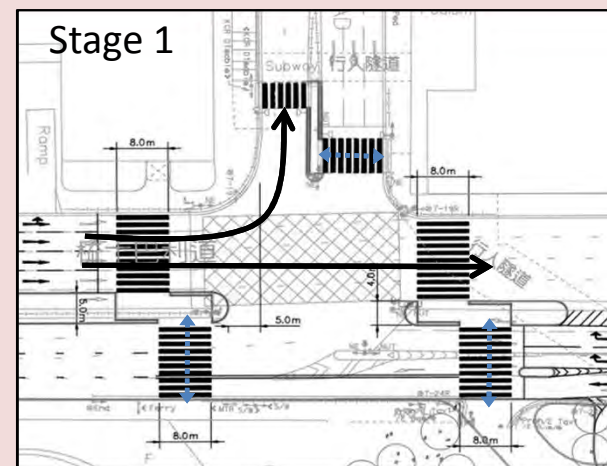

30 seconds

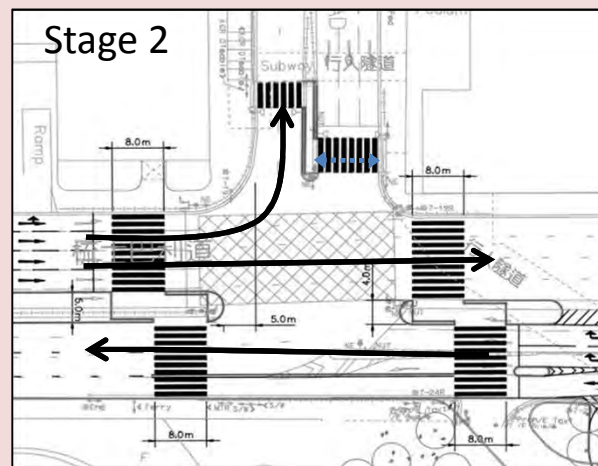

25 seconds

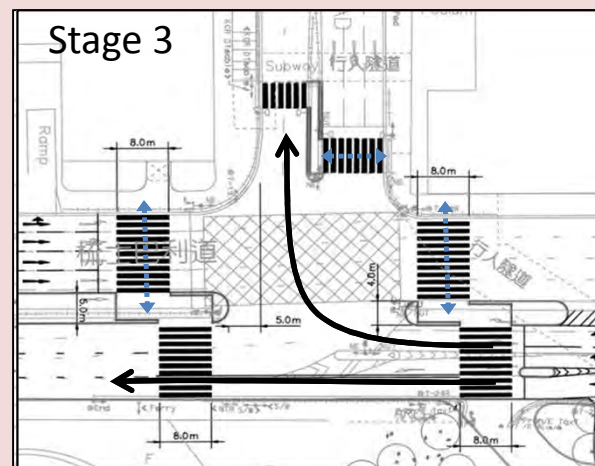

35 seconds

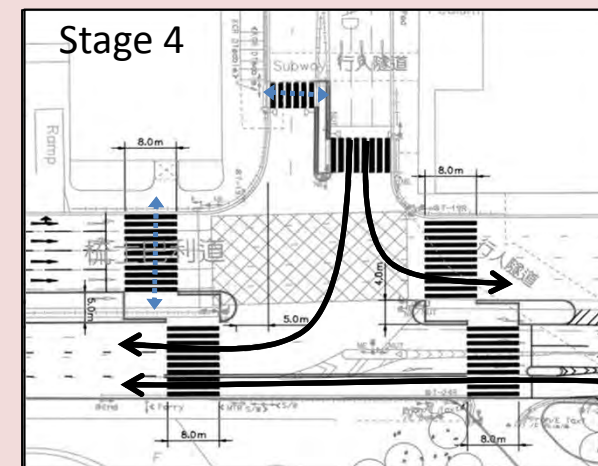

40 seconds

## Pros:

- Positive junction reserve capacity could be maintained
- Shorter vehicular waiting time for Salisbury Road westbound

## Considerations:

- Reduction by 1 lane at Salisbury Road eastbound

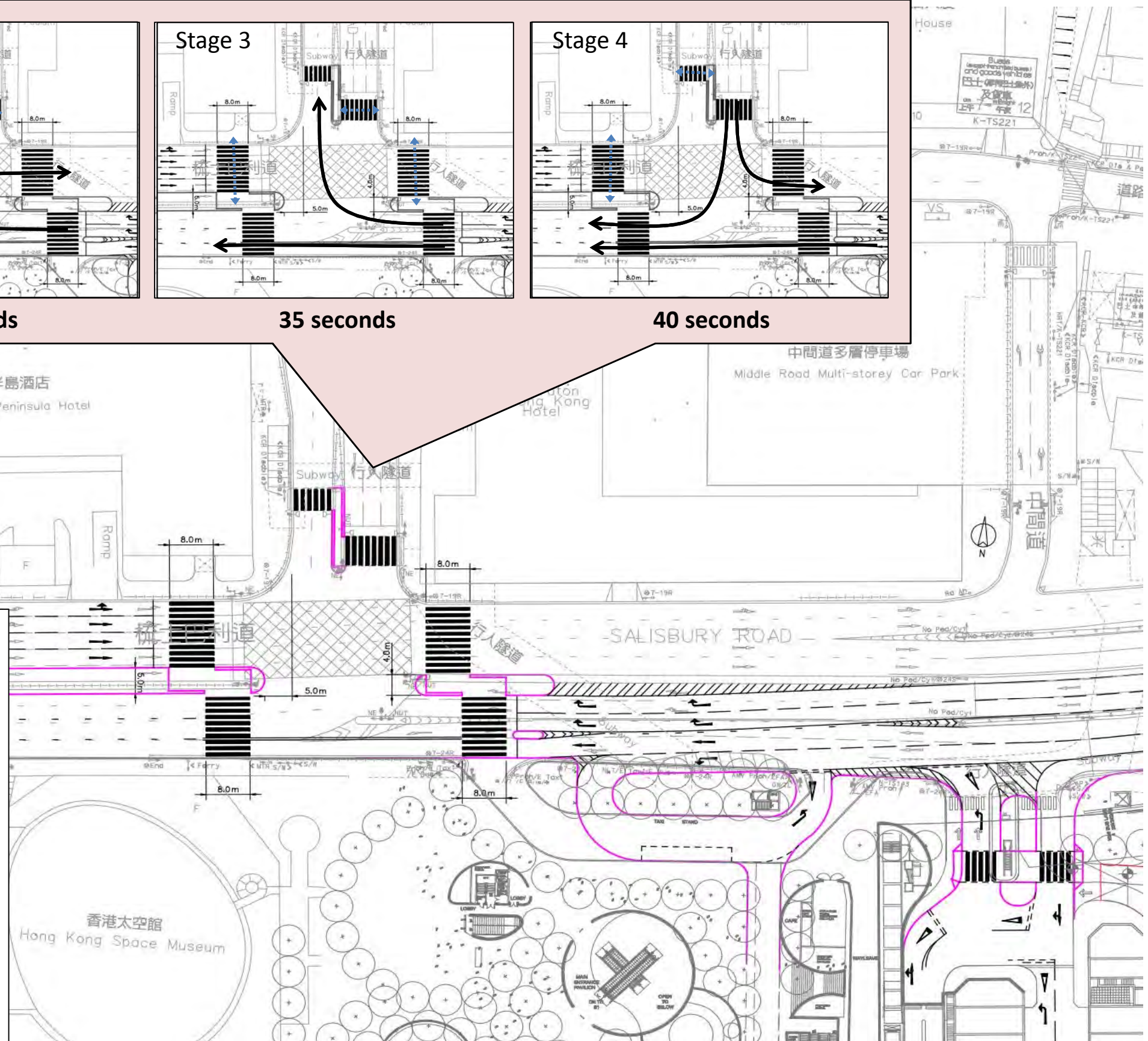

## STAGE 1 / 30 SECONDS

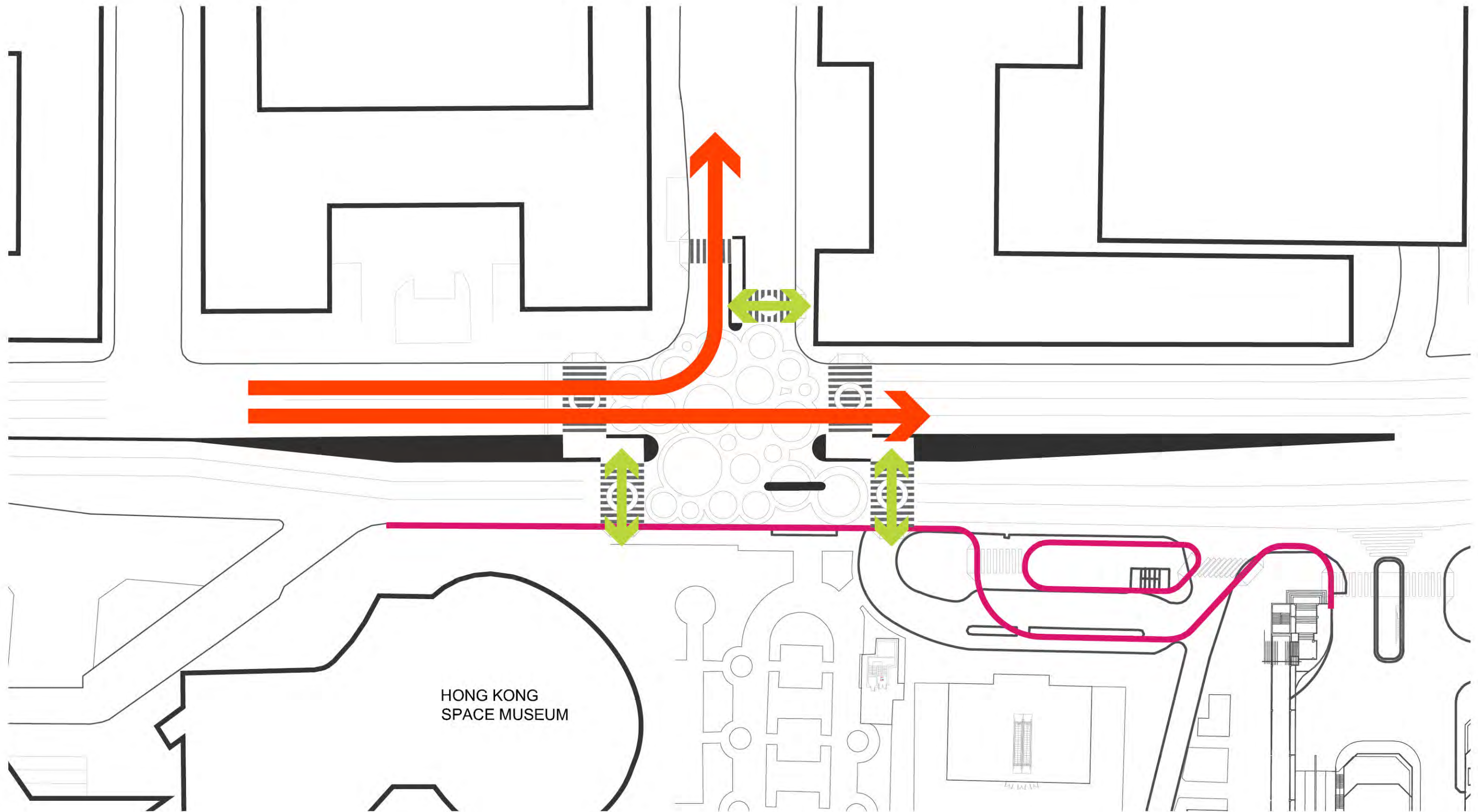

## PROVISION OF STAGGER CROSSING

**STAGE 2 / 25 SECONDS**

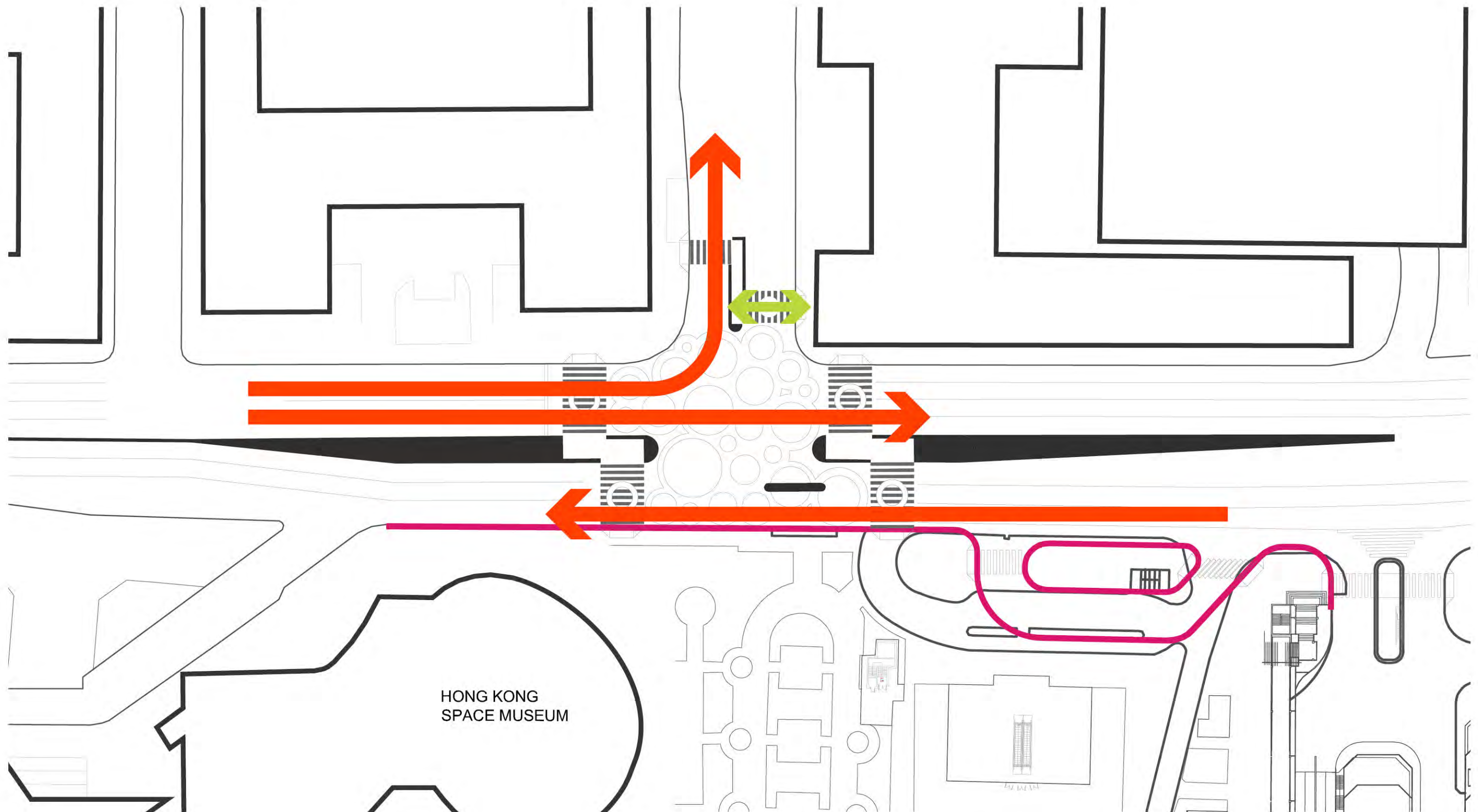

**PROVISION OF STAGGER CROSSING**

## STAGE 3 / 35 SECONDS

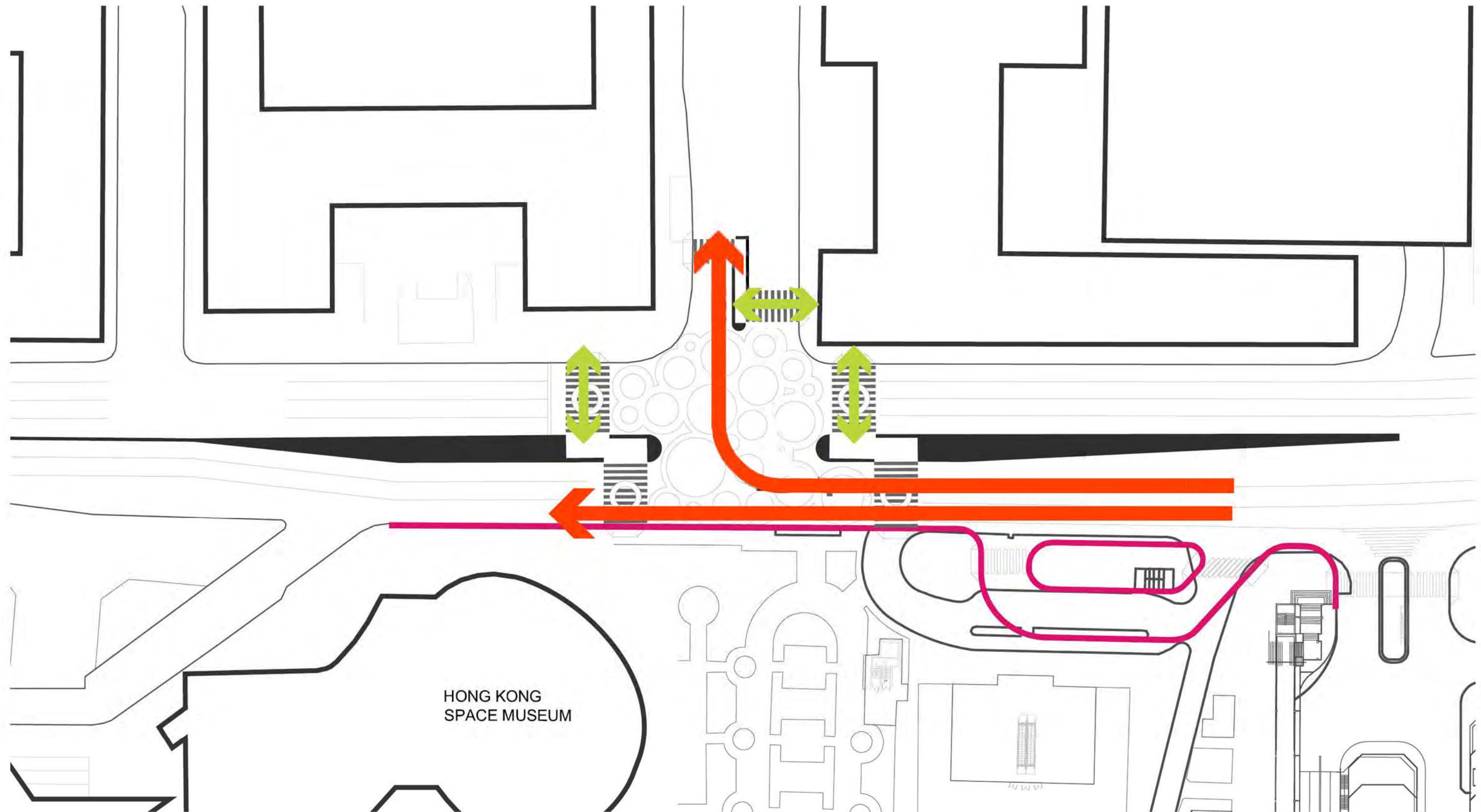

## PROVISION OF STAGGER CROSSING

## STAGE 4 / 40 SECONDS

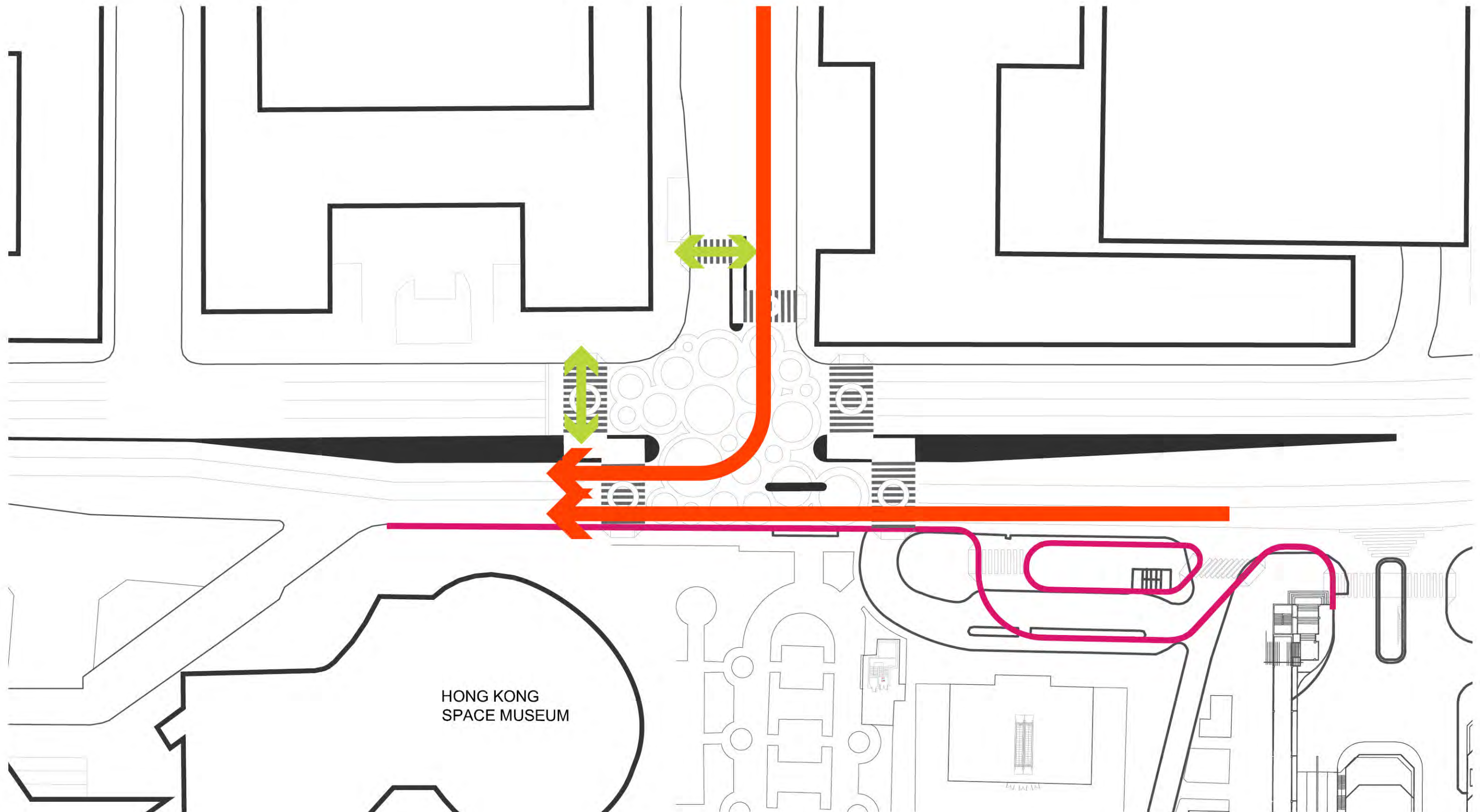

## PROVISION OF STAGGER CROSSING

# PROVISION OF STAGGERED CROSSING 設置分段過路處

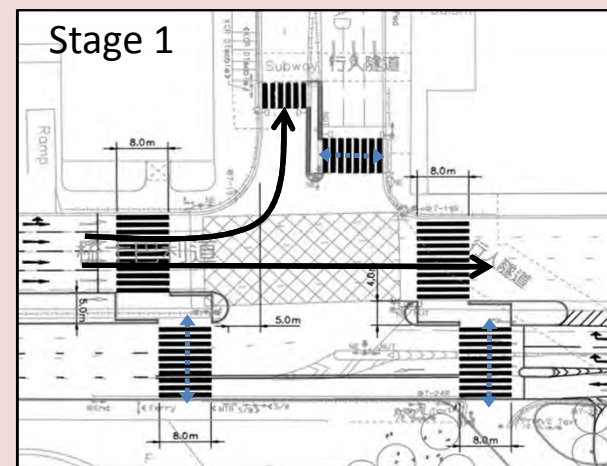

30 seconds

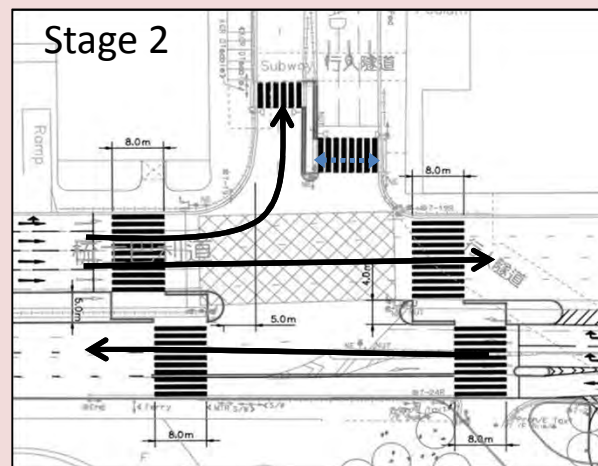

25 seconds

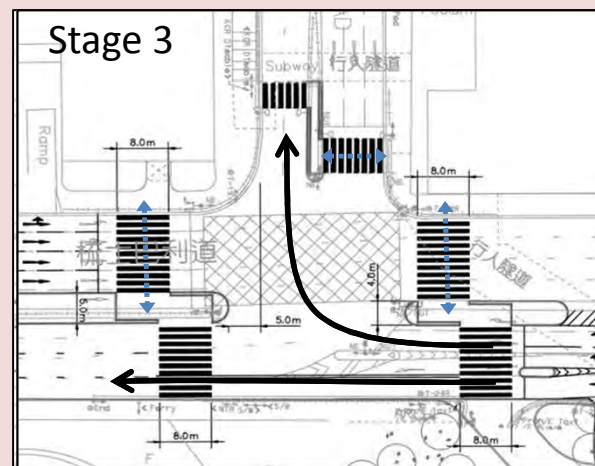

35 seconds

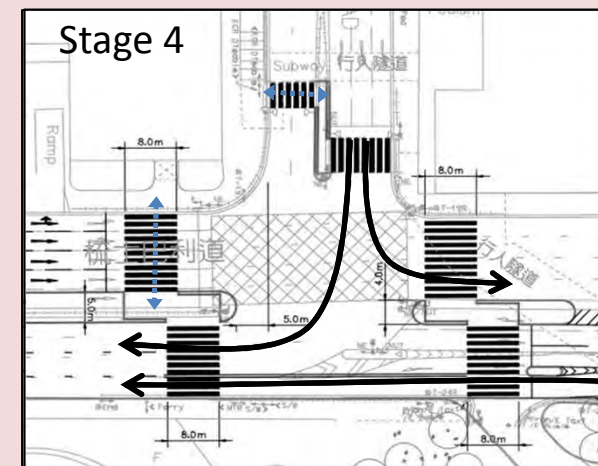

40 seconds

## Pros:

- Positive junction reserve capacity could be maintained
- Shorter vehicular waiting time for Salisbury Road westbound

## Considerations:

- Reduction by 1 lane at Salisbury Road eastbound

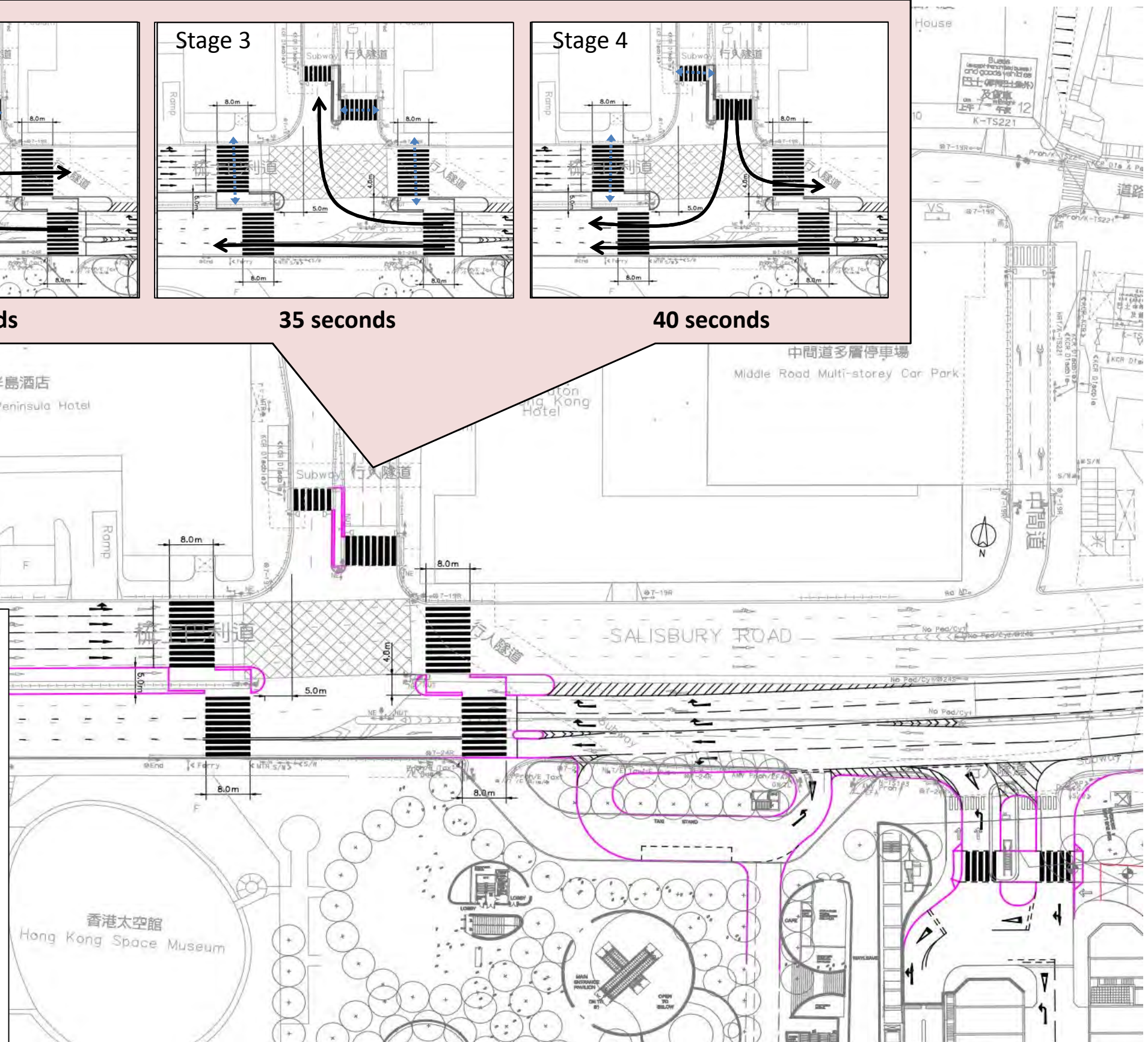

**REHABILITATE SALISBURY GARDENS**

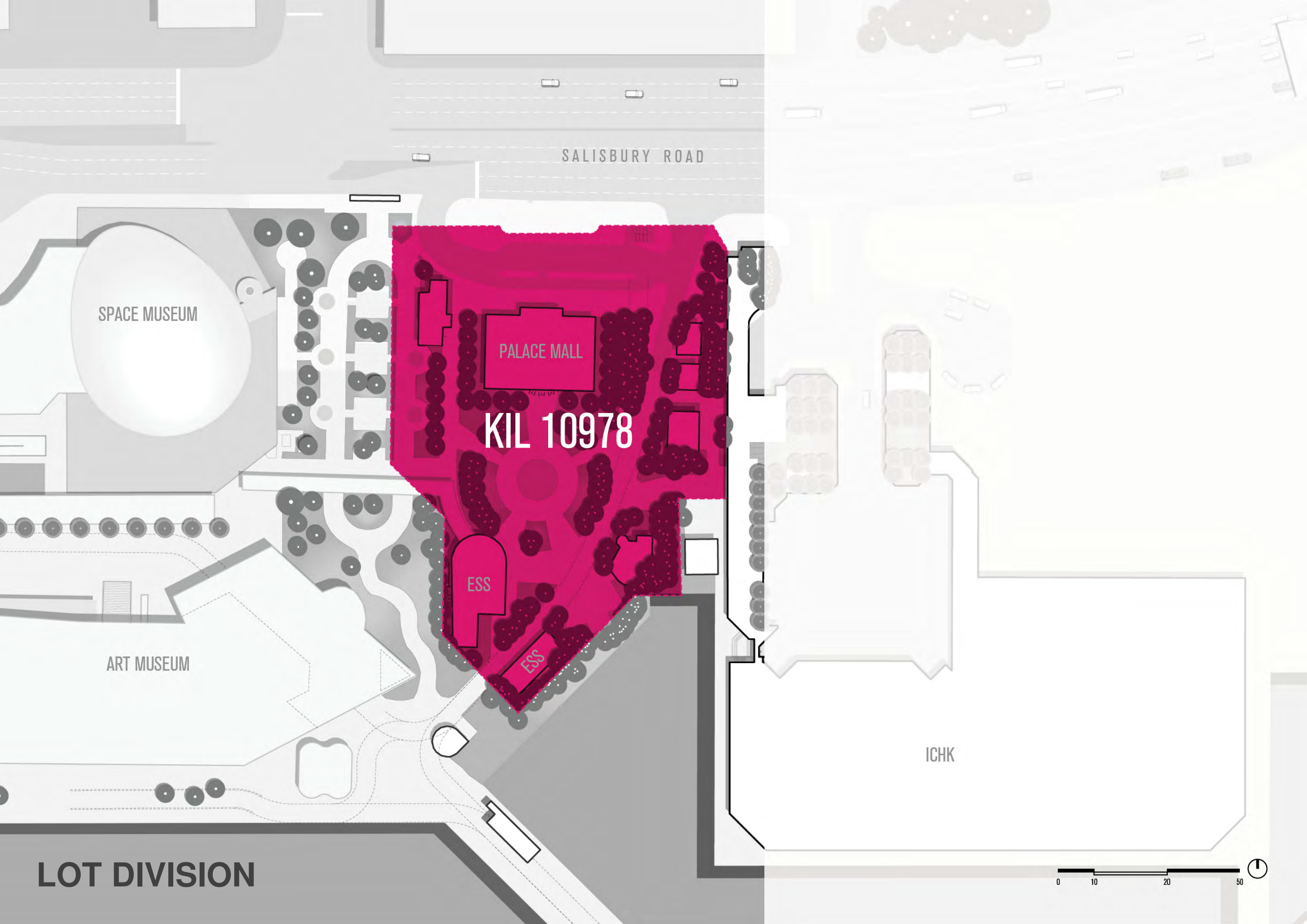

SALISBURY ROAD

SPACE MUSEUM

PALACE MALL

KIL 10978

ESS

ESS

ART MUSEUM

ICHK

LOT DIVISION

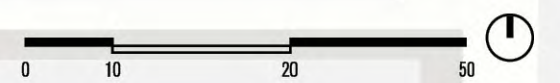



SALISBURY ROAD

SPACE MUSEUM

PALACE MALL

ESS

ESS

ICHK

ART MUSEUM

EXISTING CONDITIONS

0 10 20 50



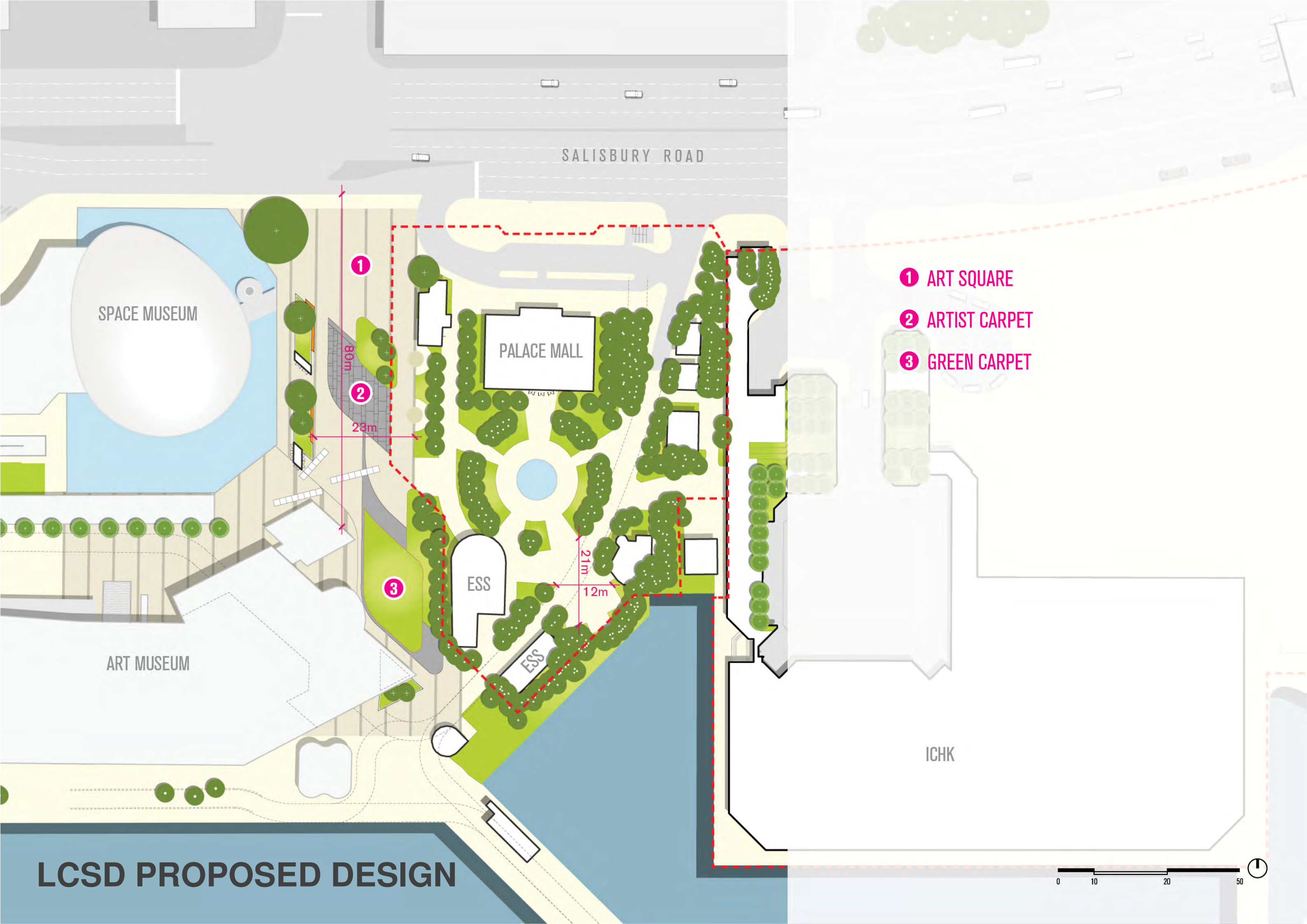

SALISBURY ROAD

SPACE MUSEUM

PALACE MALL

ESS

ESS

ICHK

ART MUSEUM

LCSD PROPOSED DESIGN

- 1 ART SQUARE
- 2 ARTIST CARPET
- 3 GREEN CARPET

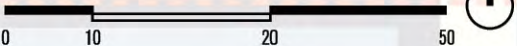



1 SALISBURY ROAD CROSSWALK

2 MEDIA BEACON

3 ART SQUARE

4 EGRESS MOUND

5 SUNKEN GARDEN

6 PALACE MALL ENTRY

7 UTILITY MOUND

8 UTILITY MOUND

9 ARTIST CARPET

10 CAFE / EGRESS

11 CAFE / EGRESS

12 GREEN CARPET

13 EVENT LAWN

14 THE STAGE

15 OBSERVATION DECK

16 WILLOW MOUNTAIN

JCFO + LCSD HYBRID

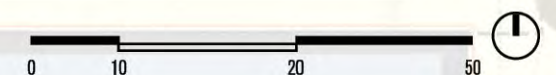

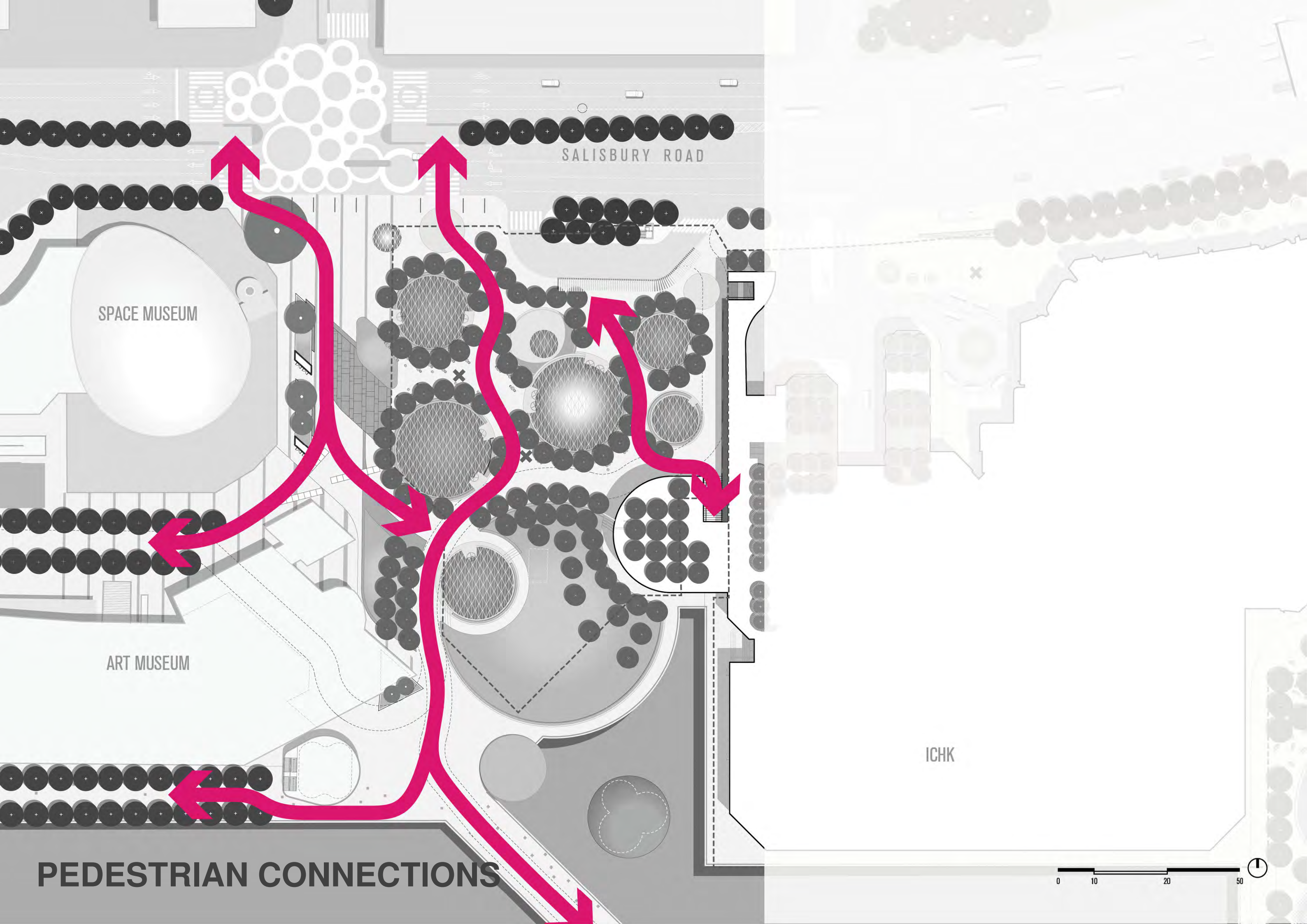

SALISBURY ROAD

SPACE MUSEUM

ART MUSEUM

ICHK

PEDESTRIAN CONNECTIONS

0 10 20 50



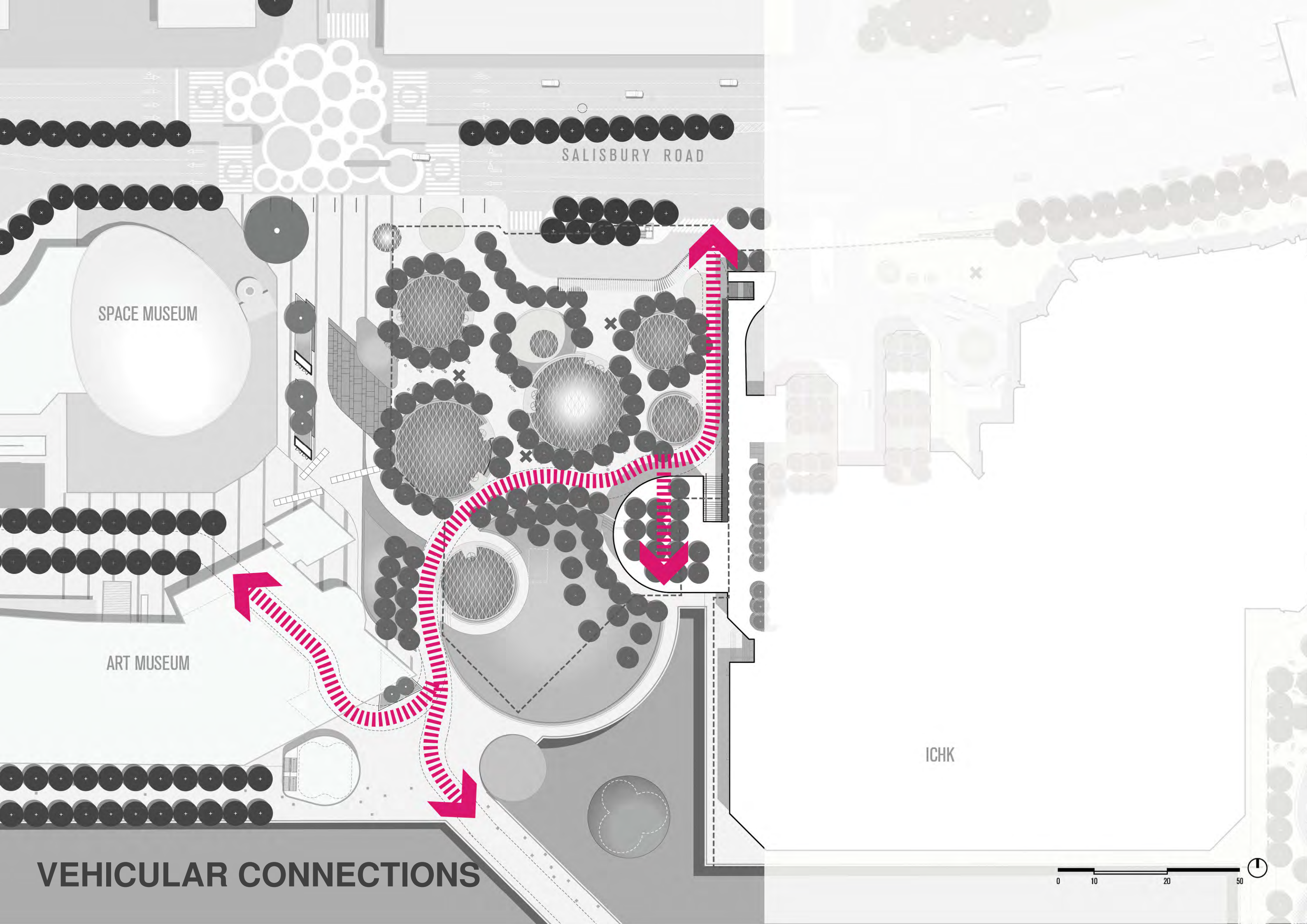

SALISBURY ROAD

SPACE MUSEUM

ART MUSEUM

ICHK

VEHICULAR CONNECTIONS

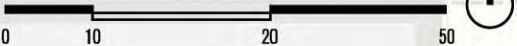

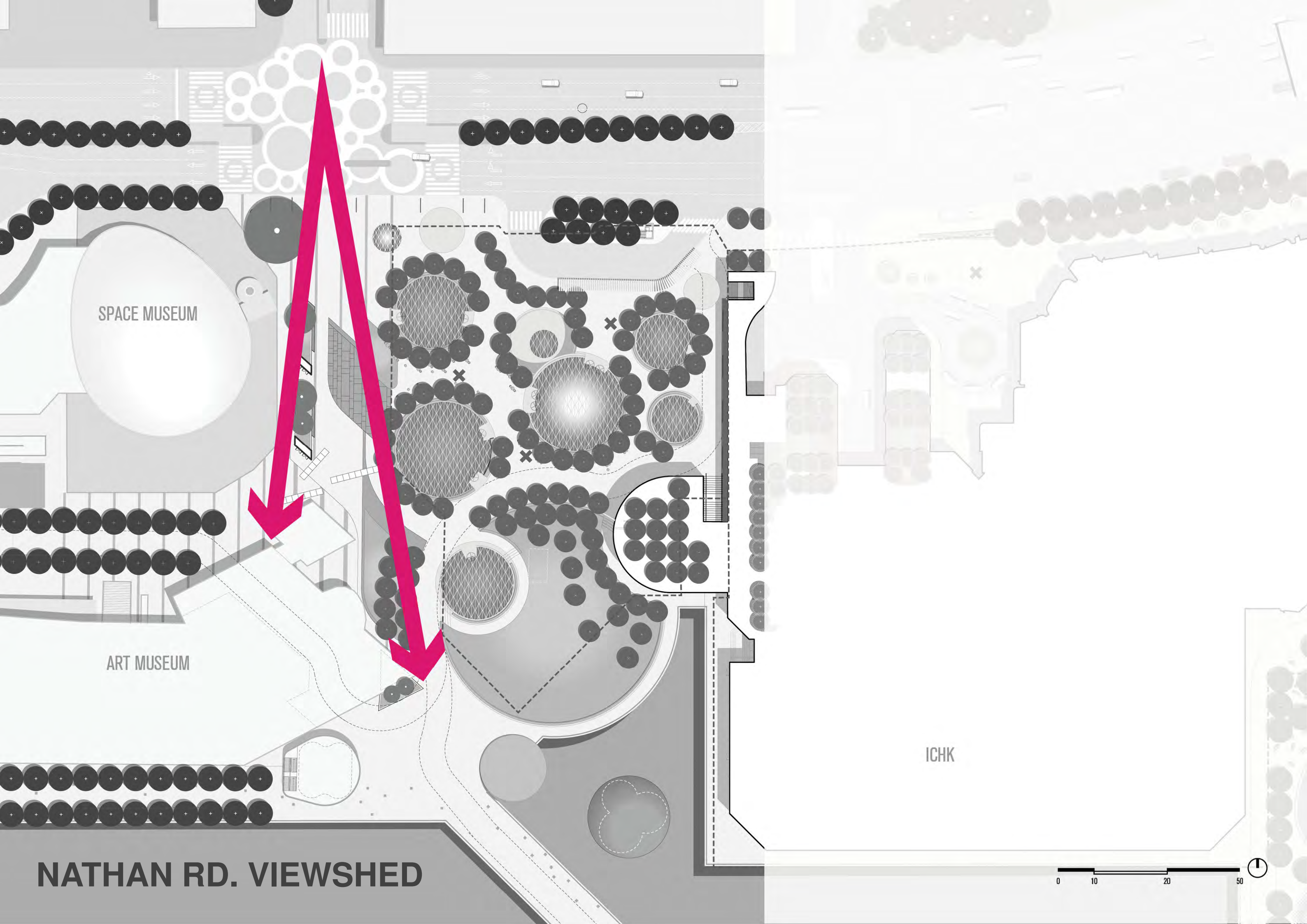

SPACE MUSEUM

ART MUSEUM

ICHK

NATHAN RD. VIEWSHED

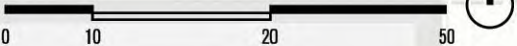







**REJUVENATE THE AVENUE OF THE STARS**



**EXISTING INNER WATER BODY AT AOS**

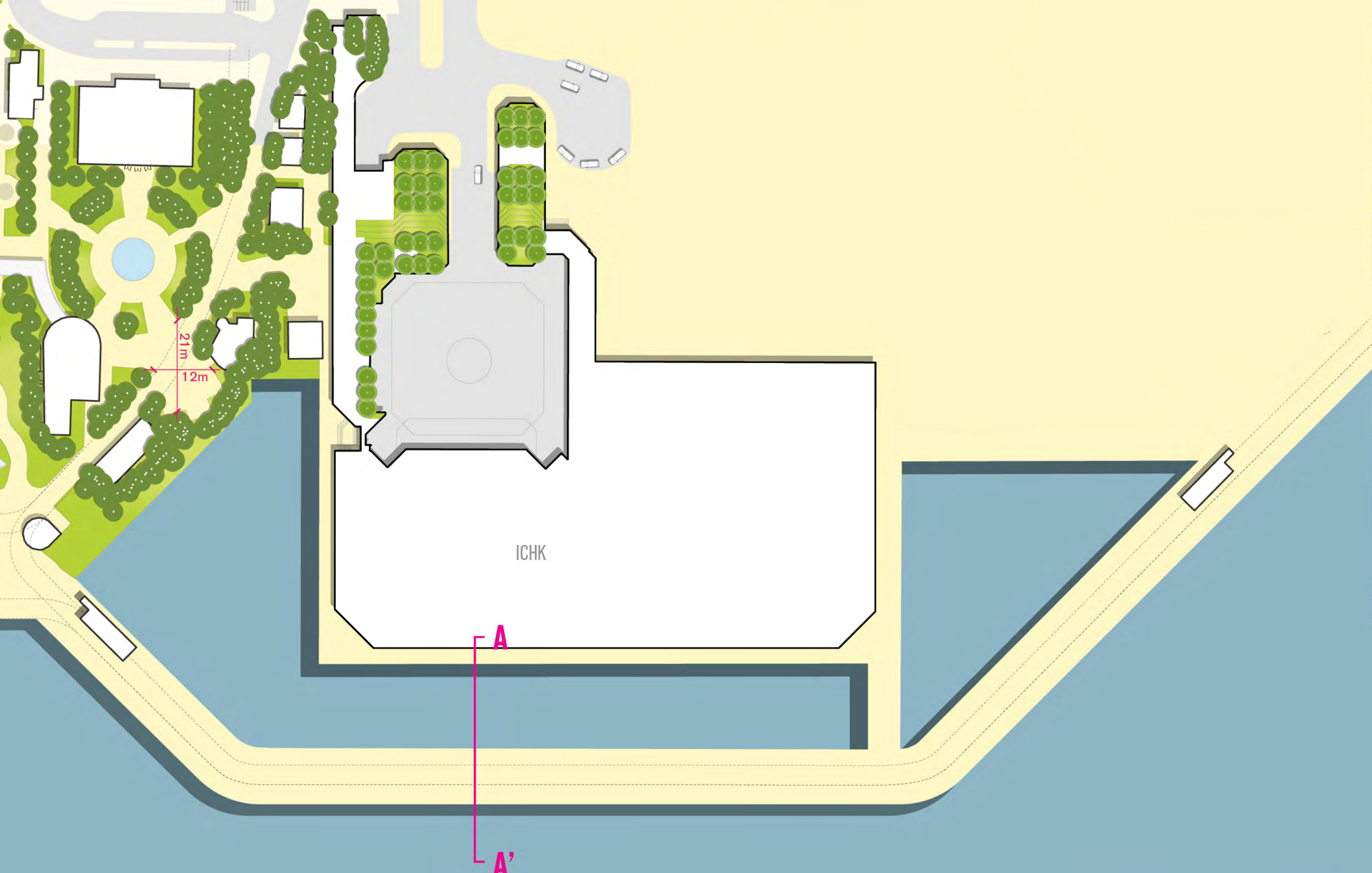

EXISTING AOS PROMENADE

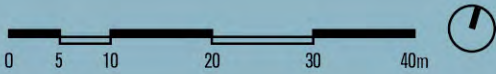



NEW WORLD CENTRE

ICHK

A

A'

EVA

EXISTING AOS EDGE

KEY :

- 1 WILLOW MOUNTAIN
- 2 SHADE STRUCTURE
- 3 SUPER STAR BALCONY
- 4 EVENT PLAZA
- 5 LANDMARK WATER FEATURE
- 6 HARBOUR TERRACE
- 7 ARK BRIDGE
- 8 EVENT LOUNGE BOSQUE

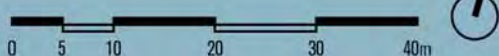

# PROPOSED AOS PROMENADE



**AOS AXON STUDY**

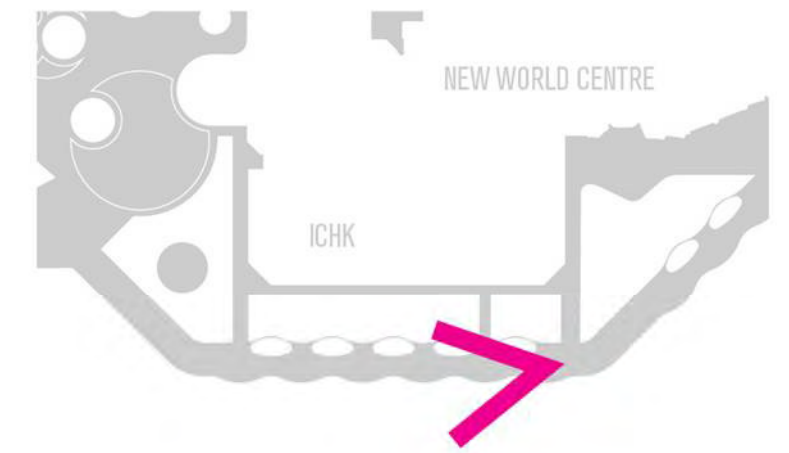

**EAST ESPLANADE**



EAST ESPLANADE EXISTING PLAN





# EAST ESPLANADE PROPOSED PLAN SELECTED / TARGETED ENHANCEMENTS





# THEATER ROOM





## SHADE ROOM



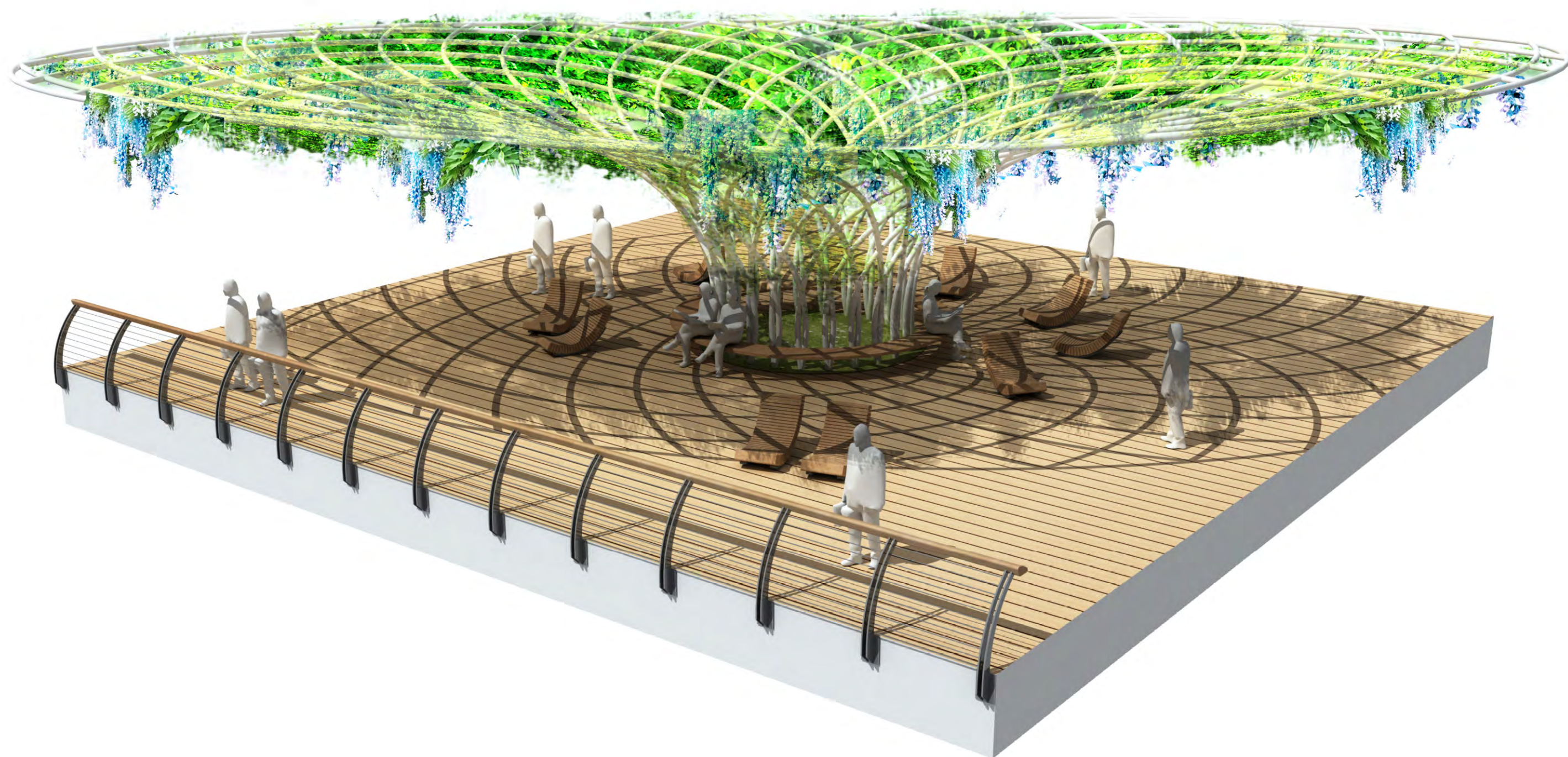

SHADE ROOM

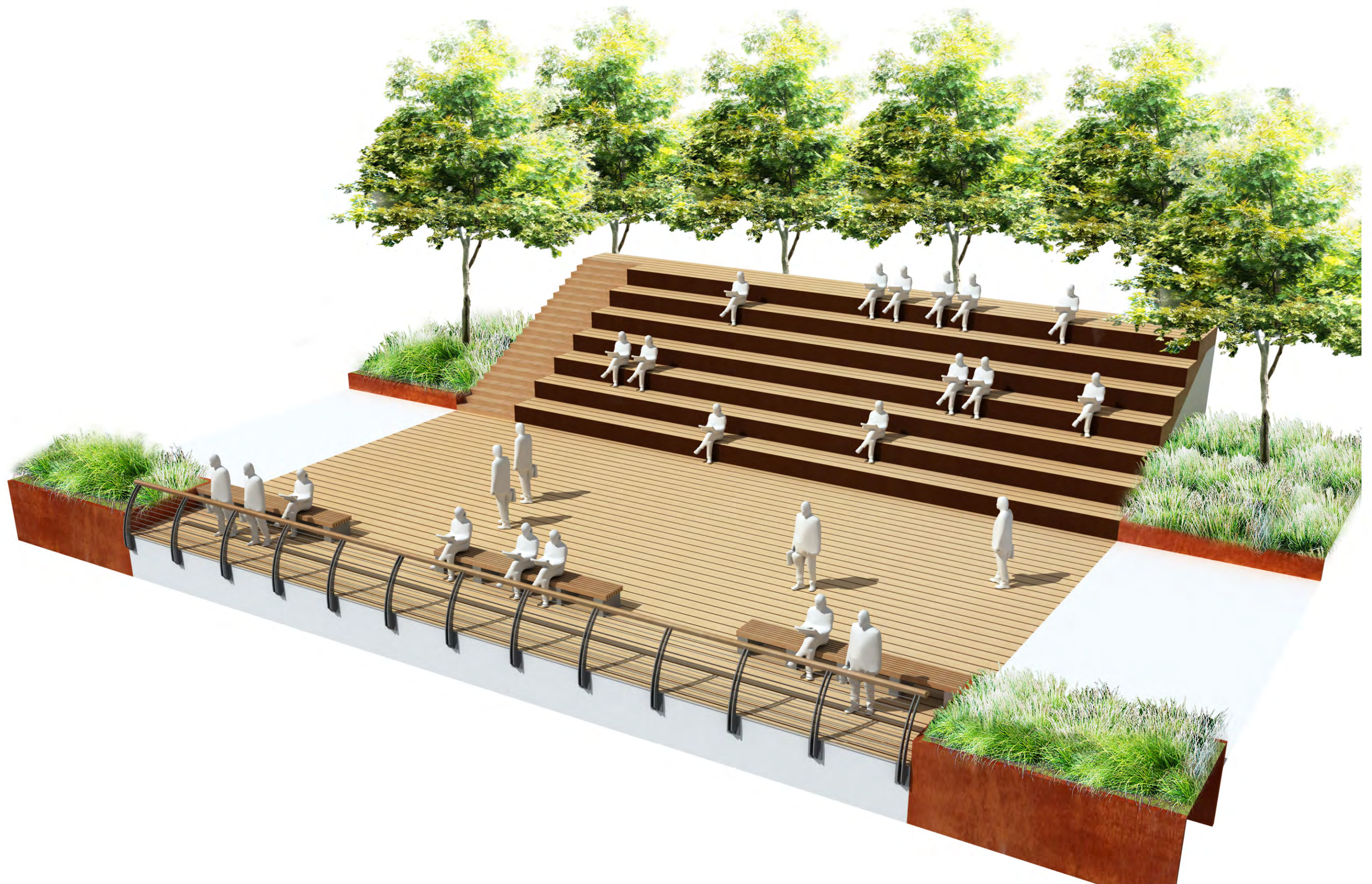

THEATER ROOM



## LOUNGE ROOM



**CULTURAL CENTRE PIAZZA**



## CULTURAL PIAZZA







Composition/Sketches//View from Lawn/





# A HOLISTIC VISION FOR THE WATERFRONT



## PUBLIC REALM ENHANCEMENT

