

Landscaped Deck above Kwun Tong Sewage Pumping Station

觀塘污水泵房上蓋園境平台

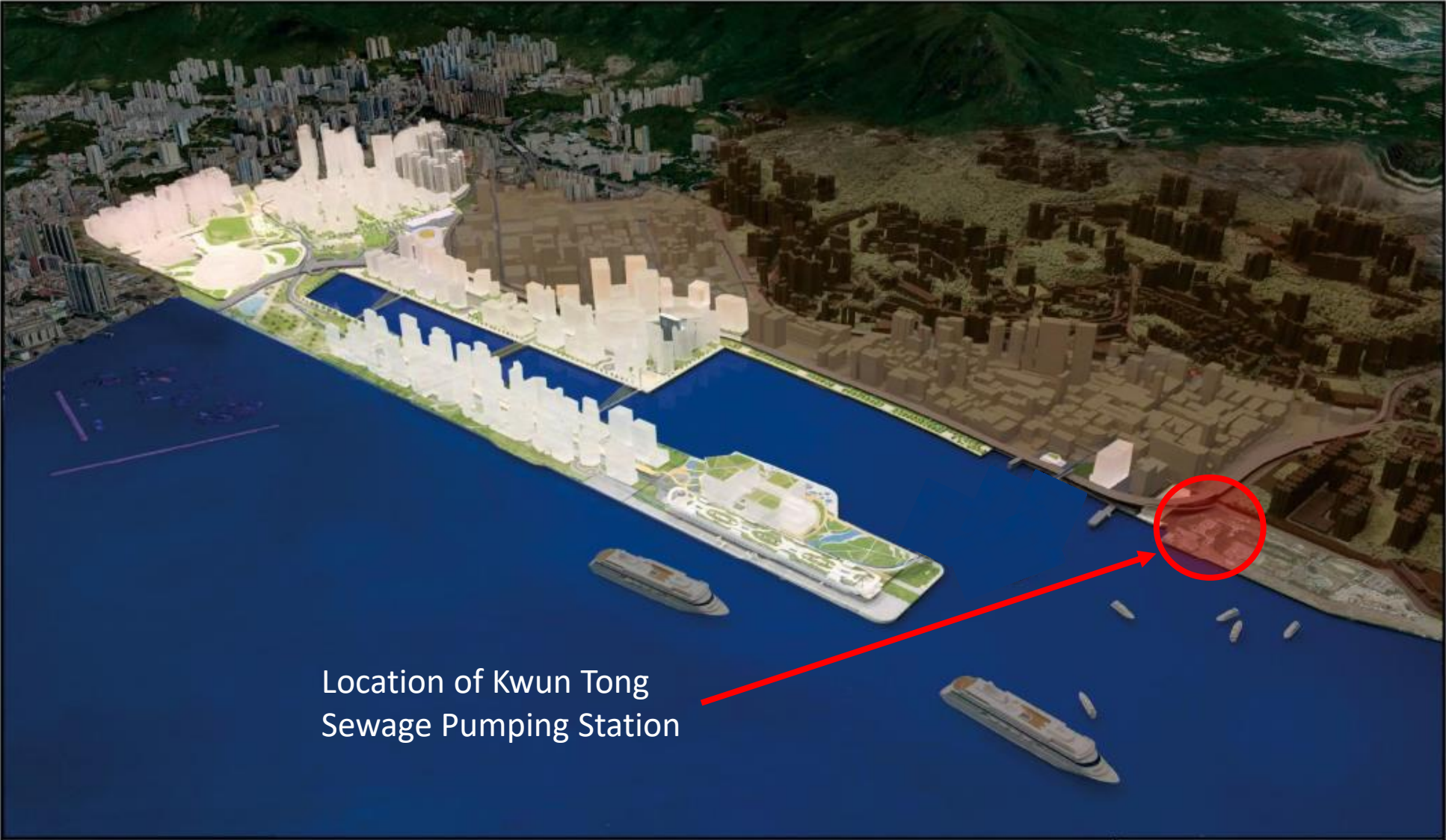

Location Plan



Location of Kwun Tong Sewage Pumping Station

Location Plan

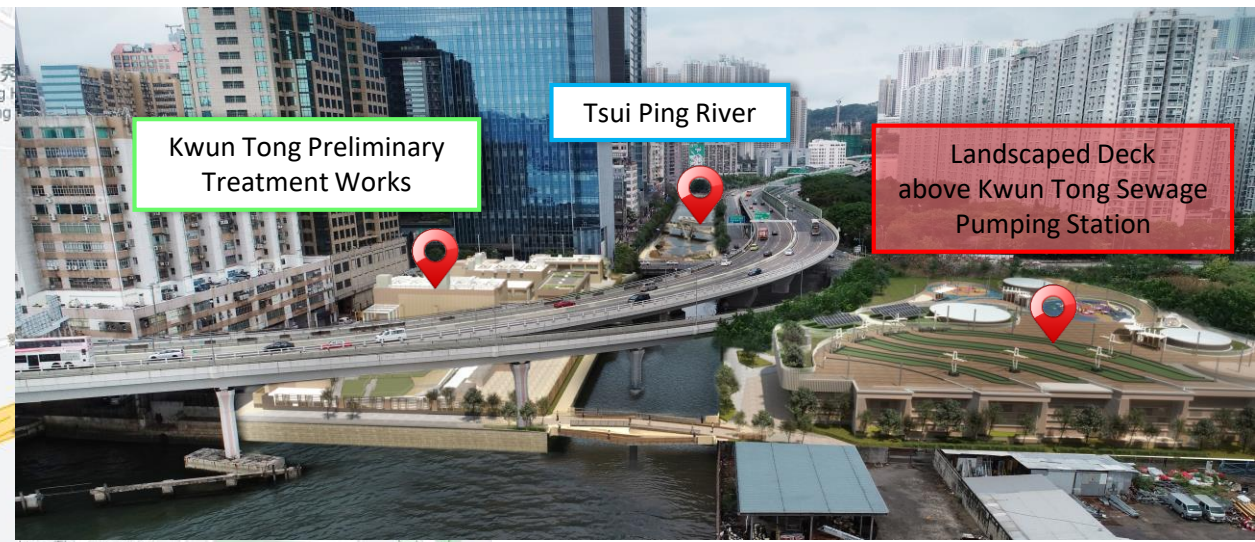

- Kwun Tong Preliminary Treatment Works
- Tsui Ping River
- Landscaped Deck above Kwun Tong Sewage Pumping Station

Connectivity

Footbridge by the project of Tsui Ping River

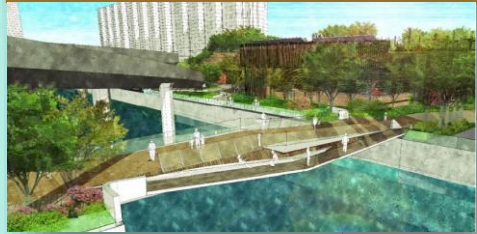

At-grade footpath beautification by the project of Tsui Ping River



Pedestrian crossing by the project of Tsui Ping River

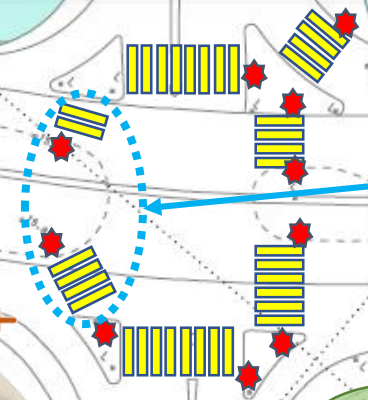

Victoria Harbour

Future connection point with promenade (lift or footbridge)

Future Promenade



-  Traffic Light
-  Pedestrian Crossing
-  Entrance (barrier-free)
-  Entrance (staircase)

Architectural & Landscape Design – View 1

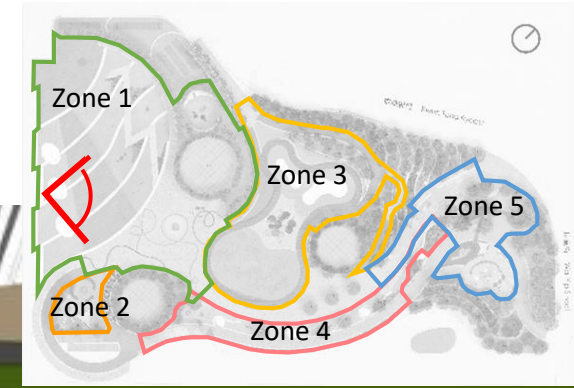

Architectural & Landscape Design – View 2



Architectural & Landscape Design – View 3

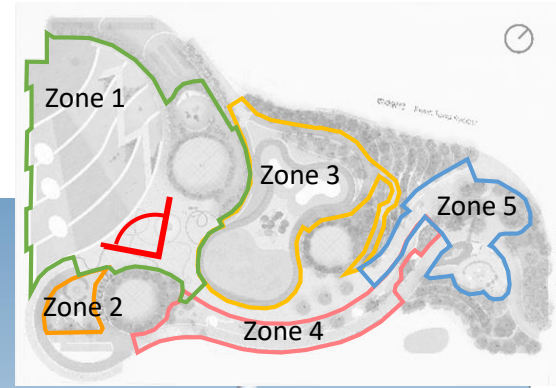

Architectural & Landscape Design – View 4



Architectural & Landscape Design – View 5



Architectural & Landscape Design – View 6

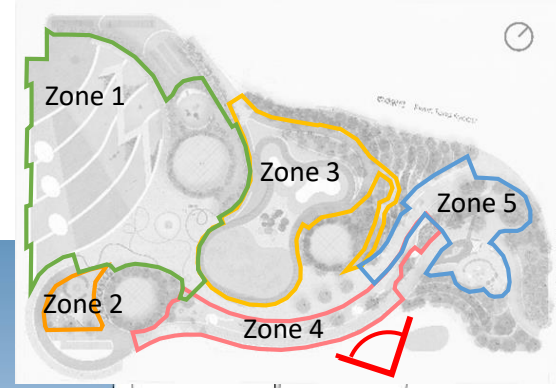

Section

Future Promenade to Main Entrance (Wai Yip Street)

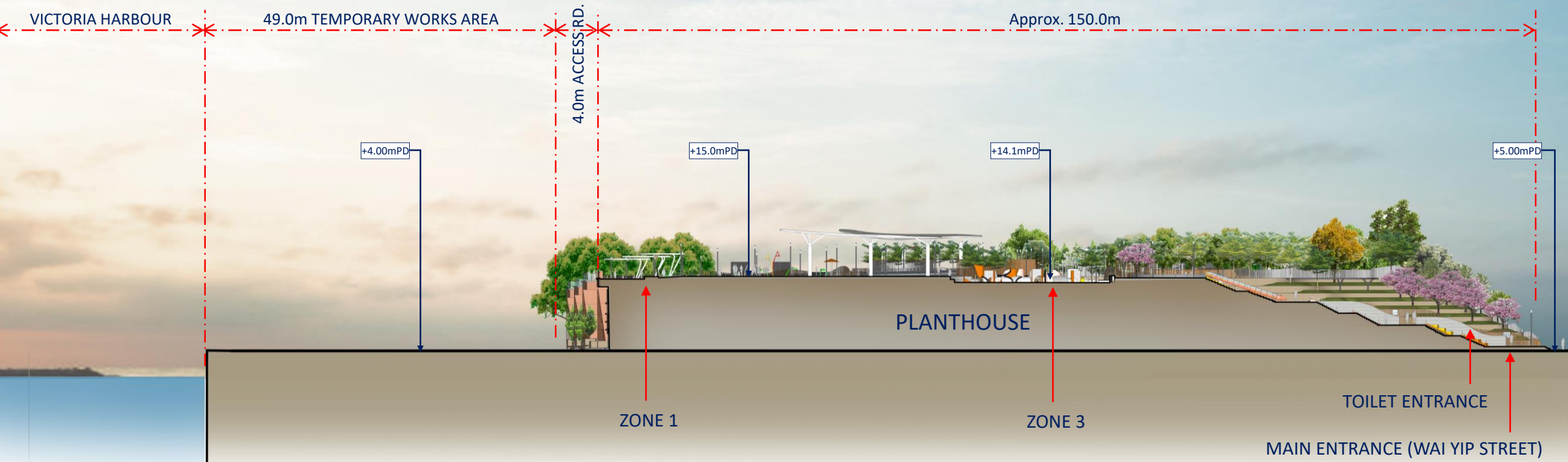
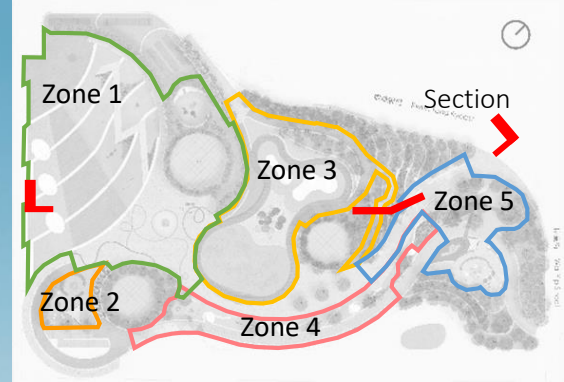

Supporting Facilities

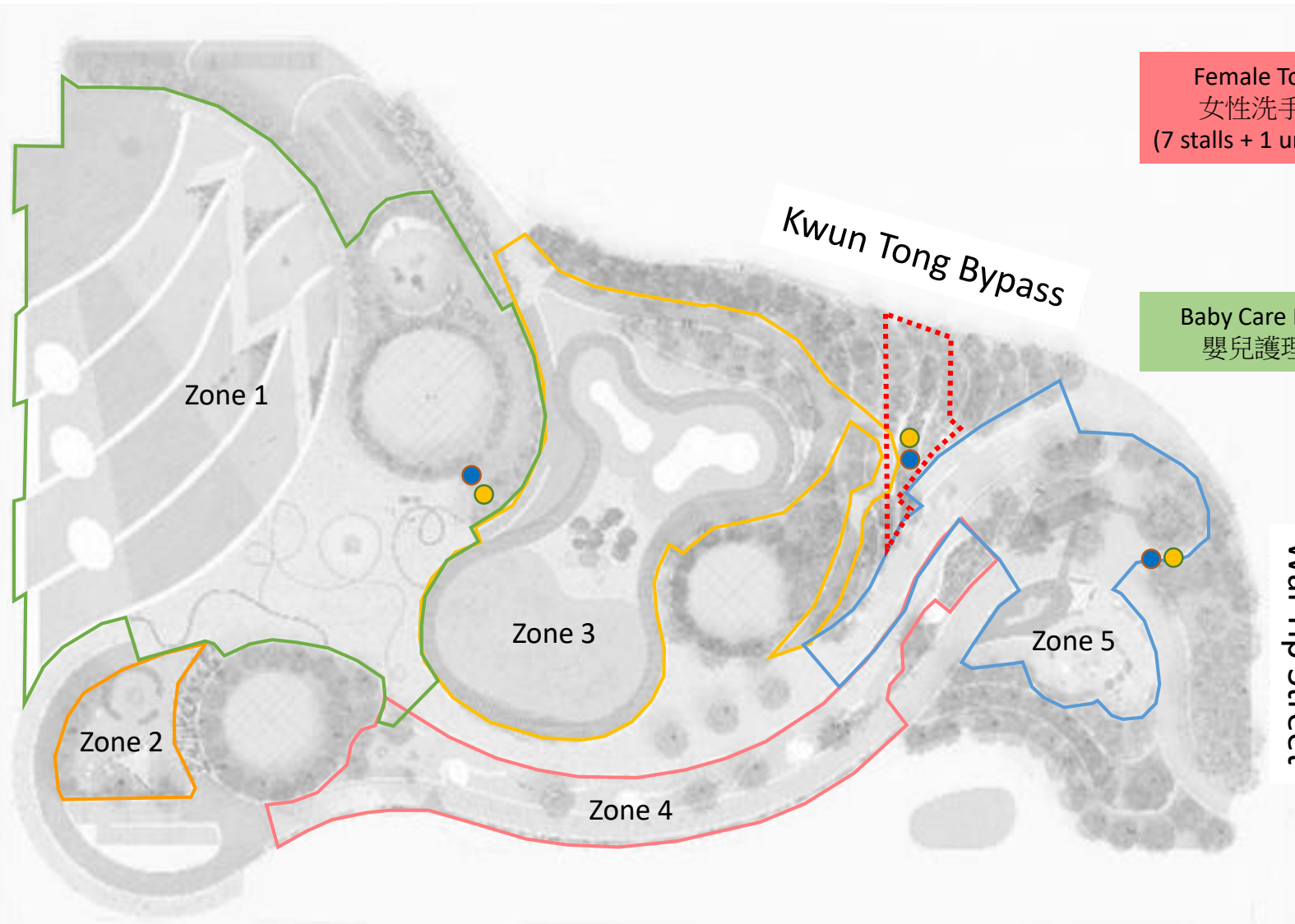

Female Toilet
女性洗手間
(7 stalls + 1 universal)

Baby Care Room
嬰兒護理室

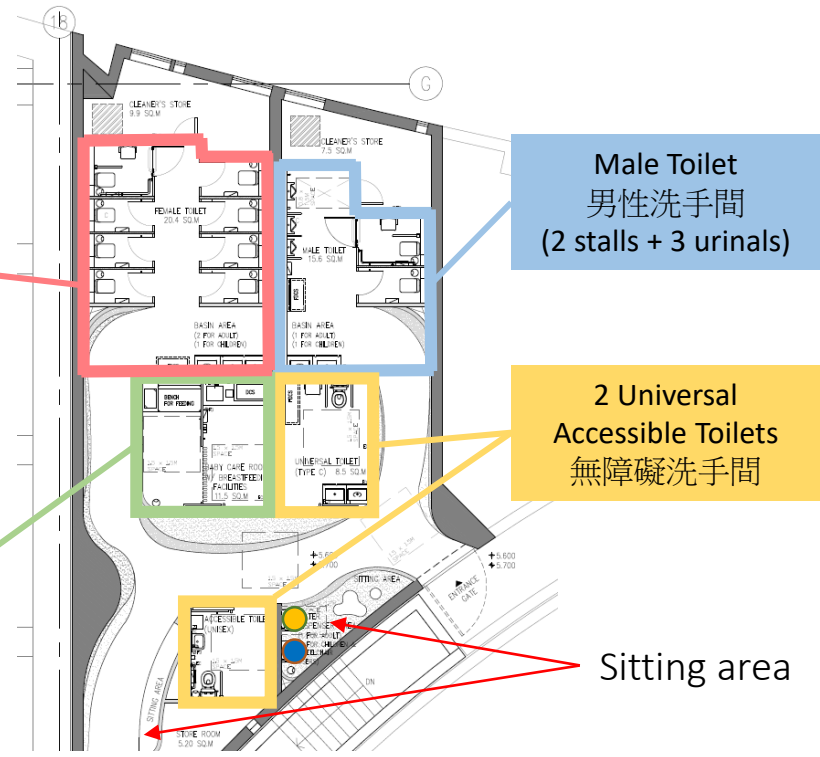

● Drinking Fountain

● Outdoor Basin

⋯ Toilet

Key Elements of Playful Nature

圖例 Legend

	01. 旋轉劇場 Family Amphitheater
Zone 1 (3178m ²)	02. 風搖搖 Land of the Breezy
	03. 大笪地 Pop-up plaza
	04. 秘密花園 Secret Garden
Zone 2 (282m ²)	05. 幼兒天地 Toddler Paradise
	06. 雲之躍動 The Clouds
	07. 綠遊遊 Embracing Green
Zone 3 (1865m ²)	08. 波浪木道 The Wooden Waves
	09. 渠管迷宮 Concrete Labyrinth
	10. 穿梭林跡 Into the Woods
	11. 光影聚 Shadow Gathering
Zone 4 (774m ²)	12. 健身小徑 Fitness Trail
	13. 彩虹隧道 Rainbow Tunnel
	14. 親樹平台 Forest Hunt
Zone 5 (881m ²)	15. 親水花園 Water Play Creek
	16. 生態教育濕地 Educational Wetland
	17. 滑梯大道 Avenue of slide



Key Features in Zone 1

Unobstructed harbour view

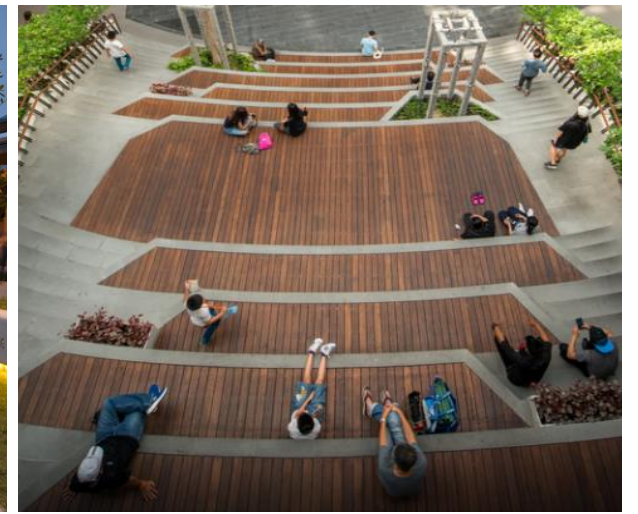
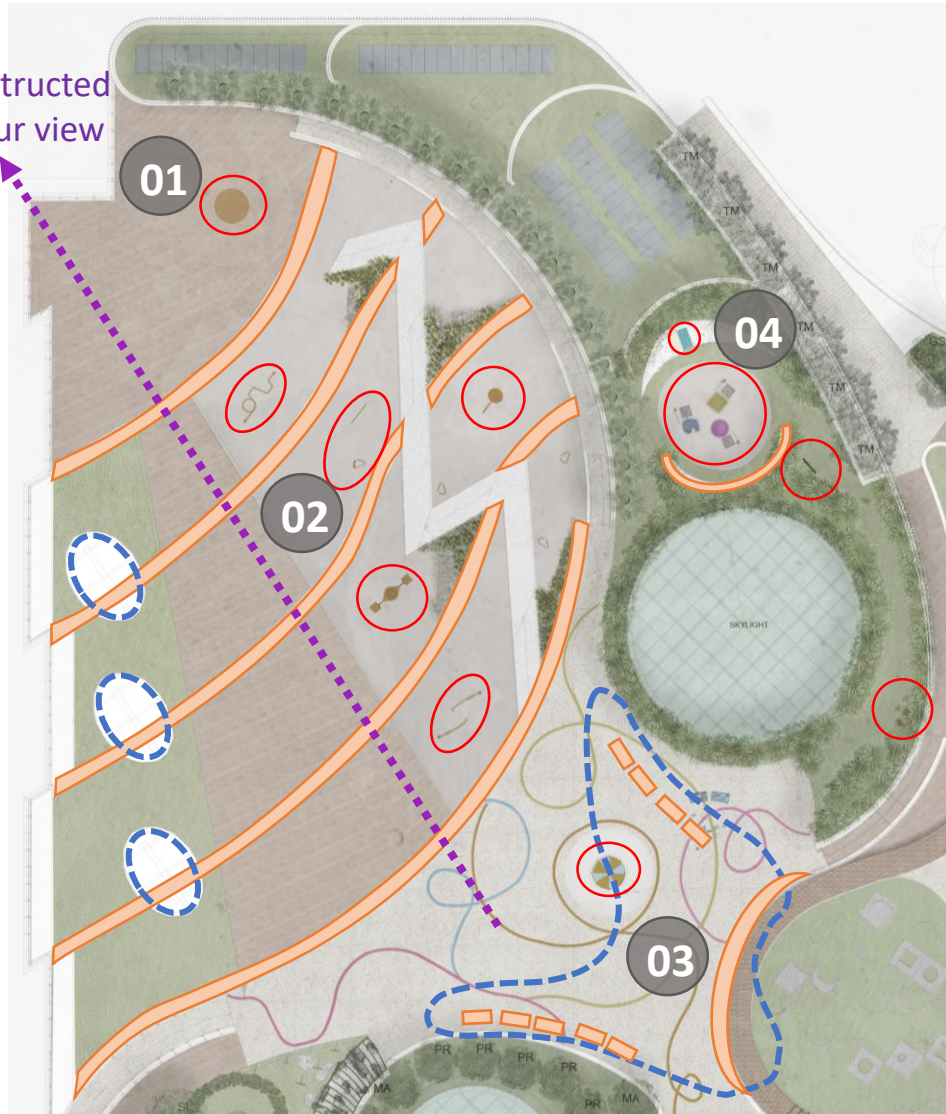

Pop-up plaza for ad-hoc events, installations, etc.



Wheelchair accessible merry-go-round

- Play Equipment
- ▭ Seating
- ▭ Shelter
- ▭ Plant Shading

- 01. 旋轉劇場 Family Amphitheatre – rotating
- 02. 風搖搖 Land of the Breezy – swinging
- 03. 大笪地 Pop-up plaza – rotating for wheelchair users
- 04. 秘密花園 Secret Garden – shadow and musical play

Key Features in Zone 1

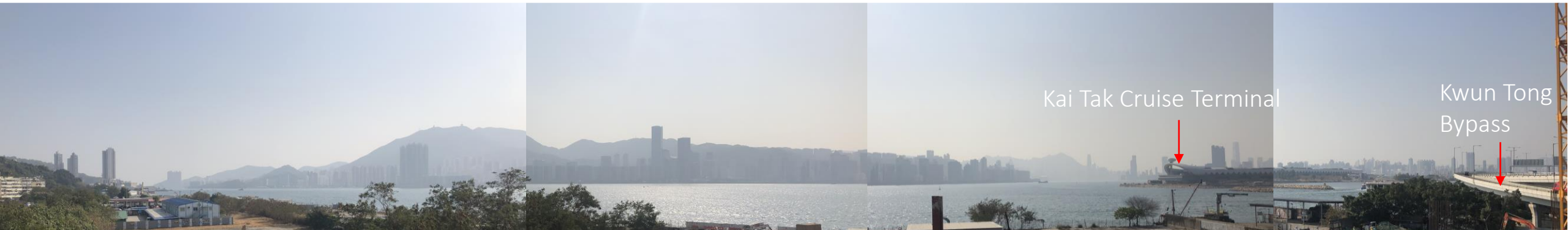
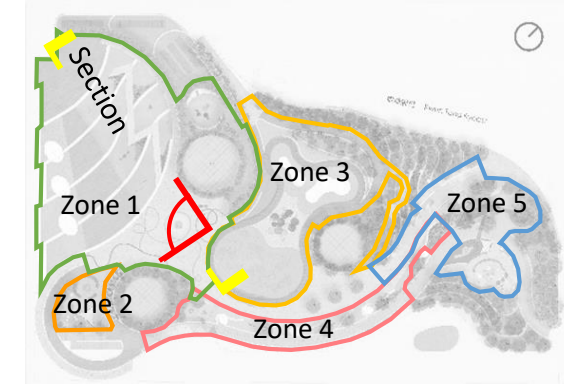

View from Zone 1 landscape deck



Section

Sightline in Zone 1

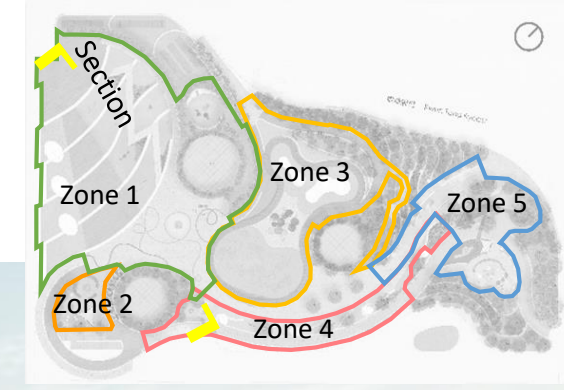

The amphitheater seating arrangement and levels set @ 400mm interval to avoid obstructing people's viewing sightline.

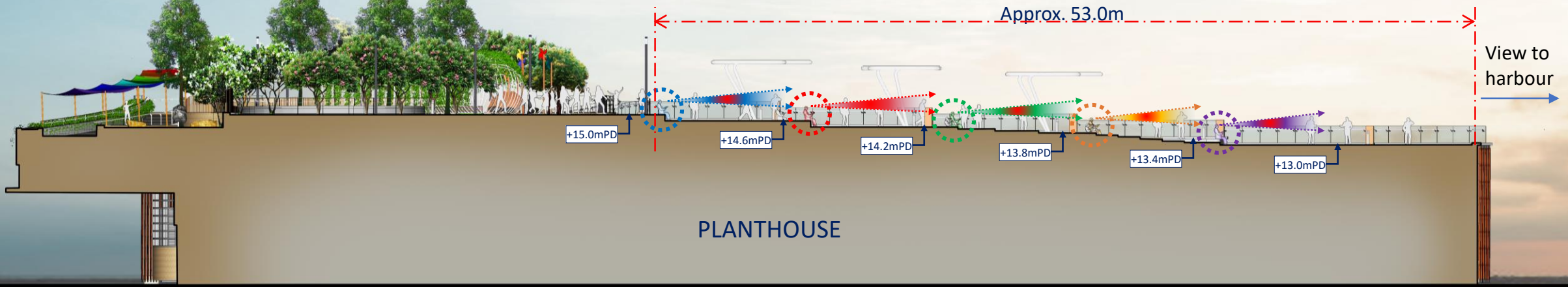

Key Features in Zone 2



Rosmarinus officinalis
迷迭香



Pennisetum alopecuroides (L.)
Spreng.
狼尾草



Leucophyllum frutescens
紅花玉芙蓉

05. 幼兒天地 Toddler Paradise

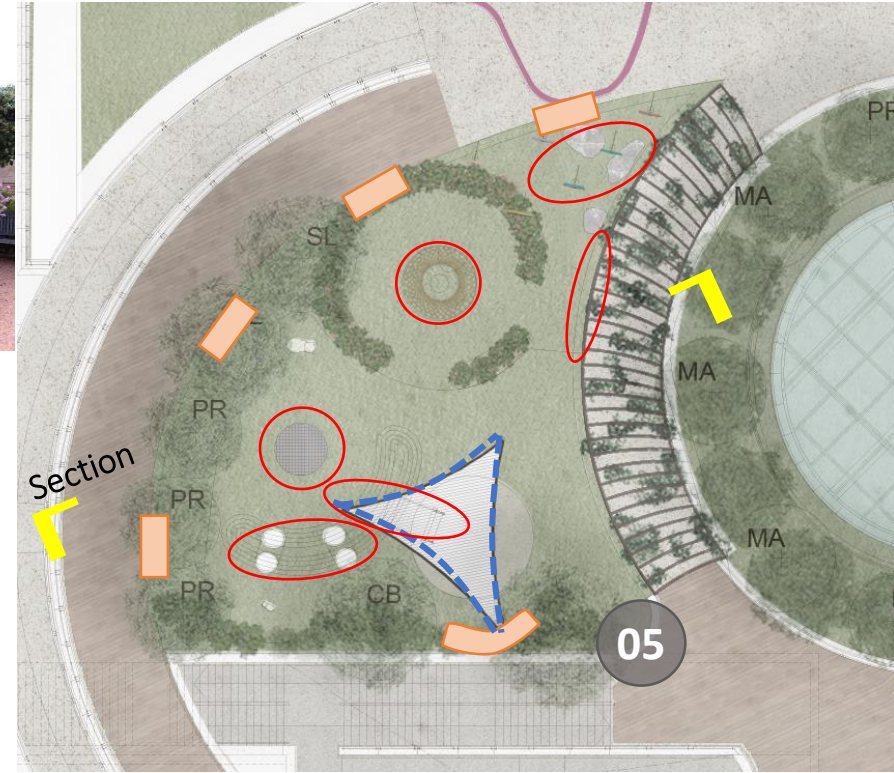

- Shadow Play
- Cozy space
- Interacting with butterflies
- Sliding
- Crawling



+15.00

Natural Hideout
草叢躲貓貓

Grassland Discovery
草原探索

Future Entrance of Promenade
未來海濱出口

- Play Equipment
- ▭ Seating
- ▭ Shelter
- ▭ Plant Shading

Key Features in Zone 3







波浪木道
The Wooden Waves



綠遊遊
Embracing Green

- 06. 雲之躍動 The Clouds
- 07. 綠遊遊 Embracing Green
- 08. 波浪木道 The Wooden Waves
- 09. 渠管迷宮 Concrete Labyrinth
- 10. 穿梭林跡 Into the Woods
- 11. 光影聚 Shadow Gathering

-  Play Equipment
-  Seating
-  Shelter
-  Plant Shading

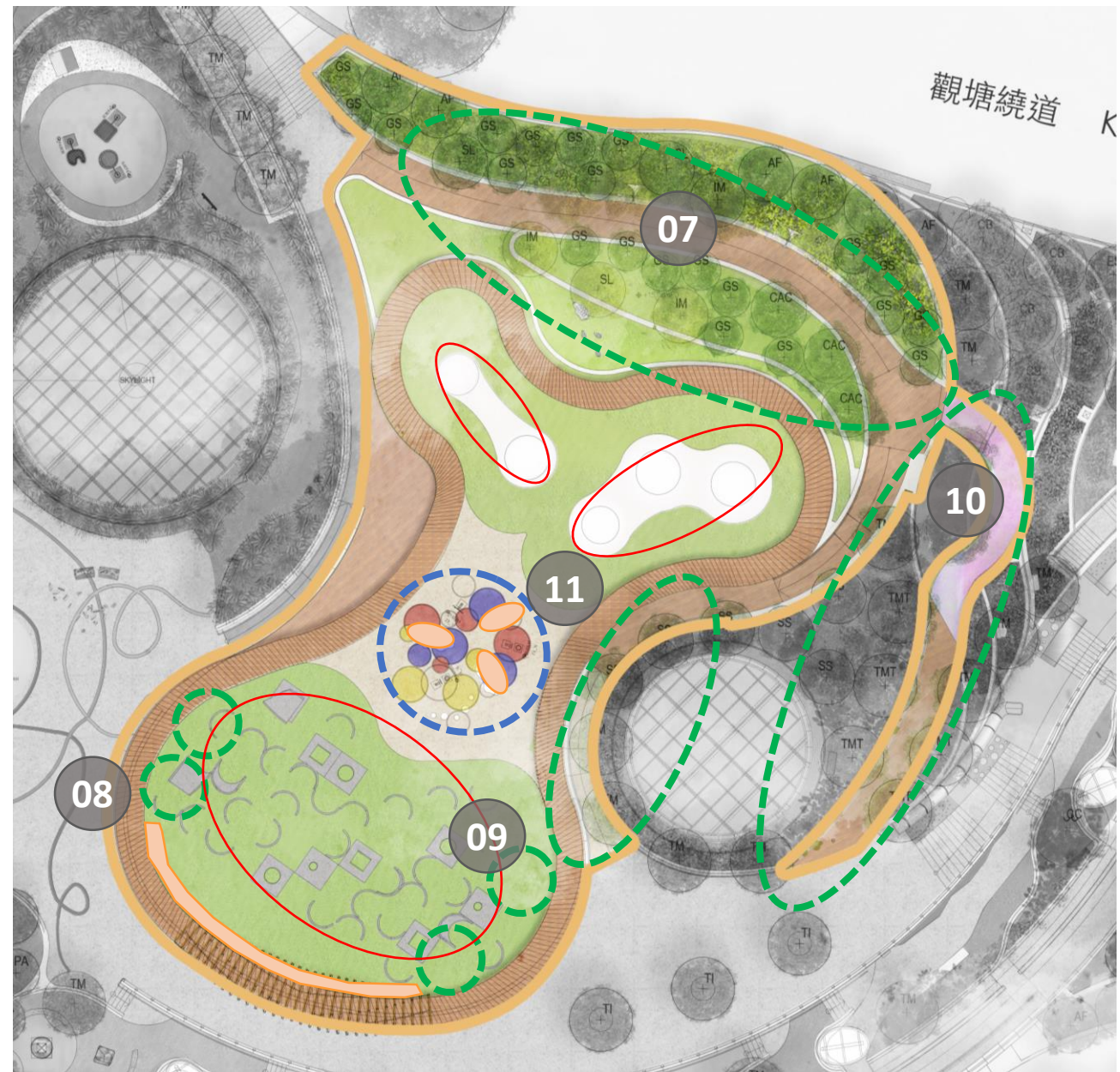

Key Features in Zone 3

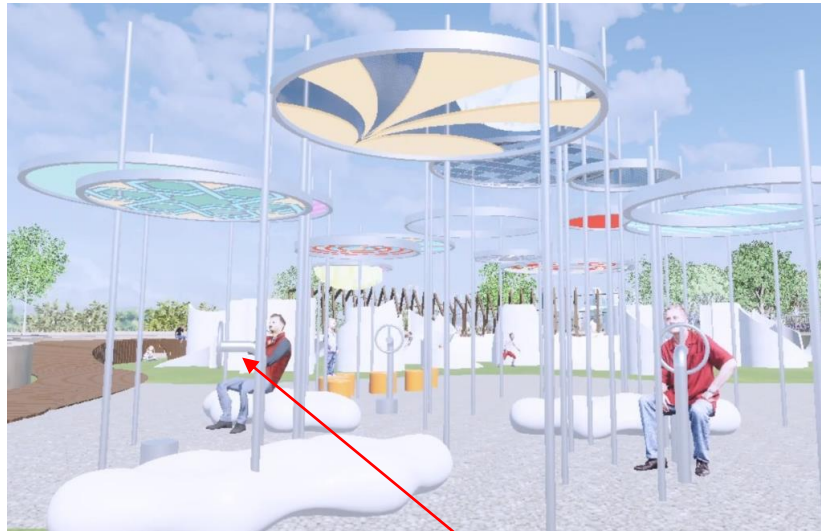
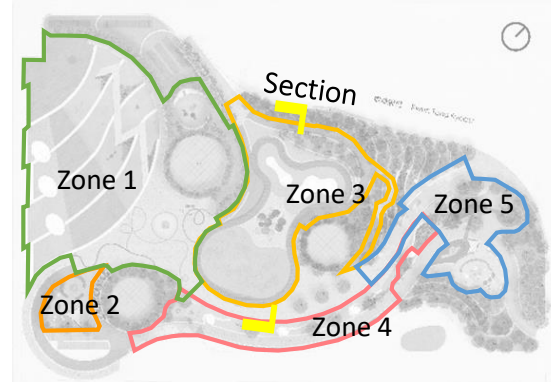

Fitness facilities for elderly under shading

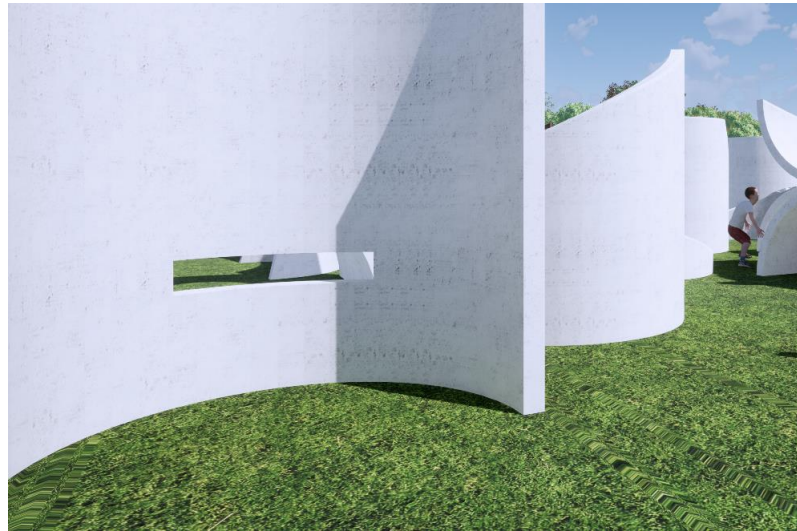

Concrete pipe maze



Key Features in Zone 4

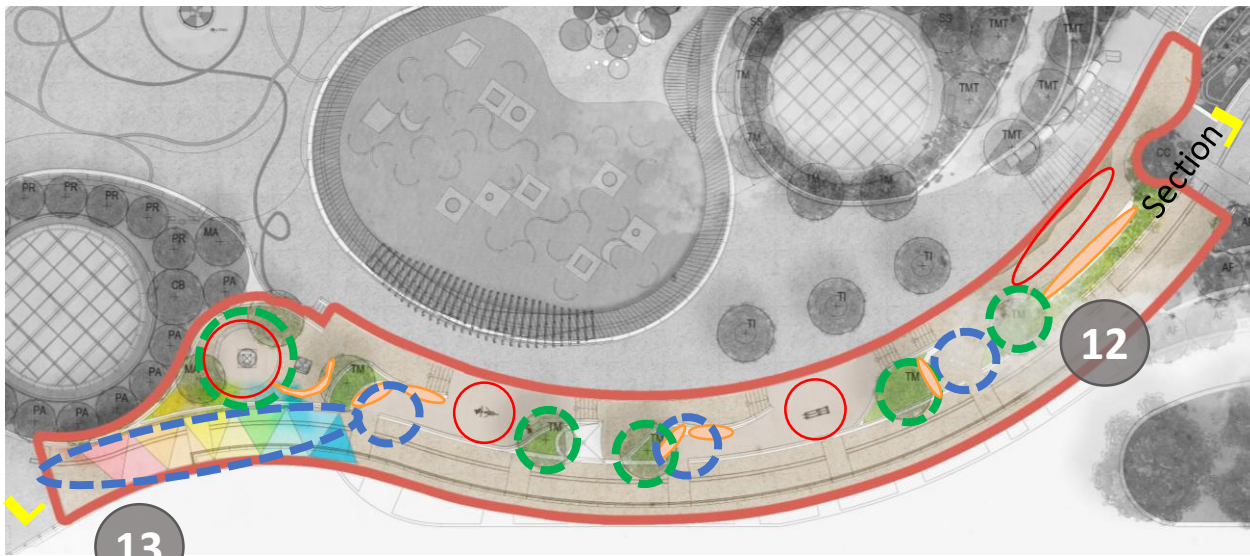

- Play Equipment
- ▭ Seating
- ▭ Shelter
- ▭ Plant Shading



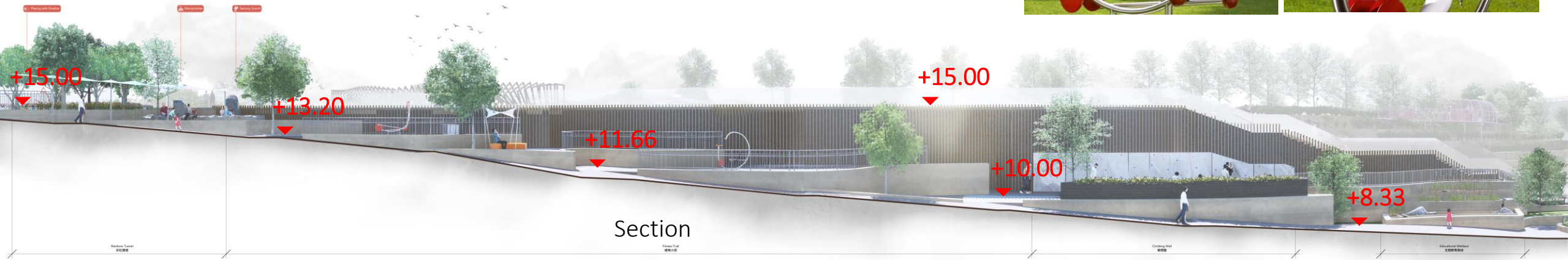

12. 健身小徑 Fitness Trail
13. 彩虹隧道 Rainbow Tunnel



Key Features in Zone 5



- 14. 親樹平台 Forest Hunt
- 15. 親水花園 Water Play Creek
- 16. 生態教育濕地 Educational Wetland
- 17. 滑梯大道 Avenue of slide

-  Play Equipment
-  Seating
-  Shelter
-  Plant Shading

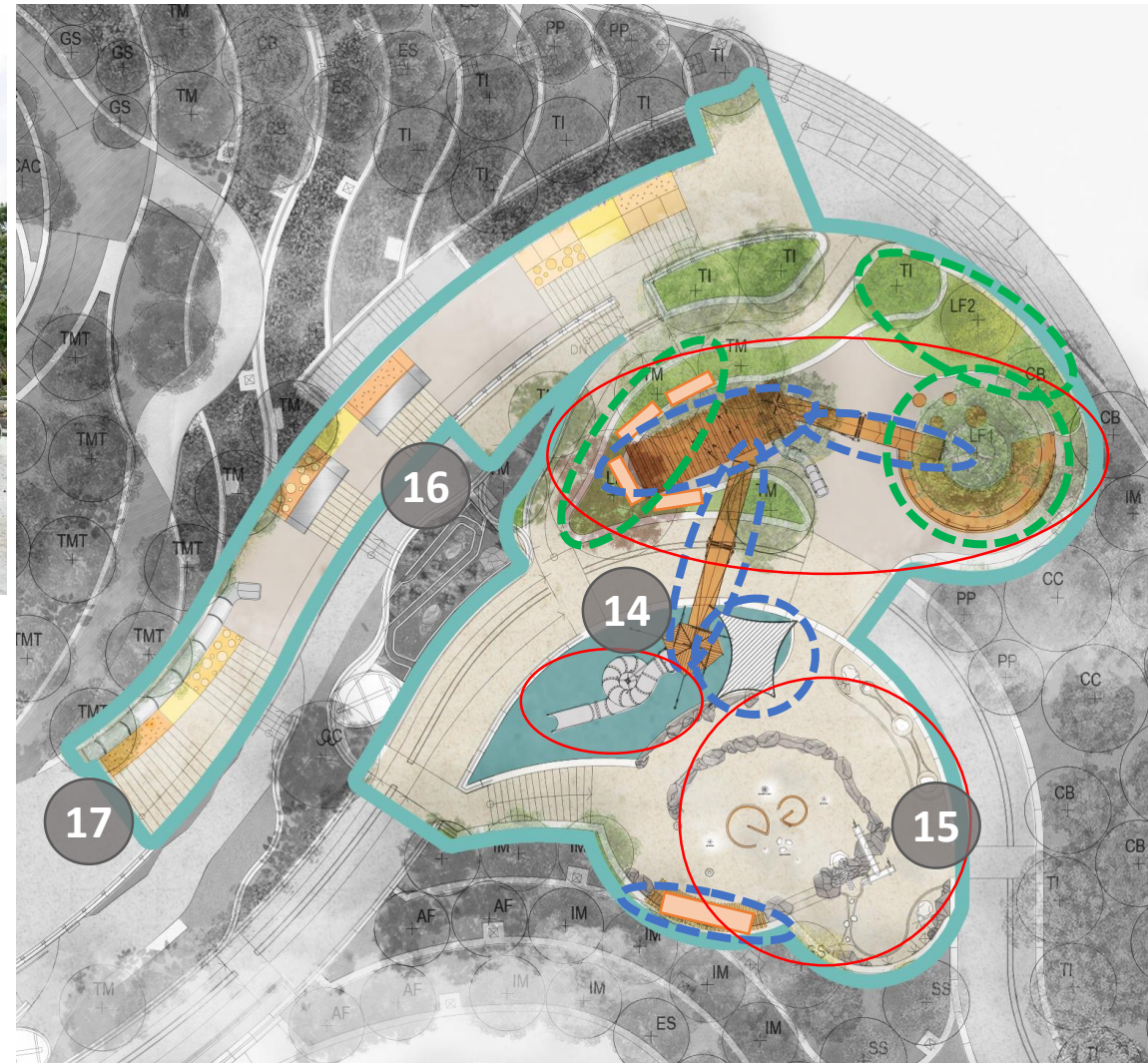

Key Features in Zone 5

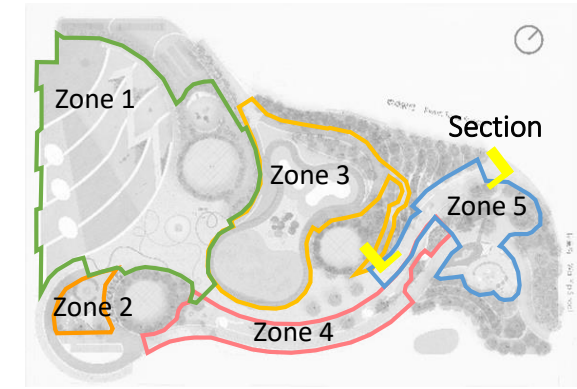

Soft Landscape & Playful Nature – Main Entrance Green Corridor



- Wildlife green corridor
- Showy seasonal flowers



Tabebuia impetiginosa
風鈴木



Liquidambar formosana
楓香



Sapium sebiferum
烏柏



Pongamia pinnata
水黃皮



Cinnamomum camphora
樟樹



Cinnamomum burmannii
陰香



Ilex rotunda Thunb. var. *microcarpa*
小果鐵冬青



Elaeocarpus sylvestris
山杜英



Terminalia mantaly
小葉欖仁



Camellia crapnelliana
紅皮糙果茶

Soft Landscape Overall Proposal

Trellis & Terraces (whole park) – Showy flowers, fragrance, green wall
 蒜香藤 | 忍冬 | 瘤腺葉下珠



Entrance – Seasonal showy colors
 風鈴木 | 紅杜鵑



Zone 3 - Peculiar colours and shapes of tree for visual interest
 紅皮糙果茶 | 錦葉欖仁



Zone 1 - therapeutic sensation from softness and movement
 小葉琴絲竹 | 矮蒲葦 | 紫葉狼尾草



Zone 2 - Feathery foliage for shadow play
 棟 | 狐尾天冬



Zone 4 - vivid contrasting colors for energetic ambiance
 天堂鳥 | 黃金榕



Ramp – Native plants for biodiversity
 小果鐵冬青 | 山杜英



Zone 5 - Feature trees with autumn colors
 楓香 | 烏柏



Soft Landscape Seasonal Arrangement

- Seasonal foliage colors, fruits and flowers to enhance “playful nature”

- Balance urban forest, biodiversity, aesthetics and long term maintenance

- Maximize greening opportunities

● Period for Fruits
★ Period for Flowers

TREES															
ABBV	BOTANICAL NAME	CHINESE NAME	ORIGIN	Jan	Feb	Mar	Apr	May	Jun	Jul	Aug	Sept	Oct	Nov	Dec
AF	<i>Albizia forsteri</i>	常綠雙楸	Native	●	●	●	●							●	●
CAC	<i>Camellia crapnelliana</i>	紅皮櫻茶	Native	★	★							●	●		●
CB	<i>Cinnamomum burmannii</i>	降香	Native			★	★								
CC	<i>Cinnamomum camphora</i>	樟樹	Native					★	★						
ES	<i>Elaeocarpus sylvestris</i>	山杜英	Native												
GS	<i>Garcinia subelliptica</i>	菲島福木	Exotic					★	★	★		●	●		
IM	<i>Ilex rotunda</i> Thunb. var. <i>microcarpa</i>	小葉羅冬青	Native	●	●	★	★	★							●
LF1	<i>Liquidambar formosana</i> 1	楓香 1	Native	●	●										●
LF2	<i>Liquidambar formosana</i> 2	楓香 2	Native	●	●										●
MA	<i>Melia azadirach</i> L.	楝	Exotic				★	★					●	●	●
PA	<i>Plumeria rubra</i> 'Acutifolia'	雞蛋花	Exotic			★	★	★	★	★	★	★	★		●
PP	<i>Pongamia pinnata</i>	水黃皮	Native					★	★		●	●	●		
PR	<i>Plumeria rubra</i>	紅花雞蛋花	Exotic			★	★	★	★	★	★	★	★		●
SL	<i>Sterculia lanceolata</i>	假蒺藜	Native				★	★			●	●			●
SS	<i>Sapium sebiferum</i>	桐油	Native	●	●	●	●	●	●	●	●	●	●	●	●
TI	<i>Tabebuia impetiginosa</i>	紅花風鈴木	Exotic	★	★	●	●								●
TM	<i>Terminalia mantaly</i>	小葉構仁	Exotic												●
TMT	<i>Terminalia mantaly</i> 'Tricolor'	錦葉構仁	Exotic												●

SHRUBS															
ABBV	BOTANICAL NAME	CHINESE NAME	ORIGIN	Jan	Feb	Mar	Apr	May	Jun	Jul	Aug	Sept	Oct	Nov	Dec
ApR	<i>Aphelandra rupestris</i>	藍花草	Exotic	★	★	★	★	★	★	★	★	★	★	★	★
AsV	<i>Alpinia speciosa</i> cv <i>Variegata</i>	花葉薑山薑	Exotic												
BuK	<i>Buxus</i> spp.	黃楊	Native												
CrS	<i>Crinum asiaticum</i> var. <i>sinicum</i>	文殊蘭	Native							★	★	★	★		
CsP	<i>Cortaderia selloana</i> Purnita	矮蒲草	Exotic												
EsR	<i>Eucodia suaveolens</i> var. <i>rdleyi</i>	龜爪梅	Exotic												
FaC	<i>Fagraea cealantica</i>	灰莉	Exotic				★	★	★	★	★				
FmGL	<i>Ficus microcarpa</i> 'golden leaves'	黃金榕	Exotic												
lcC	<i>Ixora coccinea</i> L.	緋葉珊瑚花	Exotic			★	★	★	★	★	★	★	★	★	★
LeF	<i>Lespedeza formosa</i>	美艷胡枝子	Native										★	★	
LeF	<i>Leucophyllum frutescens</i>	紅花玉芙蓉	Exotic		★		★		★		★		★		★
LoC	<i>Loropetalum chinense</i> f. <i>rubrum</i>	紅花檵木	Native			★	★	★	★						
MaB	<i>Melaleuca bracteata</i> 'Revolution Gold'	黃金串錢柳	Exotic												
NaD	<i>Nandina domestica</i>	南天竺	Native		★	★	★	★	★	★	★	★	★	★	★
PeA	<i>Pennisetum alopecuroides</i> (L.) S	狼尾草, 狗仔草	Exotic												
PePS	<i>Pennisetum purpureum</i> Schum.	紫葉雀尾草	Exotic												
PhS	<i>Phllocladon seloum</i>	香羽	Exotic												
PIA	<i>Plumbago auriculata</i>	藍雪花	Exotic							★	★	★	★		
PmS	<i>Pinus mugo</i> "Slowmound"	矮歐洲山松	Exotic												
RhH	<i>Rhapis humilis</i>	細葉棕竹	Exotic												
RhS	<i>Rhododendron simsii</i> Planch.	紅杜鵑	Native	★	★	★	★	★							★
RIN	<i>Rhaphiolepis indica</i>	車輪梅	Native		★	★	★	★							
RoF	<i>Rosmarinus officinalis</i>	迷迭香	Exotic												
SaV	<i>Schefflera arborescens</i> 'Variegata'	斑葉蕁麻藤	Exotic												
ScT	<i>Scaevola taccada</i>	草海桐	Native												
ShR	<i>Strelitzia reginae</i>	天堂鳥	Exotic	★	★	★	★	★							
SyR	<i>Syzygium rehderianum</i>	紅粉薄桃	Exotic												

GROUNDCOVERS															
ABBV	BOTANICAL NAME	CHINESE NAME	ORIGIN	Jan	Feb	Mar	Apr	May	Jun	Jul	Aug	Sept	Oct	Nov	Dec
AIP	<i>Alocasia poly</i>	果葉網舌藤	Exotic												
AsC	<i>Asparagus cochinchinensis</i>	天門冬	Native												
AsD	<i>Asparagus densiflorus</i> 'Myersii'	狐尾天冬	Exotic												
CcM	<i>Crossostephium chinense</i> (L.) M	艾草類	Native												
CuH	<i>Cuphea hyssopifolia</i>	綉葉雙距花/細葉番荔枝	Exotic	★	★	★	★	★	★	★	★	★	★	★	★
DuR	<i>Duranta erecta</i> Golden Edge	金邊假連翹	Exotic												
DuRV	<i>Duranta repens</i> 'Variegata'	花葉假連翹	Exotic												
EvN	<i>Evolvulus nuttallianus</i>	藍星花	Exotic	★	★	★	★	★	★	★	★	★	★	★	★
HaP	<i>Hamelia patens</i>	長隔木/希木利	Exotic					★	★	★	★	★	★	★	★
JuH	<i>Juniperus horizontalis</i>	匍匐雪松	Exotic												
LIV	<i>Liriope spicata</i> (Thunb.) Lour.	山萵苣	Native												
LsV	<i>Liriope muscari</i> var. <i>Variegata</i>	金邊蘭草冬	Native												
MeD	<i>Melastoma dodicandrum</i>	地稔	Native							★	★	★	●	●	●
MeD	<i>Nephrolepis auriculata</i>	腎蕨	Native												
PhX	<i>Philodendron xanadu</i>	仙南	Exotic												
SaN	<i>Sarichezia nobilis</i>	黃豚胡床	Exotic							★	★	★	★		
SeL	<i>Sedum lineare</i>	佛甲草	Exotic							★	★				
SeS	<i>Serissa serissoides</i>	六月雪	Exotic												

CLIMBERS & TRELLIS PLANTS															
ABBV	BOTANICAL NAME	CHINESE NAME	ORIGIN	Jan	Feb	Mar	Apr	May	Jun	Jul	Aug	Sept	Oct	Nov	Dec
BaC	<i>Bauhinia corymbosa</i>	圓冠錦	Native												
CaG	<i>Campsis grandiflora</i>	凌霄	Exotic												
FiP	<i>Ficus pumila</i>	黃葛藤	Native												
LoJ	<i>Lonicera japonica</i>	忍冬	Native												
PoR	<i>Podranea ricasoliana</i>	紫雲藤	Exotic												
PhM	<i>Phyllanthus myrsinifolius</i>	扁鵲下珠	Exotic												
PaD	<i>Parthenocissus daniellii</i>	異葉爬山虎	Exotic												
Qui	<i>Quisqualis indica</i>	使君子	Exotic												
PsA	<i>Pseudocalymma alliaceum</i>	蒜香藤	Exotic	★	★	★	★	★	★	★	★	★	★	★	★

BAMBOO															
ABBV	BOTANICAL NAME	CHINESE NAME	ORIGIN	Jan	Feb	Mar	Apr	May	Jun	Jul	Aug	Sept	Oct	Nov	Dec
PhN	<i>Phyllostachys nigra</i> (Lodd. ex Link)	紫竹	Exotic												
BaM	<i>Bambusa multiplex</i> 'Stripstem'	小葉琴絲竹	Exotic												

Turf															
ABBV	BOTANICAL NAME	CHINESE NAME	ORIGIN	Jan	Feb	Mar	April	May	Jun	Jul	Aug	Sept	Oct	Nov	Dec
	<i>Cynodon dactylon</i>	狗牙根	Native												
	<i>Paspalum notatum</i>	圓草	Exotic												
	<i>Lolium perenne</i>	黑草	Exotic												

Works Area

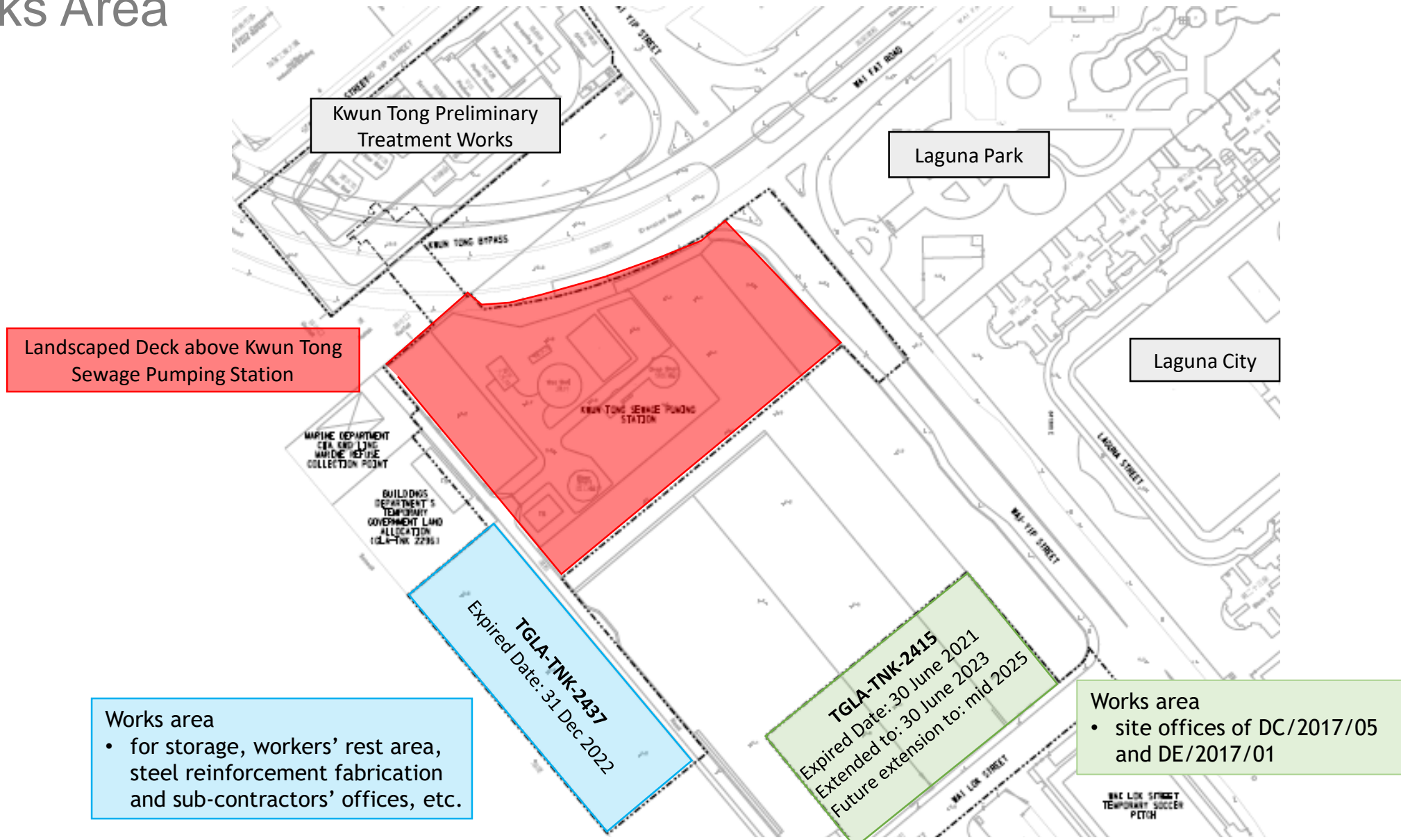

Works area

- for storage, workers' rest area, steel reinforcement fabrication and sub-contractors' offices, etc.

Works area

- site offices of DC/2017/05 and DE/2017/01

Thank You