

# Harbourfront Commission Presentation

HC/01/2021

14 April 2021

KAI TAK SPORTS PARK  
啟德體育園



# Background

1. Members to note the latest progress and design of the Sports Park
2. Suggestions and comments raised at the previous meeting on 15 January 2019

- Connectivity & Accessibility
- Water-Land Interface
- Vibrancy
- Greening & Sustainability
- Cycling
- Design

3. Adjacent Hotel Site Public Open Space (H/O POS Site)

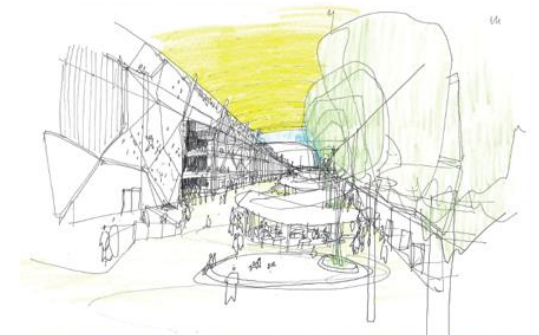
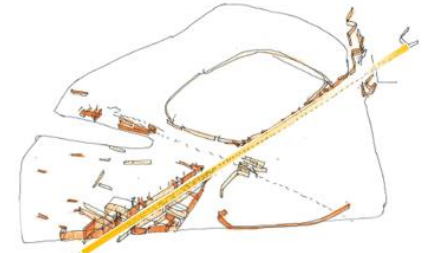
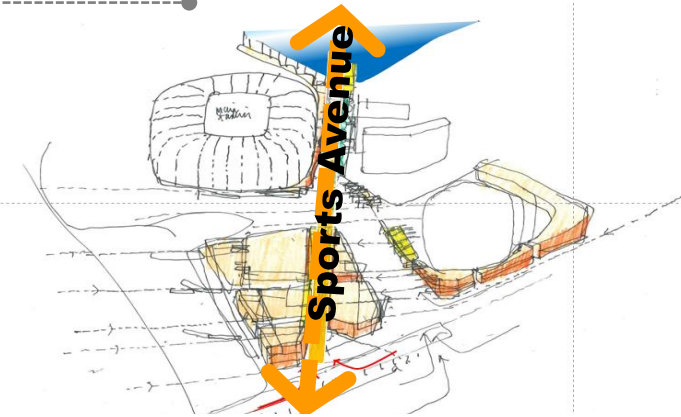

# Site Location

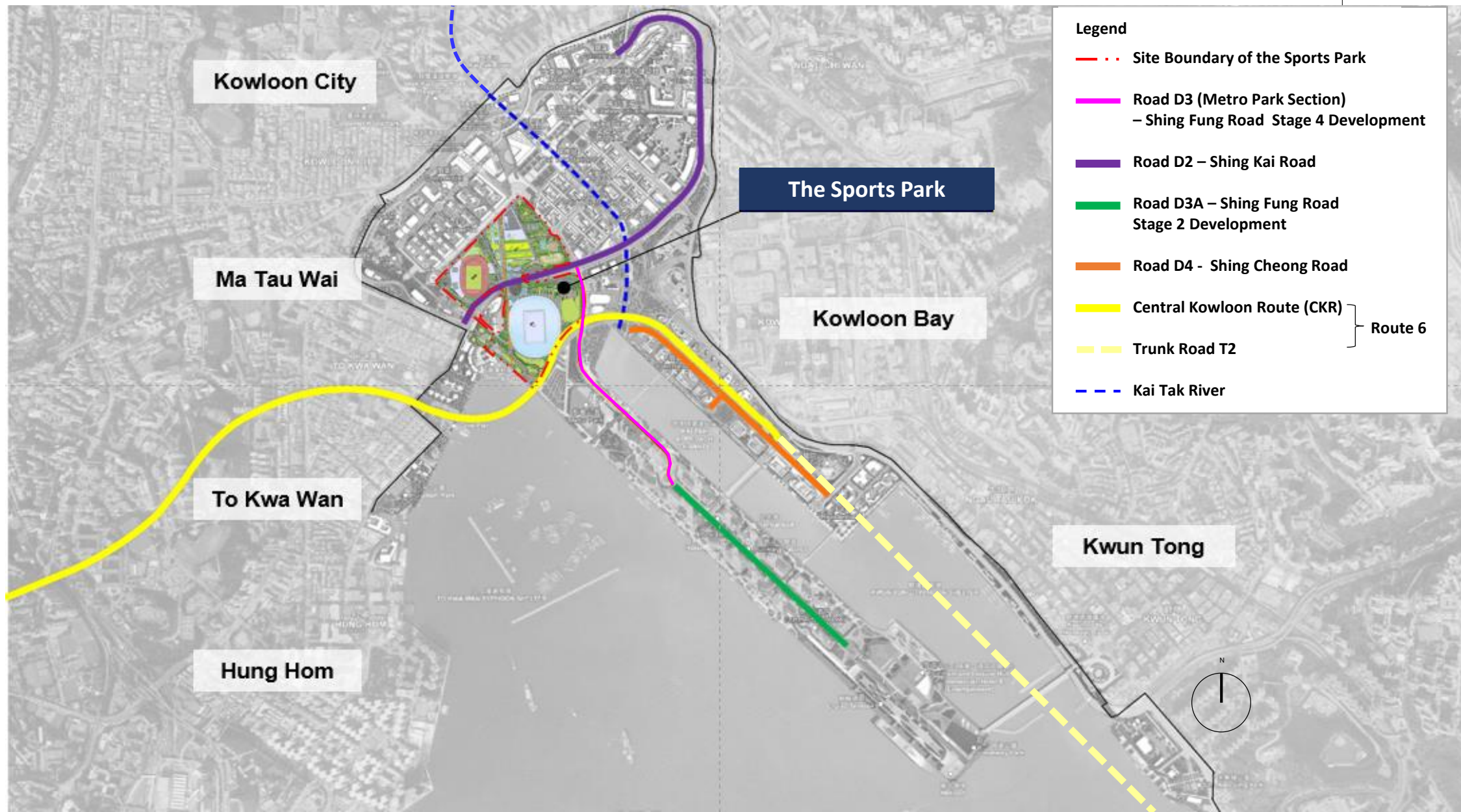

# Site Location – Nearby Public Open Space and Major Circulation

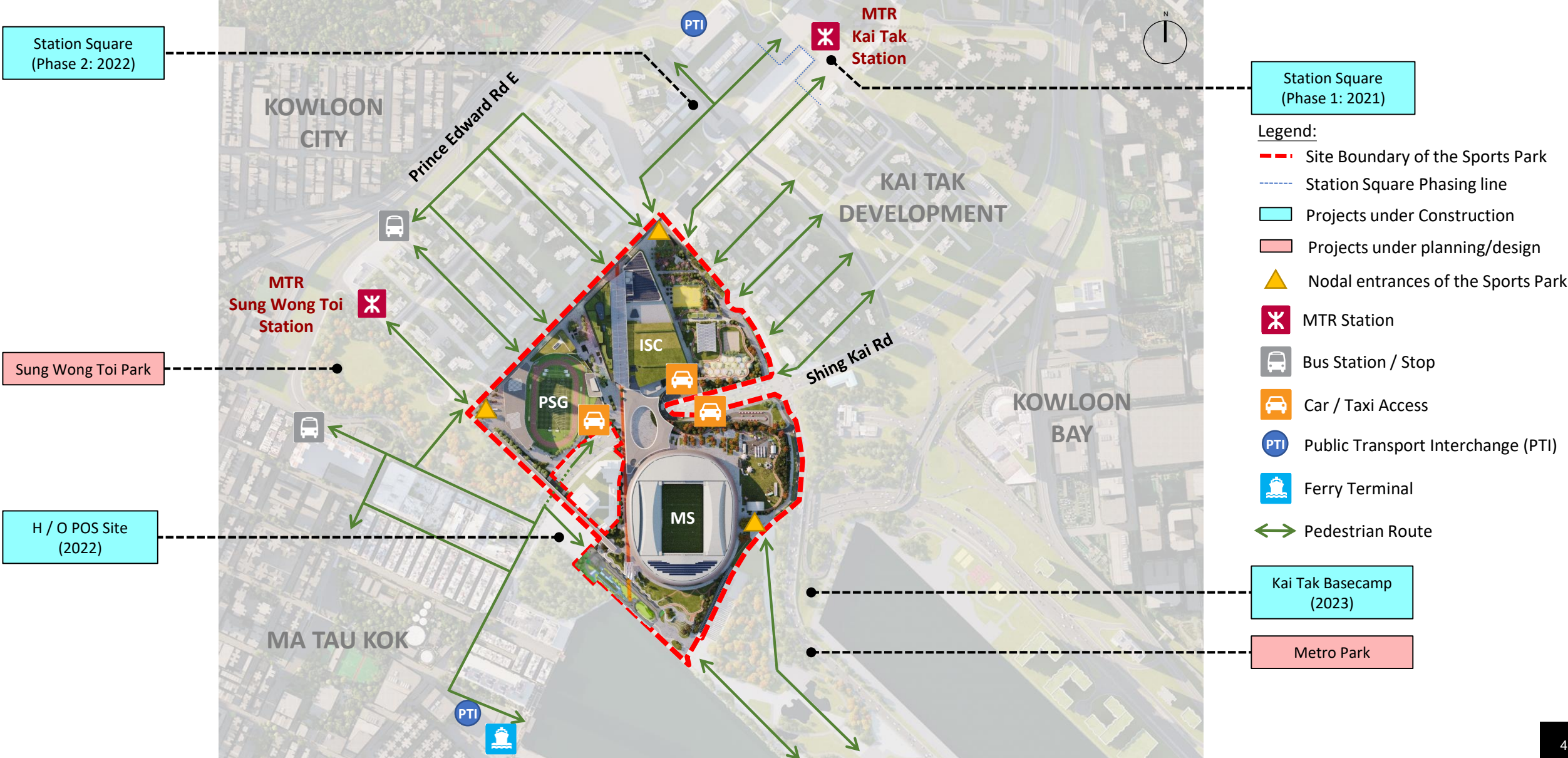

# Planning Objectives and Design Principles

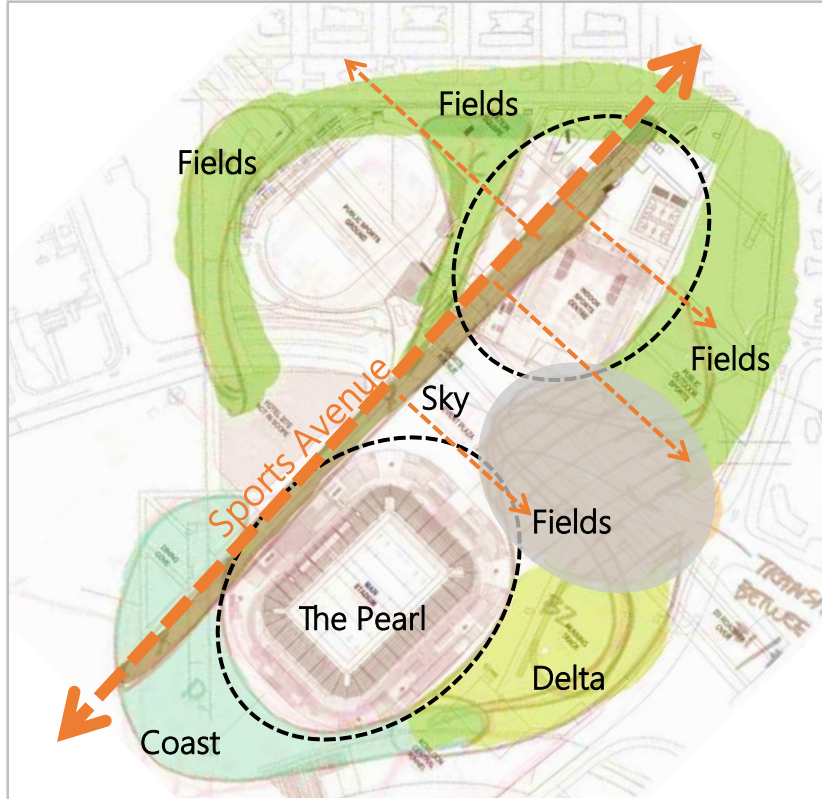

**1** **“Connected and Integrated”** -  
Strong Axis + Integrated Site Approach



**2** **“Smart and Sustainable”** -  
Smart + Healthy + Low Carbon Footprint



**3** **“Enjoyable and Vibrant”** -  
Engaging Active Spaces + Pleasant walking experience

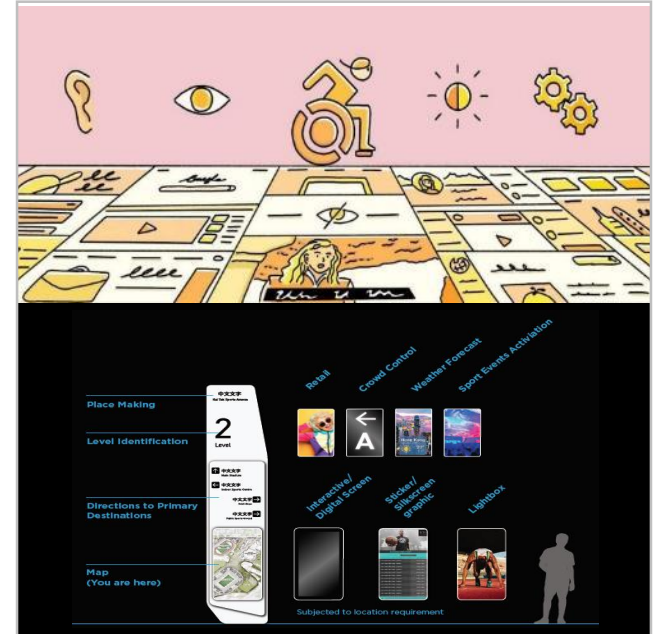

## Inclusive Play Space



**4** **“Safe and Inclusive”** -  
Enhanced Wayfinding & Identity +  
Inclusive Place for All

# Connectivity & Accessibility - The Hinterland to Harbourfront Promenade

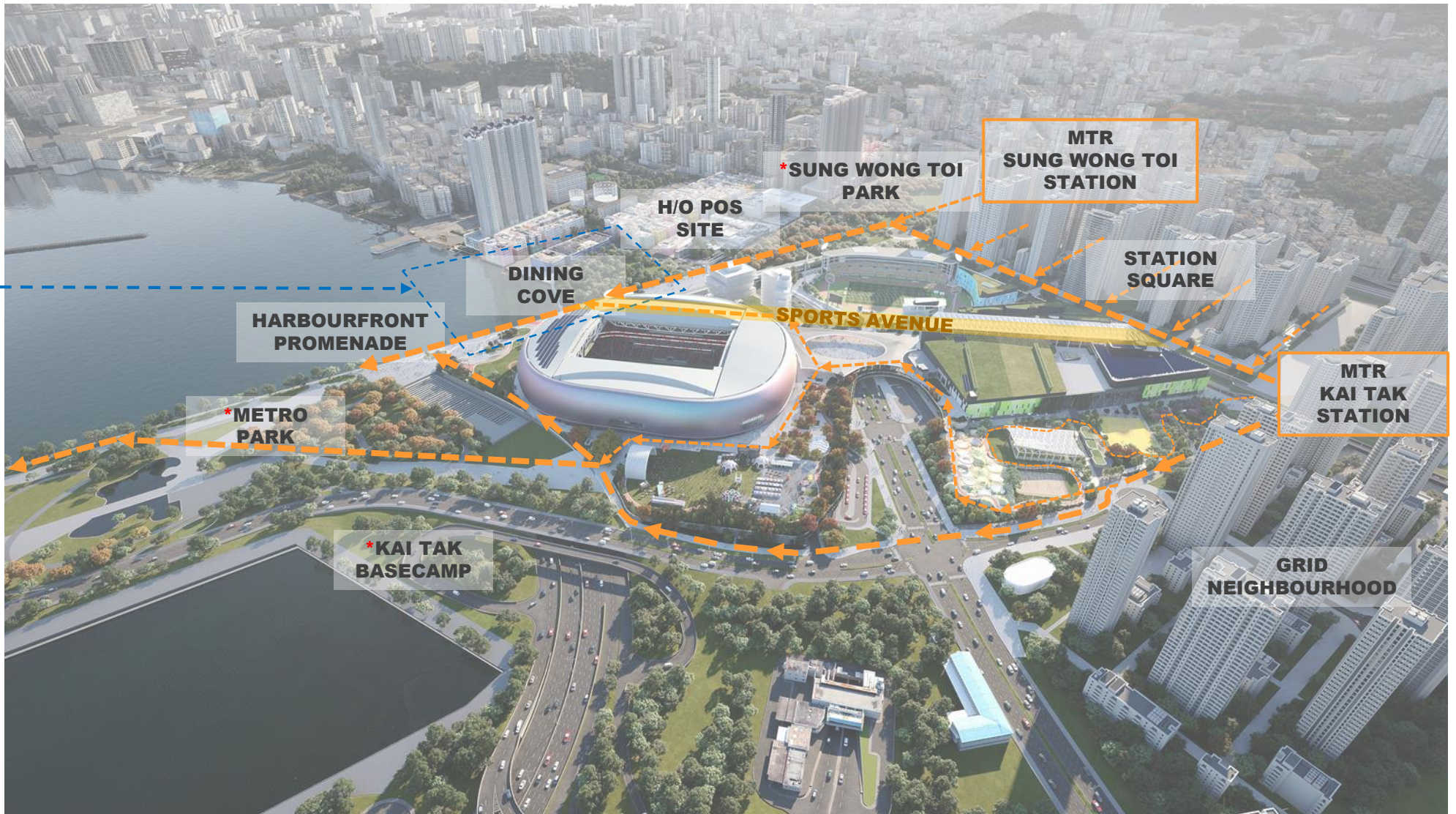
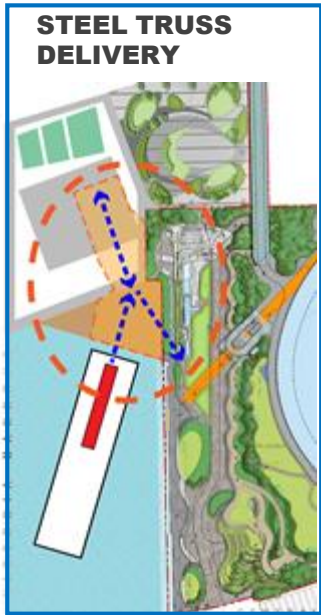

\*OPENING DATE AFTER OPENING OF THE SPORTS PARK

# Connectivity & Accessibility - The Sports Park and Station Square

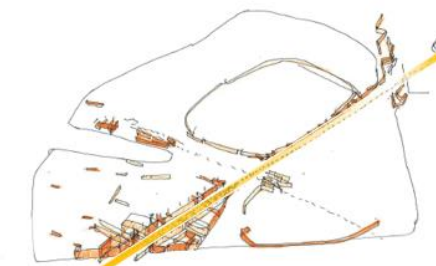
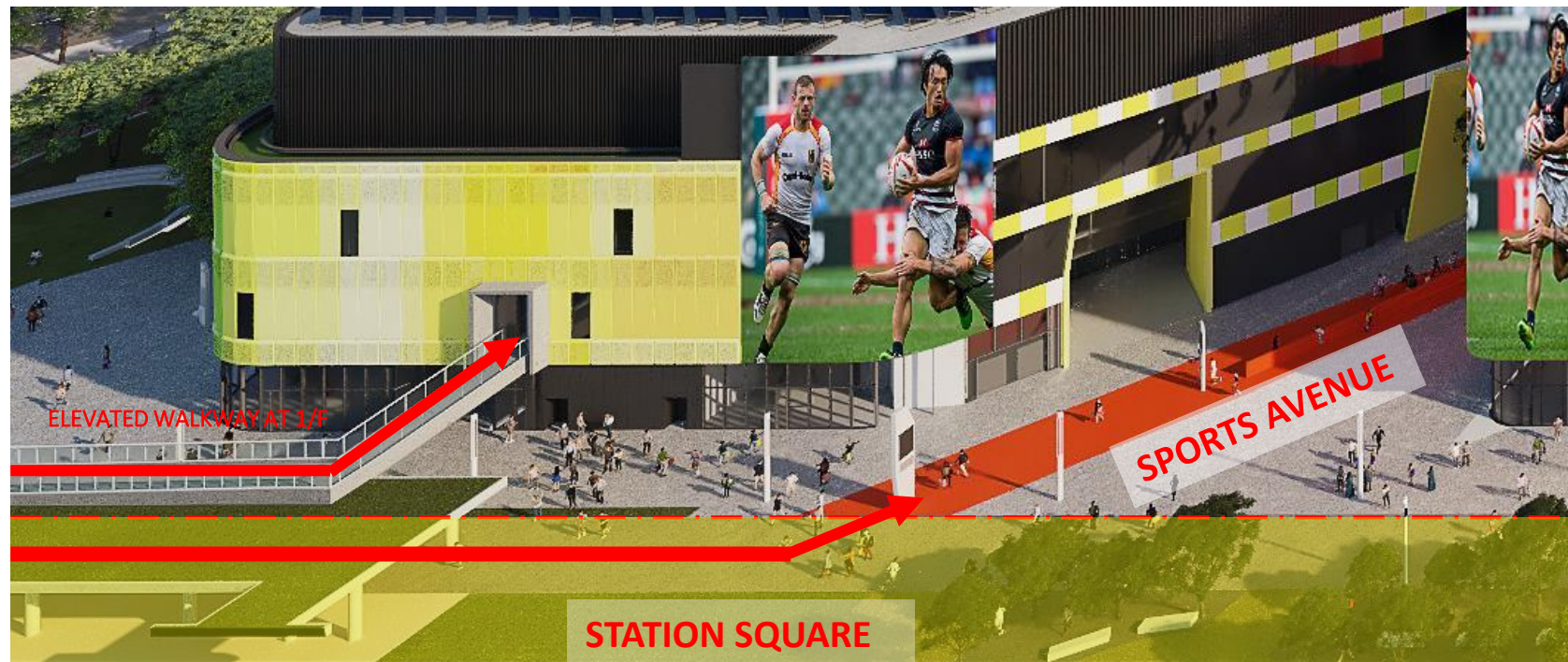
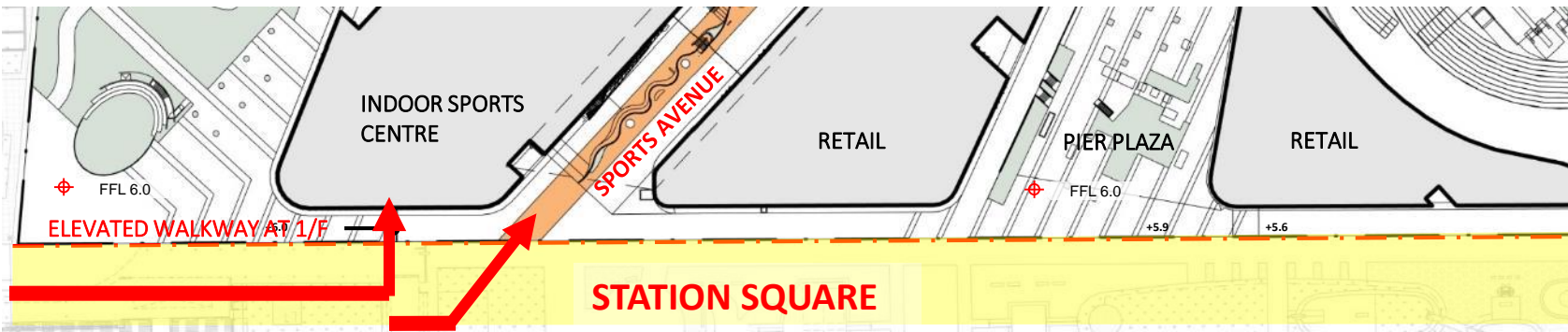

Active retail frontage

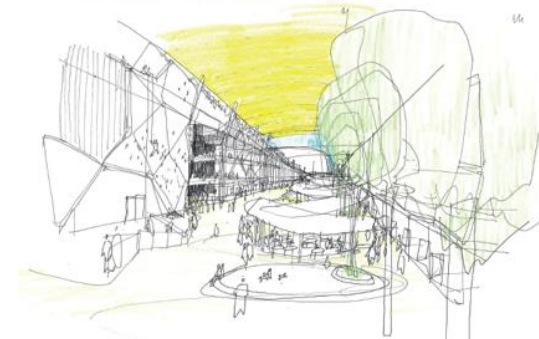

Sheltered passageway with vibrancy

**Legend**

- - - - - Site Boundary of the Sports Park
- ↔ Elevated walkway at 1/F (from Station Square to the Sports Park)

# Connectivity & Accessibility - The Sports Park to Kai Tak Basecamp

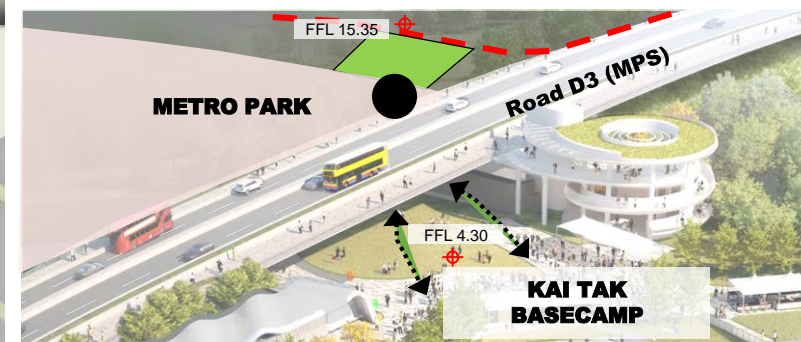
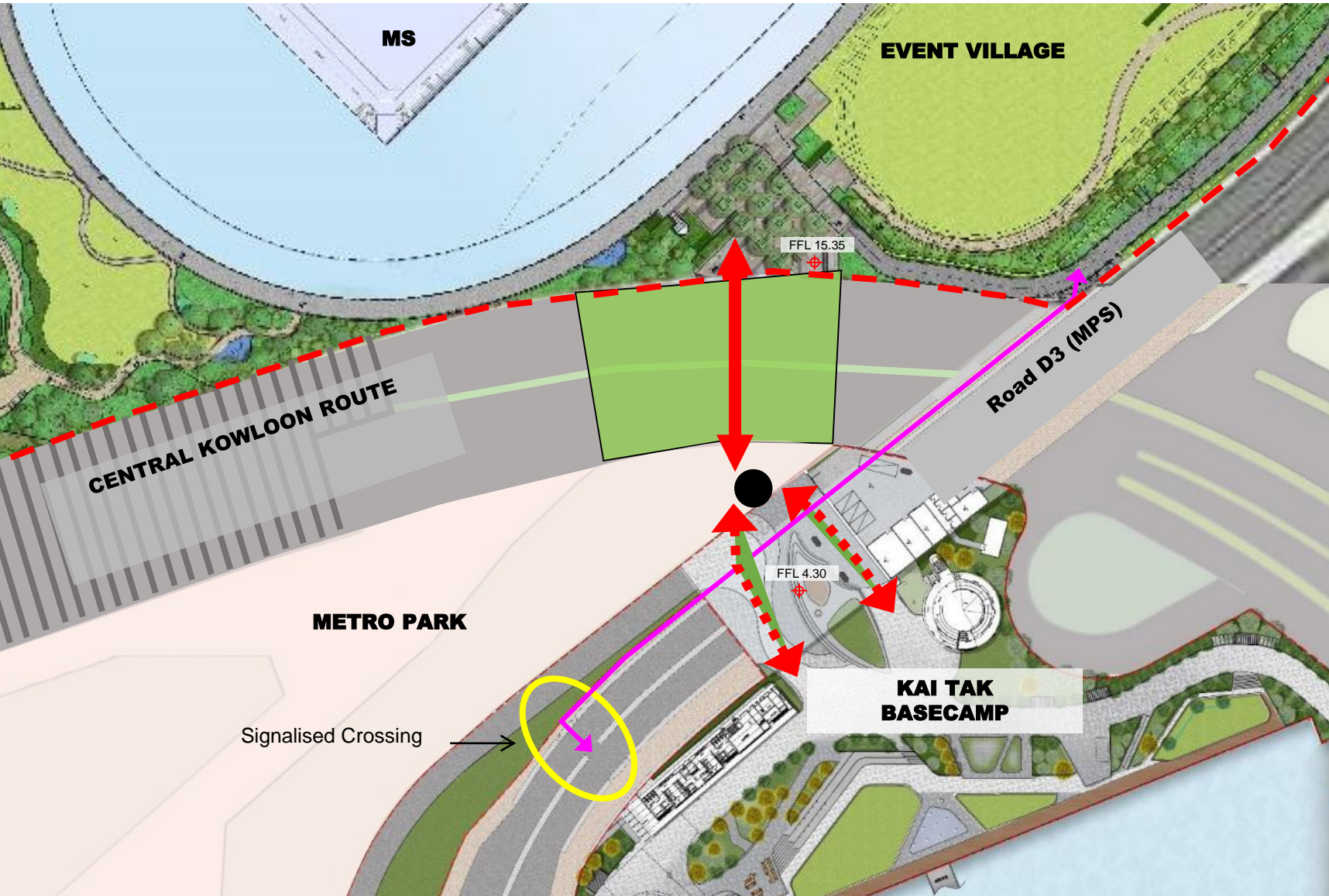

## Legend

- - - - - Site Boundary of the Sports Park
  - ↔ Interim Pedestrian Route before Completion of Metro Park (on road level)
  - · - · - Future Permanent Pedestrian Route after Completion of Metro Park (ground level walkway)
  - ↔ Future Permanent Pedestrian Route after Completion of Metro Park
  - █ Future Landscaped Deck of Metro Park above Central Kowloon Route
  - Future Vertical Connection to be provided by Metro Park (from level +15.35 to level +4.30)
- } Extent and location are subject to design



# Connectivity & Accessibility

## - The Sports Park to Hotel Public Open Space and Hotel Site

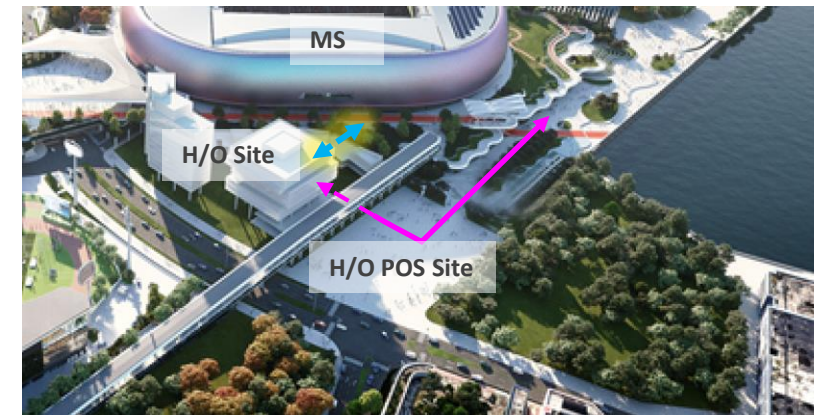
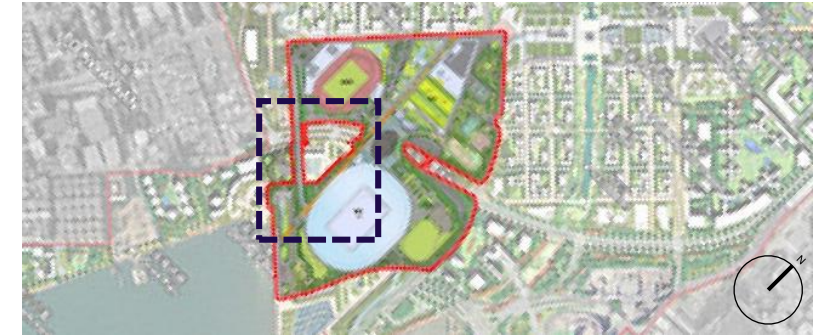
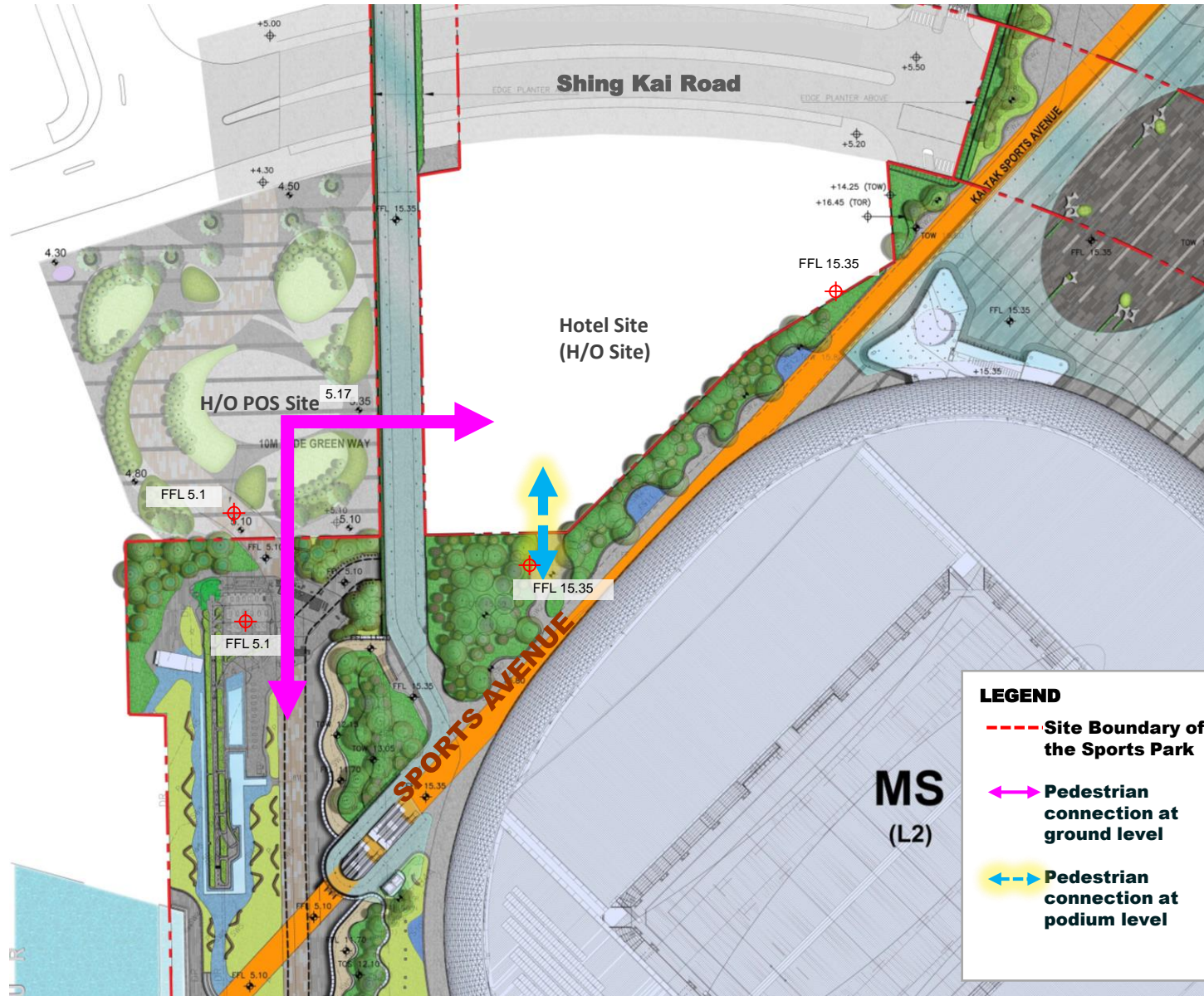

# Sports Avenue

- Connecting the heart of the Kai Tak neighbourhood to harbourfront promenade

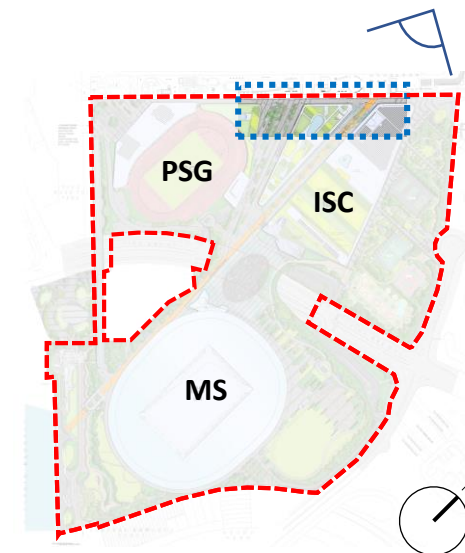
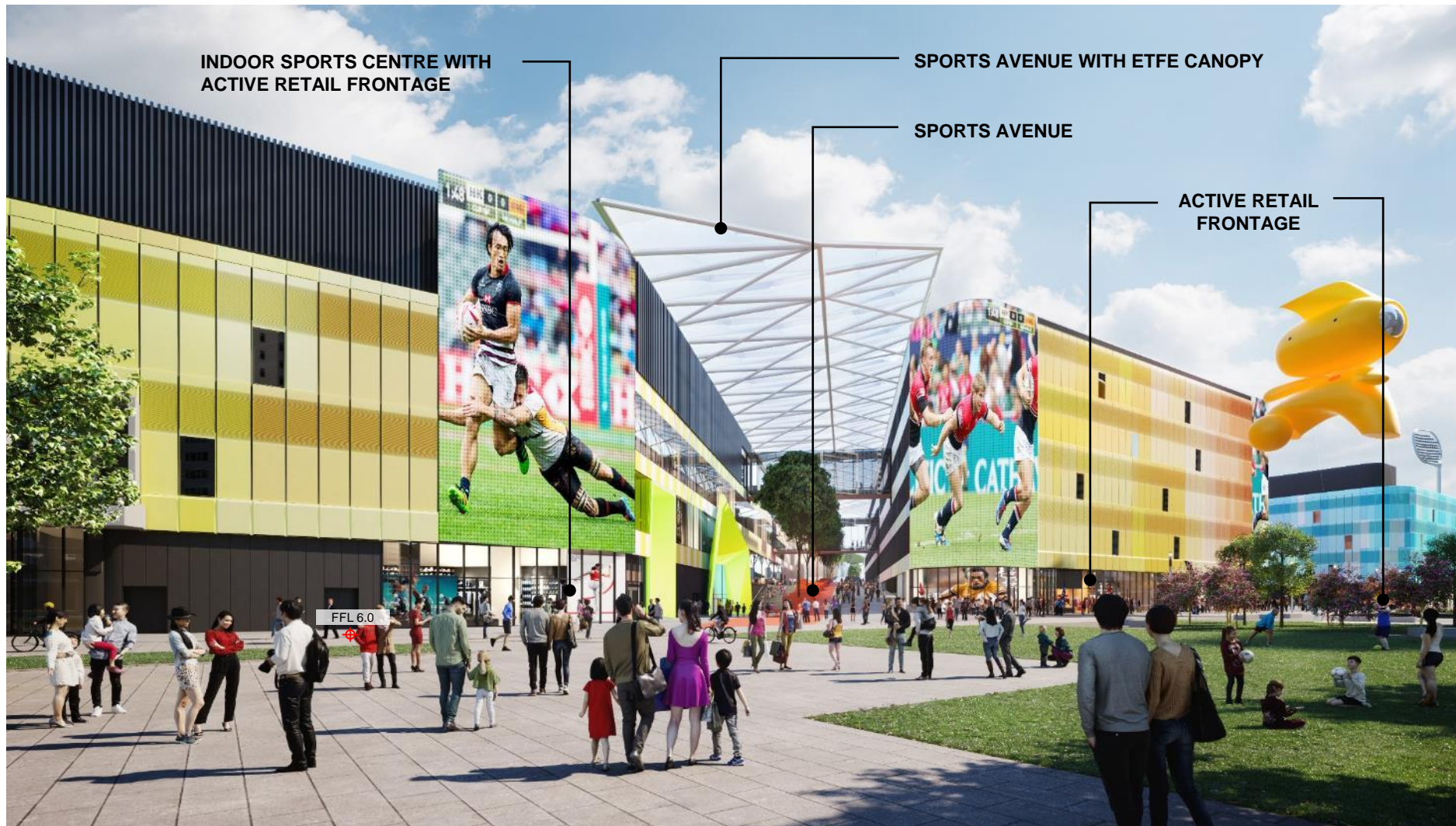

# Main Plaza

- Active and vibrant public realm for the various events and/or family outing



MAIN PLAZA CANOPY (8m HIGH)

MAIN STADIUM

MULTI-FUNCTION AREA FOR VARIOUS EVENTS

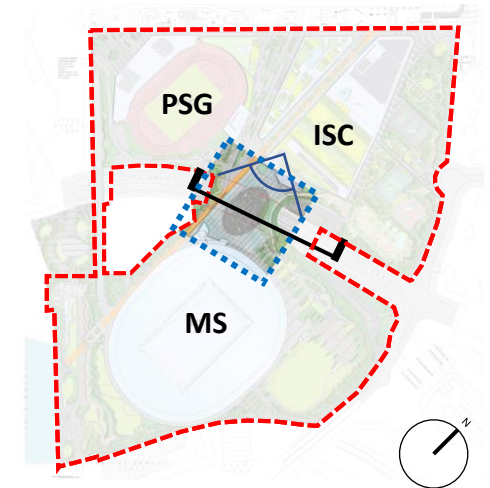

# Harbourfront promenade

- Place making for creating unique experiences and moments



# Fence-Free Seat Wall and Harbour Steps

- As a natural setting to visually connect with the harbourfront promenade

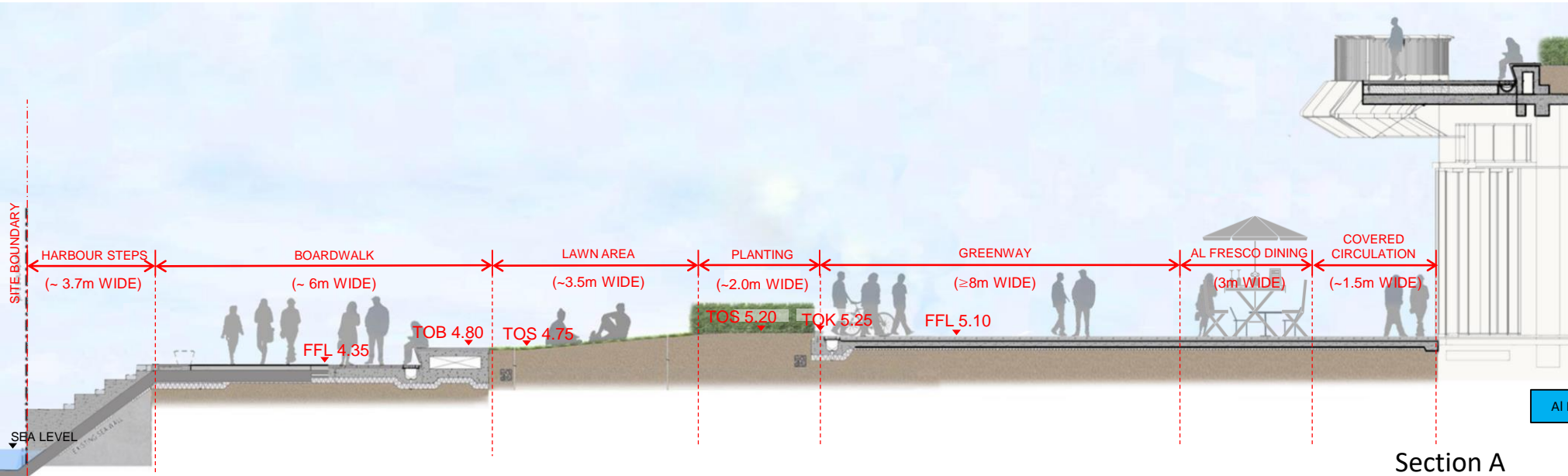

Section A

KAITAK SPORTS PARK  
啟德體育園

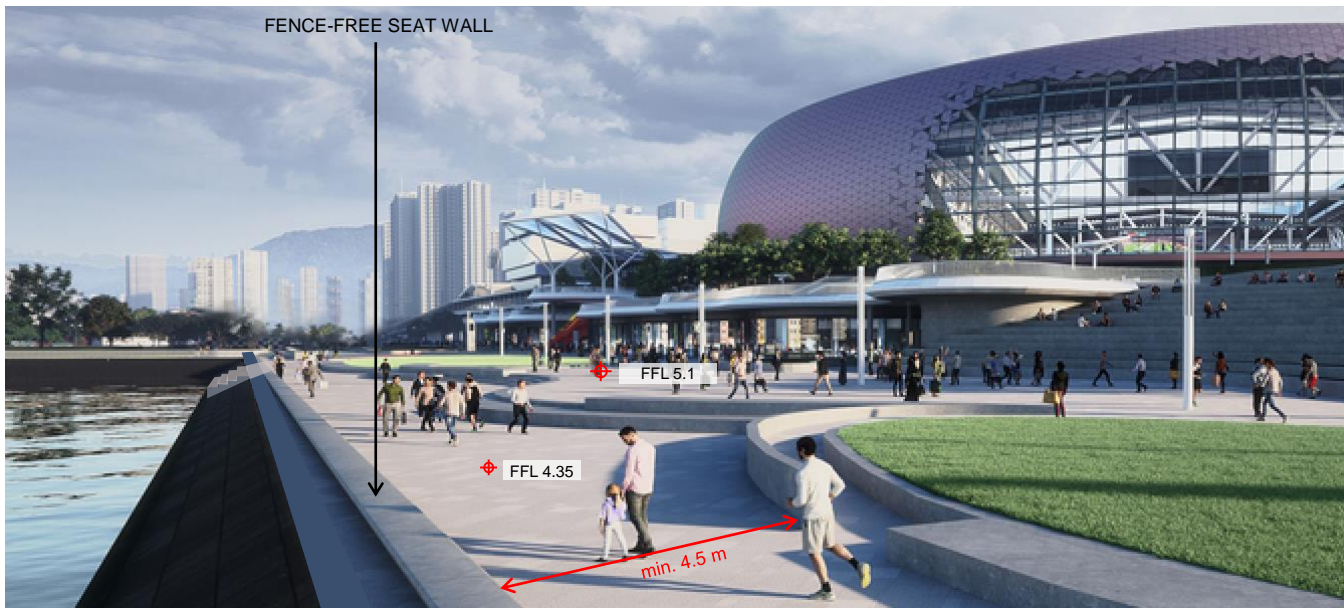
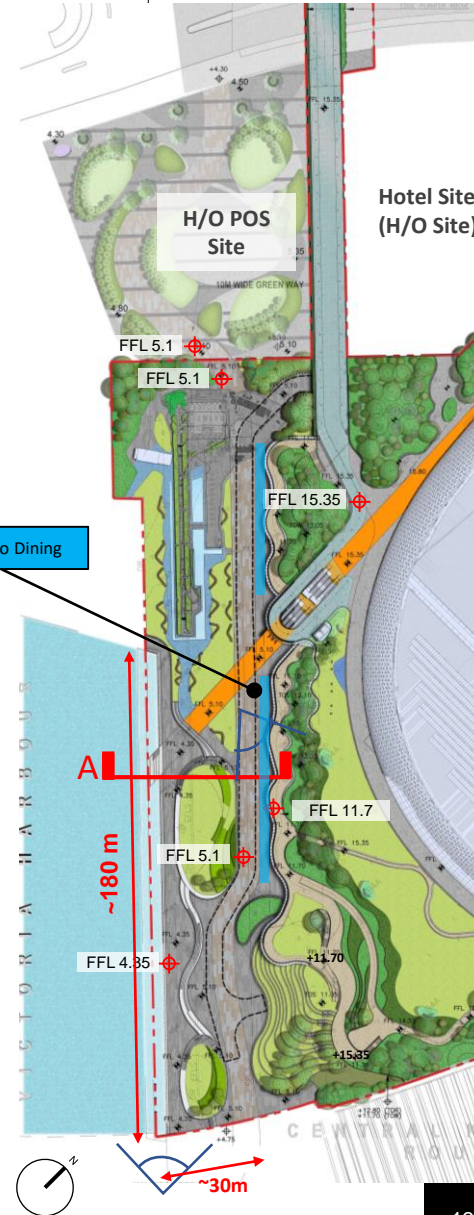

# Harbour Steps

- Continuation of Sports Avenue and connection to the harbour

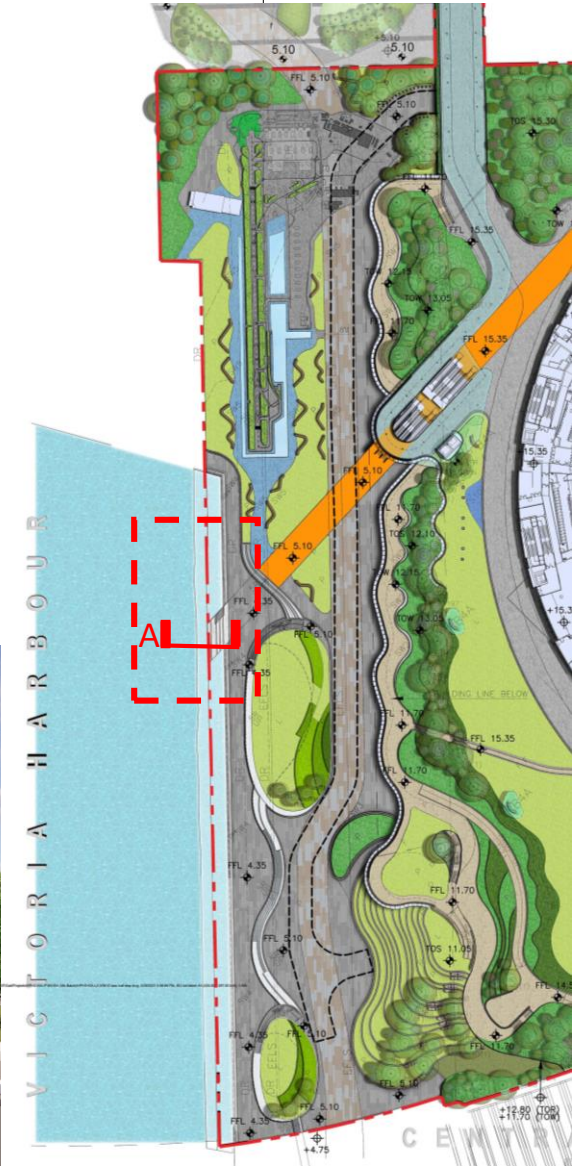
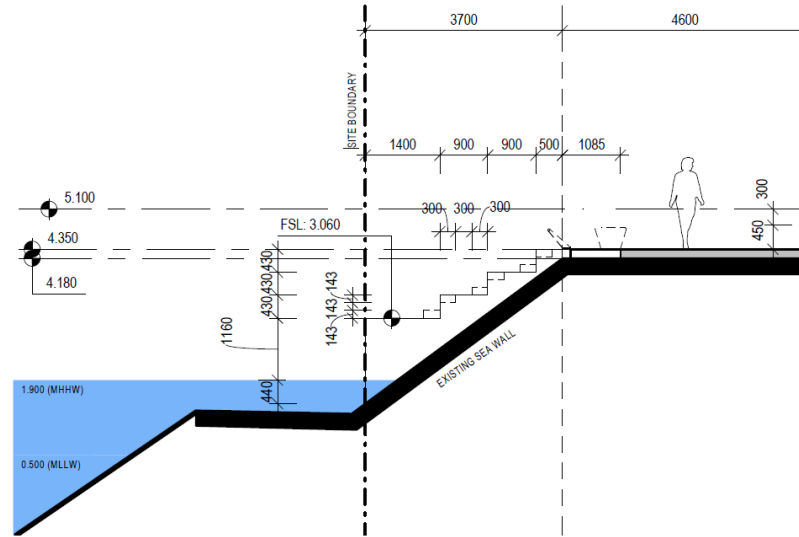
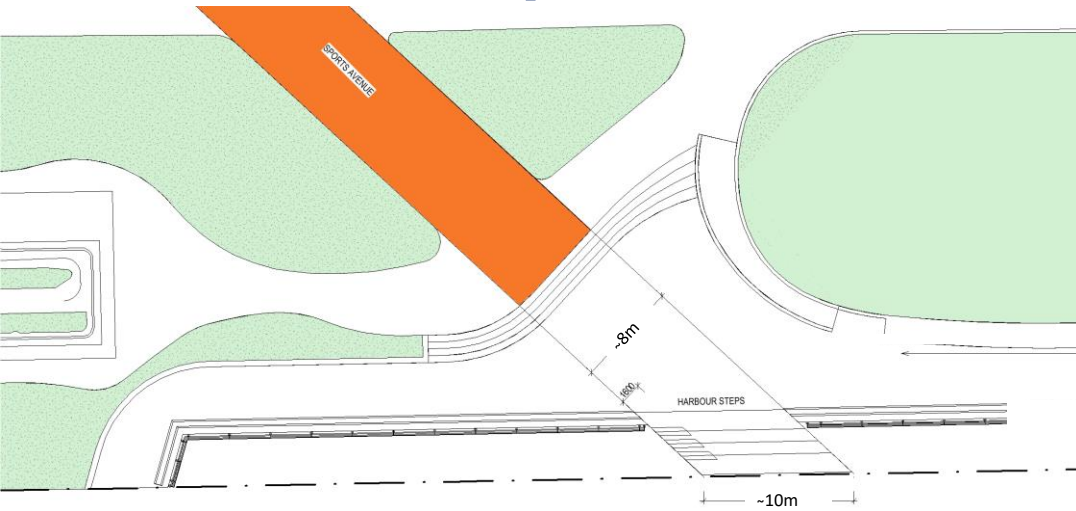

Plan View

Section A

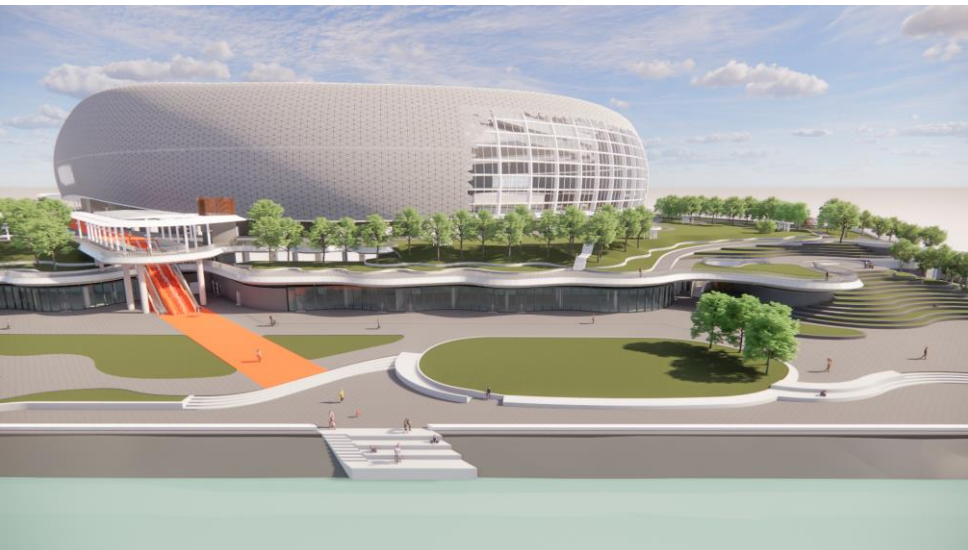

# Harbourfront promenade - sheltered provision





View 1

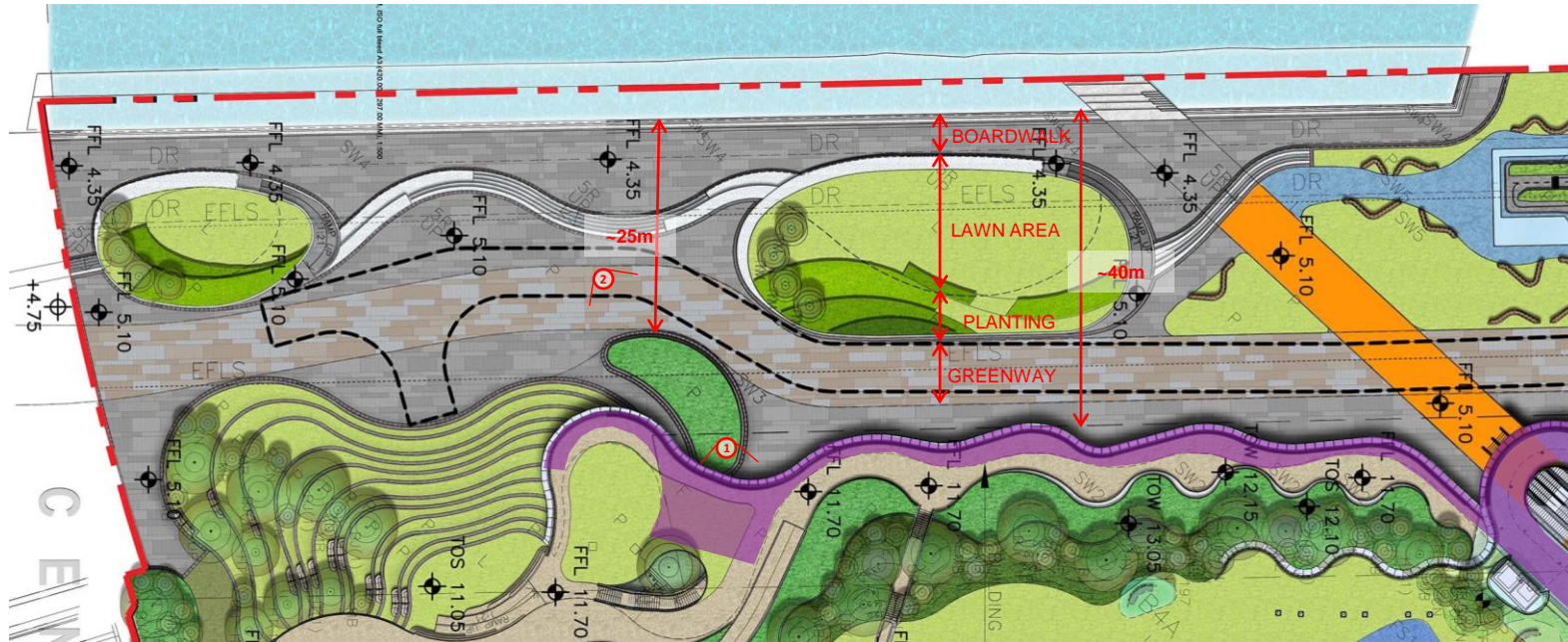

View 2



## Legend:

-  view
-  sheltered provision



KAITAK SPORTS PARK  
啟德體育園

POTENTIAL SHELTER

# Harbourfront promenade – tree shading





View 1

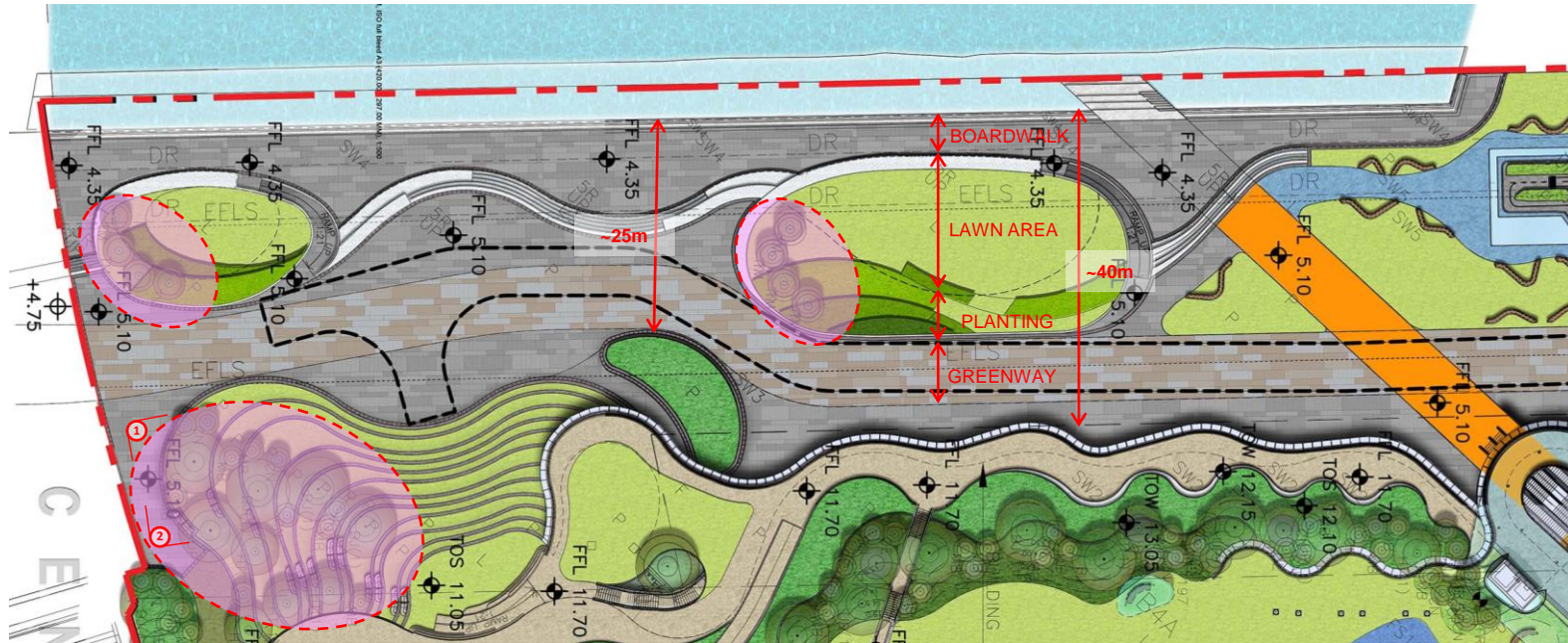

View 2



Legend:

-  view
-  tree shading





# Harbourfront promenade - potential temporary events



Island East Market



Discovery Bay Market

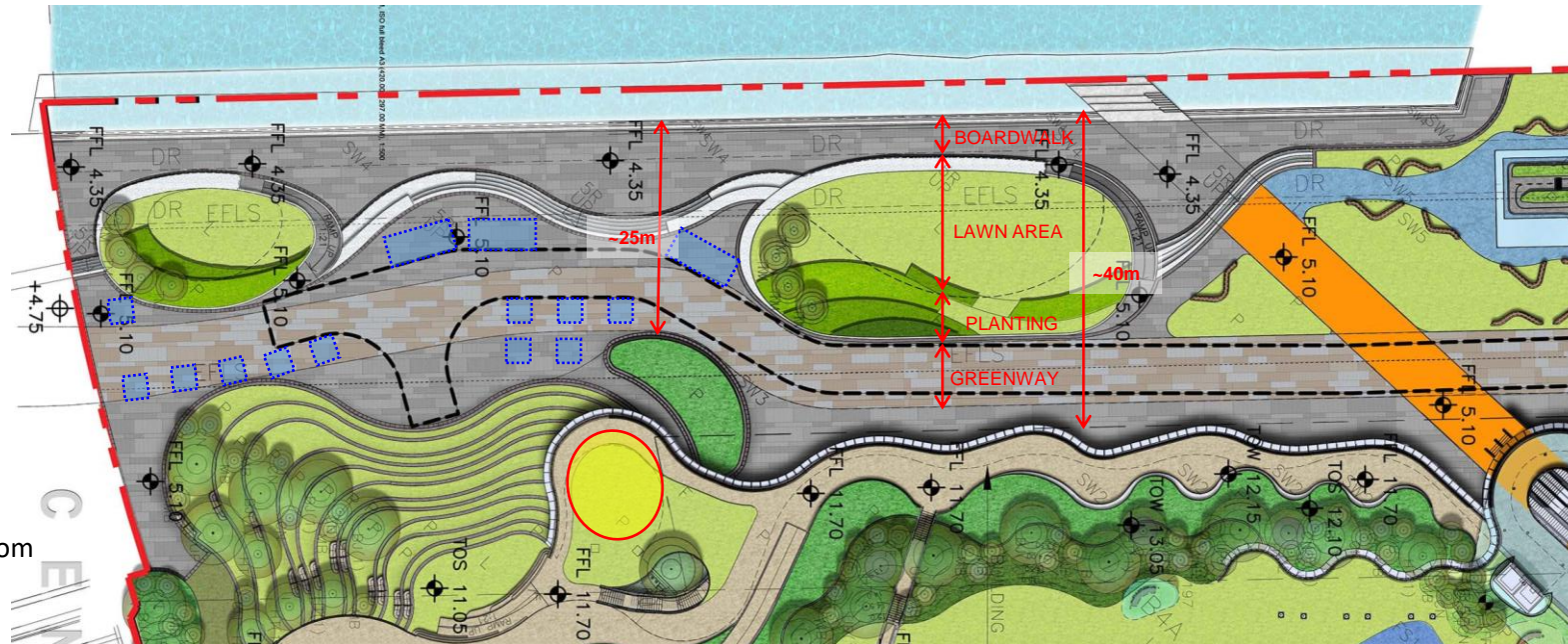

- Legend:
- Potential food truck
  - Potential marquee
  - Toilet and Babycare room

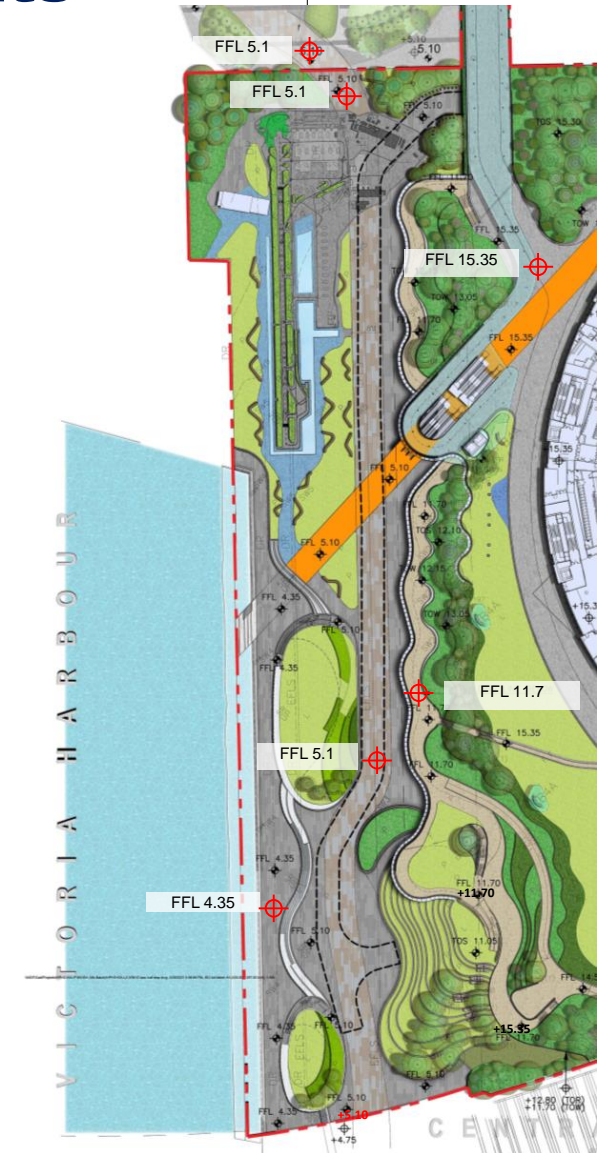

# Master Landscape Plan



MAIN PLAZA



HARBOURFRONT PROMENADE



SOUTHERN TERRACE



SPORTS AVENUE

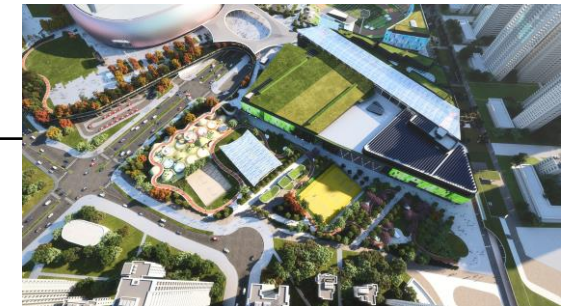

NEIGHBOURHOOD PARK



EVENT VILLAGE

# Neighbourhood Park

- Attracting people to the park with interesting pathways, children's play area and sports courts

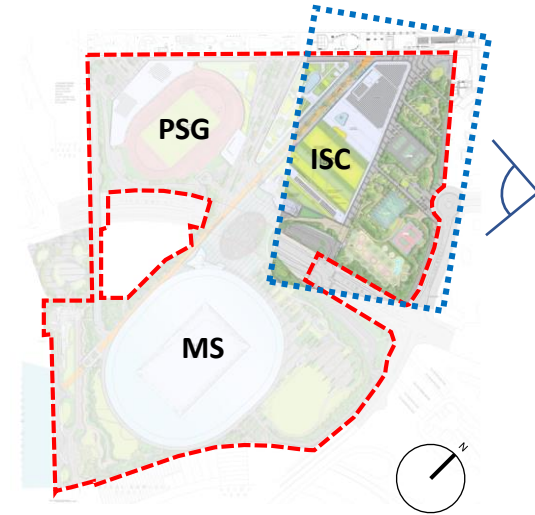
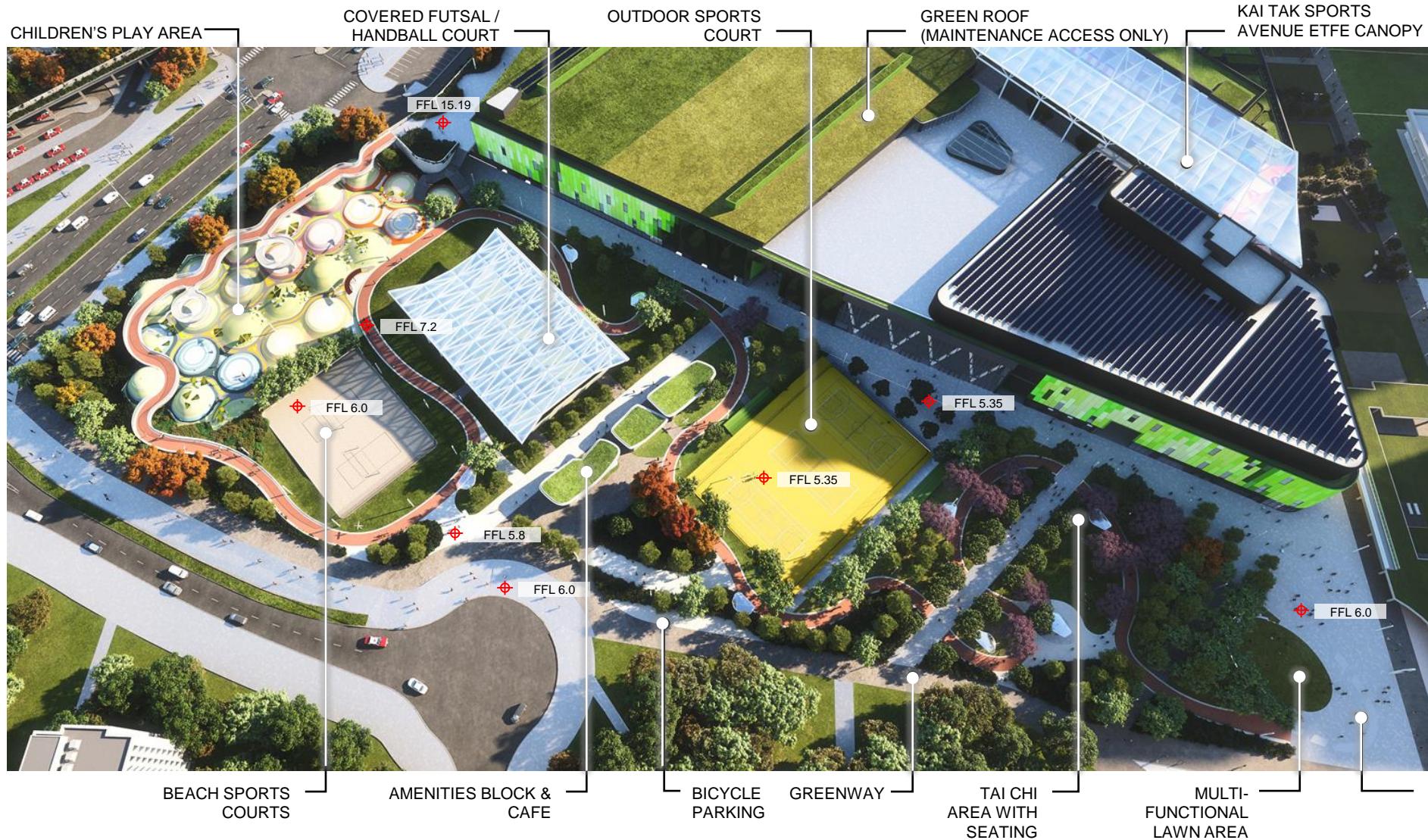

# Event Village

- Adjoining turf area for support of major events and/or open green asset for the community

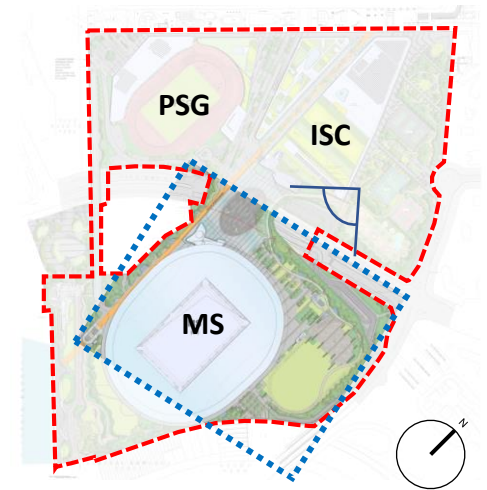

EVENT DAYS

# Adjacent Hotel Site Public Open Space (H/O POS Site)

- Adjoining harbourfront promenade of the Sports Park to provide a dynamic & energetic place for public enjoyment

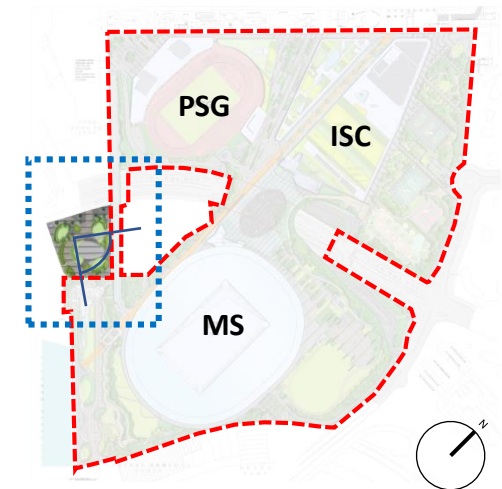
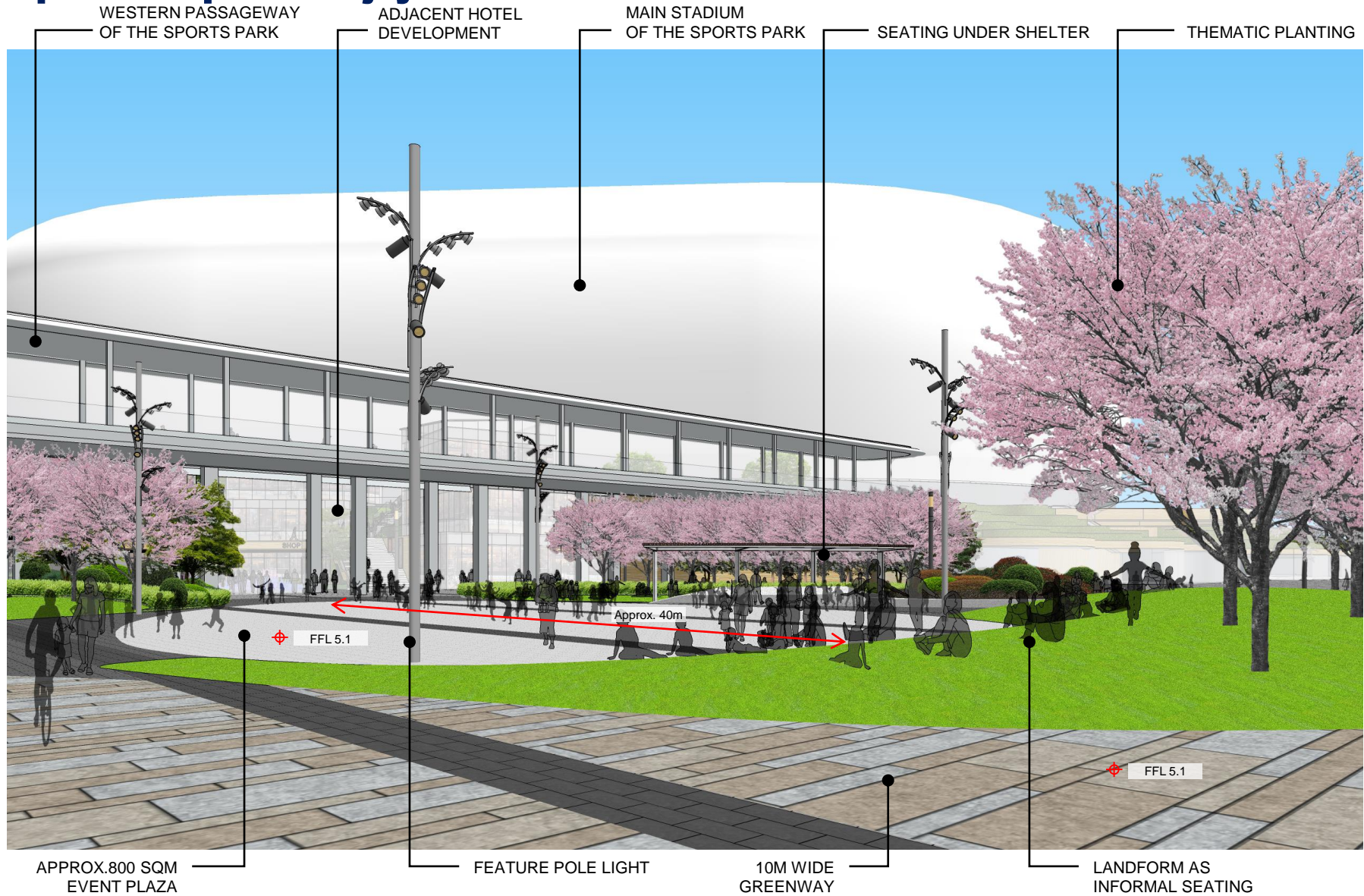

# Landscape Concept: “Green Spine” & “Connectivity”

## Character - Field, Delta & Coast

- Seasonal flowering Tree and Shrub” will be widely planted at the landscaped zones to display different characteristics with colour and texture.

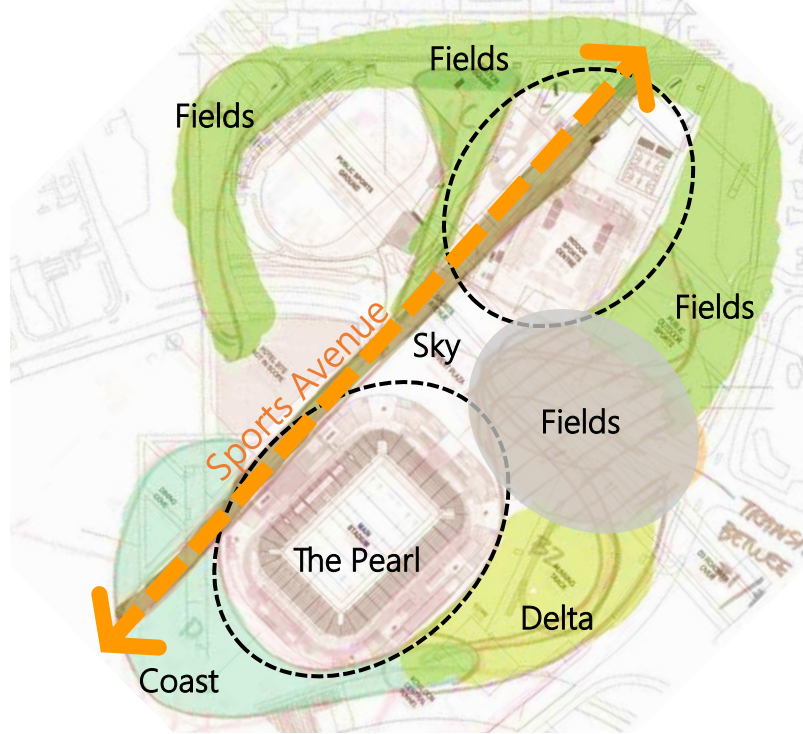

## Green Spine & Connectivity

- Sport Avenue to emphasize the “Axis of Connectivity” to all sport zones as “Green Spine” of planting design
- Strong Links between the hinterland and the harbourfront promenade



←--- Sports Avenue

“Eternity Green” - *Bischofia javanica* 秋楓



←--- Pier Plaza Walk

“Eternity Green” *Ulmus parvifoli* 榆樹



←--- East/West Connections

“Boulevard” *Terminalia mantaly* 小葉欖仁

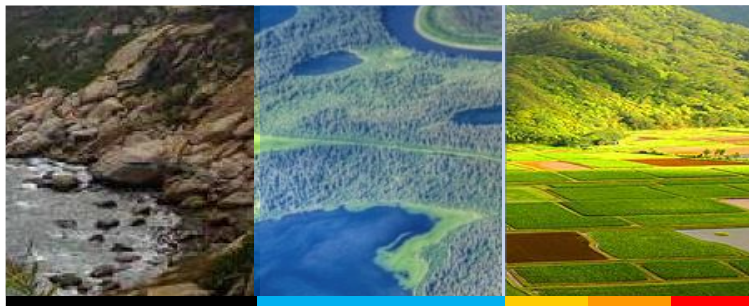

# Planting Design

- **Seasonal vibrancy** activated with colour, scent and textures throughout the year.
- **Extensive planting** integrated across multiples levels throughout the site.
- **Biodiversity** variety of species including native and adapted trees, shrubs and groundcover.
- **Urban Ecology** buffer zones with mounding, layered planting and food sources for birds, pollinating species and urban wildlife.

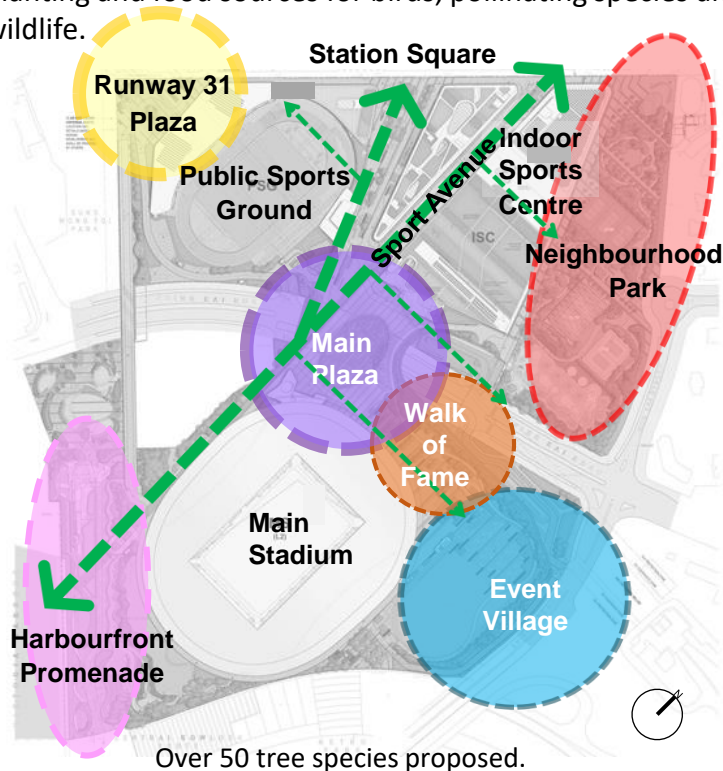

*Peltophorum tonkinense*  
銀珠

“Yellow Harvesting Field”



*Cerasus speciosa*  
大島櫻

*Prunus yunnanensis* "Guangzhou"  
廣州櫻

*Cerasus campanulata*  
鐘花櫻桃

“Seasonal Flowering”



*Magnolia gandiflora*  
荷花玉蘭

*Camellia japonica*  
山茶花

*Osmanthus fragrans*  
桂花

“Refreshing and Fragrant”



(Spring)

(Summer)

(Autumn)

(Winter)

*Liquidambar formosana*  
楓香

“Entrance Precinct of Main Stadium as Colour Medal Focal Point”

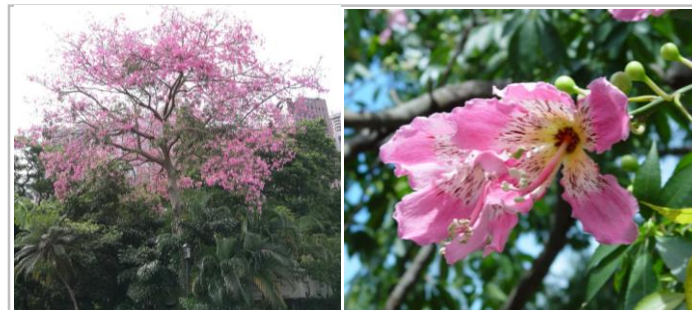

*Chorisia speciosa* St. Hil.  
美人樹

“Open and Breathtaking”



*Jacaranda mimosifolia*  
藍花楹

*Iris tectorum* Maxim  
藍蝴蝶

“Blue Blossoming”

# Green and Sustainable Features

## Green Walls



Image for reference only

Image from www.canevaflor.cl

## Fitness Station & Energy Generator



Image from www.tgoc.com

## Bio-retention System

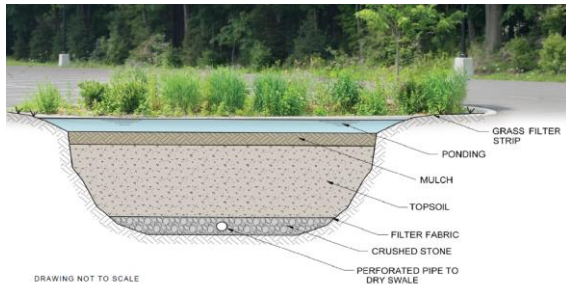
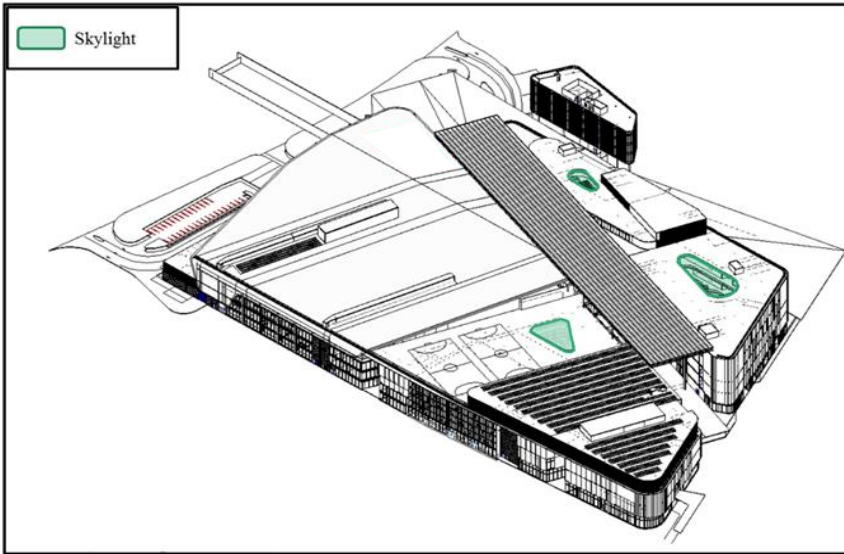
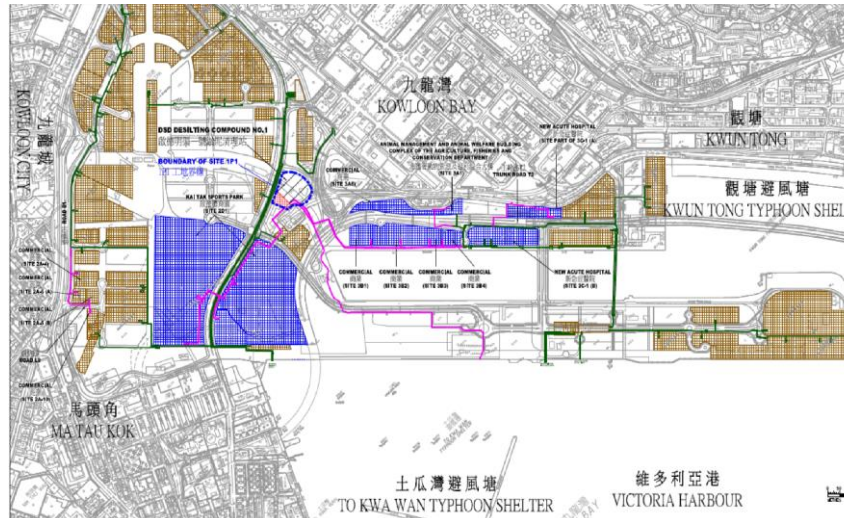

Image from www.lyngsogarden.com

## Natural Lighting - Skylights



## District Cooling System (DCS)



[https://www.emsd.gov.hk/en/energy\\_efficiency/district\\_cooling\\_system\\_at\\_kai\\_tak\\_development/](https://www.emsd.gov.hk/en/energy_efficiency/district_cooling_system_at_kai_tak_development/)

## Natural Cross Ventilation

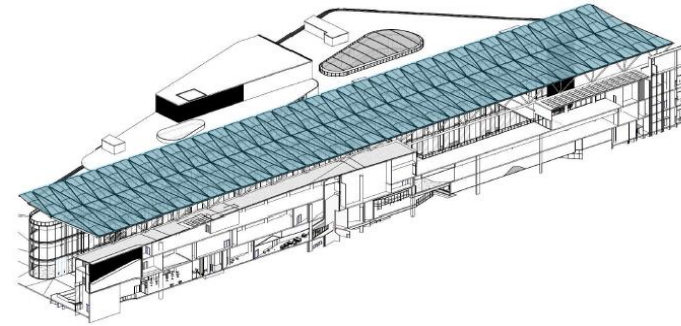

## Roof PV Panels



## Wind Catchers



Supplier: Monodraught – X-Air Thermal Mixing Unit

## KAI TAK SPORTS PARK 啟德體育園

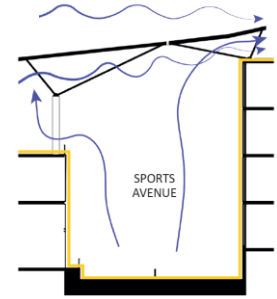

## Natural Lighting - Light Tubes



Supplier: SolaTube - Solar Master 330

## Other Features include:

- Air Induction Units (AIU)
- Outdoor PV Shelter Seating
- Rainwater Harvesting System
- City Air Purification System



# Wayfinding Signage and Public Creatives

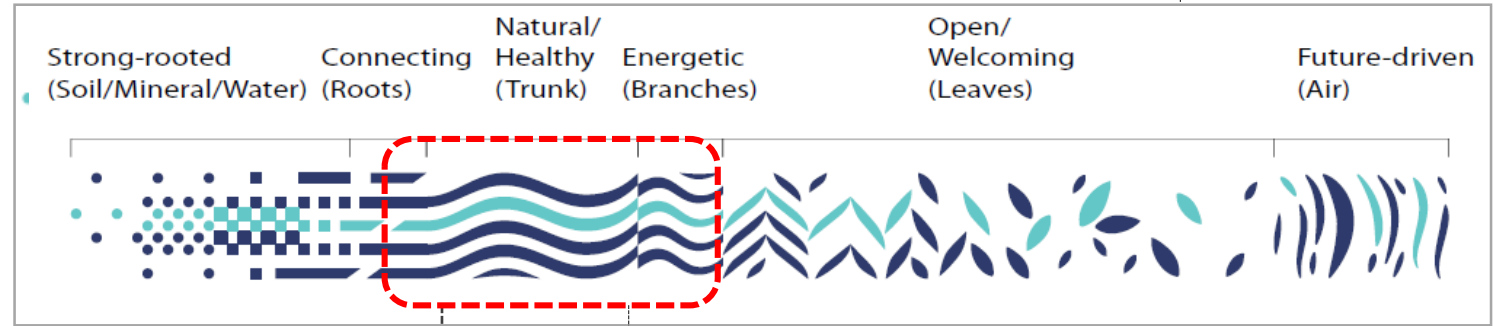

Sports Avenue feature wall



Planting design along promenade



## Wayfinding Signage

Special features:

- Interactive/ Digital Screen
- Crowd Control
- Weather Forecast

## Adoption of CEDD Kai Tak Brand Identity Manual and Public Creative Guidelines in the Sports Park

Potential design features:

- Promenade and Planting design
- Sports Avenue feature wall

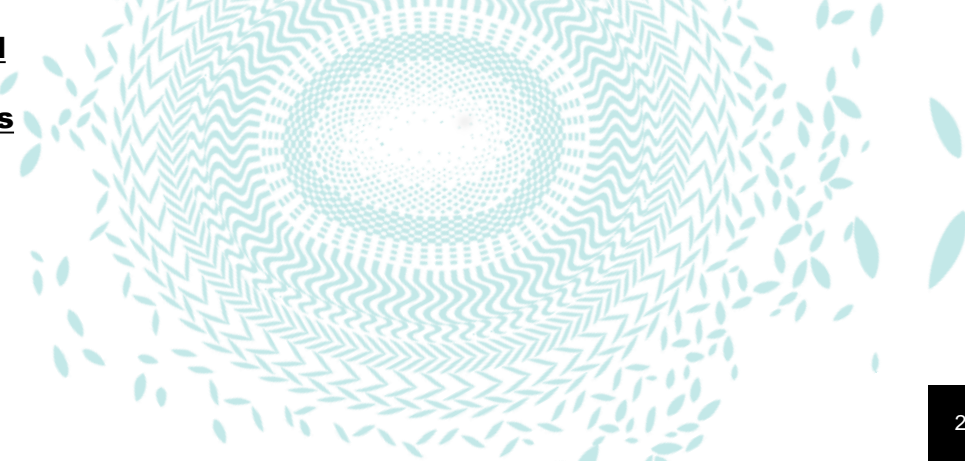

# GreenWay Provisions



**Blow up plan**  
(50 nos. cycle parking at harbourfront promenade)

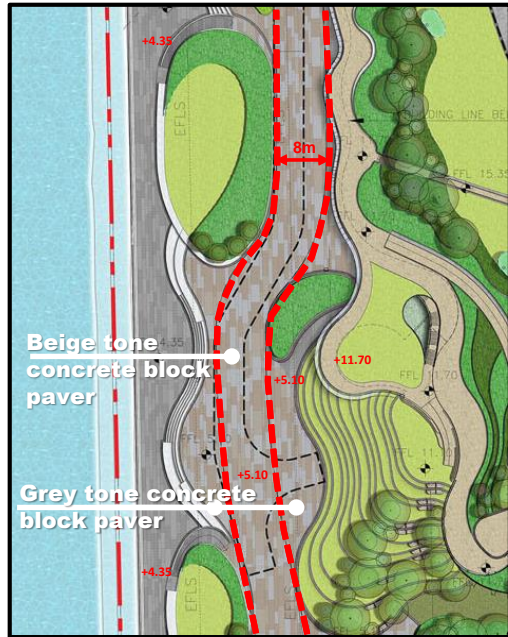

Beige tone concrete block paver  
Grey tone concrete block paver



Source: East Development Office of CEDD

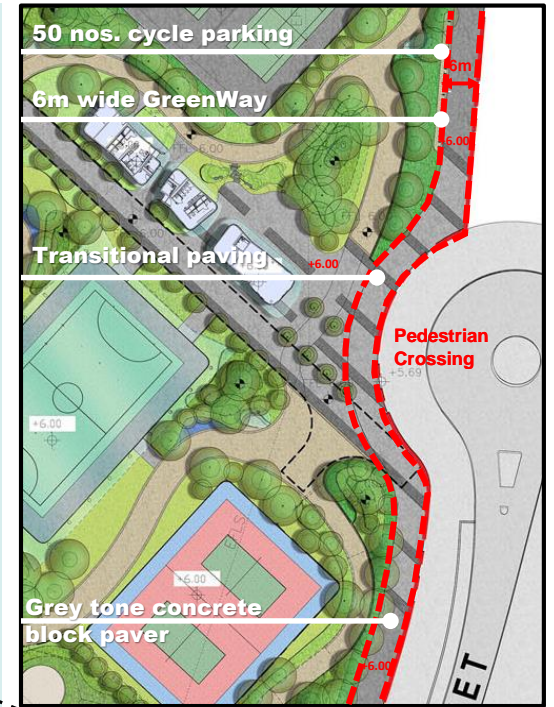

**Blow up plan**  
(50 nos. cycle parking at Neighbourhood Park)



Thank you