



# **Proposed Temporary Water Sports Centre at the Kai Tak Former Fire Station Site**

**Presentation to the Harbourfront Commission,  
Kai Tak Task Force  
28 September, 2018**

# Hong Kong Water Sports Council Membership of National Sports Associations (NSA)

- \* Hong Kong China Dragon Boat Association
- \* Hong Kong China Rowing Association
- \* Hong Kong Sailing Federation
- \* Hong Kong Canoe Union
- \* Hong Kong Water Ski Association
- \* Hong Kong Life Saving Society
- \* Hong Kong Triathlon Association
- \* Hong Kong Swimming Association

# Understanding the Context

- (a) The existing facilities at Shing Mun River, Sha Tin
- (b) The different types of water sports activities that could come to Kai Tak

# Existing Facilities at Shing Mun River, Sha Tin



# Existing Facilities at Shing Mun River, Sha Tin





Outdoor  
Dragon Boat Storage  
at Shek Mun

# Hong Kong International Dragon Boat Championships, Tsim Sha Tsui



Inadequately Sheltered Water : Need to use Lighters  
Not up to International Standards



## Different types of Canoe races







## Canoe Polo



# Youth Rowing Champs 2017



# **Kai Tak Kai Tak Former Fire Station Site**

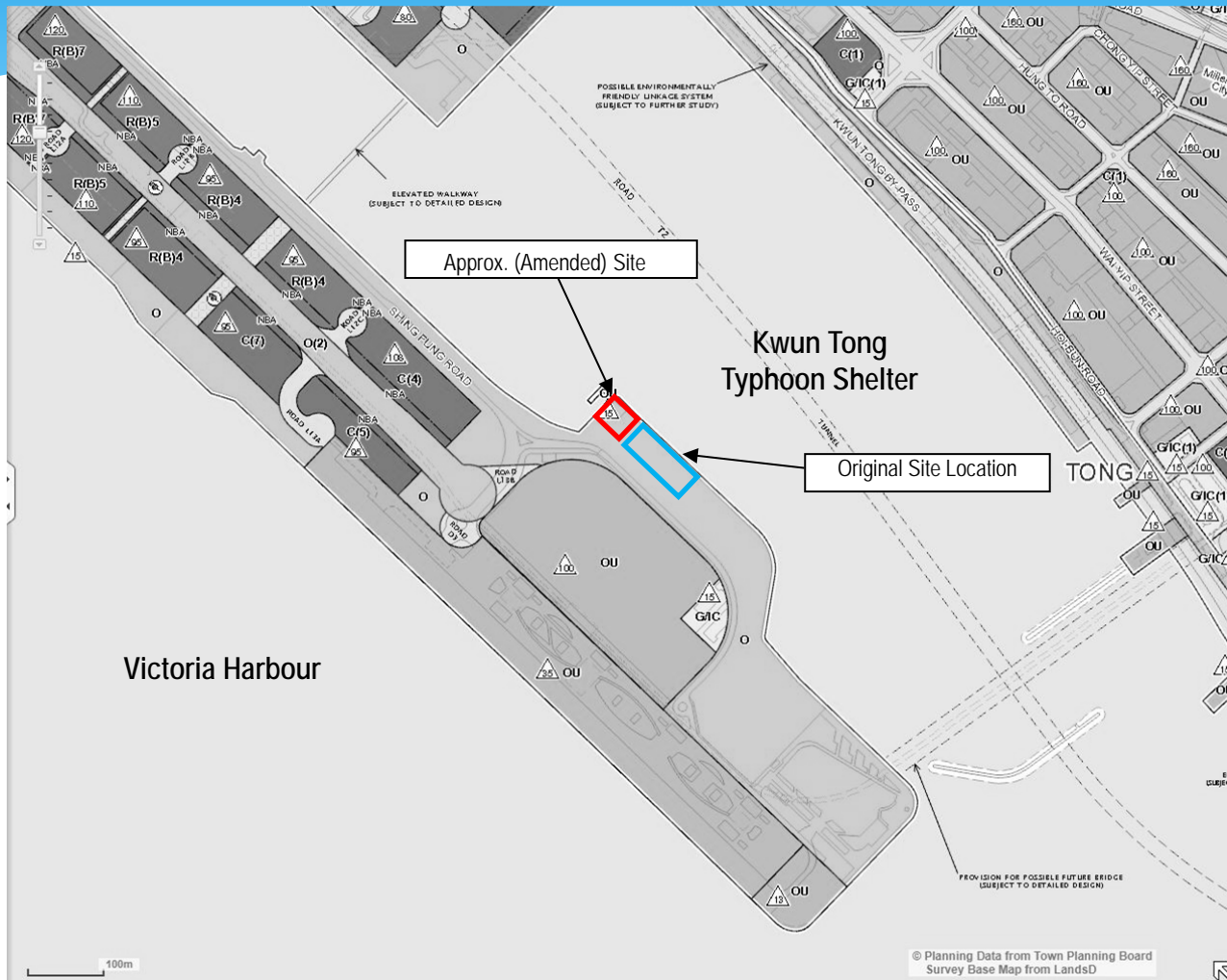

The Amended and Original (previous) location of the proposed Temporary Water Sports Centre

# Draft STT Site Plan from DLO

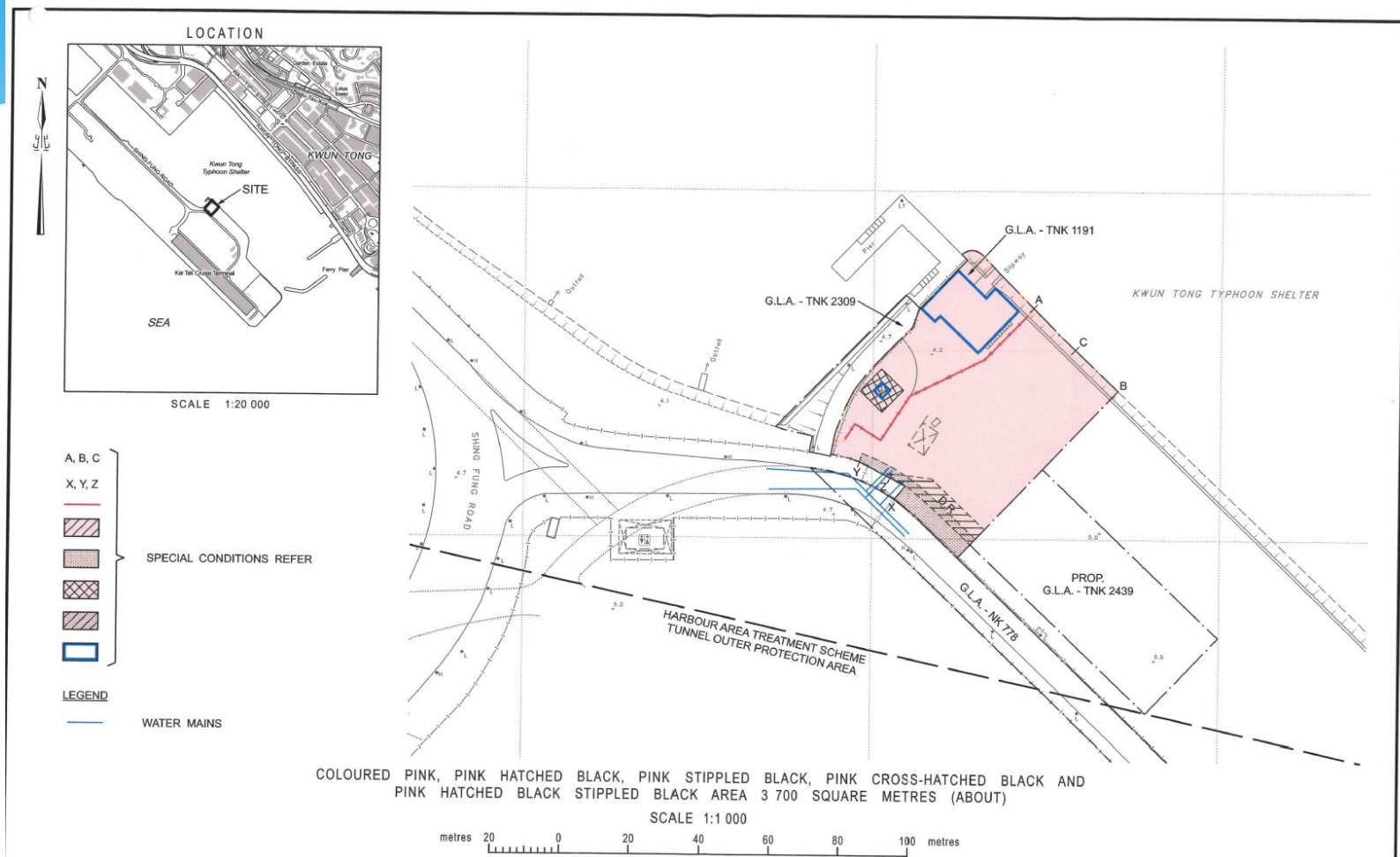

FOR IDENTIFICATION PURPOSES ONLY

District Lands Office, Kowloon East  
Lands Department

Plan Prepared by District Survey Office, Kowloon

© Copyright reserved - Hong Kong SAR Government

TENANCY AGREEMENT No. KX2992

File No. DSO/K W301/3 II\_KE KX2992(A)

Survey Sheet No. 11-NE-22B

Layout Plan No. --

Reference Plan No. --

PLAN No. KM9298-POe

Date : 27/03/2018

# HKWSC Trial Day October 7. 2014



# HKWSC Trial Day October 7. 2014



# Kwun Tong Typhoon Shelter



Location for  
Pontoon  
Landing







# New Pedestrian Access to Pier



Accommodation Schedule		
<b>A Boat Rack Covered Area</b>		
1. Rowing(1)	91 m <sup>2</sup>	
2. Rowing(2)	114 m <sup>2</sup>	
3. Canoe	120 m <sup>2</sup>	325 m <sup>2</sup>
<b>B Facilities within Ex-Fire Station</b>		
1. Changing Rooms		
2. Storage	60 m <sup>2</sup>	
3. Office	40 m <sup>2</sup>	
4. Meeting Room	65 m <sup>2</sup>	
5. Kiosk	20 m <sup>2</sup>	
6. Kitchen	30 m <sup>2</sup>	
7. Gym/ Training area/ Boat Storage	15 m <sup>2</sup>	410 m <sup>2</sup>
<b>C Others</b>		
1. Shower and Changing Room	60 m <sup>2</sup>	
2. Storage	75 m <sup>2</sup>	135 m <sup>2</sup>
<b>Total</b>	<b>870 m<sup>2</sup></b>	<b>870 m<sup>2</sup></b>

### LEGEND

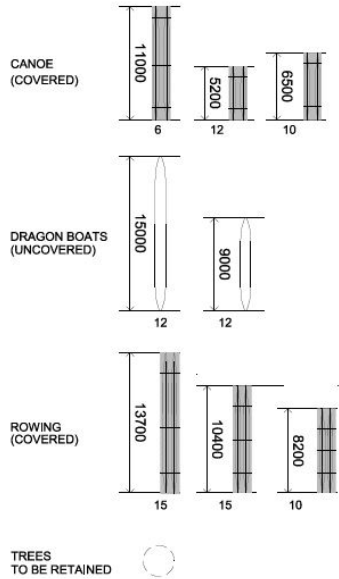

**SITE AREA: 3360m<sup>2</sup>**

ROWING (1): 215m<sup>2</sup>  
 ROWING (2): 200m<sup>2</sup>  
 CANOE: 300m<sup>2</sup>  
 DRAGON BOAT: 410m<sup>2</sup>  
 EX-Fire Station: 339m<sup>2</sup>  
 Communal Facilities: 60m<sup>2</sup>  
 Carpark: 553m<sup>2</sup>  
 Open Space: 1282m<sup>2</sup>

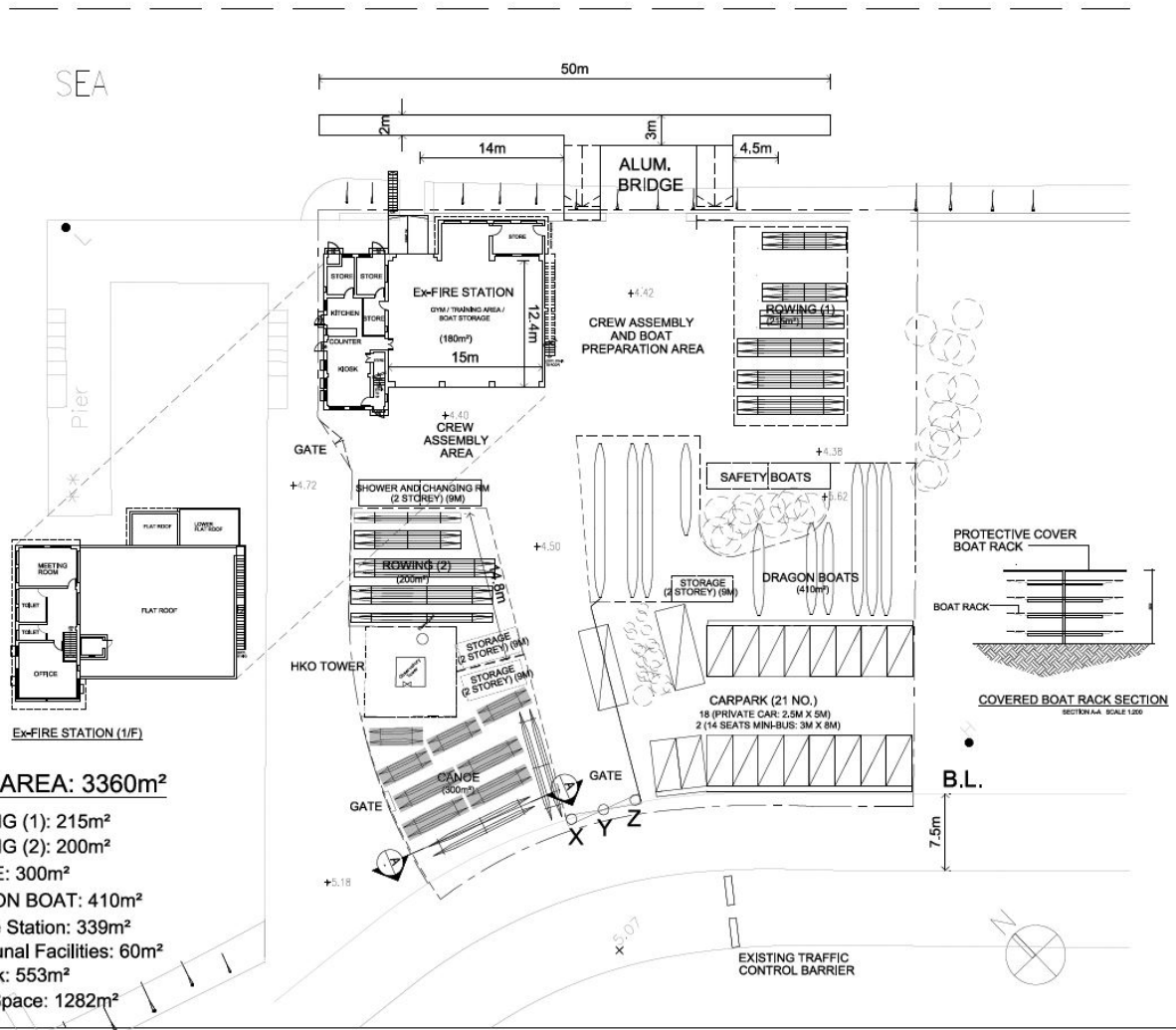

2018-03-01  
Scale 1:400 @ A3

## OVERALL GROUND FLOOR PLAN

**lwk&partners**  
architects

The proposed layout plan of the Temporary Water Sports Centre

# Kai Tak Approach Channel



# Former Fire Station Building Repaired by Government



Former fire station building under maintenance and repair by Government in March 2017

# Existing Entry Point



# Tree Survey and Landscaping



**SCENIC landscape studio limited**  
Rm. 2004, Q&C, 299 Queens Road Central, Hong Kong  
Telephone: +852 2458 2422 Fax: +852 3016 2422  
E-mail: scenic@studioscenic.com

**Legend**

- SITE BOUNDARY
- EXISTING LEVEL
- PROPOSED SCHEME
- EXISTING TREE TO BE RETAINED
- PROPOSED NEW TREE PLANTING

**General notes:**

- All drawings prepared are technical contractor shall perform structural checks to determine value load and processes required.
- Check and verify all dimensions on site.
- Coordinate with other disciplines (e.g. civil and roads) consultant teams and inform them as part of tree design and final design.
- Coordinate with other disciplines (e.g. landscape and other related drawings).
- Verify the landscape without immediate of any discrepancy found then.
- Coordinate with other disciplines (e.g. landscape and other related drawings) for approval prior to.
- Issue of all drawings works to be submitted for landscape architect's approval prior.
- Coordinate with other disciplines (e.g. landscape and other related drawings) for approval prior to.
- All construction of landscape materials to be approved by landscape architect.

Rev.	Date	Description	Initial
A	22/02/2018	GENERAL REVISION	SG

Designed by:	Name:	Signed:	Date:
Checked by:	CL		
Approved by:	JBC		
	CS		

Project Title:  
Kai Tak East Water Sports Centre

Drawing Title:  
COMPENSATORY PLANTING PLAN

Drawing Number:  
MPNP012-TC001

Project Number:  
MPNP012

Scale:  
1:200@A1

Revision:  
-

Date:  
14/02/2018

**PLANTING SCHEDULE**

Code	Botanical Name	Chinese Name	Girth	Crown spread (Dm)	Height (m)	Live crown
TM	Agave molle-leaves	銀葉龍舌蘭	0.25	1.80	2.70	40%
TM	Terminalia orientalis	蓮花樹	0.25	1.20	2.70	40%

**MANAGEMENT AND MAINTENANCE SCHEDULE**

Item	Maintenance Operation	Frequency	Months												Remarks			
			Jan	Feb	Mar	Apr	May	Jun	Jul	Aug	Sep	Oct	Nov	Dec				
1.1	Watering	180 days																
1.2	Litter collection	Daily																
1.3	Weed control	1/2 year	1	1	1	1	2	2	2	2	1	1	1	1				
1.4	Pruning of trees	Twice/year						1										
1.5	Fertiliser application	Twice/year				1					1	1	1					
1.6	Topping up mulch	Twice/year				1					1	1						
1.7	Pest control	As required																
1.8	Replacement planting	As required within 14 days																
1.9	Tree support inspection and adjustment	Once/month	1	1	1	1	1	1	1	1	1	1	1	1	1	1	1	1
1.10	Checking after exceptional weather	As required																
1.11	Joint maintenance inspection (Landscape Architect, Soft Landscape Contractor and Hoarding Club)	Once/month	1	1	1	1	1	1	1	1	1	1	1	1	1	1	1	1
1.12	Tree risk assessment in accordance with DEVB guidelines	Once/year						1										







The Hong Kong Observatory Tower next to the Former fire station building in January 2018. The tower will be retained within the site.

# Conclusion

1. The application for the STT was made in 2013 and has taken 5 years. Hope site can be allocated in 2018.
2. Intention is to have water sports active in Kai Tak Approach Channel and KTTS in early 2019.
3. Water sports activities will then become a permanent part of Kai Tak and Kwun Tong and additional facilities will be required in due course to optimise use of the water bodies.
4. Task Force is invited to note the progress made regarding the Kai Tak TWSC

Thank you