

A VERTICAL ENTERTAINMENT OBSERVATION TOWER

AN ICONIC CITY CENTRE ENTERTAINMENT TOWER
FOR HONG KONG HARBOURFRONT

WHAT IS A VERTICAL ENTERTAINMENT OBSERVATION TOWER?

It is a world's first Vertical Theme Park incorporated in a spectacularly designed Observation Tower, combining observation decks, extreme activities, adrenaline and family rides, an immersive 6D visitors attraction and shopping and dining facilities.







THE TOWER SPECIFICATION

The Tower is 250+m tall and 50m in diameter.
It will take up 4,000 sq. m. alone.

Allowing for public viewing and roaming
area, the total site will be ideally at 8,000
sq.m.

THE TOWER'S ENTERTAINMENT FEATURES

- Multiple Observaton Decks – 4 indoor galleries and an outdoor “summit” deck – accessible by scenic lifts on the outside to the Tower.
- About 20 Extreme Activities, Adrenaline Rides, Family Rides at incredible height. With Children’s Activities featuring aerial adventure within the base of the Tower.
- Virtual Zone World (VZW) – A 360 degree immersive 6D ‘ride film” adventure showcasing he history, culture and progress of Hong Kong.
- Dining and Banquet Facilities – A variety of cafes, alfresco dining, banqueting facilities offering great food and panoramic view of the city.
- Entertainment Facilities – for Shows, Live Performances and Cultural exhibition.
- Shopping Floors – for Merchandising and Gifts.

ALL IN ONE INCREDIBLE 250+M HIGH VERTICAL ENTERTAINMENT OBSERVATION TOWER,
RIGHT IN THE CITY’S HARBOURFRONT,
CREATING FUN AND EXCITEMENT FOR ALL TO ENJOY.





ESTIMATED VISITORS

The Tower has a capacity of 1,500 visitors any any one time, can welcome up to 15,000 visitors a day, and in excess of 5 million visitors per year.

Admission till be by ticketing, in accordance with the participating activities.

THE IDEAL LOCATIONS ON HONG KONG HARBOURFRONT

OPTION A :

Kai Tak Fantasy Site – on the Kai Tak Runway Park towards the end of the Kai Tak old Runway, next to the Kai Tak Cruise Terminal, commanding a spectacular view of the Victoria Harbour and Kowloon City from East Kowloon.



VTP HK : Kai Tak Cruise Terminal





Kai Tak Cruise Terminal



Kai Tak Cruise Terminal



Kai Tak Cruise Terminal



Vertical Entertainment Tower

Vertical Entertainment Tower "Velocity"

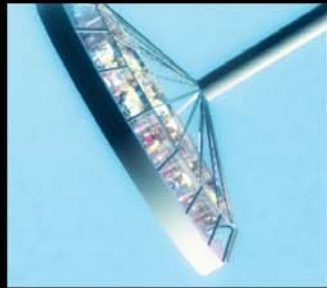
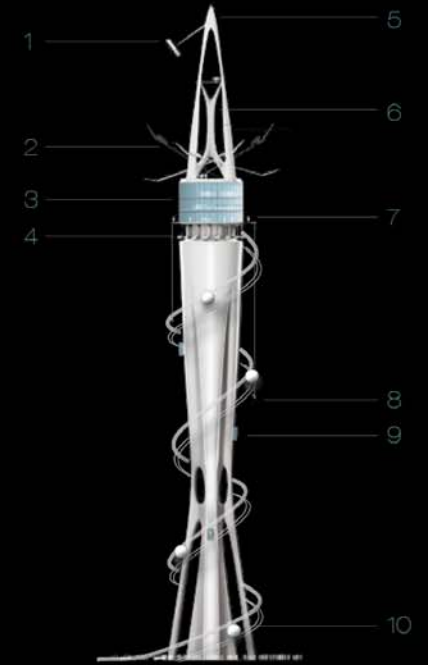

1. Evolution /
Space Shuttle



2. Giant See Saw



3. Observation & Restaurant



4. Flight Trainer



5. Climb to Top



6. Floorless Tilting Drop



7. Sky Walk



8. Sky Jump



9. Scenic Lifts



10. Twisting Scenic Gondola

VTP Global : 5 Proven Theme Attractions in One Incredible Tower



VZW (Virtual Zone World)



THE IDEAL LOCATIONS ON HONG KONG HARBOURFRONT

OPTION B :

Central Harbourfront – Ideal location is at Site 7, right in front of the Edinburgh Place and City Hall. It will command an unobstructed view of the whole Victoria Harbour from a centre point, overlooking the Island, Kowloon Inland and the Nine Dragon Mountain Range.



VTP HK : Central Harbourfront





HK Central Harbourfront



HK Central Harbourfront

HK Central Harbourfront



HK Central Harbourfront





HK Central Harbourfront



A NEW ENGINEERING FEAT BY THE TEAM :

- **VTP GLOBAL LLP, UNITED KINGDOM**
- **INTAMIN, SWITZERLAND**—the world's No. 1 rides designer and manufacturer.
- **VZW LLP, UNITED KINGDOM.**
- **MAA URBAN DESIGNER, TAIWAN AND SHANGHAI.**



VTP Global

VTP GLOBAL : Company Profile

- VTP Global is a British company specialising in premium city centre tourism attractions.
- The company's flagship project is the iconic city centre VTP entertainment tower delivering a globally admired and economically sustainable tourism destination.
- Within the base of the tower is the Virtual Zone World (VZW) providing a 360 degree immersive visitor experience.
- A world class design, delivery, operations and safety team who have represented the themed attractions industry at the very highest level.
- R&D investment to date in excess of US \$15m and exclusive Global Rights (Intamin of Switzerland).
- Phase I international rollout programme including London, Dubai and China (multiple cities).



VTP GLOBAL : Tower Design USPs

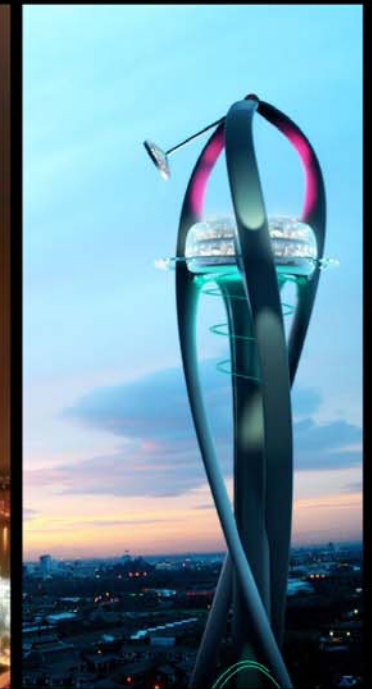

VTP GLOBAL : Vertical Entertainment Tower

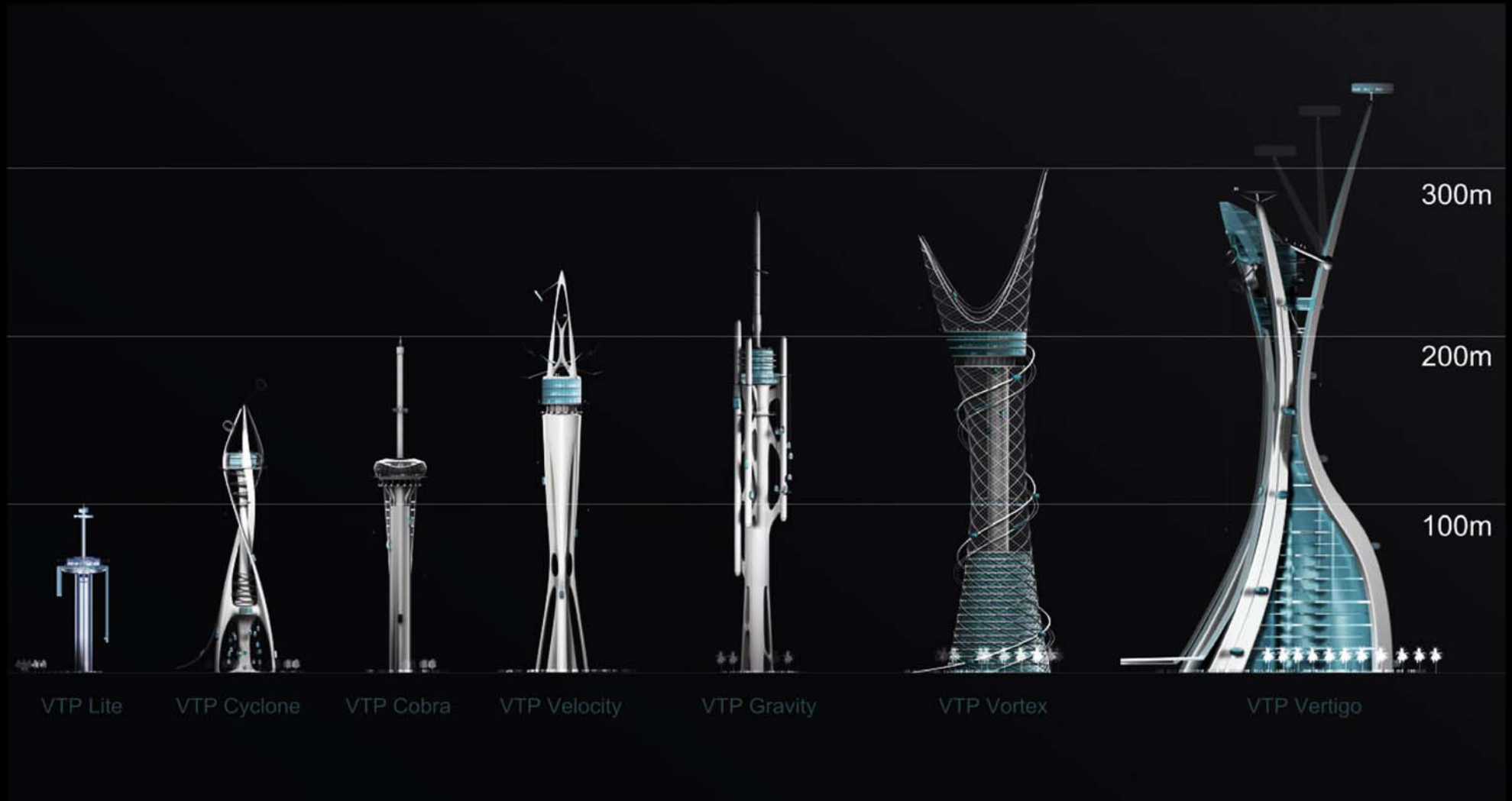

VTP GLOBAL : Company Profile

- A highly experienced and dedicated management team has been assembled for the VTP with specialist skills in:
 - development and project management;
 - international real estate;
 - construction;
 - ride design;
 - tower operations, visitor experience etc;
 - health and safety;
 - global marketing expertise.
- Members of ADIPS, BALPPA and IAAPA.
- The management team is already in place for the Phase I rollout of the VTP.
- Management have represented the leisure industry at the highest levels and contributed to Best Practice in operations and health and safety.
- Operations team headed by leisure veteran, Richard Pawley, who has developed a number of world-first rides.





INTAMIN

INTAMIN : Example Rides



INTAMIN : VTP Example Rides



Sky Coaster



Flight Trainer, Scenic Gondola



Scenic Gondola



Giant Drop



Space Shot



Seesaw



VZW (Virtual Zone World)



VZW (Virtual Zone World) : Company Profile

- A totally immersive 360 degree visitor attraction housed in a series of bespoke 15 meter 'domes'.
- A JV between VTP Global and a team of international film producers lead by industry veteran Kent Walwin.
- Standing or seated domes with hydraulic floors and dynamic 6-Axis Motion Seating.
- Each dome showcases a bespoke 8-10 minute 'ride' film utilising live production, animatronics and special effects.
- For major cities (i.e. Hong Kong) a 'field of domes' would be constructed providing a rich and varied visitor experience.
- Some initial immersive ride ideas for Hong Kong could include:
 - Simulated Flight into the original Kai Tak Airport;
 - Hot Air Balloon 'Journey of a Lifetime' over Hong Kong;
 - Journey to the Centre of the Earth (including Chinese Dynasties).

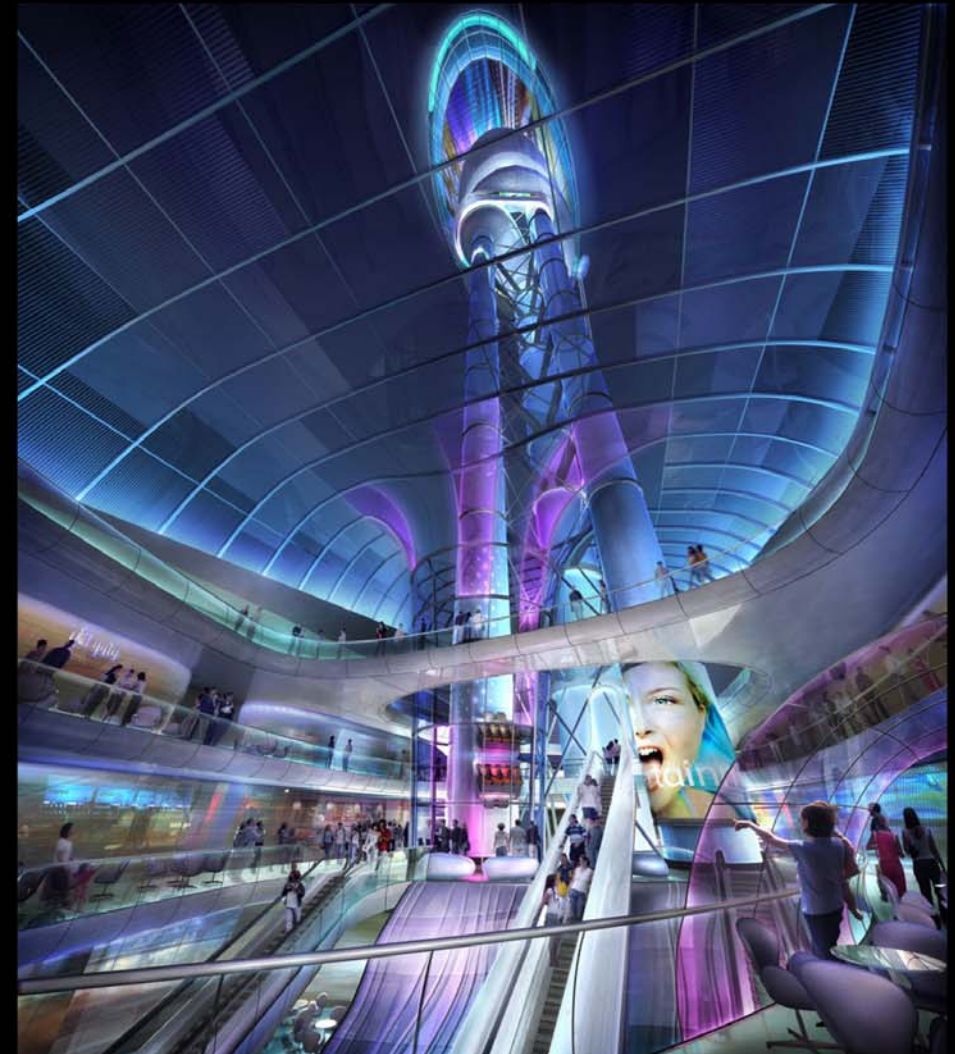

MAA

Motive Architects & Associates

MAA : Company Profile

MOTIVE ARCHITECTS & ASSOCIATES (MAA) was founded in Taipei in 2003 and opened its Shanghai office after setting up China operations in 2005.

In addition to architectural design, MAA is much experienced in large-scale urban planning for mixed-use development projects, landscaping, and interior design. It aims to provide the best possible spatial strategy for clients and their environment by integrating multiple interfaces, in order to solve problems in a proactive manner while exploring various possibilities.

Constantly seeking the quintessential factors and regional distinctiveness of land as a form that embodies significance, MAA vows to enhance the cultural sophistication and quality of each space.



MAA : Projects



Design & Professional Team :



THANK YOU

VTP Hong Kong
Vertical Entertainment Tower

September 2013