

ENCLOSURE A SITE CONTEXT AND CONNECTIVITY

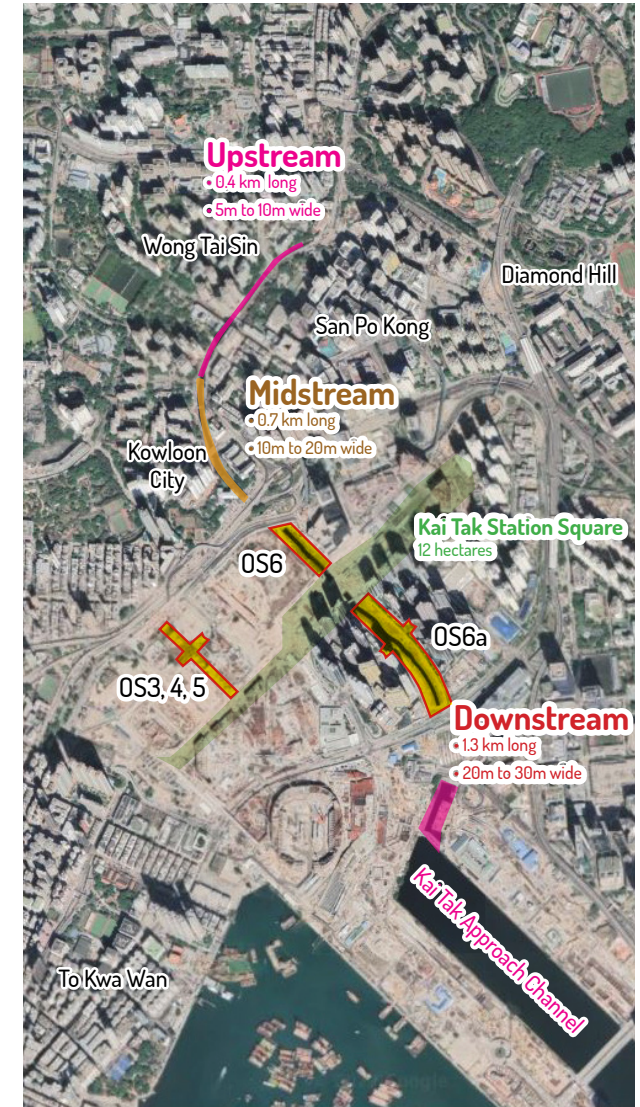
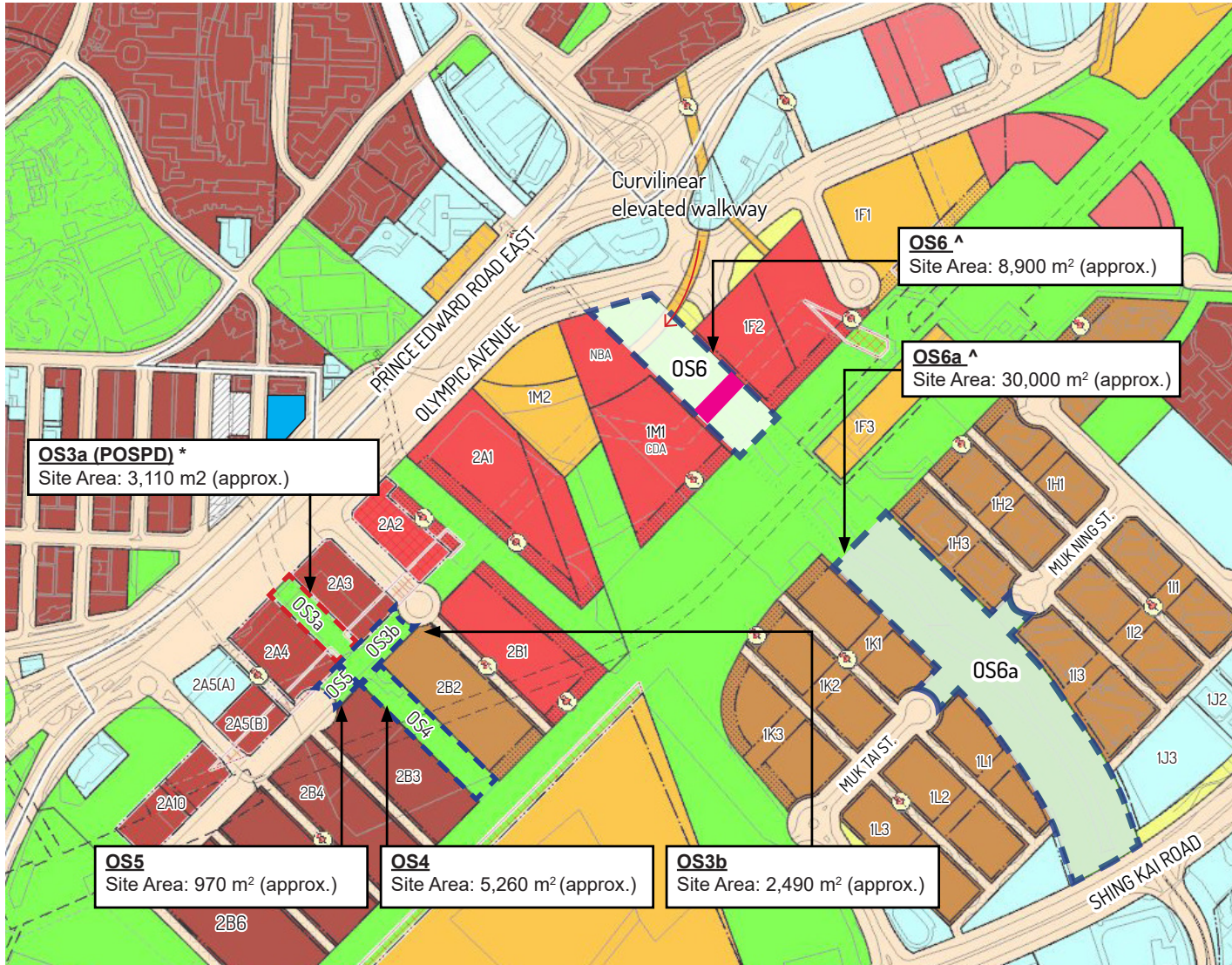

OZP Zoning

CDA Comprehensive Development Area	C Commercial
O Open Space	G/IC Government, Institution or Community
OU(A) Other Specified Uses (Amenity Area)	OU Other Specified Uses
R(A) Residential (Group A)	R(B) Residential (Group B)

* POSPD : Public Open Space under Private Development

^ Area excludes water area of Kai Tak River.



USS : Underground Shopping Street

ENCLOSURE A SITE CONTEXT & CONNECTIVITY

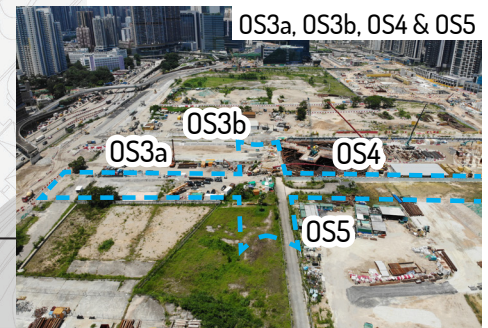
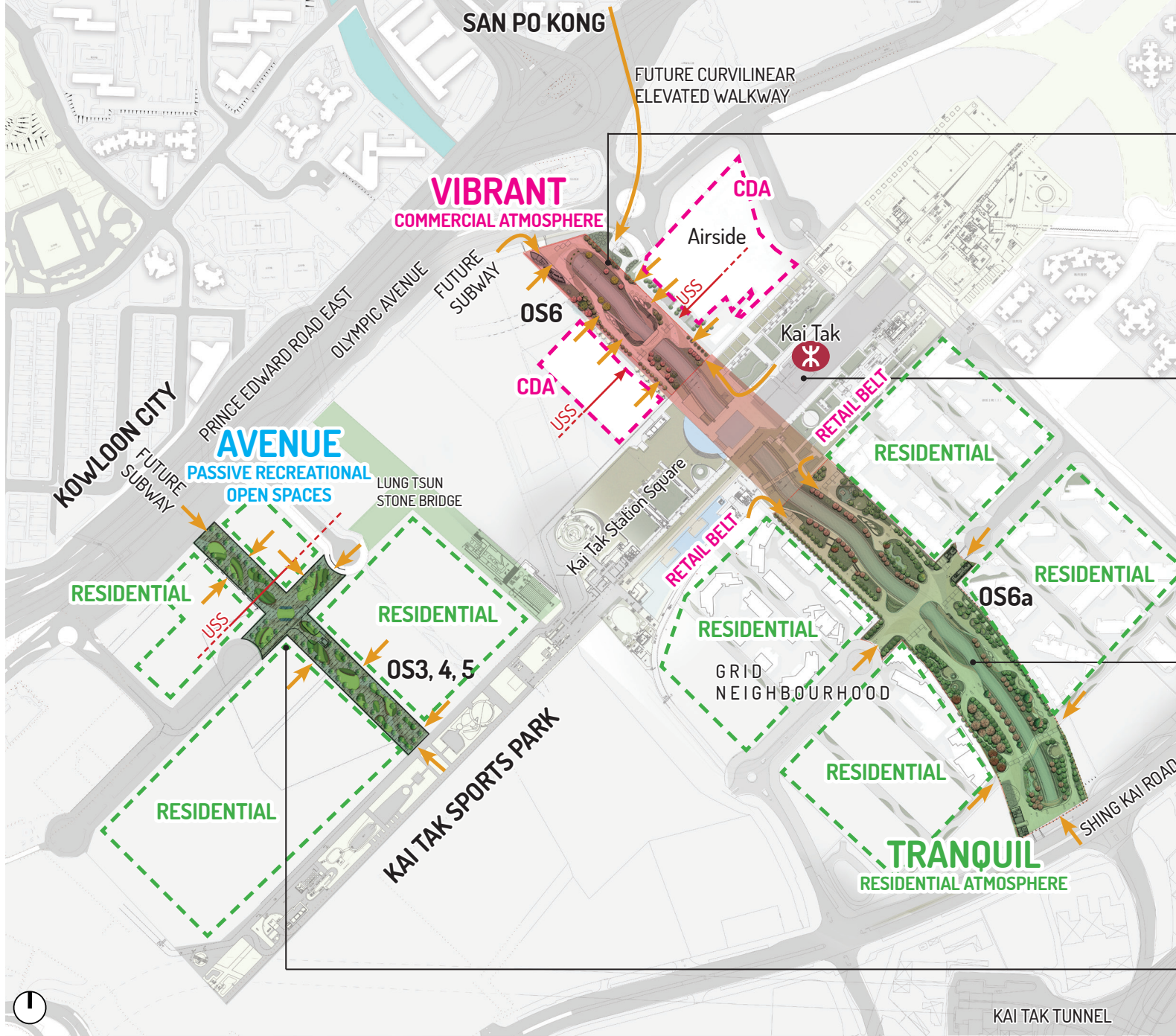

INSPIRED BY THE MORPHOLOGY OF RIVERS...

活水 VITALIZING RIVER



FLOW

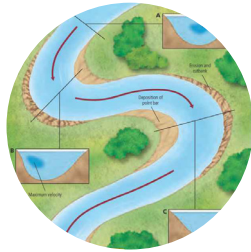

EROSION AND SEDIMENTATION

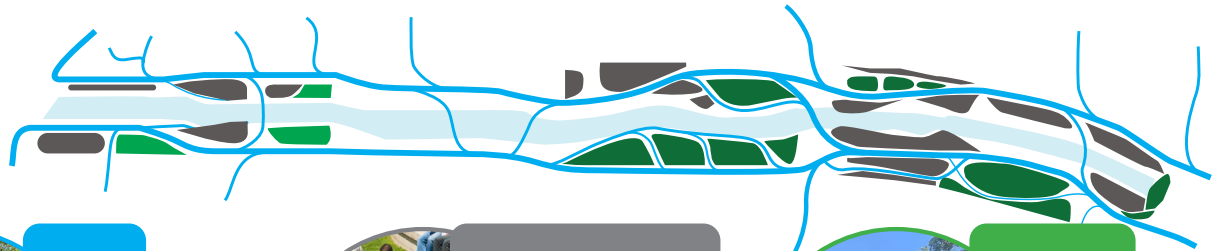

FLOW

Connectivity & Circulation



SEDIMENTATION

Accumulation of Social & Cultural Practices



GROWTH

Enriching the ecosystem

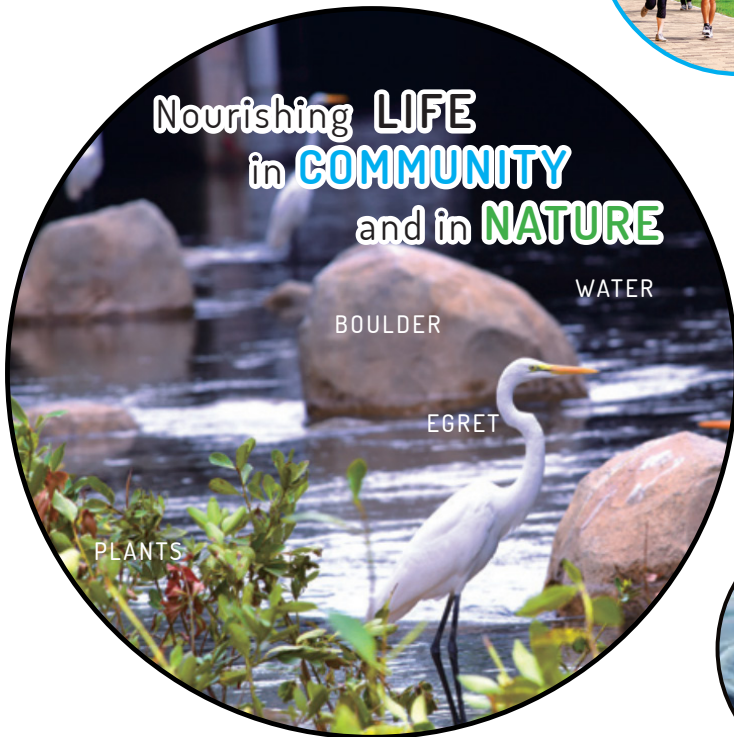

Nourishing LIFE in COMMUNITY and in NATURE

WATER
BOULDER
EGRET

PLANTS



Living Root



Connect Nature



Create Character of Place



Leaves on a Stream



Connect People & Neighbourhood



Urban Oasis

ENCLOSURE C DESIGN PROPOSAL OF OS6 & OS6a

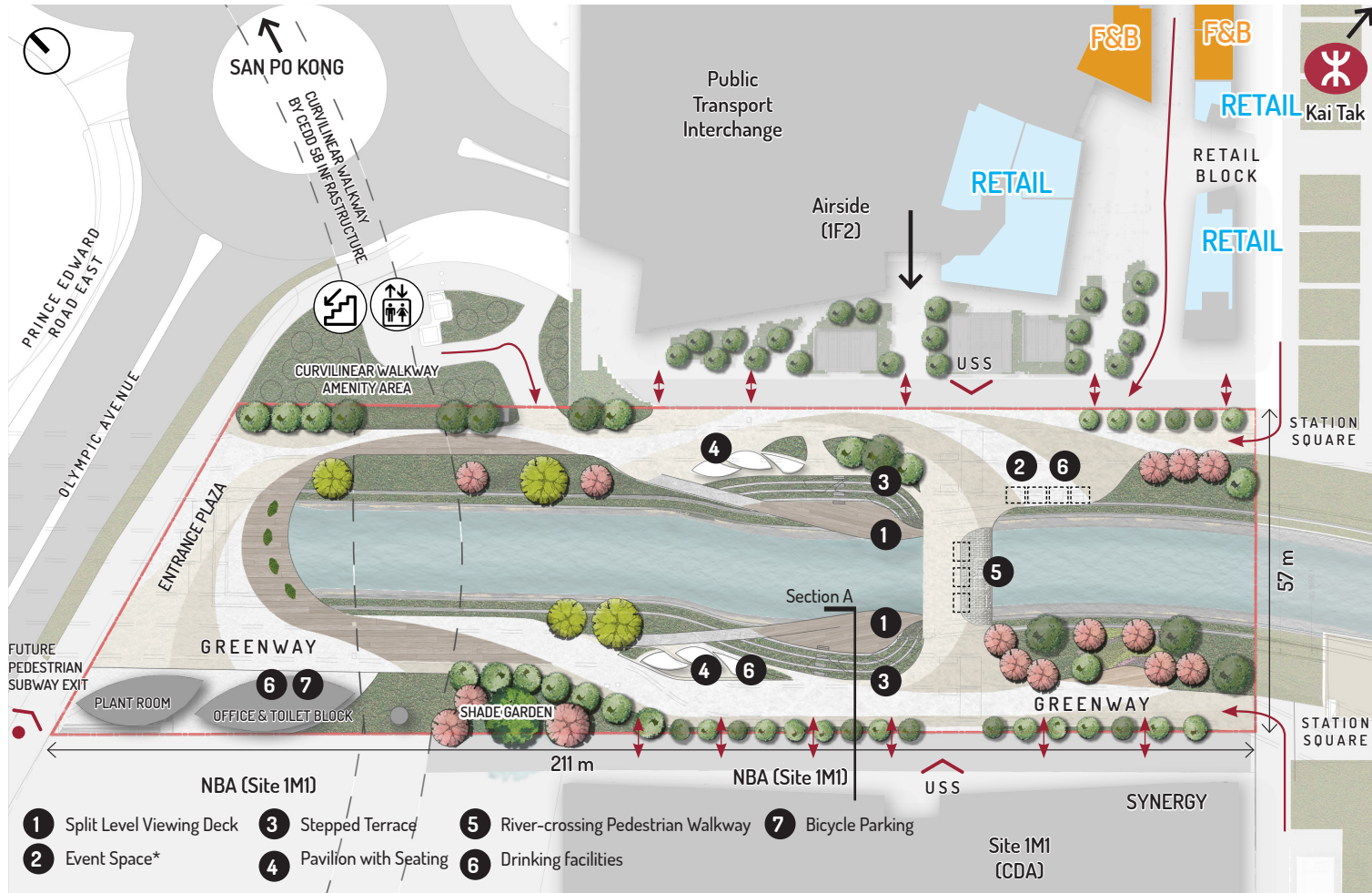

1 Split Level Viewing Deck



2 Event Space



3 Stepped Terrace

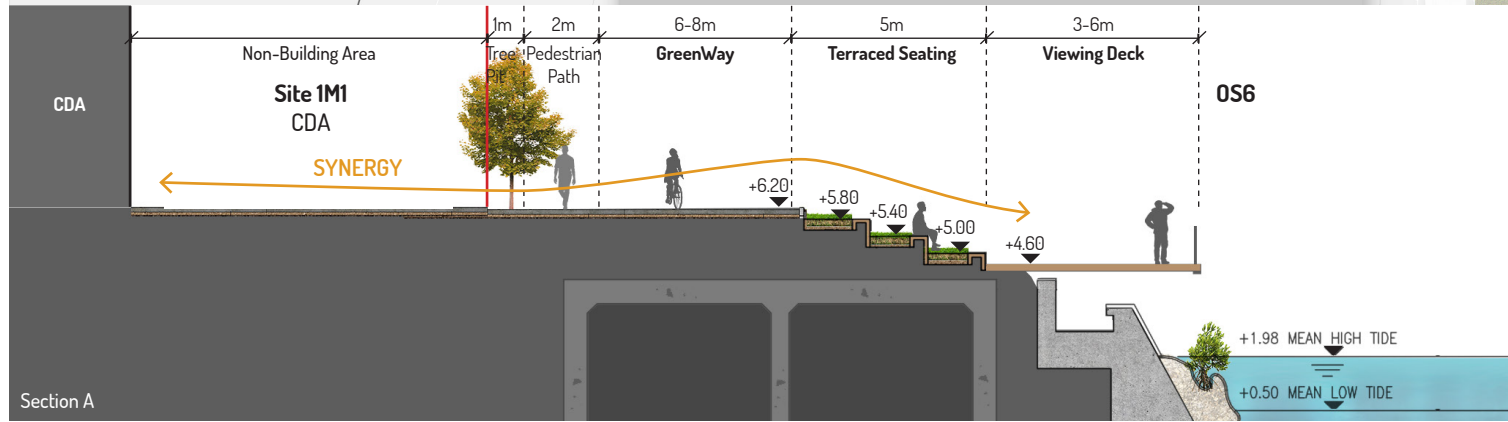

*Only provisions including space, water/power points would be provided in the project

ENCLOSURE C DESIGN PROPOSAL OF OS6 & OS6a



5 Riverside Planting to Enhance Biodiversity



5 Riverine Gardens



6 Canopy of Trees

ENCLOSURE D SOFT LANDSCAPE DESIGN OF OS6 & OS6a

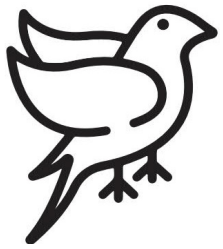
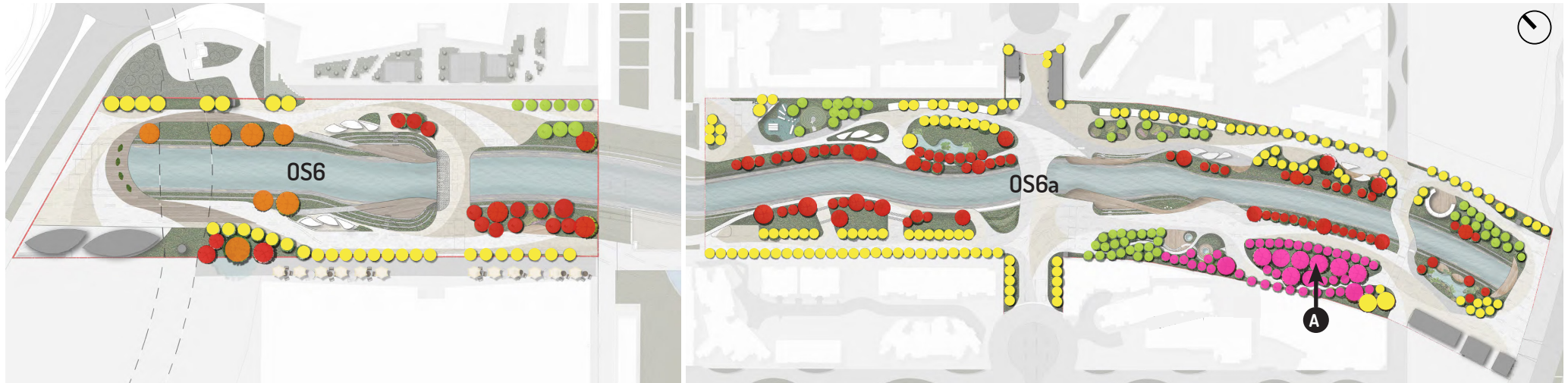

● Feature Tree Along River



Bauhinia variegata
宮粉羊蹄甲

● Feature Tree



Spathodea campanulata
火焰木

● Canopy of Trees



● *Jacaranda mimosifolia*
藍花楹

● Structural Tree Along GreenWay & Pedestrian Pathway



Liquidambar formosana
楓香



● Species Promoting Biodiversity



Hibiscus tiliaceus
黃槿



Melia azedarach
苦楝



Celtis sinensis
朴



Phoenix roebelenii
日本葵



Chrysalidocarpus lutescens
散尾葵

Plants with Hong Kong Local Character



Bauhinia blakeana
洋紫荊



Camellia hongkongensis
香港茶



Rhododendron hongkongense
香港杜鵑



FLESHY FRUITS FOR BIRDS



LARVAL FOOD PLANT FOR BUTTERFLY



NECTAR PLANT FOR BUTTERFLY



Adopting **Native** Plants with **Local** Characters
& Promoting **Biodiversity**



*All proposed plant species are subject to detailed feasibility study

ENCLOSURE E DESIGN CONCEPT AND PROPOSAL OF OS3a, OS3b, OS4 & OS5

