

# Task Force on Kai Tak Harbourfront Development

---

For discussion  
on 14 April 2021

TFKT/02/2021

## Landscaped Deck above Kwun Tong Sewage Pumping Station

### PURPOSE

This paper is to update Members and seek Members' views on the latest design of the landscaped deck under the Project of Enhancement Works for Kwun Tong Sewage Pumping Station (KTSPS).

### BACKGROUND

2. The Project of Enhancement Works for KTSPS was implemented to cope with the forecast increase in sewage flow from the committed and planned developments in the East Kowloon, in which a balancing tank is proposed next to the KTSPS to temporarily retain excess preliminarily treated sewage discharged from Kwun Tong Preliminary Treatment Works (KTPTW) during the peak flow period. In order to minimize the visual and odour impact to the community in the vicinity, the balancing tank and the KTSPS will be covered by a landscaped deck. The landscaped deck will be transformed to an open space of about 11,000 m<sup>2</sup> for public enjoyment. The Project location is shown in **Annex A** for reference.

3. Previous consultation on the Project was conducted in the 23<sup>rd</sup> meeting of Task Force on Kai Tak Harbourfront Development held on 18 November 2016 as well as in the 38<sup>th</sup> meeting of Harbourfront Commission held on 28 January 2021 and Members supported the Project.

4. The construction commenced in end 2017 and the target completion date is end 2022. The underground structures were completed and the construction of superstructure is on-going.

### LATEST DESIGN OF THE LANDSCAPED DECK

5. Sewage facilities are generally perceived by the public as unpleasant and aesthetically dull public infrastructures. The design concept of the landscaped deck is to integrate these facilities with the community and to achieve harmony with the adjacent

environment. The structural form of landscaped deck envisages a graceful pattern of curvilinear lines rhythmically swaying all the way along the direction of Kowloon Bay.

6. The balancing tank and the KTSPS would be situated under the landscaped deck of about 11,000m<sup>2</sup> in size. The landscaped deck will act as a physical barrier to mitigate visual impact and control unpleasant odour. Greenery, seating, shades, children playing area, elderly exercise area as well as supporting facilities such as toilet and drinking fountains will be provided on the landscaped deck.

7. The landscaped deck is enhanced to be a public-oriented environment with integration of public social spaces and entertaining zones suitable for all ages for public enjoyment. Such facilities include play spaces to encourage children to explore and challenge themselves; fitness facilities for the elderly to exercise; and multi-purpose area for all age group to mingle. With the barrier-free access and the inclusive play facilities, people who are wheelchair-bound can also spend a joyful time on the landscaped deck. **Annex B** shows the architectural design of the landscaped deck.

8. The soft landscape design aims at using both native and exotic species which harmonizes with the neighbourhood greening to create a continuous ecological corridor along Tsui Ping River area. Species are also chosen for their seasonal aesthetics effects, their suitability to the theme of the play space, and their hardiness in the waterfront condition.

### **CO-CREATION OF A 'PLAYFUL NATURE' PLAY SPACE**

9. To echo with the Chief Executive's 2019 Policy Address that public open spaces in districts should provide interesting play areas with innovative elements for children, DSD explored to review and study the play space on the landscaped deck of the KTSPS. The design of the play space was based on the playable space audit, children participation and a co-creation and inclusive approach through a series of community engagement activities spanning over the year of 2020.

10. The landscaped deck, locating adjacent to Tsui Ping River and Kwun Tong harbourfront, offers worthy opportunities for children to engage nature in an urban setting. It is proposed to

cultivate an environment and an atmosphere for free play in this site by reconnecting the elements of nature with children and unearthing the essence of children play. **“Playful Nature”** is an attempt to deliberately integrate play with the living landscape, and promote a full-body engagement with the environment instead of leaving nature as a backdrop of children’s activities. The natural elements of Air, Sun, Sky, Ground, and Water are infused into the play settings, triggering children to play with space (play equipment and facilities); play with people (families and peers); and play with different living things (plants & animals). Fitness facilities and multi-purpose area are also blended into the play space, allowing people in all age group to enjoy the playful nature. The design of the play space is shown in **Annex C**.

### **CONNECTIVITY**

11. Four entrance are provided for the landscaped deck and two of them are barrier-free access. The connectivity of the landscaped deck will be further improved after the completion of the junction improvement works at J/O Wai Yip Street and Kwun Tong Bypass Up-ramp as well as the footbridge crossing Tsui Ping River under another DSD project. Details of the connectivity are shown in **Annex D**.

### **WORKS AREA TGLA-TNK 2415 & 2437**

12. In line with the “Incremental Approach” in opening up the promenades for the public, we plan to carry out simple reinstatement works for the works area that we have occupied at the seafront (TGLA-TNK 2437) upon expiry of our occupation in end 2022 and open for public enjoyment. Suitable connection facilities for allowing public to transit from the seafront to our landscaped deck will also be explored.

13. The current TGLA-TNK 2415 at Wai Lok Street, which accommodating the site office of the project of Enhancement Works for KTSPS and Upgrading of KTPTW, will expire on 30 June 2021. We are now applying a 2-year extension till 30 June 2023. In order to optimize the uses of government land, it is also proposed to accommodate the site office of the project of Revitalisation of Tsui Ping River in the same TGLA. As the target completion of the Revitalisation of Tsui Ping River will be 2024 Q3. Subject to our further deliberation with the Education Bureau and Vocational

Training Council (VTC), it will be our intention to further extend the TGLA until mid 2025 provided that it would not cause any delay to the delivery of VTC's campus project and the waterfront promenade to be constructed under the same project scope. The location plan of the works areas is shown in **Annex E**.

### **COMPLIANCE WITH HARBOUR PLANNING PRINCIPLES**

14. Reference has been made to the Harbour Planning Principles when planning the proposed design –

#### Principle 1: Preserving Victoria Harbour and Principle 5: Proactive Harbour Enhancement

- (a) The project will not involve any reclamation works. The balancing tank will temporarily retain excess preliminary treated sewage during the peak flow period such that the water quality of the harbour will be preserved and protected.

#### Principle 2: Stakeholder Engagement

- (b) The design of the play space is formulated based on children participation program and various community engagement activities.
- (c) The District Facilities Management Committee of the Kwun Tong District Council (KTDC) had been consulted. The Committee of the KTDC supported the design.

#### Principle 3: Sustainable Development

- (d) Taking the opportunity for land co-use with public, the project will convert the facility into a fusion of modern urban utility building primarily serving as a 'sewage pumping station' and as a functional landscaped deck for public enjoyment. It will be a pioneer in blending "Not-In-My-Back-Yard" (NIMBY) infrastructure into the community and thereby achieving a win-win situation.

## **Task Force on Kai Tak Harbourfront Development**

---

TFKT/02/2021

- (e) Solar panels to harvest solar energy for lighting, and skylights to provide natural lighting for KTSPS are introduced.

### Principle 4: Integrated Planning

- (f) We have been liaising with the relevant departments tasking forward the relevant projects, such as the waterfront promenade and the Revitalization of Tsui Ping River project to better coordinate the design and the interfacing issues during construction.

### Principle 6: Vibrant Harbour and Principle 8: Public Enjoyment

- (g) Our project aims to provide additional benefits to the public by opening a landscaped deck for public enjoyment. We will also carry out simple reinstatement works for the works area at the seafront upon expiry of our occupation in end 2022 and open for public use. Suitable connection facilities for allowing public to transit from the seafront to our landscaped deck will also be explored.

### Principle 7: Accessible Harbour

- (h) Our project will facilitate the connectivity from Kwun Tong to the harbourfront area. With the footbridge crossing Tsui Ping River and road improvement works under another DSD project, the connectivity to the harbourfront will be further improved.

## **WAY FORWARD**

15. We would like to seek views or comments from the Members to refine and finalize the design of the landscaped deck. The target completion date of the landscaped deck is at the end of 2022.

16. We would like to seek Members' comments on the application of extension of TGLA-TNK 2415 at Wai Lok Street till 30 June 2023 and its future extension till mid 2025.

# **Task Force on Kai Tak Harbourfront Development**

---

TFKT/02/2021

**Annex A** Location Plan for Enhancement Works for Kwun Tong Sewage Pumping Station

**Annex B** Architectural Design for Landscaped Deck

**Annex C** Design of Play Space at Landscaped Deck

**Annex D** Details of Connectivity for Landscaped Deck

**Annex E** Location Plan of Works Areas

**Drainage Services Department**  
**April 2021**

## Location Plan for Enhancement Works for Kwun Tong Sewage Pumping Station



啟德發展的外貌  
OVERVIEW OF KAI TAK DEVELOPMENT

規劃署  
PLANNING  
DEPARTMENT



參考編號  
REFERENCE No  
M/K22/18/34

圖 FIGURE  
1

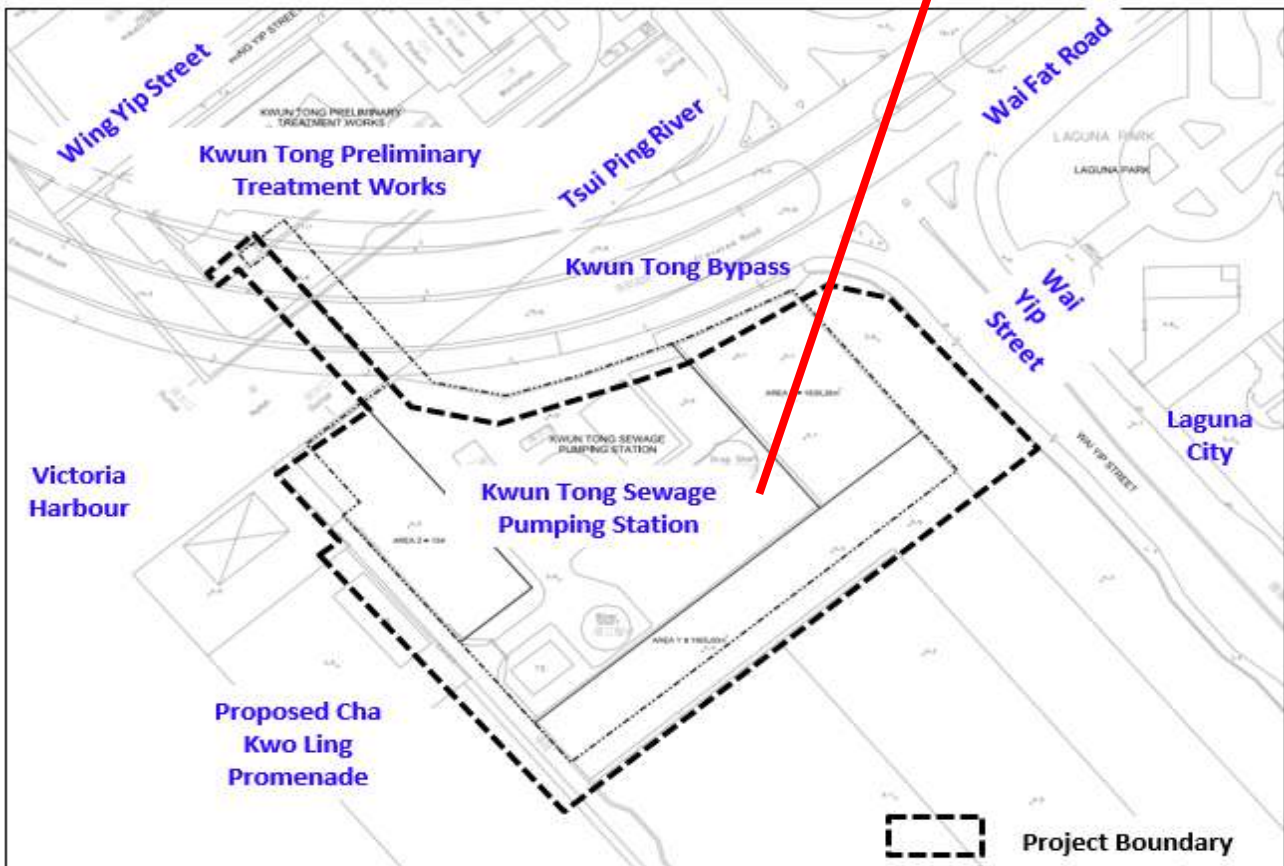



### Architectural Design for Landscaped Deck

KTSPS Layout Plan

TOS	TOP OF SOIL
TOK	TOP OF KERB
TOW	TOP OF WALL
FL	FINISHED LEVEL
---	SOIL MIX SLOPE DEMARCATION
---	PROPOSED U-CHANNEL
---	MANHOLE



SCALE 1:400@A3

D<sub>1</sub>

D<sub>2</sub>

D<sub>3</sub>

D<sub>4</sub>

D<sub>5</sub>

D<sub>6</sub>

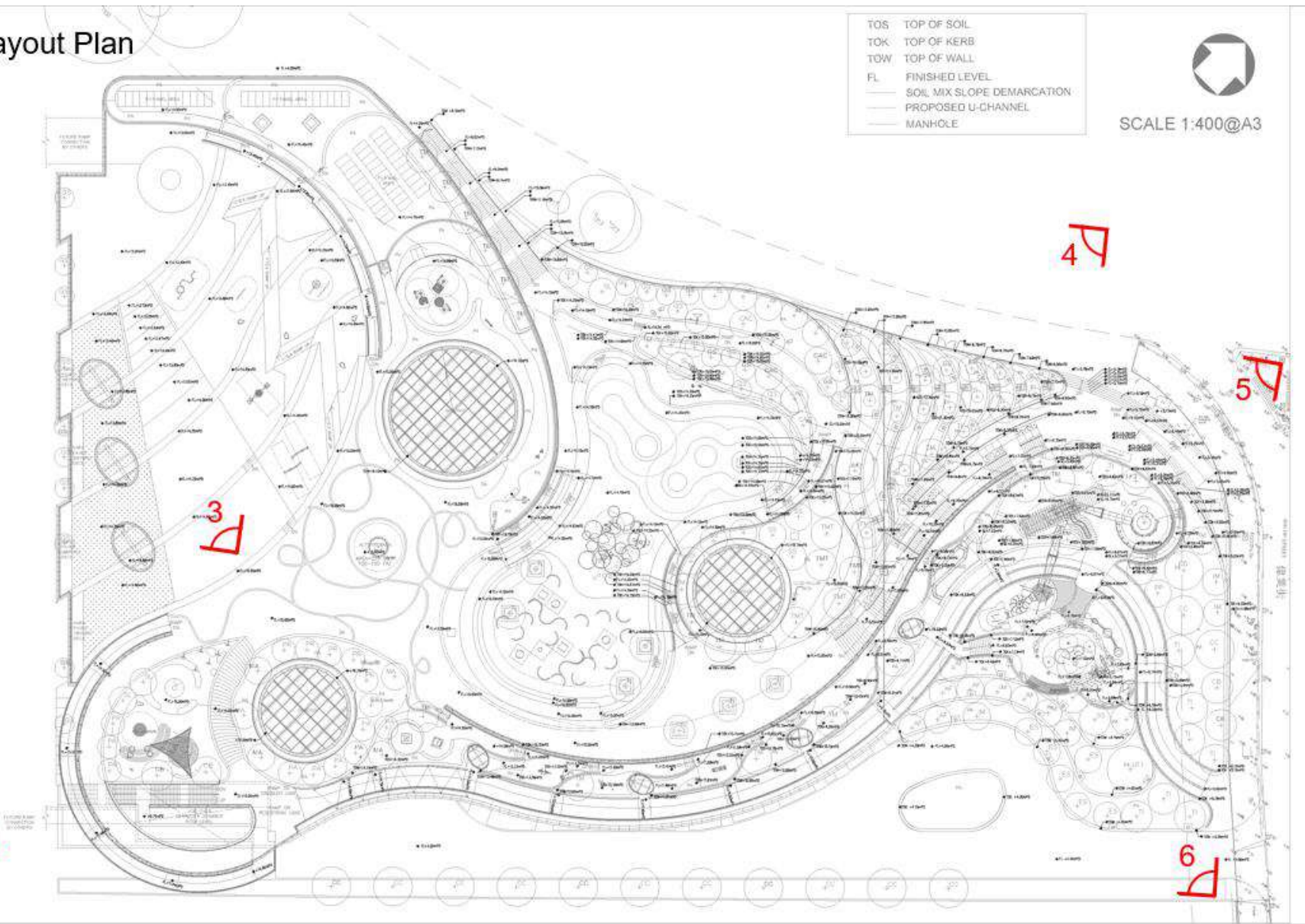



**Architectural Design for Landscaped Deck**



View 1

**Architectural Design for Landscaped Deck**



View 2



Architectural Design for Landscaped Deck



View 3

Architectural Design for Landscaped Deck



View 4



Architectural Design for Landscaped Deck



View 5

Architectural Design for Landscaped Deck



View 6



## Design of Play Space at Landscaped Deck

### 圖例 Legend

	01. 旋轉劇場 Family Amphitheater
Zone 1 (3178m <sup>2</sup> )	02. 風搖搖 Land of the Breezy
	03. 大管地 Pop-up plaza
	04. 秘密花園 Secret Garden
Zone 2 (282m <sup>2</sup> )	05. 幼兒天地 Toddler Paradise
	06. 雲之躍動 The Clouds
Zone 3 (1865m <sup>2</sup> )	07. 綠遊遊 Embracing Green
	08. 波浪木道 The Wooden Waves
	09. 渠管迷宮 Concrete Labyrinth
	10. 穿梭林跡 Into the Woods
	11. 光影聚 Shadow Gathering
Zone 4 (774m <sup>2</sup> )	12. 健身小徑 Fitness Trail
	13. 彩虹隧道 Rainbow Tunnel
Zone 5 (881m <sup>2</sup> )	14. 親樹平台 Forest Hunt
	15. 親水花園 Water Play Creek
	16. 生態教育濕地 Educational Wetland
	17. 滑梯大道 Avenue of slide



### Details of Connectivity for Landscaped Deck

