

The Tsim Sha Tsui Star Ferry Pier: Restoration and Revitalization

An aerial photograph of the Tsim Sha Tsui Star Ferry Pier in Hong Kong. The pier is a long, white structure with a green roof and a glass-enclosed walkway. A large ferry boat is docked at the pier. In the background, the dense Hong Kong skyline is visible, including the Bank of China Tower and other skyscrapers. The water is dark blue, and the sky is clear.

31 May 2011

Content

- Introduction
- Concept
 - Layout Plan
 - Photomontages
- Conclusive Remarks
- Q&A

Introduction

Tsim Sha Tsui Star Ferry Pier



Application Site

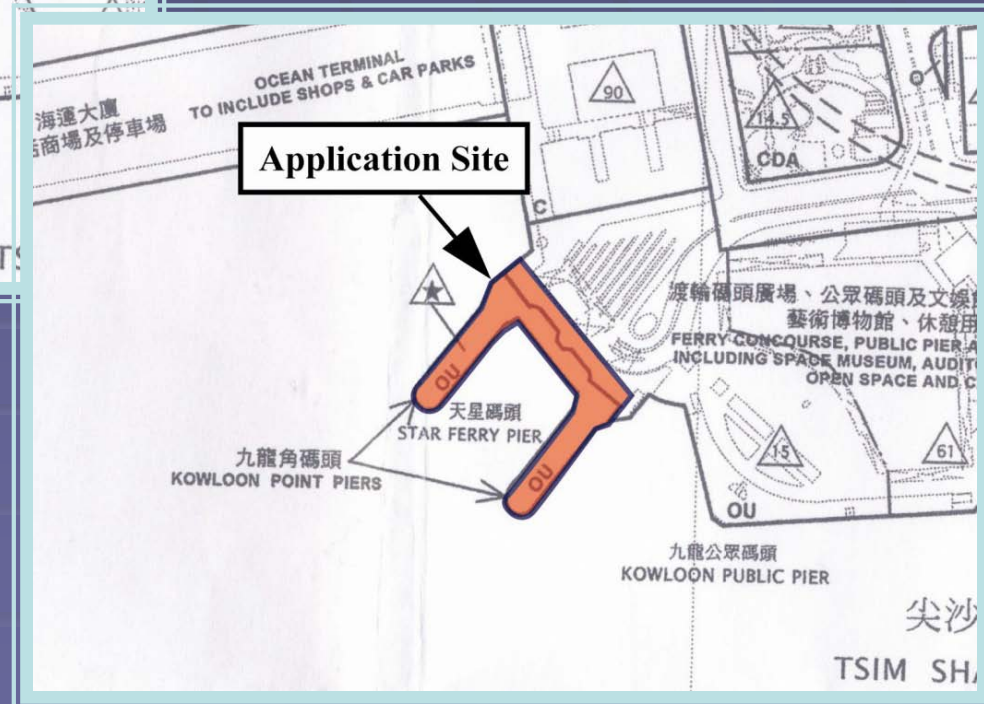
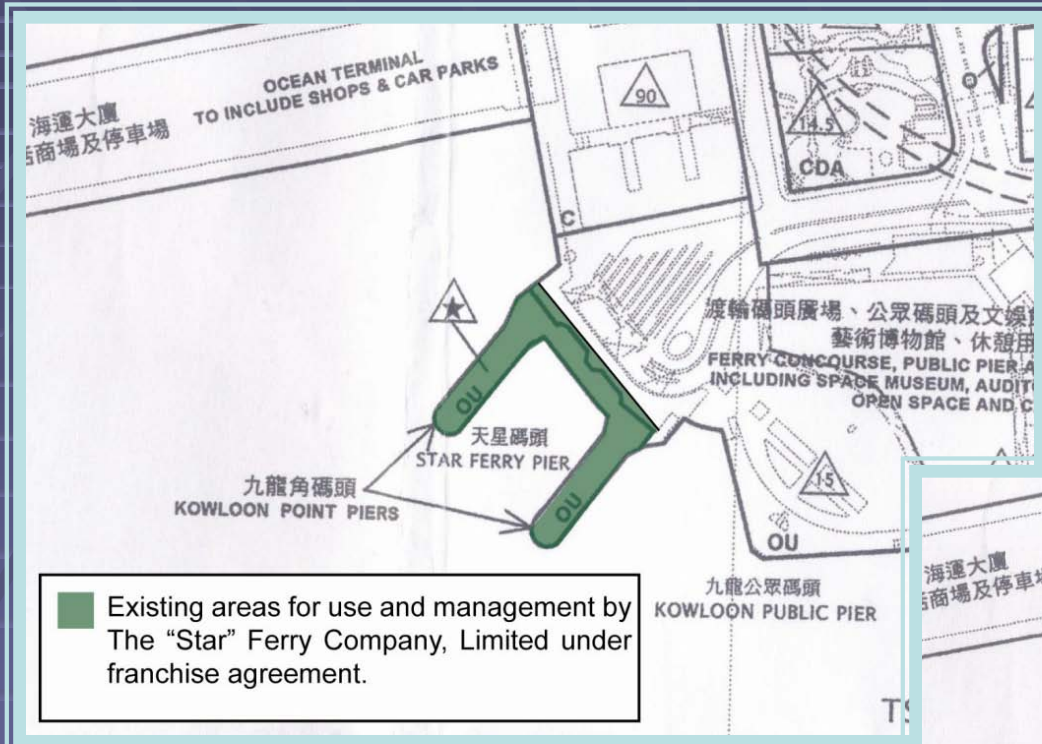

Objectives

- Upgrade the access and indoor facilities



- Restore the Pier and restore its original architectural appearance



Objectives



- Upgrade the existing kiosks

- Provide access to the roof level and expand additional spaces for F&B outlets

Concept

Ground Floor – Layout Plan

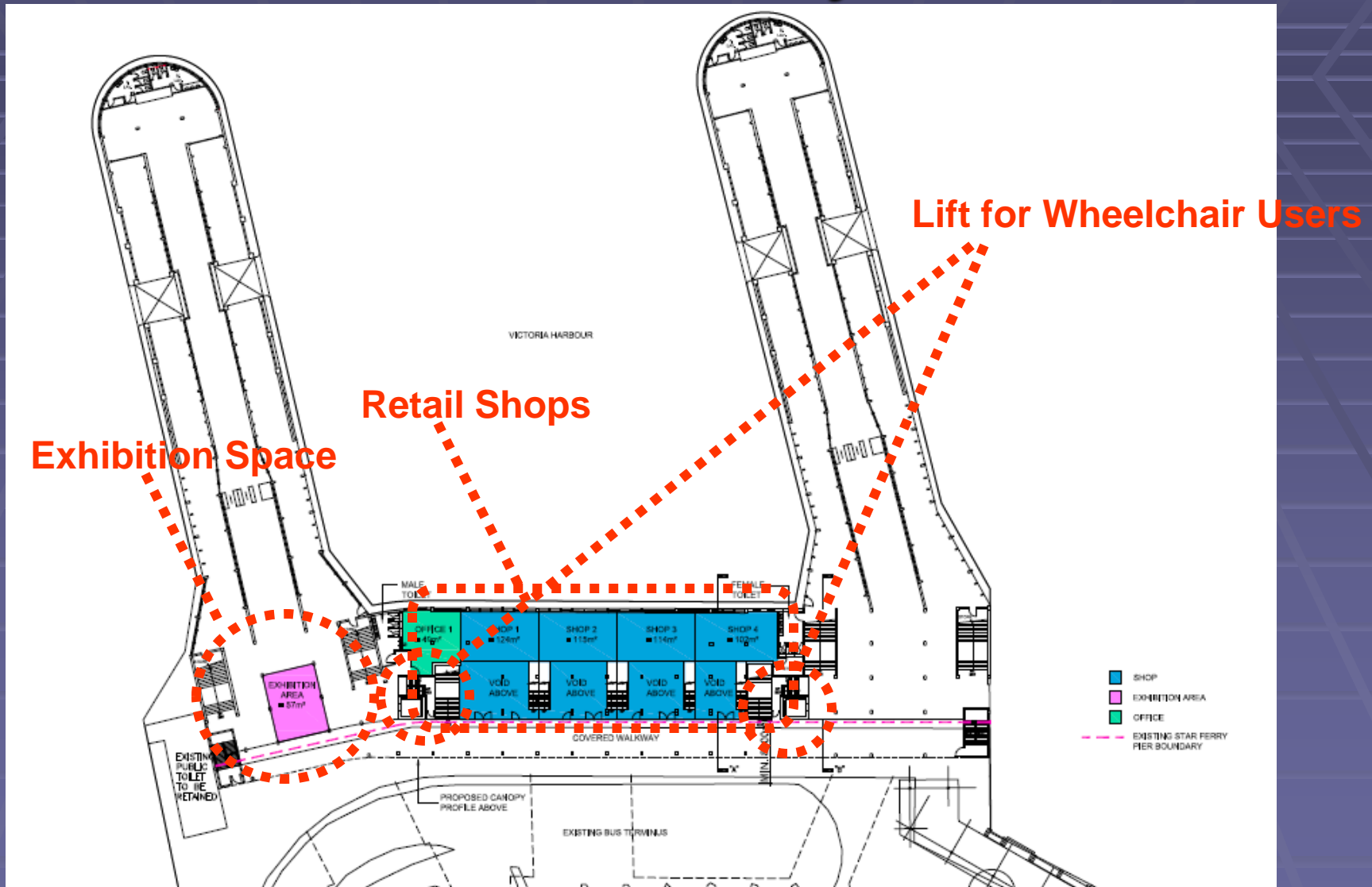

Ground Floor - Design Feature

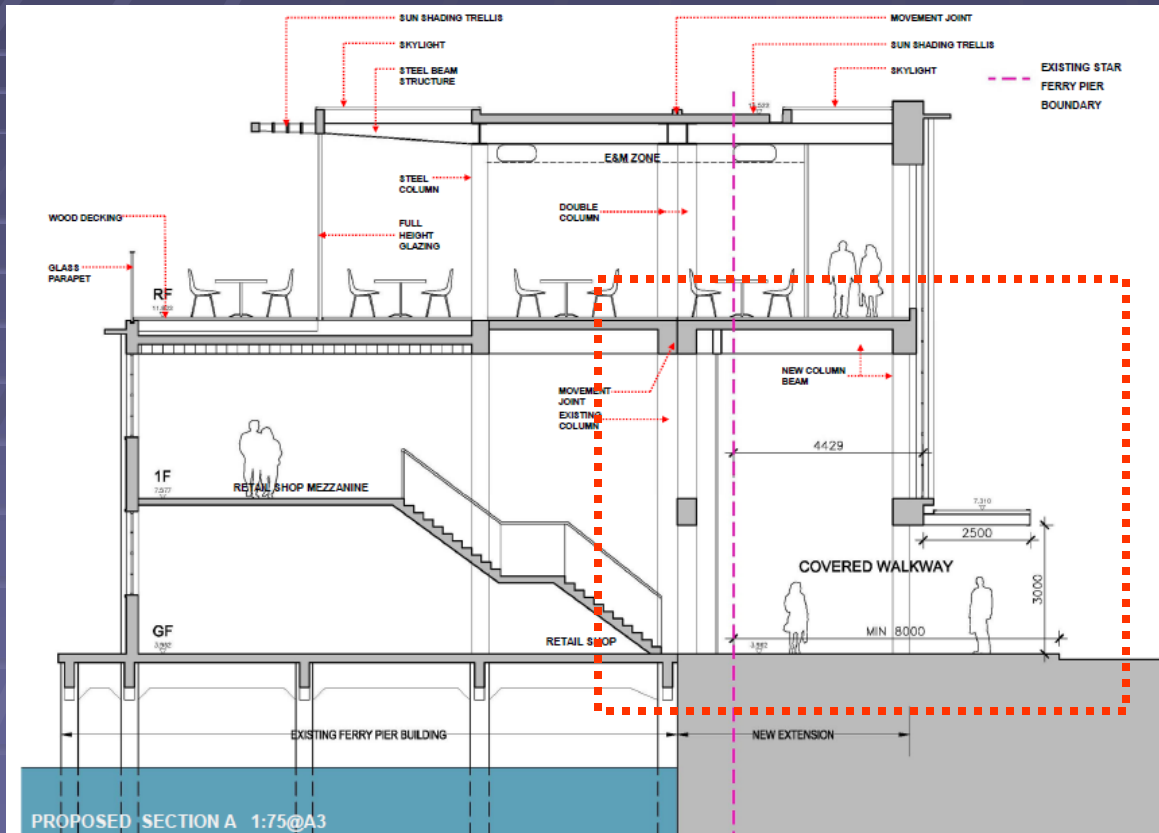

- The existing entrance areas will be rationalized;
- The commercial kiosks replaced by properly designed retail spaces;
- The existing pedestrian walkway under the canopy would remain at about 8 metres wide;
- The canopy itself would be replaced by part of the new building and a new canopy;
- Public exhibition space will be provided in the entry to the east pier.

Streetscape Outside Pier Entrance



Roof Level - Layout Plan

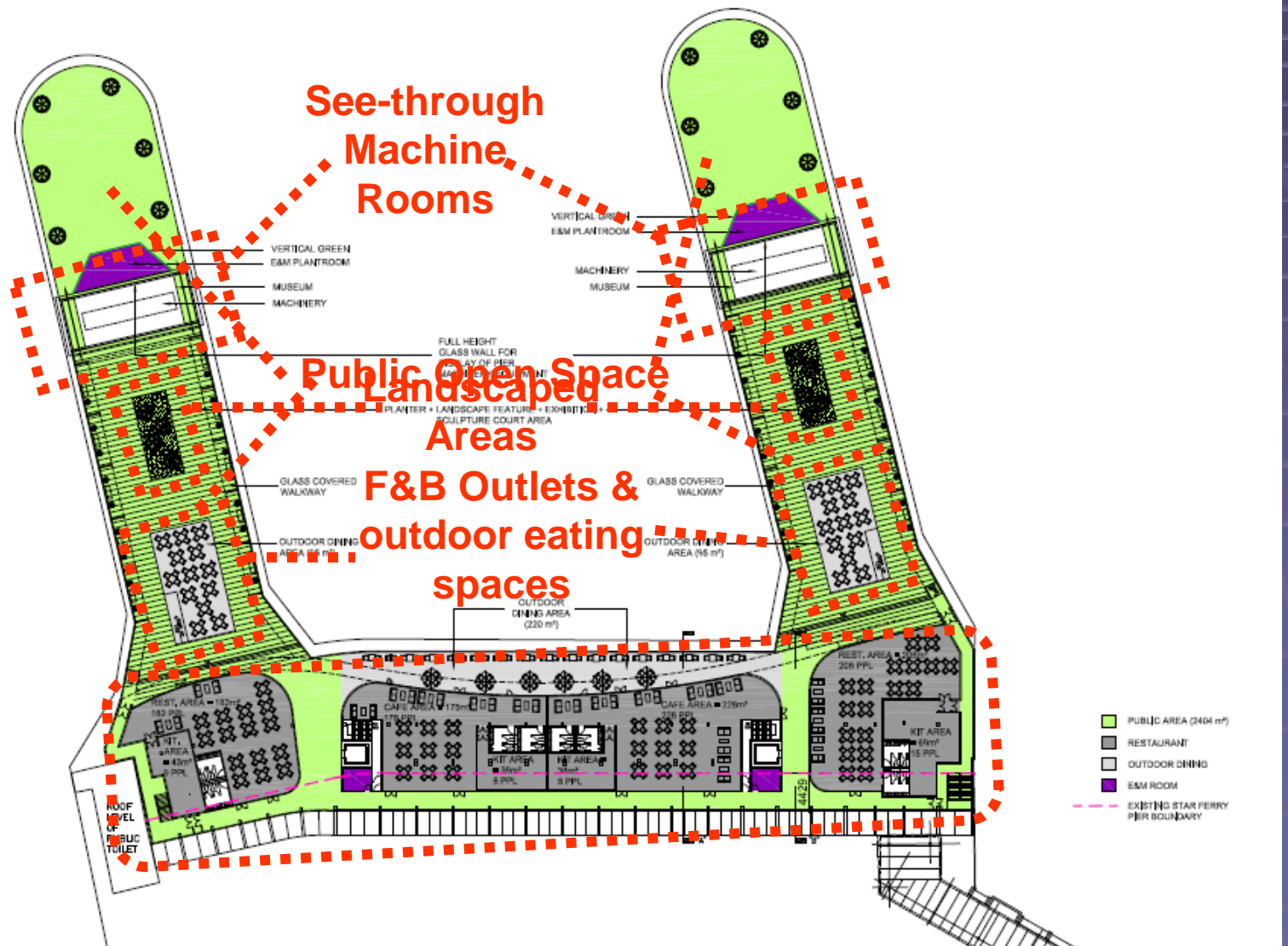

Public Open Space



ARK

See-through Machine Rooms – the public can walk through them to the end of the piers

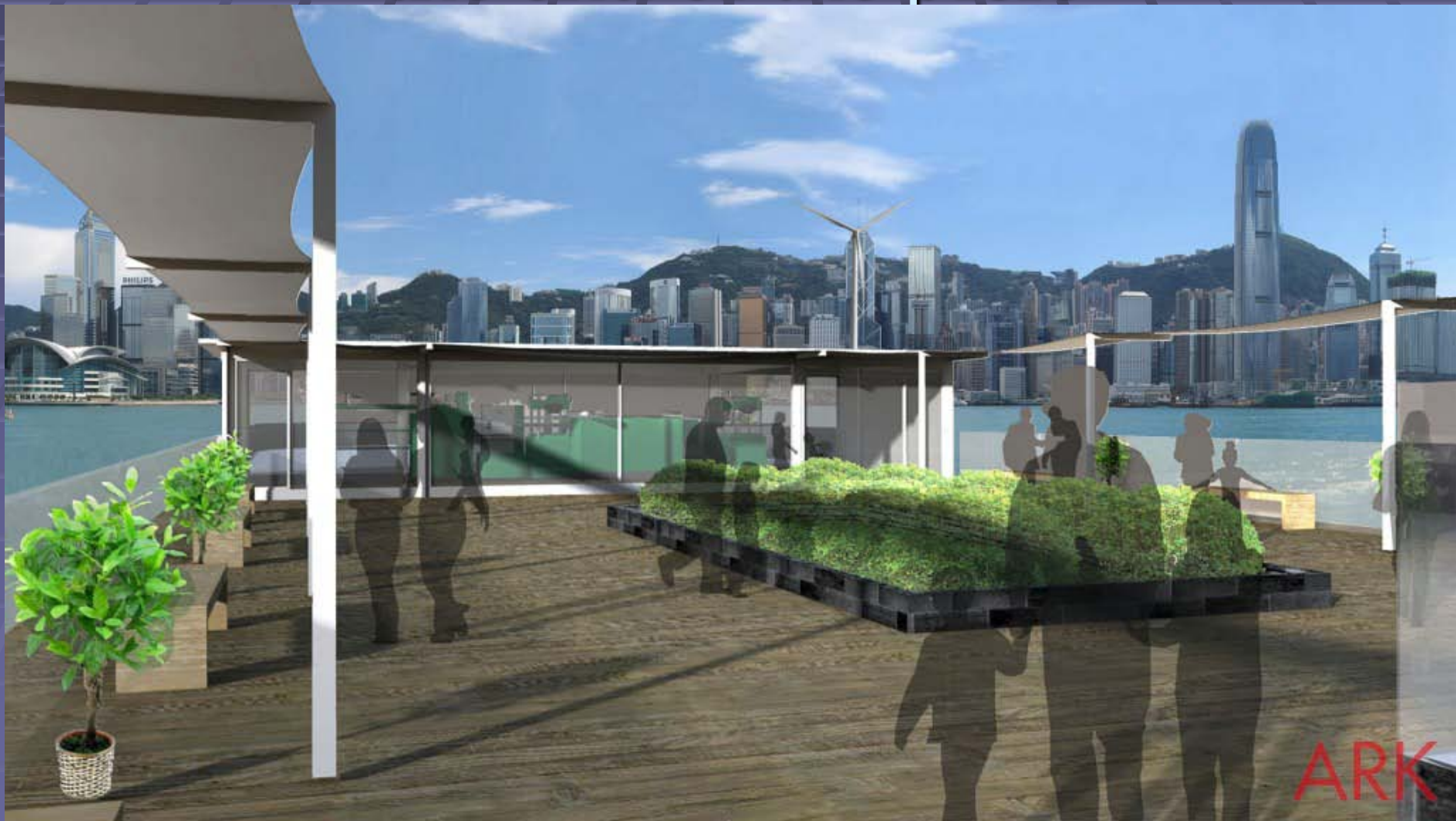

F&B Outlets and Outdoor Eating Space



Roof Level – Design Features

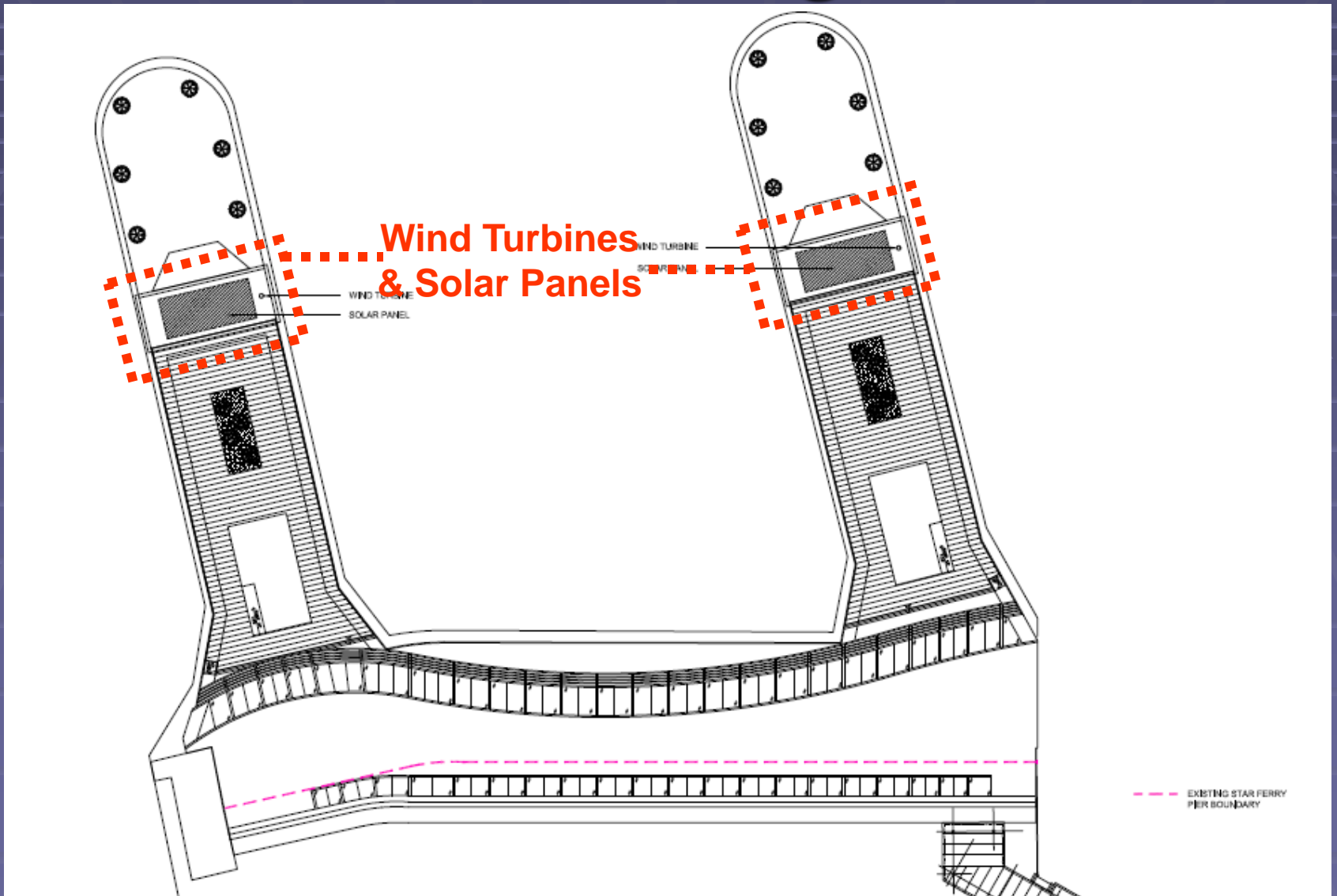

Gross Floor Area

	Existing GFA (sq. m.)	Proposed GFA (sq. m.)
Retail	385	863
F&B outlets & outdoor eating space	0	1,472
Roof Top Public Open Space	0	2,404

View From Bus Terminus

Existing Facade



Proposed Facade



View From Harbour City



Existing Facade



Proposed Facade

View From Clock Tower



Existing Facade



Proposed Façade

Photomontage from the Central Star Ferry Pier



ARK

Photomontage from the Hong Kong Convention and Exhibition Centre



Conclusive Remarks

- Revitalize the Pier and waterfront
- Create a focal point for tourist activities
- Provide public access to harbour views
- Preserve the heritage significance
- Restore the architectural integrity
- Generation of non-fare box revenue from additional retail floor spaces and F&B outlets to cross-subsidize the iconic ferry services
- No significant adverse visual impact

Q & A