

Harbourfront Commission Discussion Paper **Appendices**

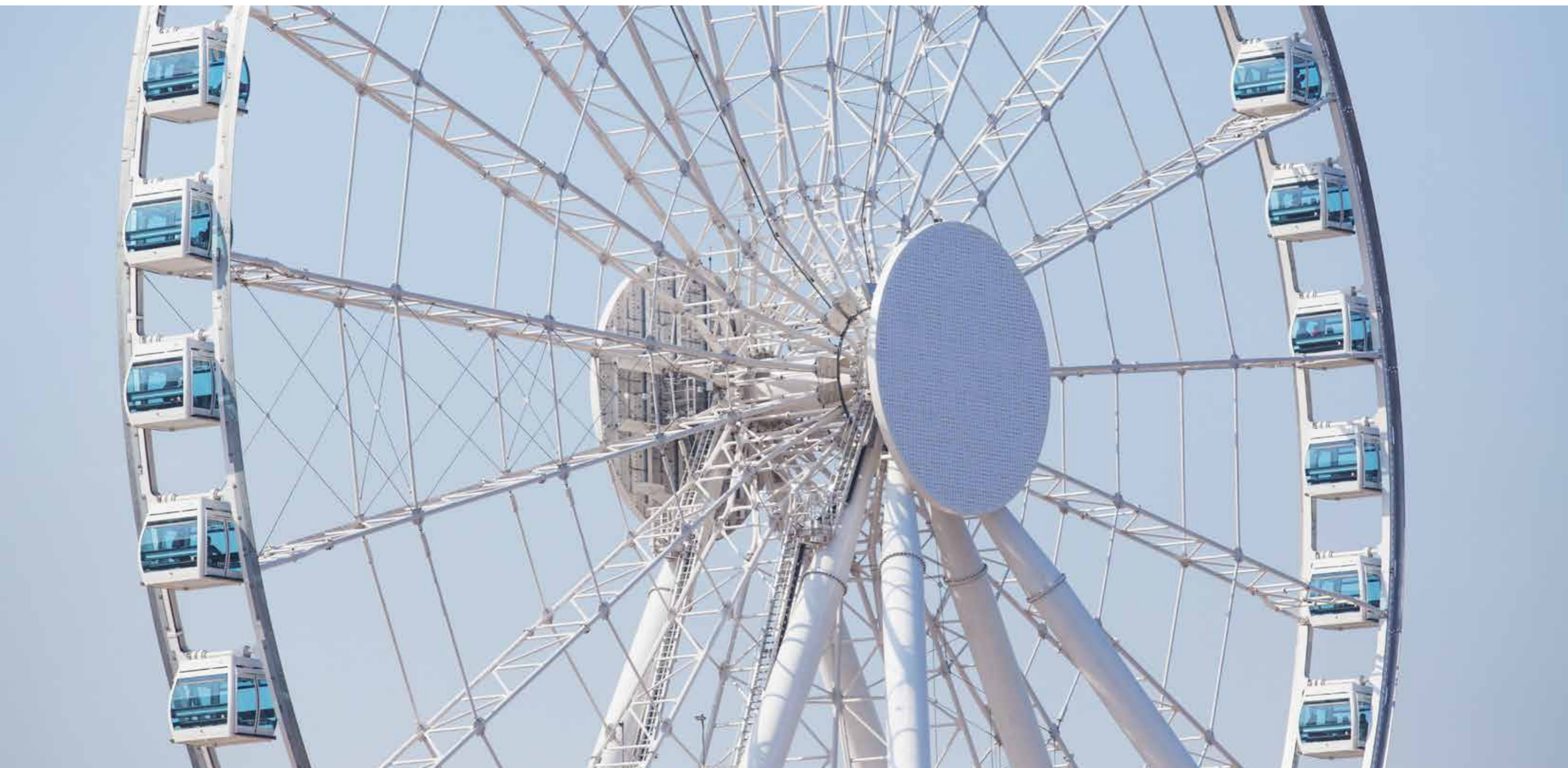

The Hong Kong
Observation Wheel
香港摩天輪

SWISS+AEX[®]
ASSETS EXCEPTIONAL

Appendix A | Pictures of the foundation work



Appendix A | Pictures of the foundation work



Appendix B | Locations of the underground cable ducts

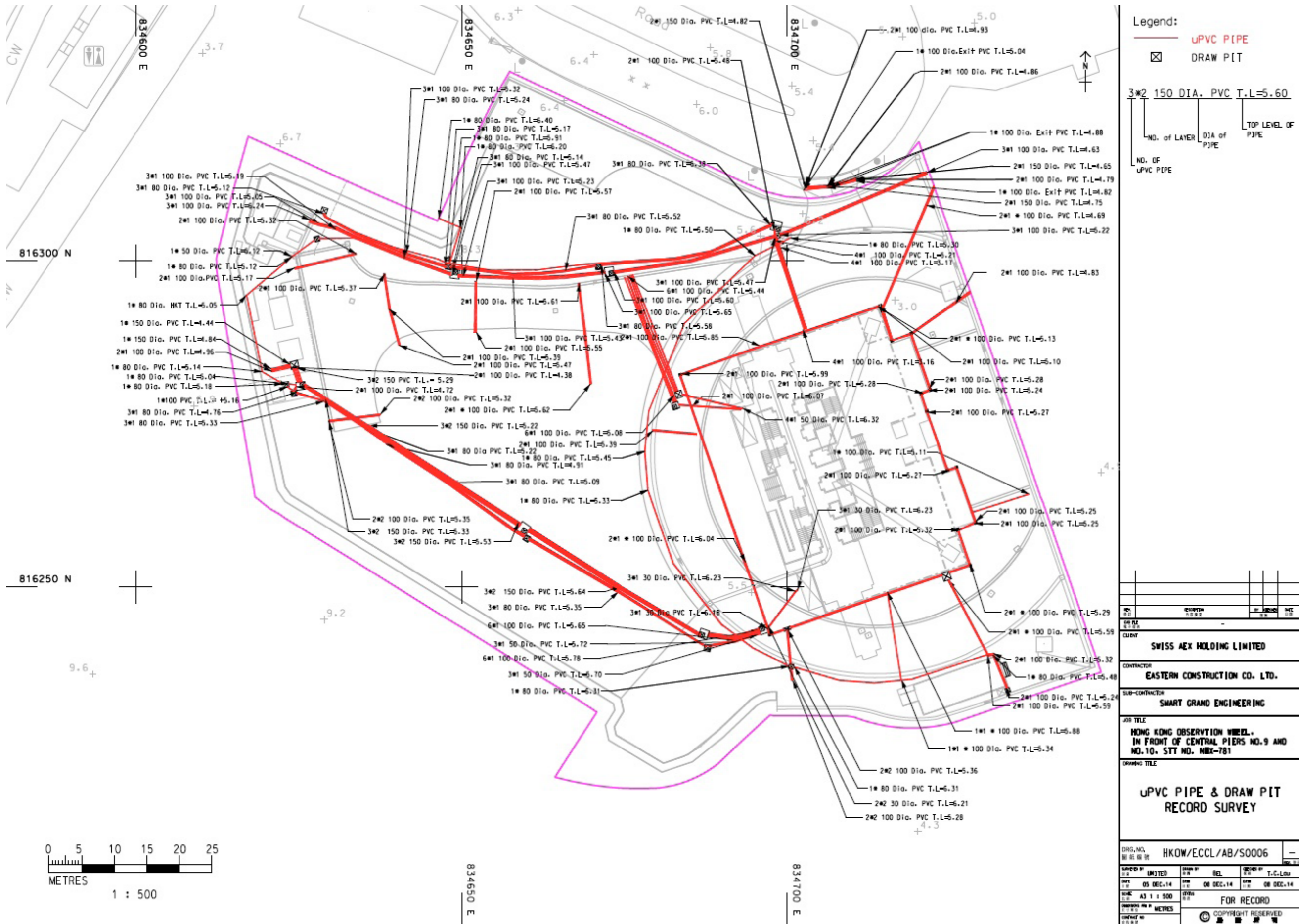

Appendix C | Secure dual-power source





Appendix D | Permanent site drainage











Executive Summary

This short report aims to summarise the events held at the Hong Kong Observation Wheel with various reputable, registered local charities, and to detail the future efforts of the attraction in proactively reaching out to more local charities in need of support.

Since the inception of the idea to construct a world-class observation wheel on Central harbourfront, and as mentioned in our successful tender for the attraction and the presentations to the Harbourfront Commission and Central and Western District Council in 2014, the first and foremost objective of the Hong Kong Observation Wheel is to serve as an icon in the local community in which it stands, and become the latest tourist attraction at Central harbourfront for international visitors.

In order to give back to all members of the Hong Kong community, especially the less fortunate and more needy young and old community groups, the Hong Kong Observation Wheel has been proactive in its philanthropic involvement with the organisation of complimentary visits for members of various local charities since opening its doors on 5 December 2014. As of April 2016, the Hong Kong Observation Wheel has invited around 2,350 members from a variety of local charities. The details of these events are presented in Part 1.

In addition to organising complimentary visits, the Hong Kong Observation Wheel has also contributed to charitable causes in Hong Kong by hosting fundraising events and offering donations. Details of these events are presented in Part 2.

The Charity webpage of the Hong Kong Observation Wheel was launched in late 2015 to offer more information on the charity activities held at the attraction, and provide an official platform for interested local charities to sign up for complimentary visits.

In the future, the Hong Kong Observation Wheel will continue to offer complimentary visits for local charities registered under Section 88 of the Inland Revenue Ordinance as charitable institutions and trusts of a public character in Hong Kong. The attraction will also explore opportunities to work with a wider range of charities in support of different causes, such as social welfare and environmental, wildlife and animal protection. Details of the next steps of the Hong Kong Observation Wheel in its charities activities are presented in Part 3.



Part 1: Complimentary Visits Hosted by the Hong Kong Observation Wheel in 2015 and 2016

As of February 2016, the Hong Kong Observation Wheel has invited 2,350 members from local charities supporting various causes and service targets. In order to give participants the complete experience on the Hong Kong Observation Wheel, refreshments were also provided according to their needs. No media were invited to the complimentary visits.

Table 1 shows a detailed list of the charities that enjoyed the complimentary visits at the Hong Kong Observation Wheel at zero cost. The souvenirs from local charities that enjoyed complimentary visits at the Hong Kong Observation Wheel are shown in Annex 1.

2015	No.	Date	Organisation	Category	Number of participants
	1.	21-03-2015	Enlighten- Action for Epilepsy	• Epilepsy patients and families	40
	2.	08-04-2015	Po Leung Kuk	• Children and young people under residential care	95
	3.	02-06-2015*	Neighbourhood Advice-Action Council Sham Shui Po District Elderly Community Centre	• The elderly	100
	4.	16-06-2015	Tung Wah Group	• Elderly from the Fong Shu Chuen District Elderly Community Centre • Children from Ng Sheung Lan Memorial Nursery School	100
	5.	23-07-2015	Fresh Fish Traders' School	• Underprivileged primary school students	200
	6.	16-09-2015	Mongkok Kai-fong Association Kowloon Chamber of Commerce Centre for the Elderly	• Low-income elderly in Mongkok area	100
	7.	23-09-2015	Tsim Sha Tsui District Kaifong Welfare Association Neighbourhood Elderly Activities Centre (Group 1)	• Single –living elderly and elderly without family support	58
	8.	30-09-2015	Hong Kong Community Development Network	• Low-income children and families in Yau Ma Tei, Tsim Sha Tsui and Mongkok area	100
	9.	28-10-2015	Tsim Sha Tsui District Kaifong Welfare Association Neighbourhood Elderly Activities Centre (Group 2)	• Single –living elderly • Elderly without family support	42
	10.	29-10-2015	Island Harbourview Elderly Club of Asian Outreach Hong Kong	• Socially isolated ('hidden') elderly	150
	11.	11-11-2015	Christian Action	• Cerebral palsy patients	10
	12.	17-11-2015	Caritas Lok Kan School	• Students 6-18 years of age with severe intellectual and/or physical disabilities	123
	13.	24-11-2015	Hong Kong Cancer Fund	• Breast cancer patients and families	100
	14.	30-11-2015	Hong Chi Lions Morninghill School	• Students with mild intellectual disabilities (aged 6 - 18)	182
	15.	10-12-2015	Hong Chi Lei Muk Shue Centre	• People aged 15 or above with moderate to severe intellectual disabilities	120
	16.	15-12-2015	Caritas Li Ka Shing Care and Attention Home	• Elderly needing specialist care	20
17.	17-12-2015	Changing Young Lives Foundation	• Children from Sham Shui Po living in poverty	40	

2016	No.	Date	Organisation	Category	Number of participants	
	18.	15-01-2016	Wai Ji Christian Service	• Adults with severe intellectual disabilities	22	
	19.	26-01-2016	First visit for beneficiaries under Operation Santa Claus 2015	• People with intellectual disabilities	8	
	20.	29-01-2016	Hong Kong Playground Association	• Kindergarteners who are new arrivals in Hong Kong	30	
	21.	04-02-2016	Association of Baptists for World Evangelism Shing Yan Christian Social Service Centre	• Children from low-income families in Kwai Chung	38	
	22.	24-02-2016	Second visit for beneficiaries under Operation Santa Claus 2015	• The elderly • Adults and children with intellectual, physical or psychiatric disabilities	171	
	23.	29-02-2016	Third visit for beneficiaries under Operation Santa Claus 2015	• Adults with intellectual disabilities	25	
	24.	04-03-2016	The Jockey Club Hong Chi Sun Chui Workshop cum Hostel	• Adults with mild to moderate intellectual disabilities	214	
	25.	15-03-2016	Long Town Hall Mrs. Leung Hok Chiu Neighbourhood Elderly Centre	• Elderly who are living alone and/or on government social security assistance	108	
	26.	24-03-2016	SAHK East Kowloon Parents' Resource Centre	• Children aged 3-18 years with development disorders and parents	50	
	27.	13-04-2016	The Hong Kong Down Syndrome Association Bradbury Parents Resource Centre	• People with Down Syndrome and families	40	
	28.	15-04-2016	New Life Psychiatric Rehabilitation Association The Wellness Centre (Yau Tsim Mong)	• People in recovery of mental illnesses in Yau Ma Tei, Tsim Sha Tsui and Mongkok area	24	
	29.	29-04-2016	Hong Chi Morningjoy School, Yuen Long	• Students with mild intellectual disabilities	40	
	Total number of participants in 2015 & 2016					2,350

Table 1: Local Charities who Enjoyed Complimentary Visits at the Hong Kong Observation Wheel

Part 2: Other Charity Contributions of the Hong Kong Observation Wheel

In addition to hosting complimentary visits for local Hong Kong charities, the Hong Kong Observation Wheel has supported local charities in Hong Kong by donating materials, hosting of fundraising events and calling for attention on various charitable causes. Summaries of these events are listed below.

1. Special Lighting to Support Epilepsy Awareness

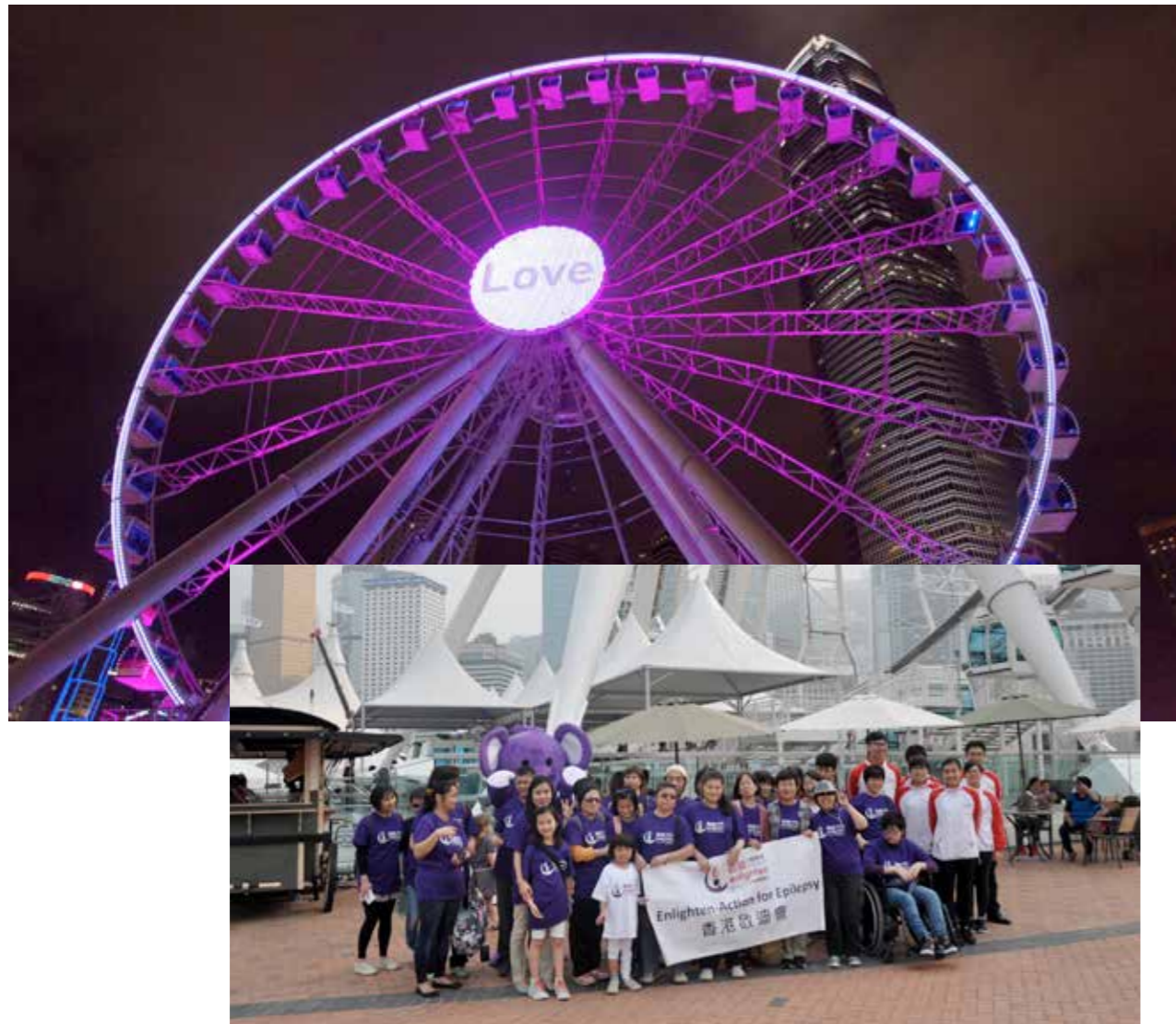

In the evening of Thursday 26 March 2015, special purple lighting was used to light up the Hong Kong Observation Wheel in support of the Paint the Town Purple campaign organised by Enlighten: Action for Epilepsy, the only epilepsy-focused, non-medical registered charity in Hong Kong. Also, staff of the attraction dressed in special purple t-shirts in support of the cause. In addition, a complimentary visit for epilepsy patients and their families from Enlighten was organised on 21 March 2015.

2. Candy donation to the Hong Kong Community Development Network



Surplus candy from the Valentine's Day 2015 promotion of the Hong Kong Observation Wheel were delivered to the food bank operated by the Hong Kong Community Development Network on Tuesday 31 March 2015 for a birthday party for children from low-income families. Later on 30 September 2015, 100 service users of the organisation were invited to a complimentary visit at the attraction.

Part 2: Other Charity Contributions of the Hong Kong Observation Wheel

3. Support on the Breast Cancer Awareness Month



From 29 September – 29 October 2015, the Hong Kong Observation Wheel participated in a global campaign for raising awareness on breast cancer. The Events Area of the Hong Kong Observation Wheel was the venue for the kick-off ceremony on 29 September 2015, and pink illumination was used to light up the attraction for a month. The site and gondolas of the attraction were decorated with the pink ribbon and special messages calling for awareness on breast cancer.

4. Participation in the “Spin for Survival” campaign



Cooperation between the Hong Kong Observation Wheel and the Ocean Park Conservation Foundation Hong Kong in the “Spin for Survival” campaign took place from 1 - 30 November 2015. Gondolas of the Hong Kong Observation Wheel were decorated with pictures of four focal wild animals to promote their conservation statuses, threats to these four valuable wildlife species and how everyone can help to save them. In addition, banners with conservation messages were placed near the exit of the Hong Kong Observation Wheel, and a walkthrough exhibition on the four endangered species on the deck of the attraction.



Part 2: Other Charity Contributions of the Hong Kong Observation Wheel

5. Participation in Operation Santa Claus 2015



On Wednesday 4 November 2015, the Opening Ceremony of Operation Santa Claus was held at the Events Area of the Hong Kong Observation Wheel to kick off the annual charity fundraising campaign jointly organised by Radio Television Hong Kong and South China Morning Post. A total of three complimentary visits for beneficiaries of the campaign have been arranged in January and February 2016 with a total of 213 participants. The Opening Ceremony was reported on the front page of South China Morning Post and contributed to over HK\$21.3 million raised by the fundraising campaign.

6. Support in the Humanity Parade and Carnival of the Red Twinkle Star Campaign of the Hong Kong Red Cross



The Red Twinkle Star Parade cum Carnival of the Hong Kong Red Cross was held on Saturday 5 March 2016 at the space in front of the Hong Kong Observation Wheel. The event was part of the Red Twinkle Star Campaign, an educational programme to foster humanitarian spirit in children in Hong Kong. The Humanity Parade, the key activity on the day, began with a loop around the site of the Hong Kong Observation Wheel then continued on the Central Harbourfront. Over 1,000 children and their families joined the event despite the light shower. In addition to supporting the Humanity Parade, the Hong Kong Observation Wheel also sponsored entrance tickets to the attraction for the top nine finalists of the Red Twinkle Star Flag Design Competition.

Part 2: Other Charity Contributions of the Hong Kong Observation Wheel

7. Donations to the Christina Noble Children's Foundation Hong Kong

In early April 2016, two VIP tickets to the Hong Kong Observation Wheel were donated to the organisation in support of their annual Ladies' Long Lunch. The Christina Noble Children's Foundation Hong Kong, established in 1996, is a fundraising centre to support the operational projects of the Christina Noble Children's Foundation in Vietnam and Mongolia.

8. Launch of Charity page on the official website of the Hong Kong Observation Wheel

In late 2015, the charity page of the official website of the Hong Kong Observation Wheel (<http://www.hkow.hk/en/charity>) was launched as a gesture of recognition for the most reputable charitable organisations, and to help increase awareness to the most worthy philanthropic causes in our society.

On the charity webpage, background information of the charity initiative of the Hong Kong Observation Wheel and local charities that have enjoyed complimentary visits to the attraction are included. An application form is also provided for local charities to express their interest in participating in the complimentary visits.

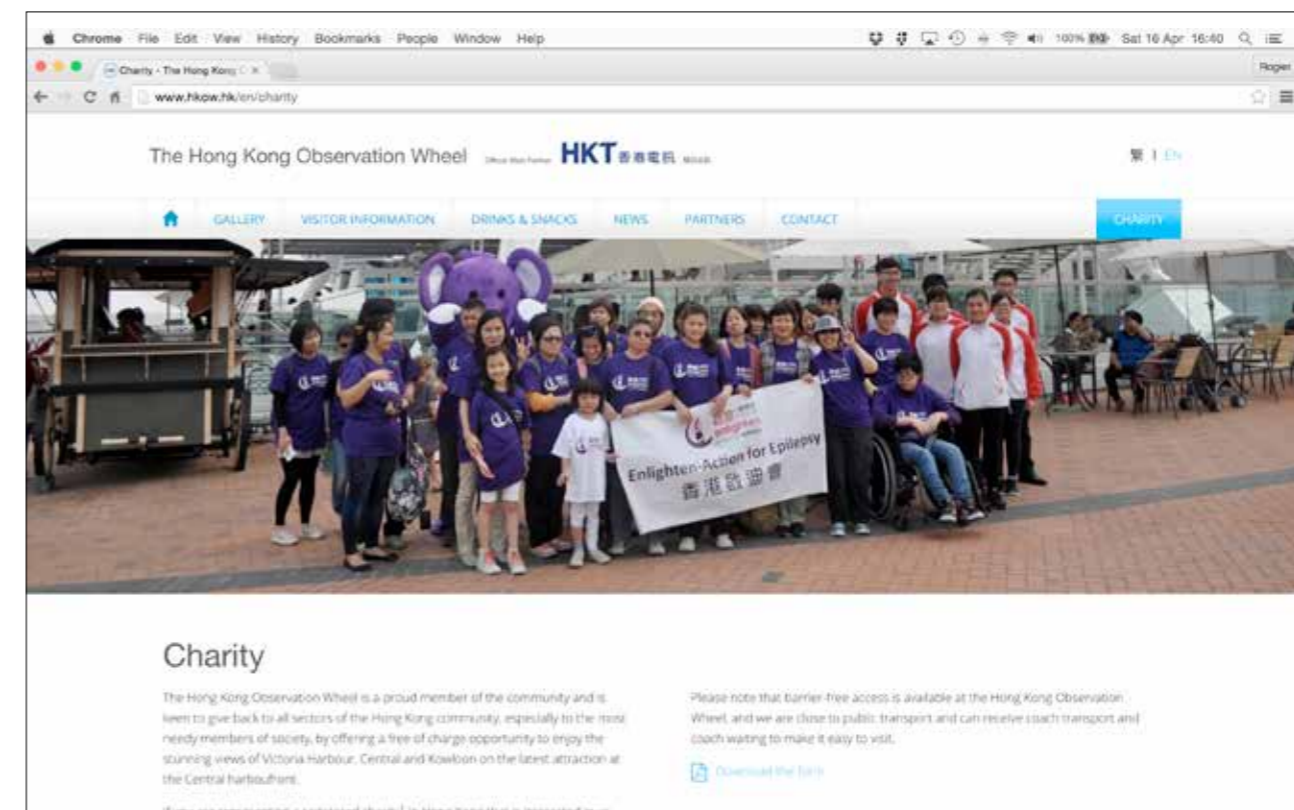

Part 3: Next Steps by the Hong Kong Observation Wheel

The Hong Kong Observation Wheel frequently receive enquiries and requests from various charities in Hong Kong, expressing interest in joining the complimentary visits offered by the attraction. Based on the positive feedback from the visits organised so far, complimentary visits to the attraction will continue to be offered to local charities registered under Section 88 of the Inland Revenue Ordinance as charitable institutions and trusts of a public character.

The Hong Kong Observation Wheel will continue to explore and liaise closely with charities throughout Hong Kong that are interested in visiting the attraction at zero cost. For example, when organising complimentary visits for local charities, the attraction will continue to refer to the Booklet on Community Services and Resources in Central and Western District, kindly shared by the Central and Western District Council, to further contribute to the community in which the attraction stands.

The Hong Kong Observation Wheel will also explore opportunities to support more charitable organisations furthering various causes, such as social welfare and environmental, wildlife and animal protection.

Table 2 shows a list of Hong Kong charities that have expressed interest in participating in complimentary visits to the Hong Kong Observation Wheel later in 2016. Table 3 is a detailed list of the charities to be invited to the Hong Kong Observation Wheel for complimentary visits.

Organisations	Category
1. Evangelical Lutheran Church Kwai Chung District Support Centre	Mild to moderately mentally handicapped persons and families
2. Ronald McDonald House Charities (RMHC)	Severely or terminally ill children and families
3. Tung Wa Group Hui Mok Tak Yu Care and Attention Home	Elderly with weak health, limited self-care ability and/or dementia
4. Hong Chi Shui Choi Centre	People with intellectual disabilities
5. Kin Chi Dementia Care Support Service Centre of St James' Settlement	Elderly with dementia in Central and Western district
6. Homantin Integrated Centre for Youth Development of Yang Memorial Methodist Social Service	Young people aged 6 - 35 in the Homantin area and families
7. Hong Kong Sheng Kung Hui Tseung Kwan O Aged Care Complex	Single living elderly and elderly needing specialist care
8. Small Group Homes of Hong Kong Christian Service	Children and teenagers aged 4-18 in need of proper care because of family difficulties and crises (e.g. child abuses, parents with illnesses etc.)
9. Hong Kong Family Welfare Society Shun Lee Integrated Family Service Centre	Low-income families
10. Children and Family Services Centre (Kowloon City) of the Hong Kong Society for the Protection of Children	Children from low-income families
11. T.O.U.C.H.-Support Service Centre for Ethnic Minorities of the Neighbourhood Advice-Action Council	Children and families of ethnic minorities in Tung Chung
12. Jockey Club Ping Shek Youth S.P.O.T. of the Hong Kong Federation of Youth Groups	Underprivileged children in Ping Shek area

Table 2: List of Hong Kong Charities Interested in Participating in Complimentary Visits to the Hong Kong Observation Wheel Later in 2016

Table 3: Detailed List of Charities to be Invited for Complimentary Visits to the Hong Kong Observation Wheel

Organisations	Description
<i>Charities for elderly services</i>	
1. Helping Hand	Helping Hand offers rehabilitation service such as physiotherapy and occupational therapy for elderly, in addition to operating care homes, holiday centres and special housing units for them.
2. Hong Kong Sheng Kung Hui - W.C. Central & Western District Day Care Centre for the Elderly	Provides elderly aged 60 or above in the community who are weak and lack care with daily life assistance, social recreational services and rehabilitation services.
3. Yan Chai Nursing Home	Provides elderly homes, meal services, caretaking services, medical services, physiotherapy, occupational services, counseling services and social activities
<i>Charities for people with development disabilities</i>	
4. Yan Chai Hospital Sheung Wan Rehabilitation Service Centre	Provides people with mild intellectual disabilities with accommodation, community activities and assists them in employment.
5. The Nesbitt Centre (For English Speakers)	Assists students with a wide range of cognitive abilities to grow by providing opportunities to learn, experience and reach their full potential in life.
<i>Charities for low-income families</i>	
6. Hans Andersen Club	Hans Andersen Club purports to provide adequate training as well as readily accessible resources and trainings on storytelling and on devising creative games, and to serve the grass-root and under-privileged families and their children in Hong Kong.
7. Yan Oi Tong Siu Cheng Suk Ching Community Support Centre	Provides the disadvantaged individuals and families, especially jobless, low-income families, chronic disease sufferers and elderly, in Yuen Long and Tin Shui Wai with practical services, including cash aid, free home repair services, food, daily necessities, small electronics etc.
<i>Charities for children</i>	
8. The Boys' & Girls' Clubs Association of Hong Kong	The Boys' & Girls' Clubs Association of Hong Kong helps children and youth to attain well-balanced moral, intellectual, physical, social and aesthetic development.
9. Hong Kong Society for the Protection of Children	Hong Kong Society for the Protection of Children provides for and promotes the care, education and social development of children and families in partnership with the community.
10. S.K.H. St. Christopher's Home	S.K.H. St. Christopher's Home is a Christian association providing holistic services on children accommodation, counseling and health development.
<i>Charities for people with disabilities</i>	
11. The Hong Kong Society for Rehabilitation	The Hong Kong Society for Rehabilitation provides responsive and equality rehabilitation services for people with disability, chronic illness or problem of aging.
12. St. James' Settlement Rehabilitation Services	St. James' Settlement Rehabilitation Services offers comprehensive training, education, recreation services and local support to people with disability.
13. YMCA Home of Love - Sheltered Workshop	Serves people with intellectual and physical disabilities of various types as well as ex-mentally ill persons.
<i>Other charities</i>	
14. Children's Cancer Foundation	The foundation was established in 1989 to improve the quality of life for young cancer patients and their families by offering counseling, psychotherapy and assessment, financial, educational and social support, and manage halfway homes for convalescing patients.

Annex 1

Souvenirs from local charities that enjoyed Complimentary Visits at the Hong Kong Observation Wheel.



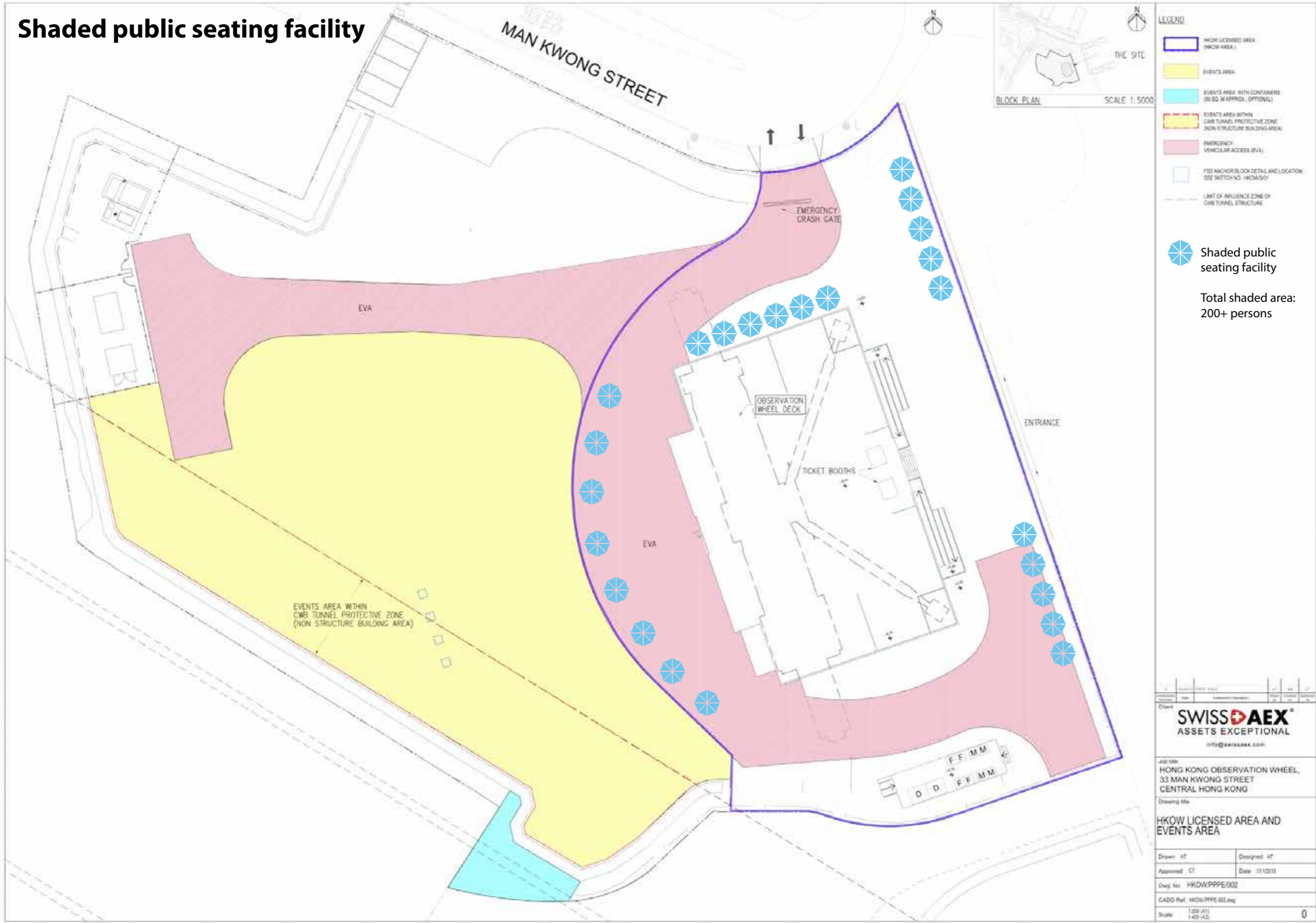







1
ANNIVERSARY 周年

12月5至6日
慶祝香港摩天輪開幕一周年
持有香港身份證*可享所有門票

半價優惠*

持有香港摩天輪當天
門票票尾+香港身份證*
的遊客可享 食品及飲料

半價享用*

特別開放時間直至凌晨1時







1. Are you a Hong Kong Resident?

Results based on 6000 responses to this question.

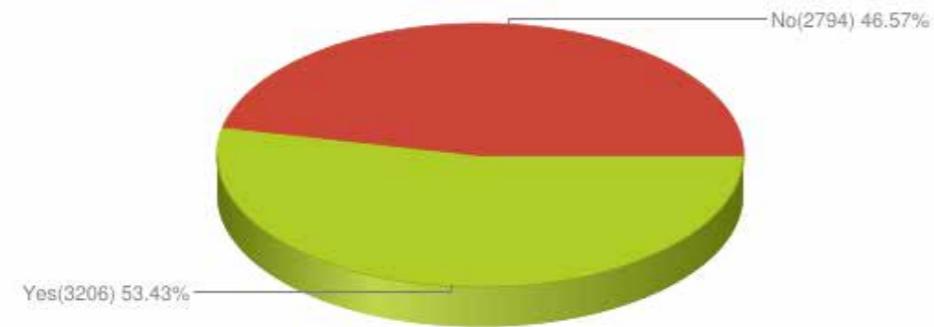

2. How was your overall experience/journey at the Hong Kong Observation Wheel today?

Results based on 6000 responses to this question.

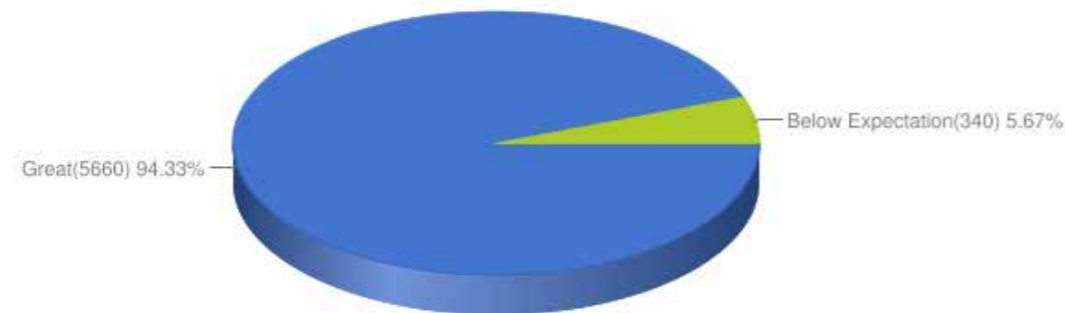

3. How were you received by our staff?

Results based on 6000 responses to this question.

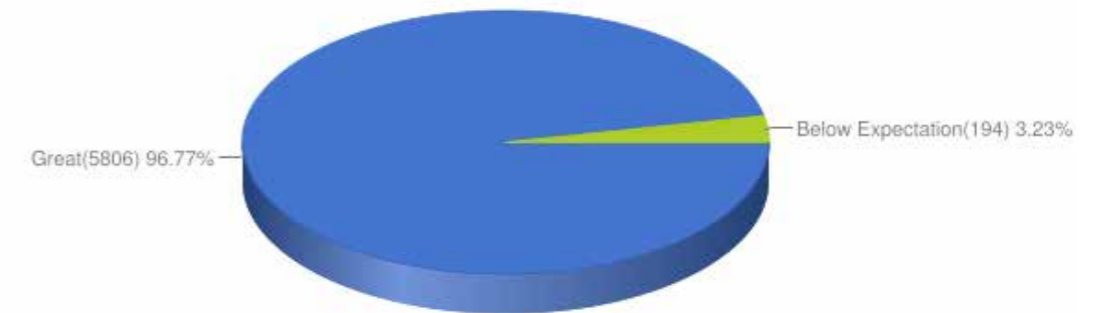

4. Would you like the Hong Kong Observation Wheel to be a permanent attraction in Hong Kong?

Results based on 6000 responses to this question.

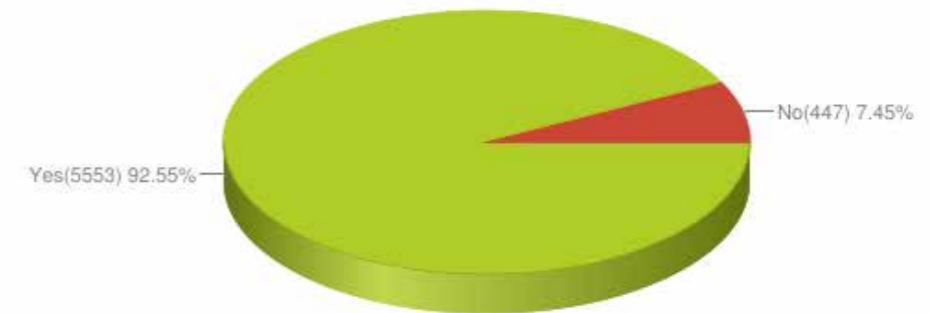

5. Would you recommend the Hong Kong Observation Wheel to others?

Results based on 6000 responses to this question.







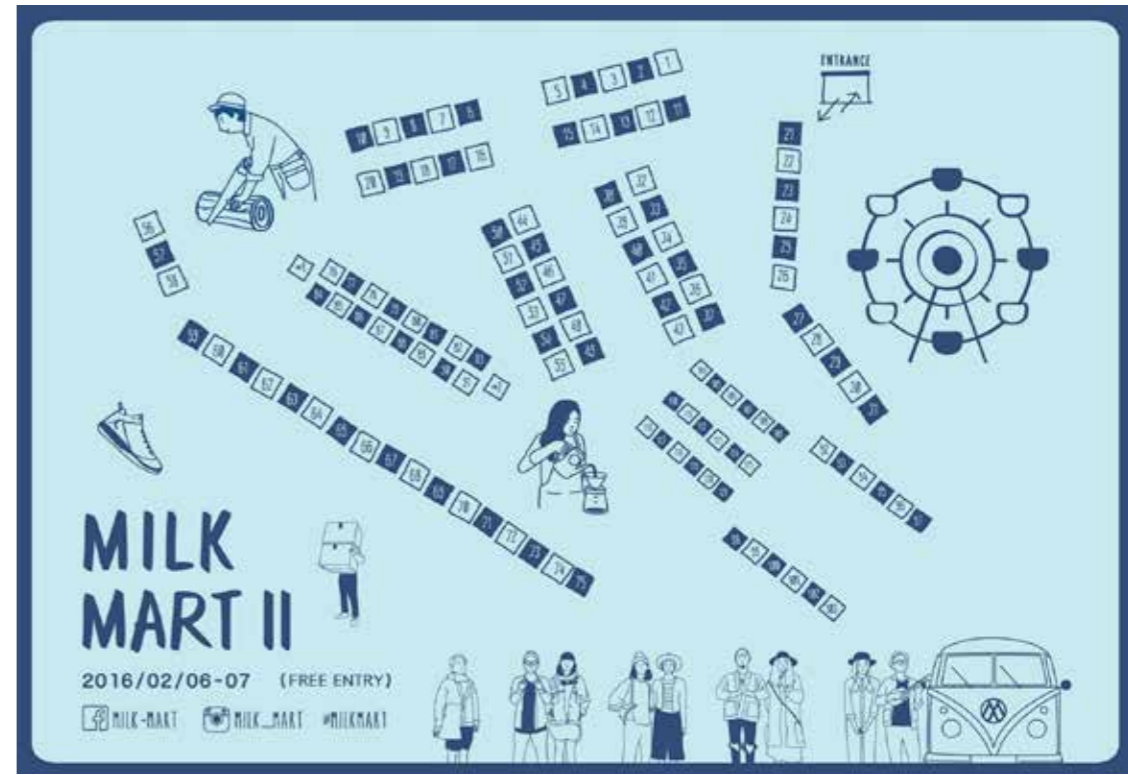
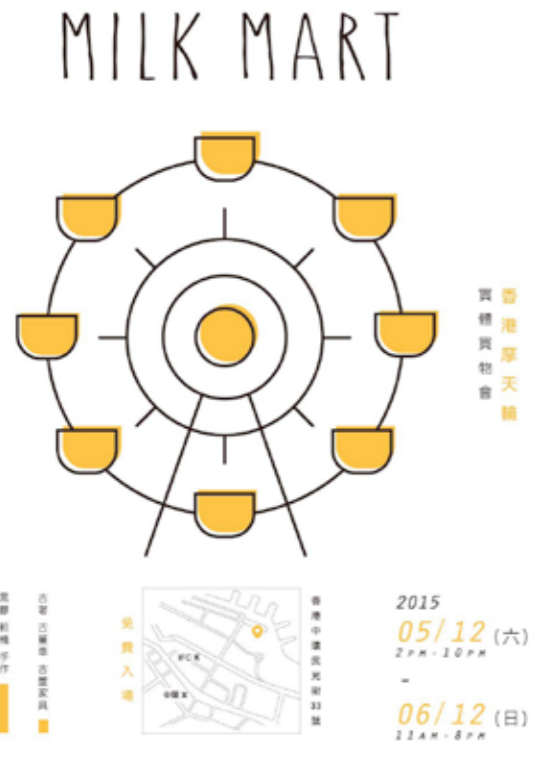







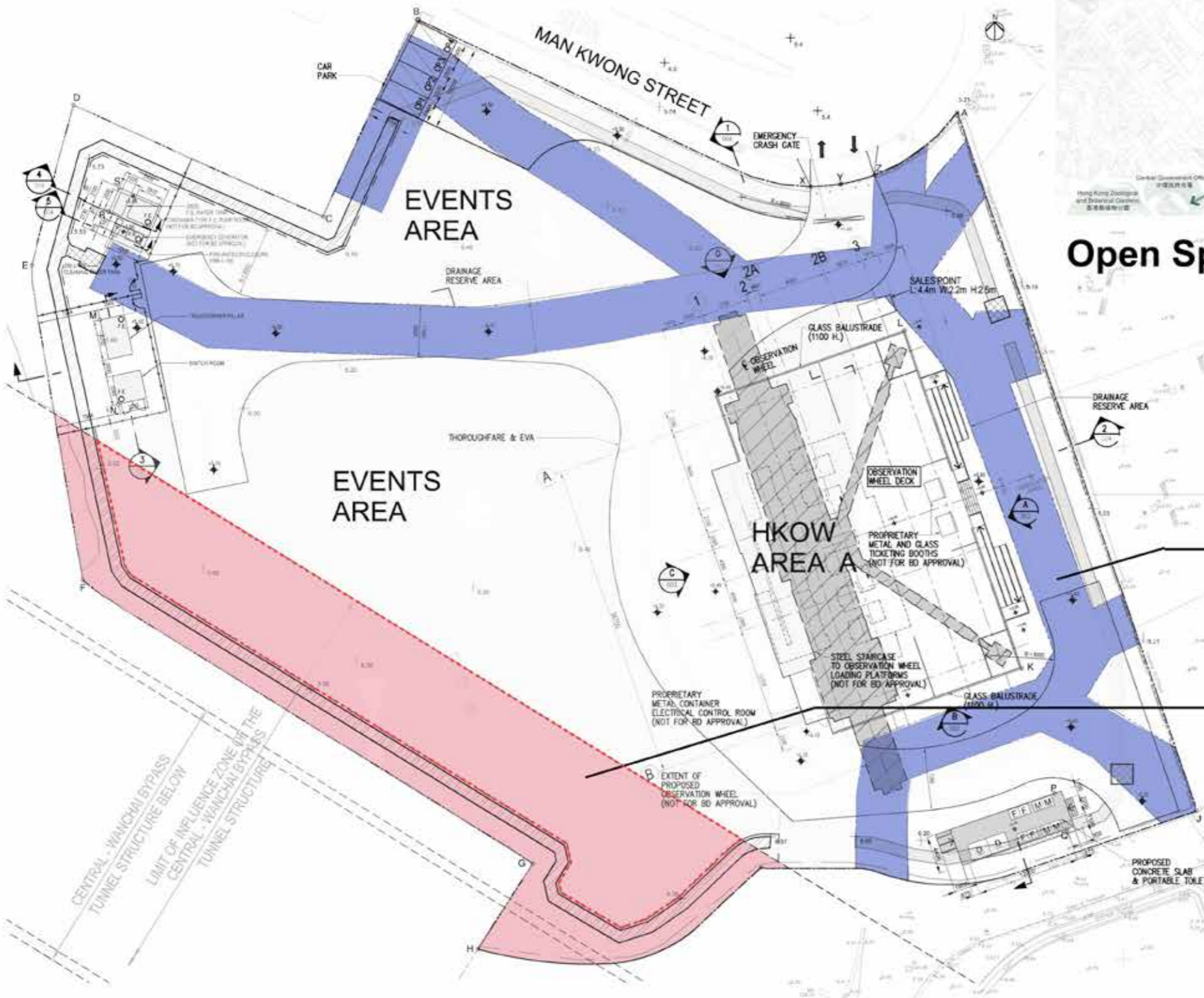

Open Space Network Plan (2012)

2012 Design Constraint:
Drainage Reserve Area

2012 Design Constraint:
Tunnel Protective Zone

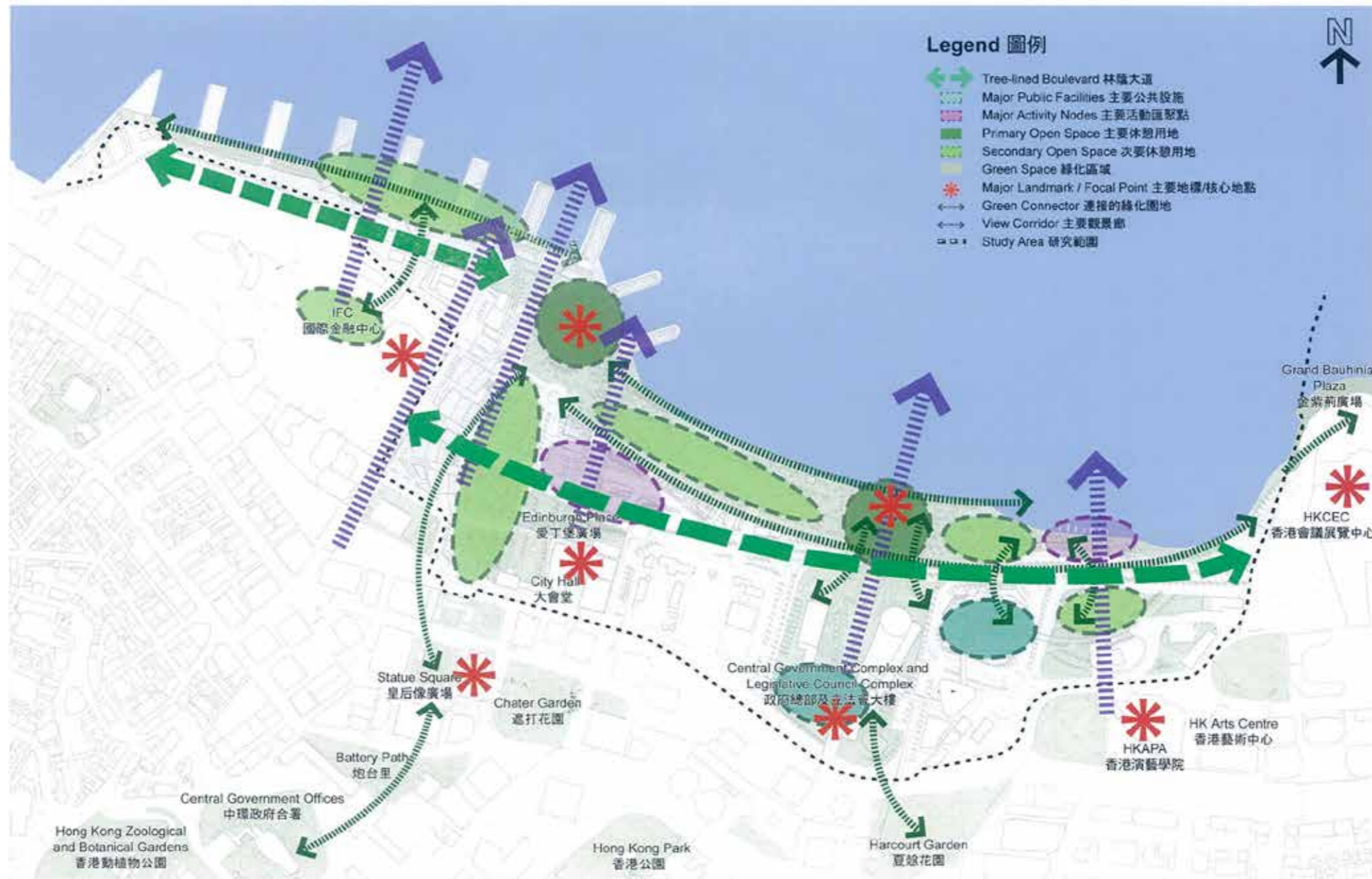

Open Space Network Plan (2012)

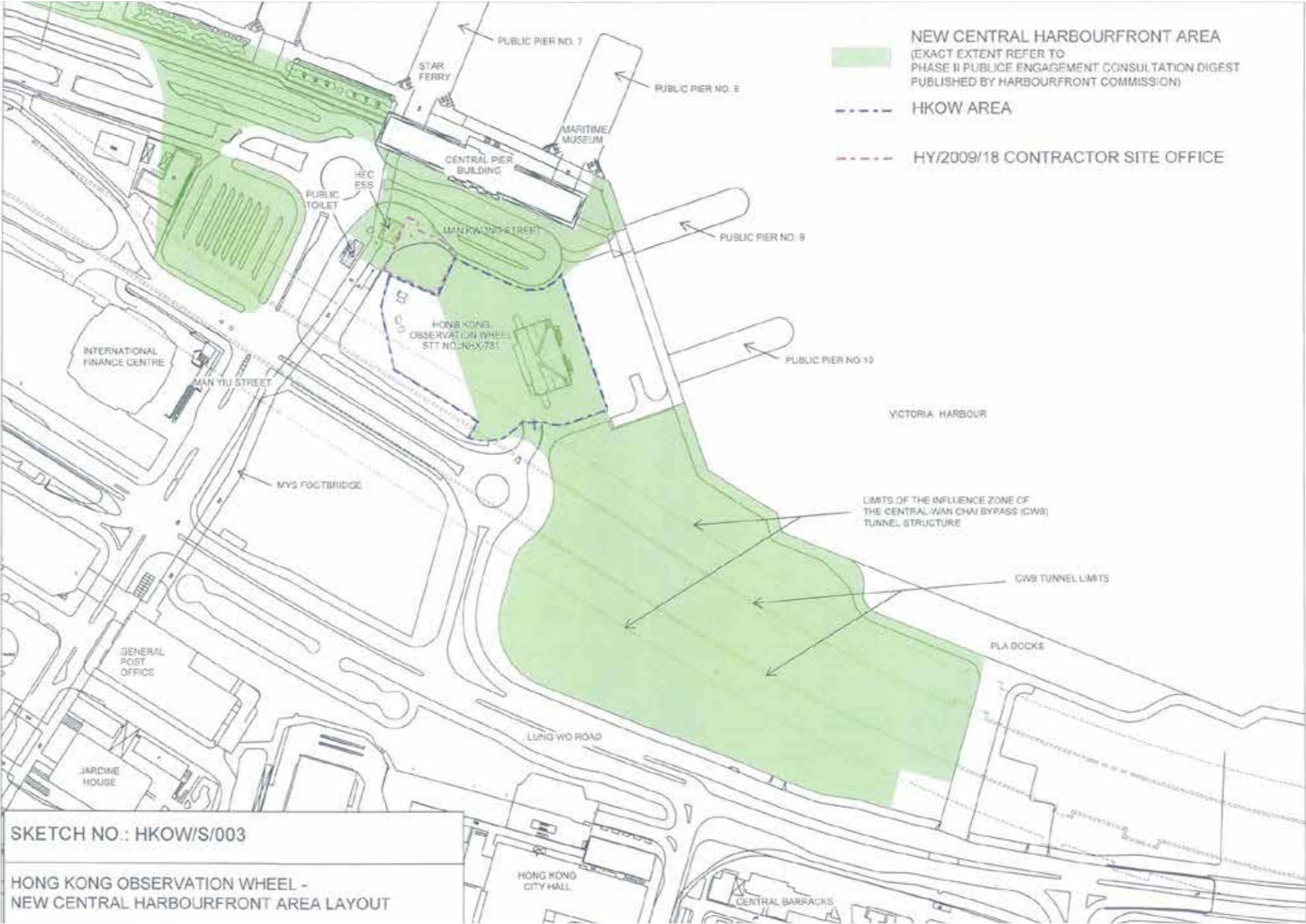

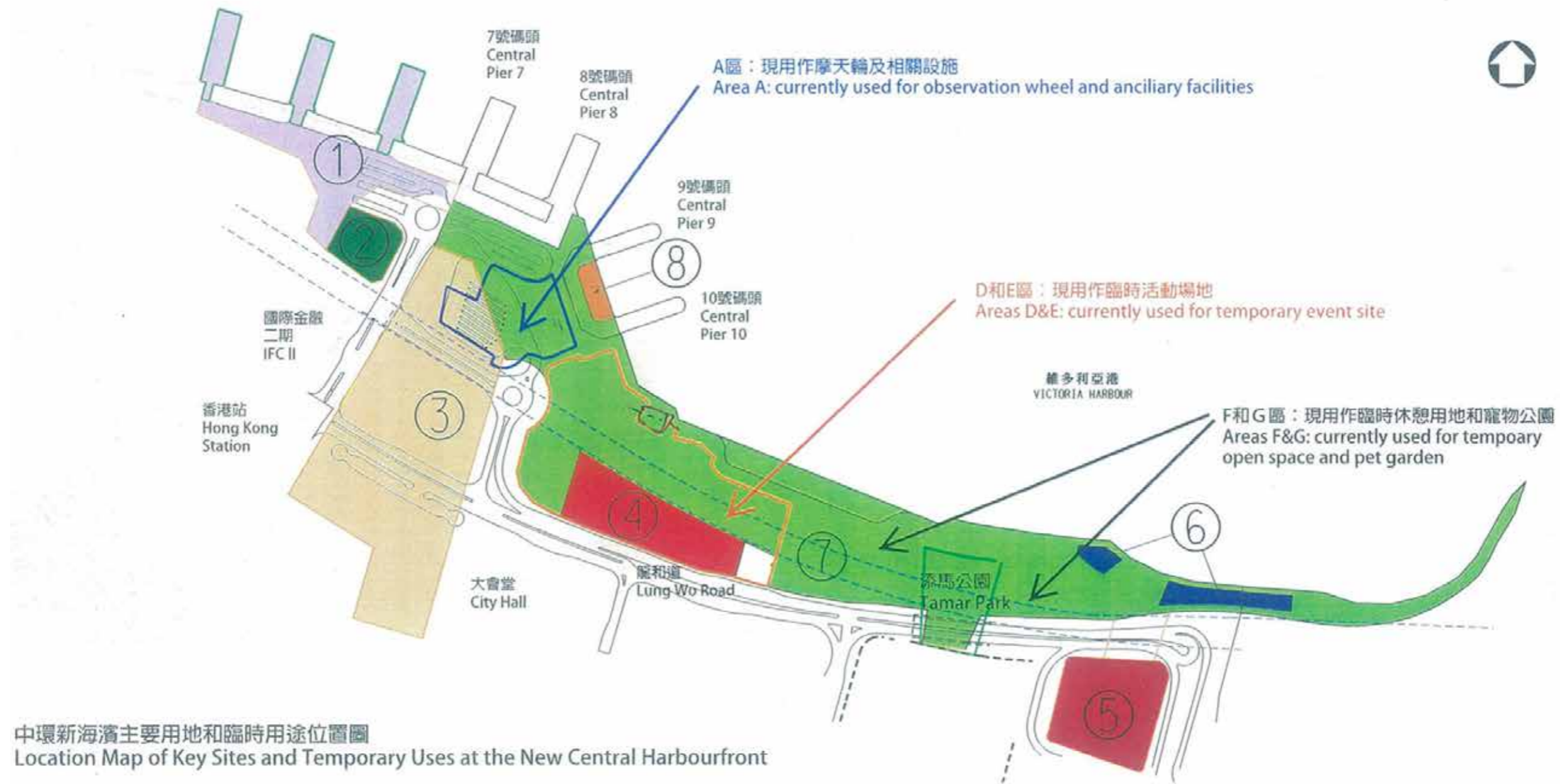

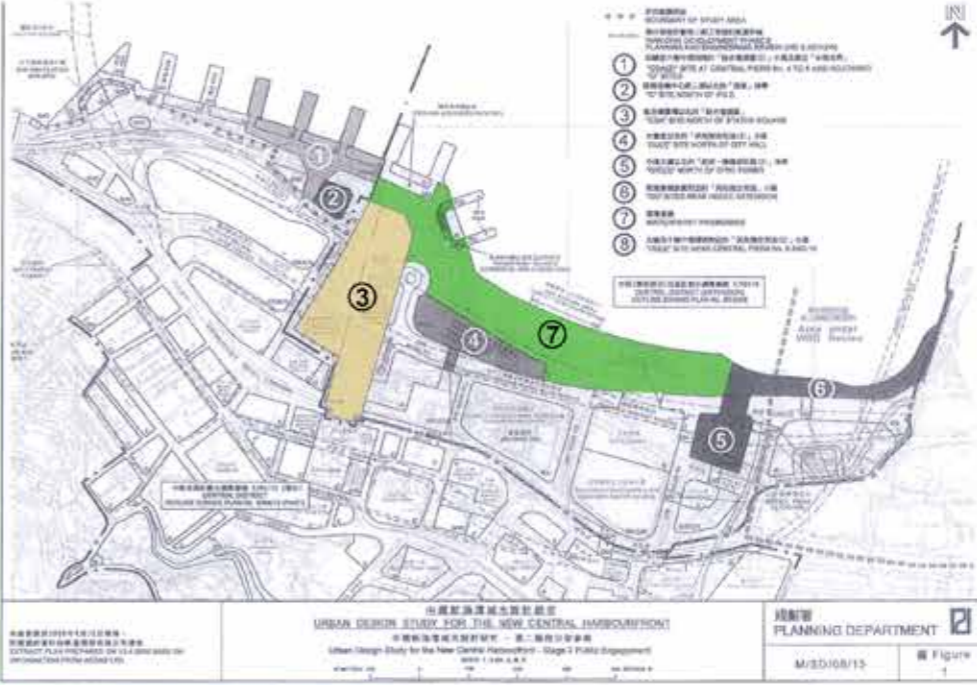
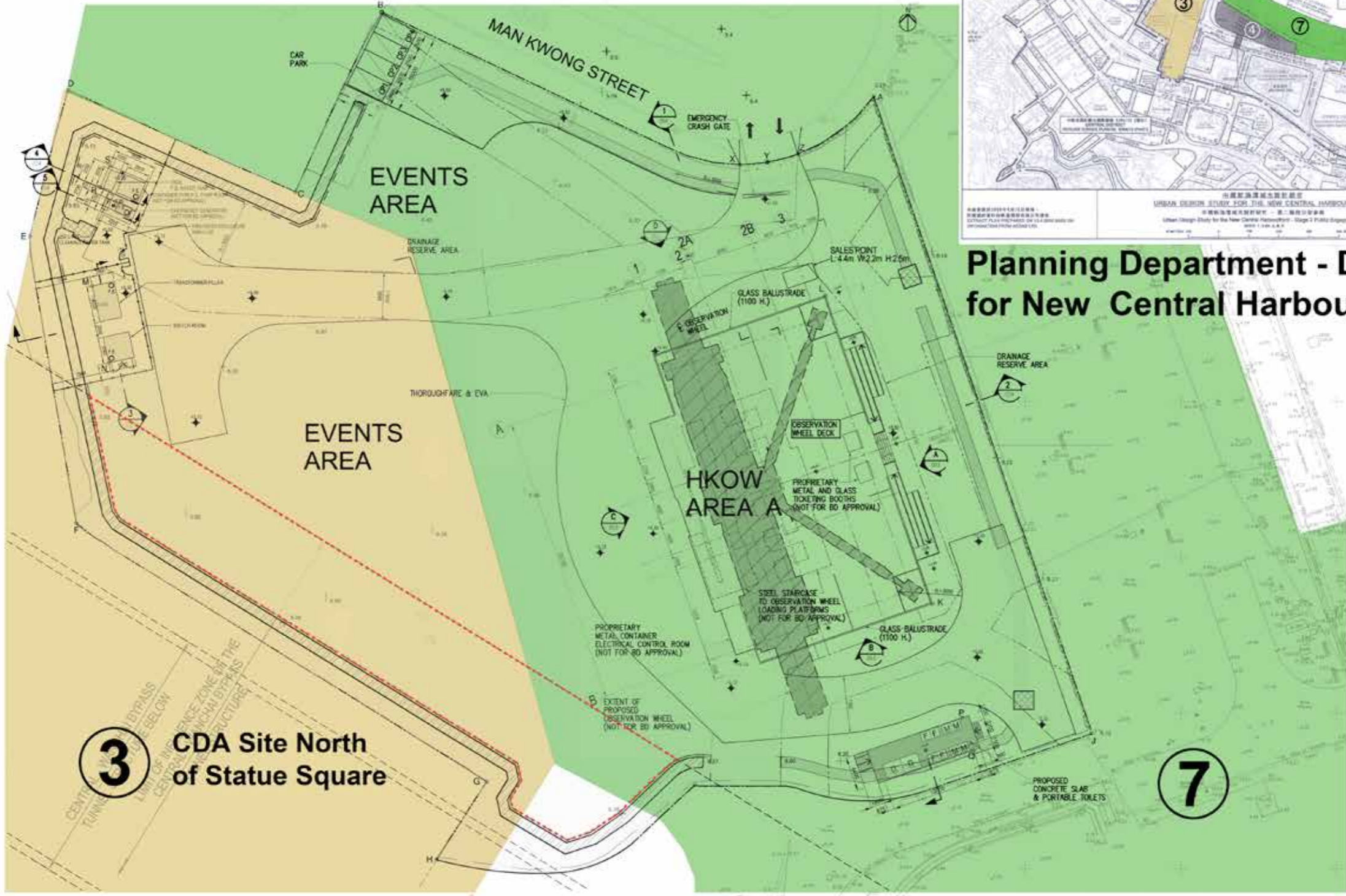

Planning Department - Design Study for New Central Harbourfront

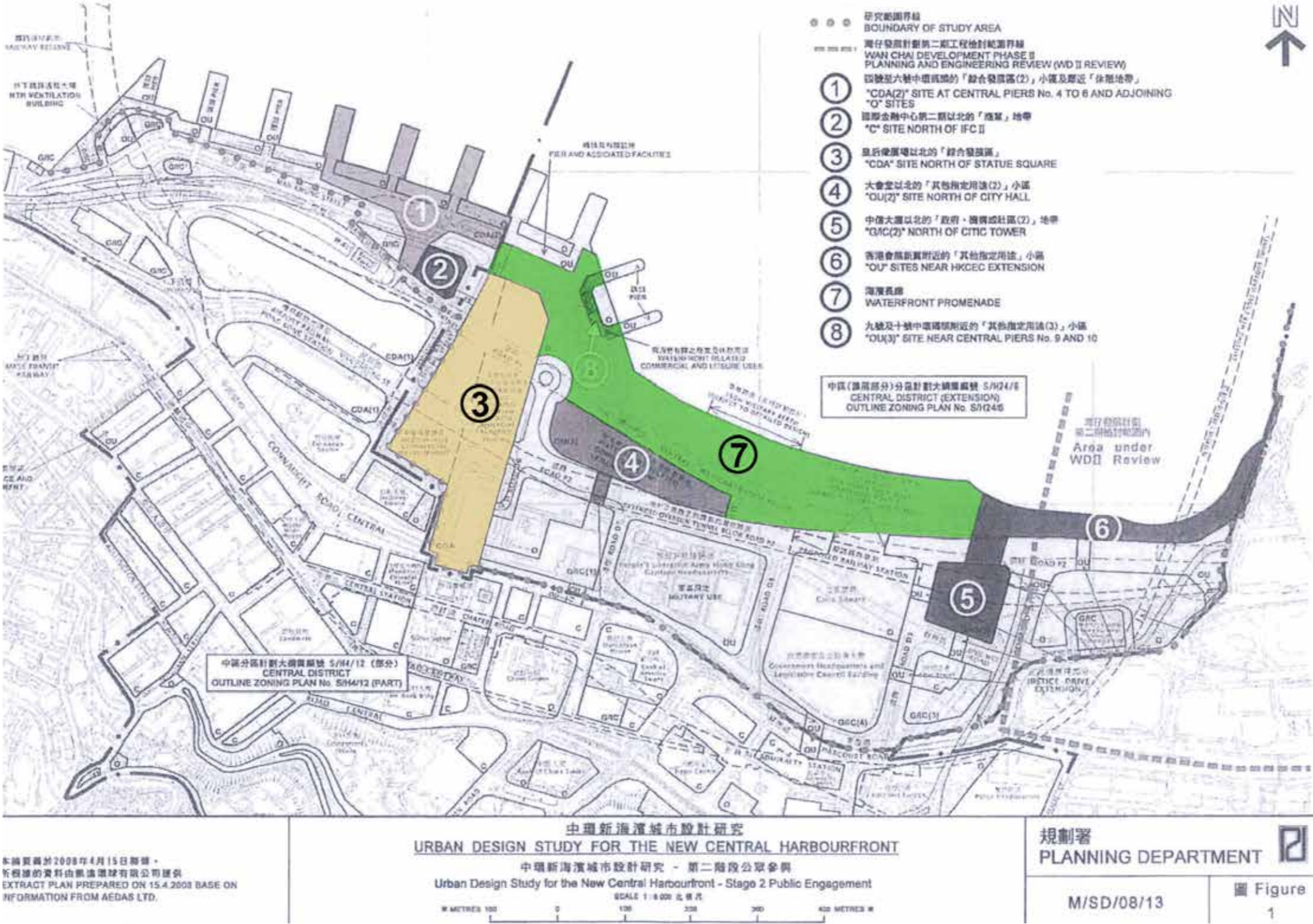

Tamar park



The Hong Kong
Observation Wheel



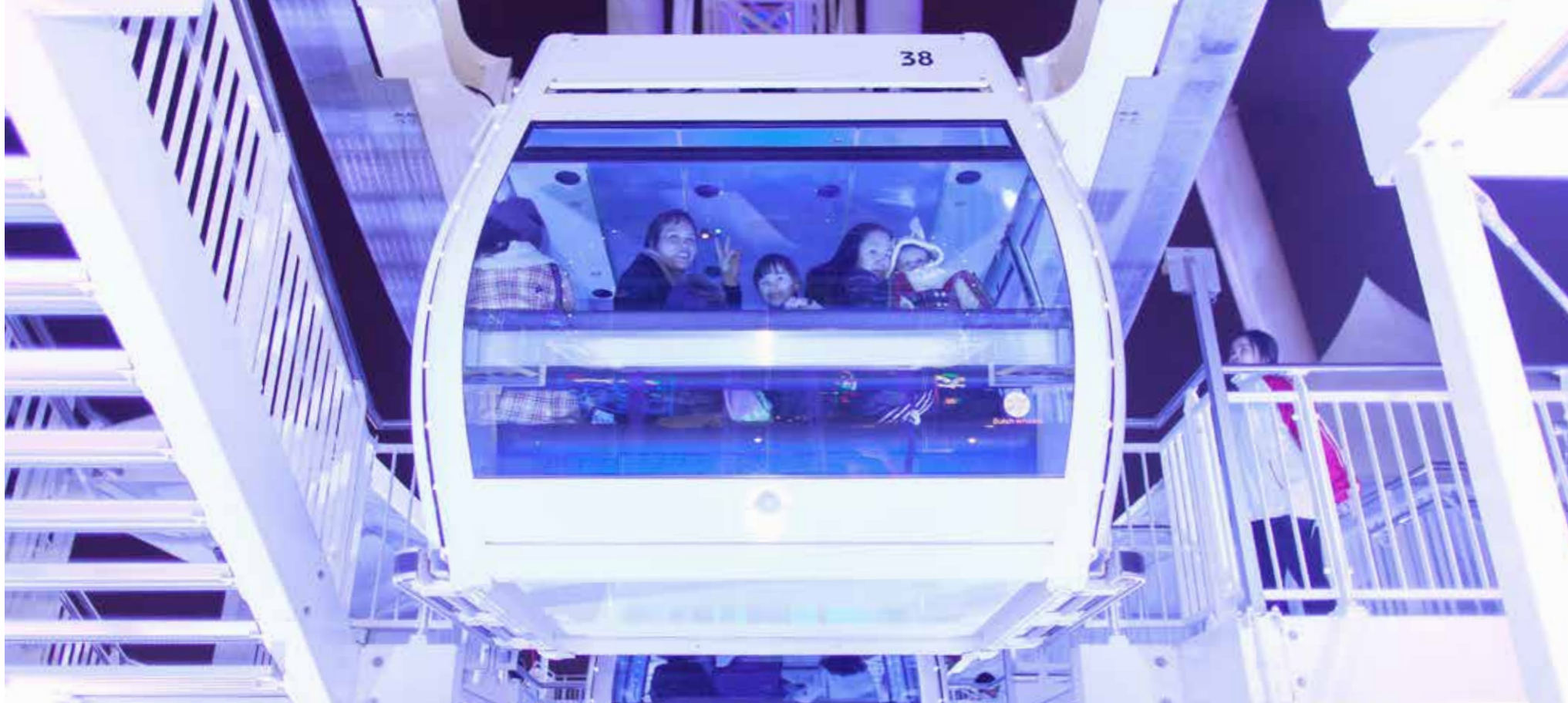









Harbourfront Commission Discussion Paper **Appendices**

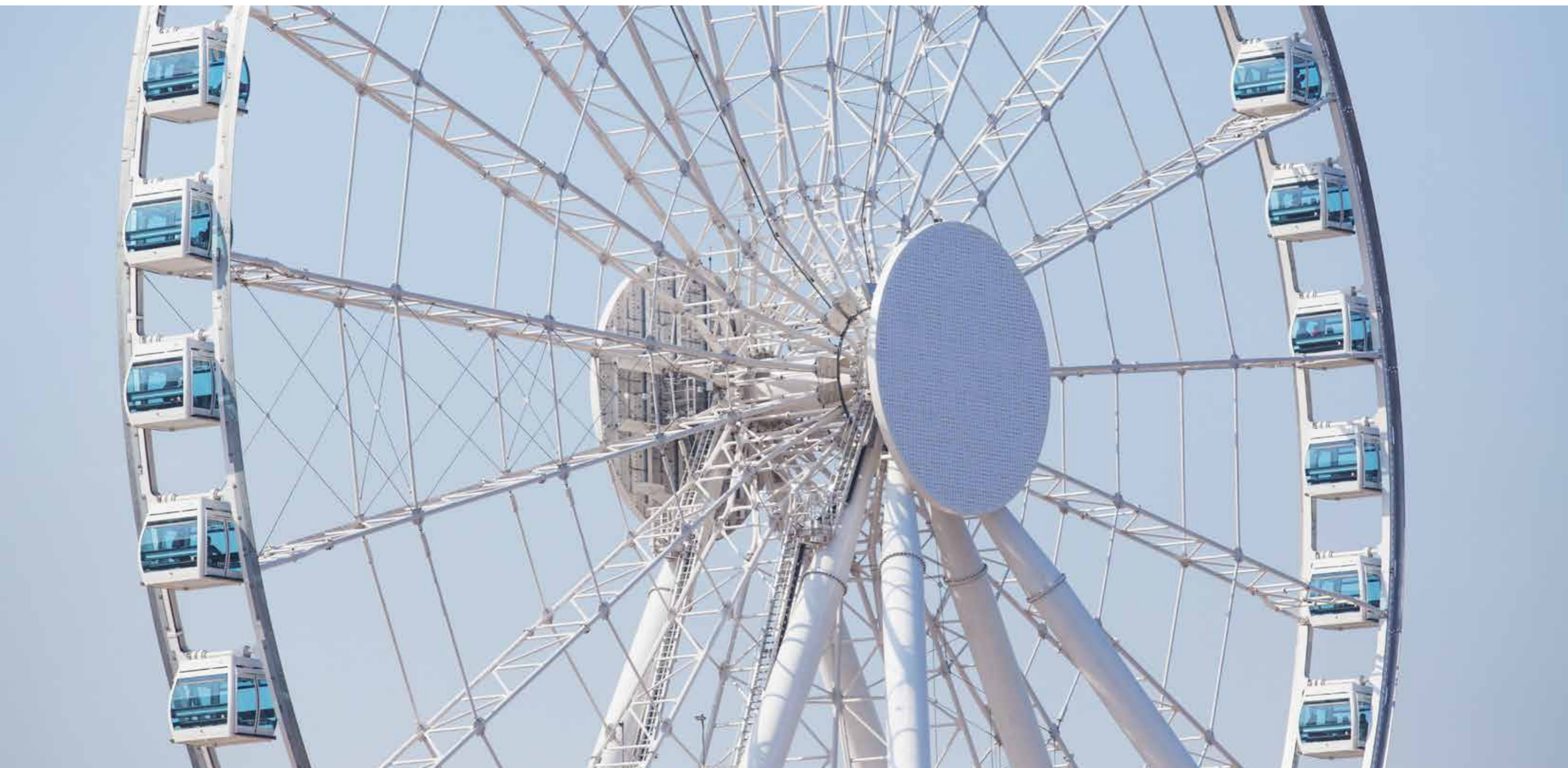

The Hong Kong
Observation Wheel
香港摩天輪

SWISS+AEX[®]
ASSETS EXCEPTIONAL