

# Land Use Review on the Western Part of Kennedy Town

Task Force on Harbourfront  
Developments on Hong Kong Island  
5.5.2015

# Review Area

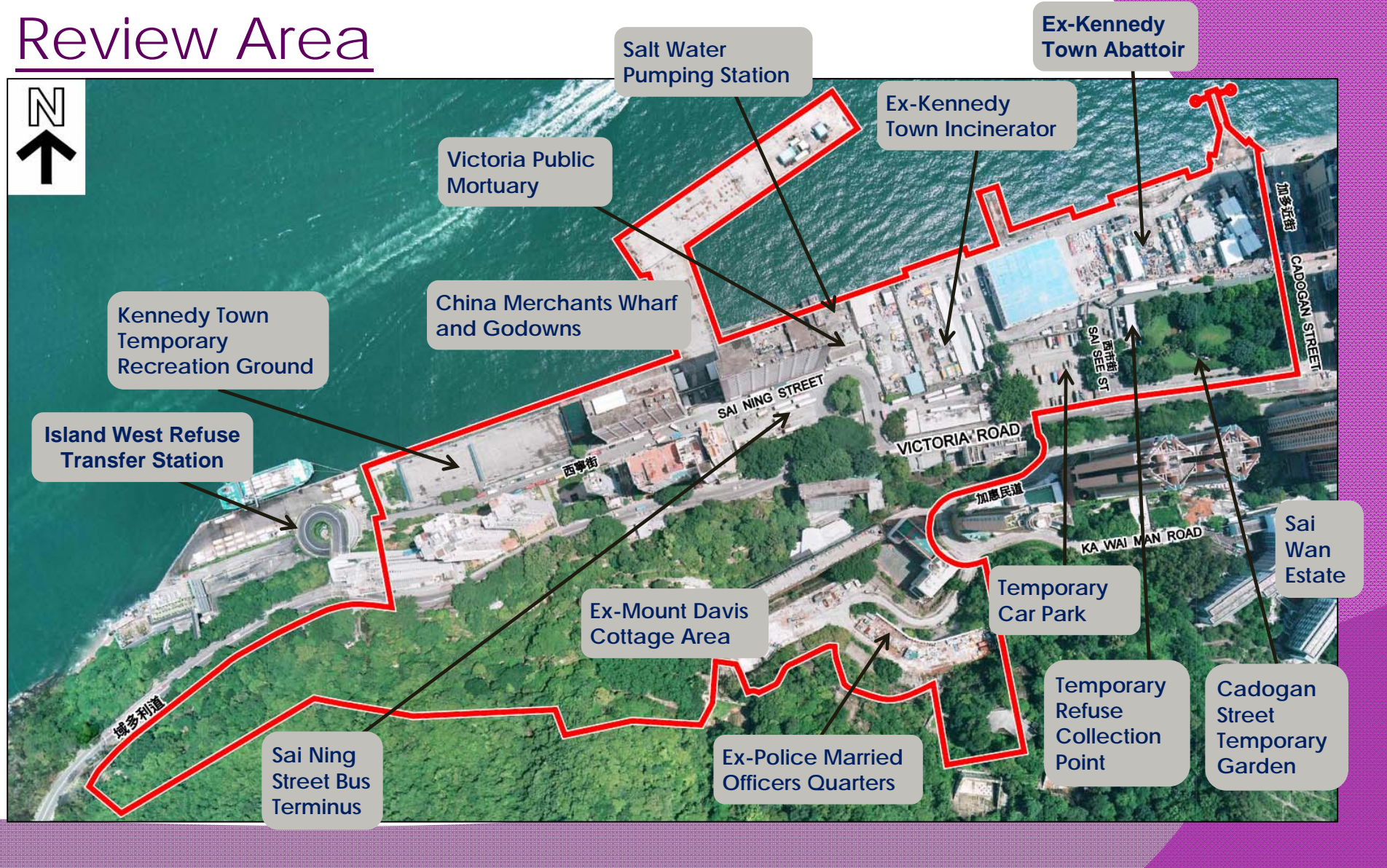





# Preliminary Land Use Proposal

(For consultation with TFHK on 7.6.2013)

- New residential and GIC developments

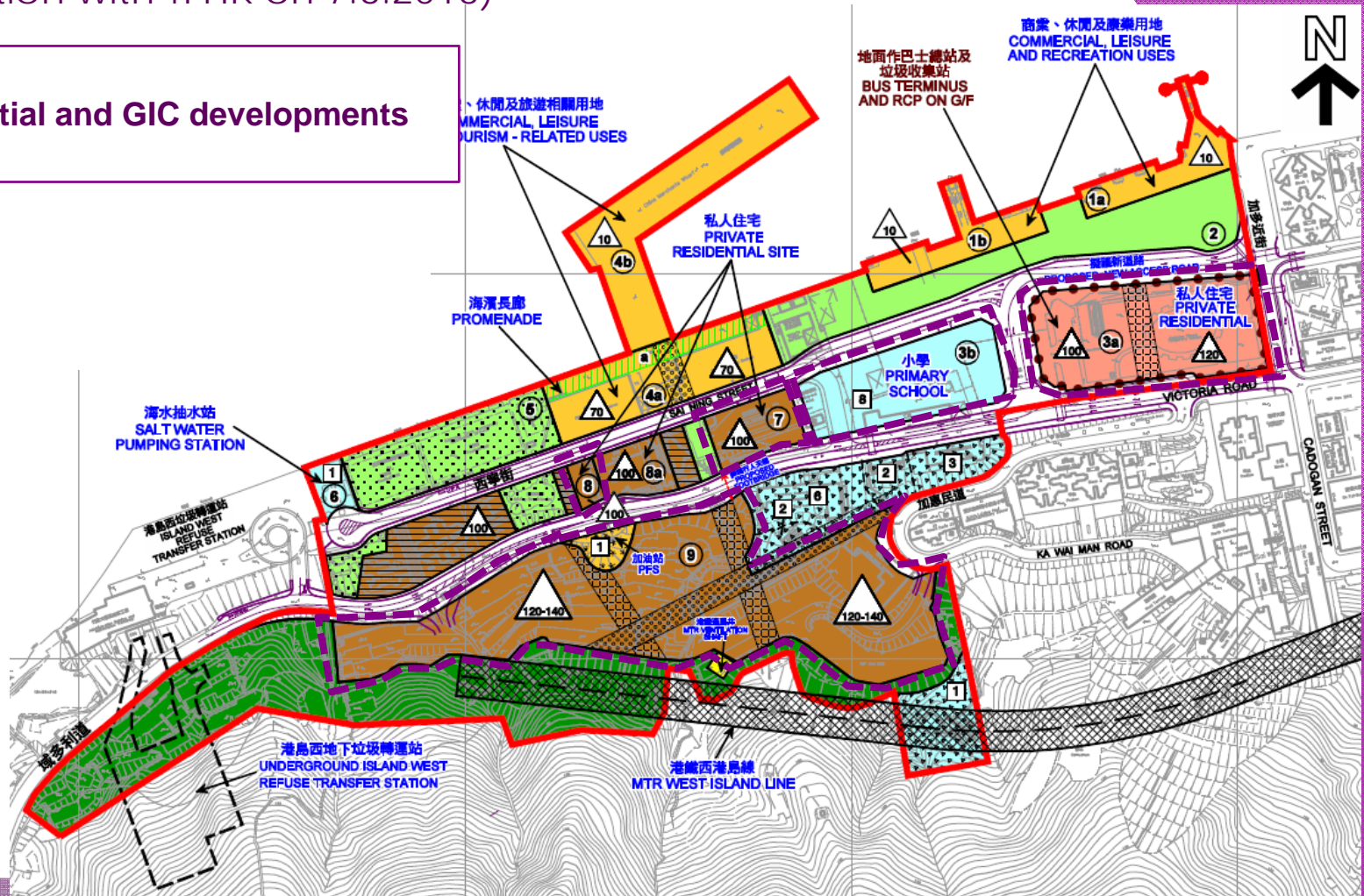





# Views of TFHK on 7.6.2013

(on the Preliminary Land Use Proposal)



## Accessibility to the Waterfront

- to enhance pedestrian connectivity;
- to shorten new access road for direct access to the waterfront;
- to consider marine access;

## Location and Design of Private Housing Development at Site 3a

- swapping of primary school (Site 3b) with private housing development (Site 3a);
- PTI to be well integrated with the topside residential development;

## Others

- to retain the arch and foundation stone of the ex-Tung Wah Smallpox Hospital at its current location; and
- to extend tramway to serve new residential developments

# Public Consultations

In May and June 2013, PlanD consulted Central & Western District Council and attended two public forums









# Accessibility to the Waterfront & Open Space

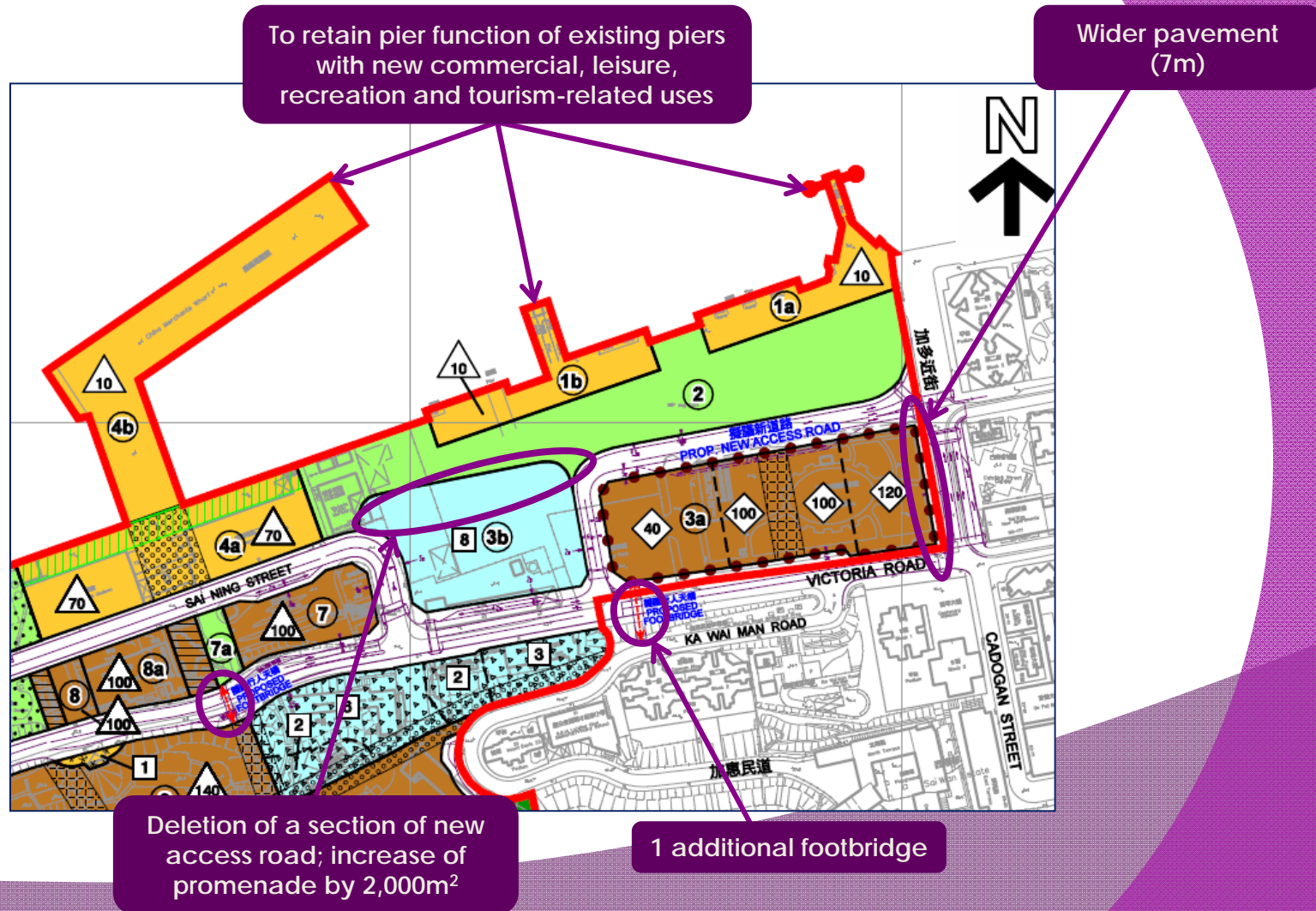

# Private Housing Development at Site 3a

- to minimise size of PTI to retain more space for GIC facilities;
- to provide basement carpark for private cars and goods vehicles; and
- 8-storey primary school, together with existing low-rise GIC developments to provide visual break

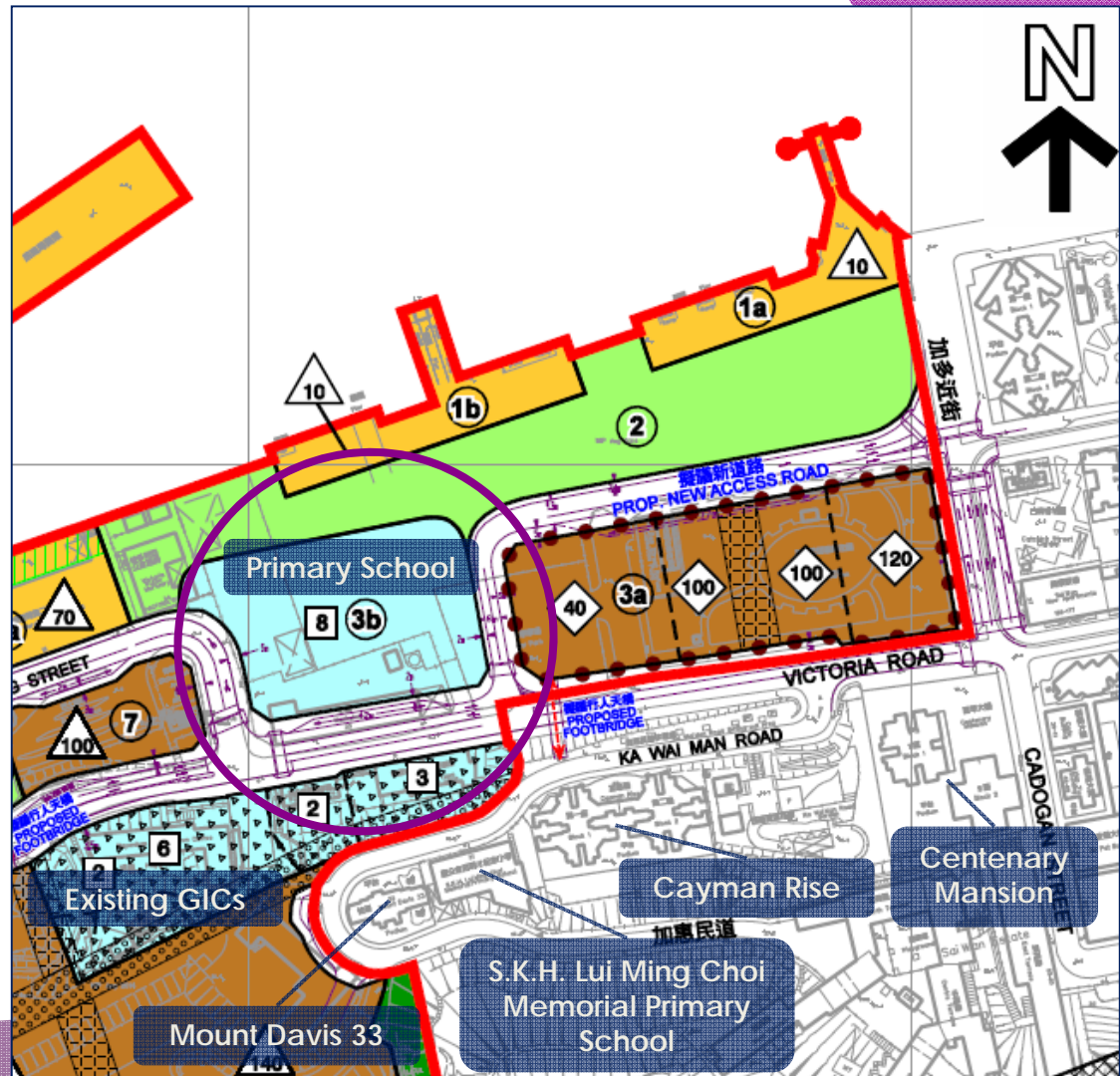



# Other TFHK's Concerns

- Relocation of the arch and foundation stone of the Ex-Tung Wah Smallpox Hospital to waterfront promenade for better setting for conservation
- TD has no plan to extend tramway service

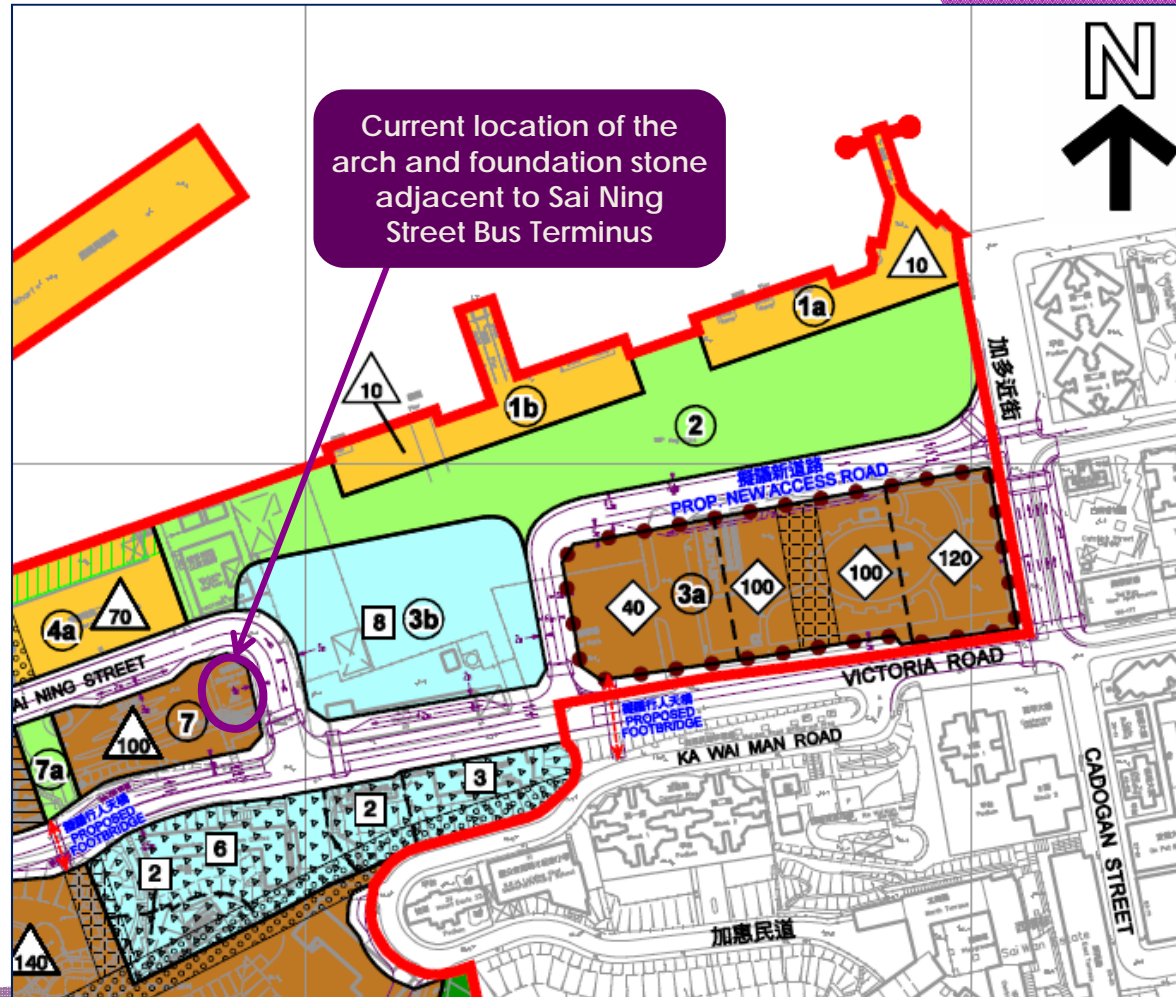

## Next Stage

- Corresponding amendments to the Kennedy Town and Mount Davis OZP, together with comments of TFHK, C&WDC, relevant Government departments and public concerns, to be submitted to the Metro Planning Committee (MPC) of the Town Planning Board (TPB) in accordance with the established procedures; and
- If the MPC agrees to the rezoning amendments, the TPB will exhibit the OZP amendments for public inspection under the Town Planning Ordinance for 2 months



**Thank you**

A decorative graphic on the right side of the slide, consisting of a vertical purple bar with a halftone dot pattern. A large white semi-circle is cut out from the left side of this bar, extending from the top to the bottom. A horizontal purple bar with a halftone dot pattern is positioned at the bottom, overlapping the bottom edge of the white semi-circle.