

Task Force on Harbourfront Developments on Hong Kong Island

For discussion
on 29 May 2017

TFHK/04/2017

Open Space Development at Fung Mat Road Waterfront Site

PURPOSE

This paper briefs Members on the scope of works and design of the Open Space Development at Fung Mat Road Waterfront Site.

BACKGROUND

2. The waterfront site near Fung Mat Road, Sai Ying Pun (the Site) of about 6 500-metre square is situated at the waterfront area between the eastern end of Fung Mat Road and the Western Wholesale Food market (as shown in **Appendix 1**). The Site was allocated to the Drainage Services Department (DSD) as temporary works area for the implementation of the Harbour Area Treatment Scheme for further improvement of the water quality in Victoria Harbour. With the completion of the infrastructure works, DSD had carried out relevant reinstatement works, including the provision of water and electricity connections, paving the ground as well as other landscaping works.

3. As reported to the Task Force vide an earlier paper in November 2016 (copy attached at **Appendix 1**), the Central and Western District Office (DO) plans to carry out minor works, with funding from the District Minor Works programme of the Central and Western District Council (C&WDC), to enhance the Site so that the Site as part of the waterfront promenade could be opened up for public enjoyment as soon as possible.

4. In the longer run, the Site and the adjacent Eastern Street North car-parking site (as explained in another paper no. TFHK/03/2017), (locations of both are shown in **Appendix 1**) will be developed into a waterfront promenade connecting the waterfront area under the Signature Project Scheme and the waterfront area of the Sun Yat Sen Memorial Park. We note the latest development that the HC agreed on 8 May 2017 that the above-said project should be one of the HC's harbourfront

Task Force on Harbourfront Developments on Hong Kong Island

TFHK/04/2017

enhancement projects funded by the \$500 million dedicated funding earmarked for harborfront enhancement. Taking into account the time required for preparation, design and the necessary engagement with relevant stakeholders, it is expected that the construction works of permanent development would commence in 2021/22.

CURRENT STATUS OF THE FUNG MAT ROAD WATERFRONT SITE

5. The Site was temporarily allocated to and currently managed by the Central and Western District Office (C&WDO). DO has received the funding approval from the C&WDC and propose to carry out the enhancement works. The aim of the DMW project is to turn the Site into a public open space for early public enjoyment in the interim pending longer-term development by HC together with the neighboring harbourfront areas, hence its scope is planned to cover the basic and essential works and facilities in a simple and functional design for public enjoyment. The scope of the proposed enhancement works (as shown in **Appendix 2**) includes –

- (a) Installation of 43 LED pole top lamps;
- (b) Installation of 1 rain shelter;
- (c) Installation of 8 benches; and
- (d) Construction of railings along this section of the harbourfront

6. Subject to any feedback from Members and completion of tender procedures for selecting a contractor, on-site works are expected to commence in September 2017 for completion by the first quarter of 2018 and opening by the second quarter of 2018.

COMMUNITY EVENT

7. With the support of the Task Force vide the above-mentioned paper, the DO partnered with the charity Playright Children's Play Association and held a Community Park event in November 2016 as one of the signature events of the Central and Western District Festival 2016. The event alone has attracted over 7 700 participants. Some photos are in **Appendix**

Task Force on Harbourfront Developments on Hong Kong Island

TFHK/04/2017

3. We have received very positive feedback from the local community, including parents, grand-parents and schools, who encouraged us to organize more events of similar type in the harbourfront area or other open space. C&WDC also welcome such activities. The DO will continue working closely with C&WDC, NGOs and other local stakeholders to support organising community activities in demand, create opportunities for good cause and social innovation and make good use of the valuable harbourfront space provided under the leadership of the HC.

APPENDIX

Appendix 1 – Location Plan

Appendix 2 – Layout Plan - Scope of Enhancement Works

Appendix 3 – Photos of the Community Event

**Central and Western District Office
Home Affairs Department
May 2017**

Four Waterfront Sites in Central & Western District (A B C D)

Total waterfront length: 1 350 m (approx.)

Total area: 62 000 sqm (approx.)

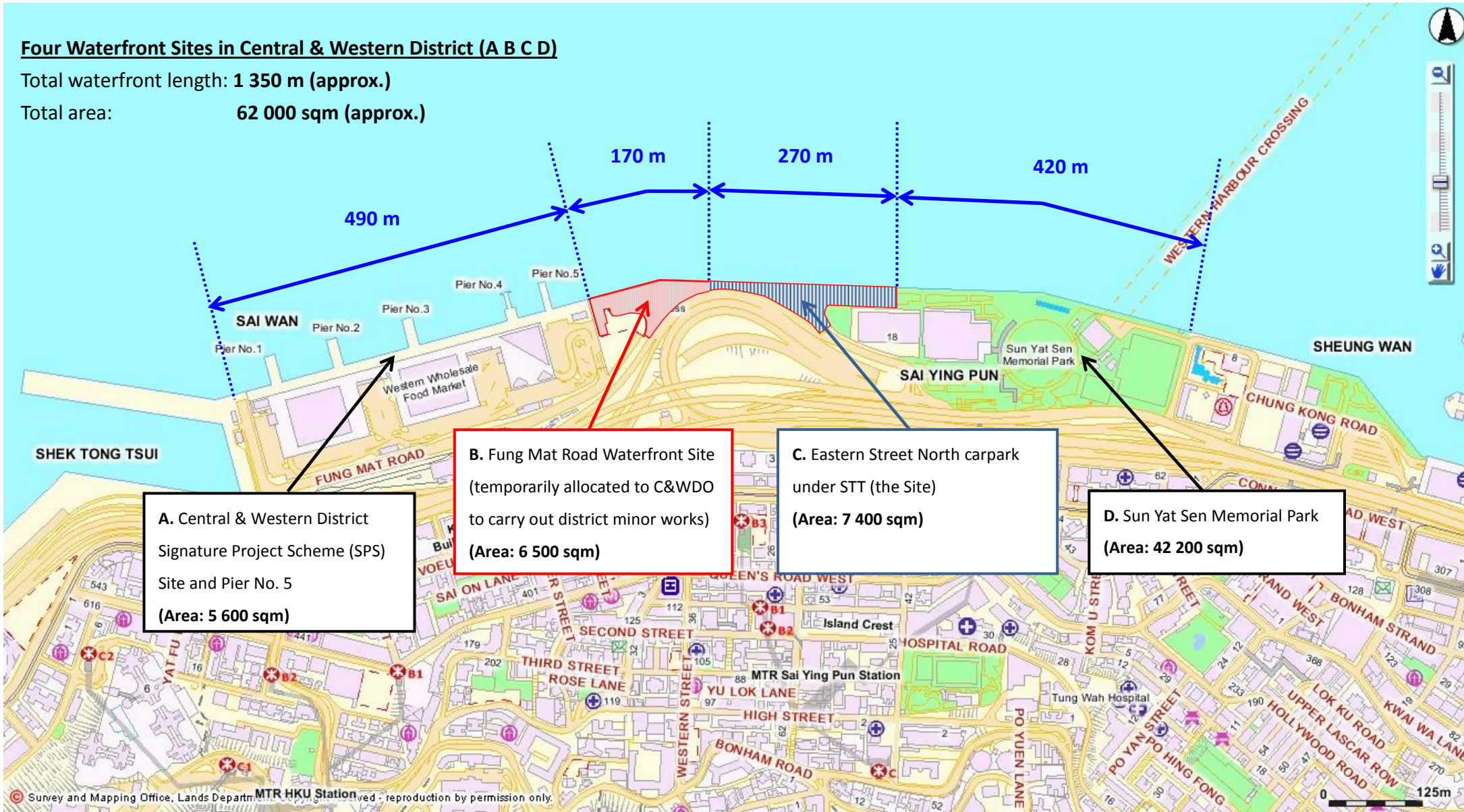

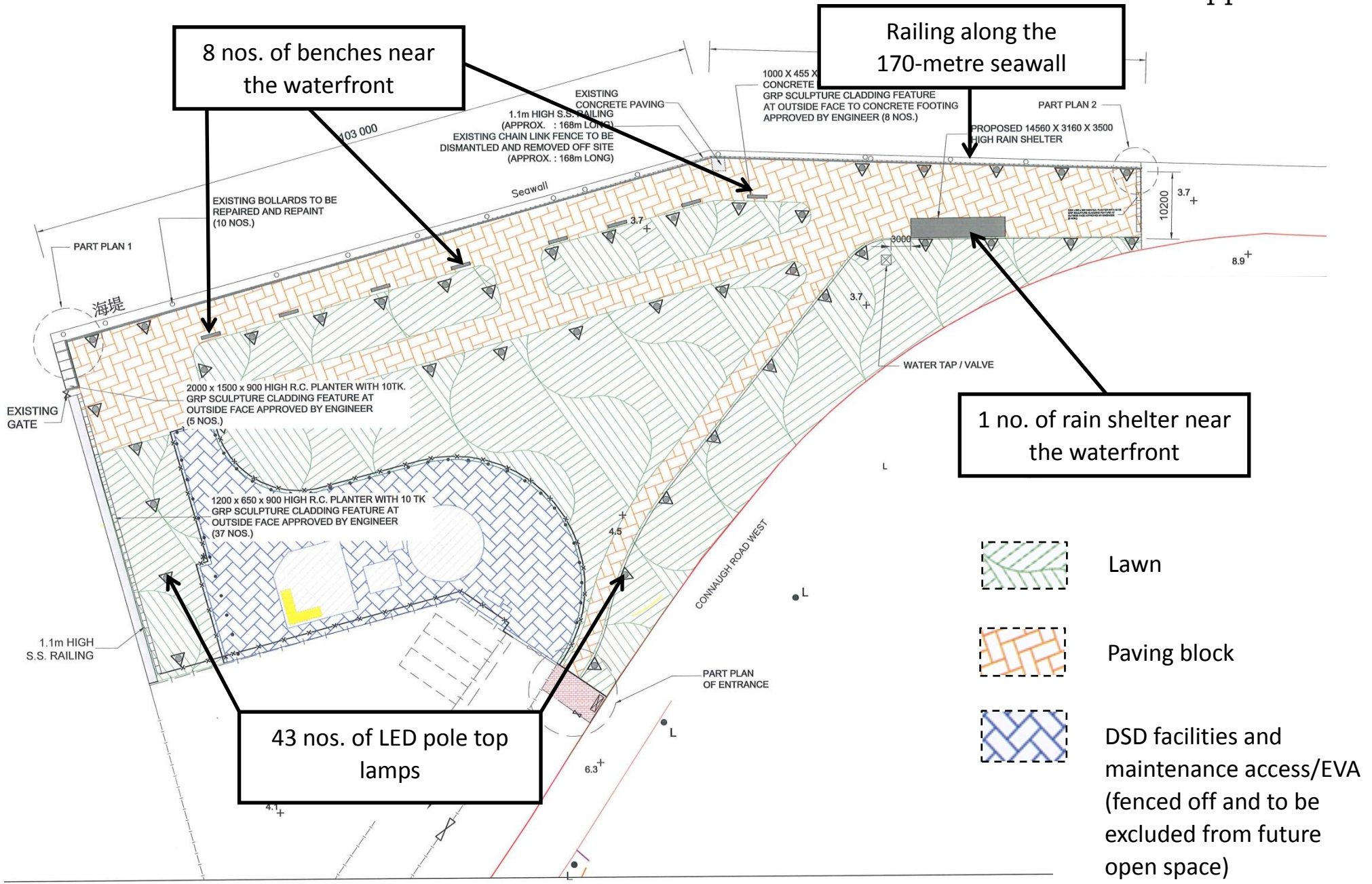

8 nos. of benches near the waterfront

Railing along the 170-metre seawall

1 no. of rain shelter near the waterfront

43 nos. of LED pole top lamps

LAYOUT PLAN

