

**PROPOSED SALT WATER PUMPING STATION  
AND ADJOINING RECREATION AREA  
AT SAI NING STREET,  
KENNEDY TOWN**

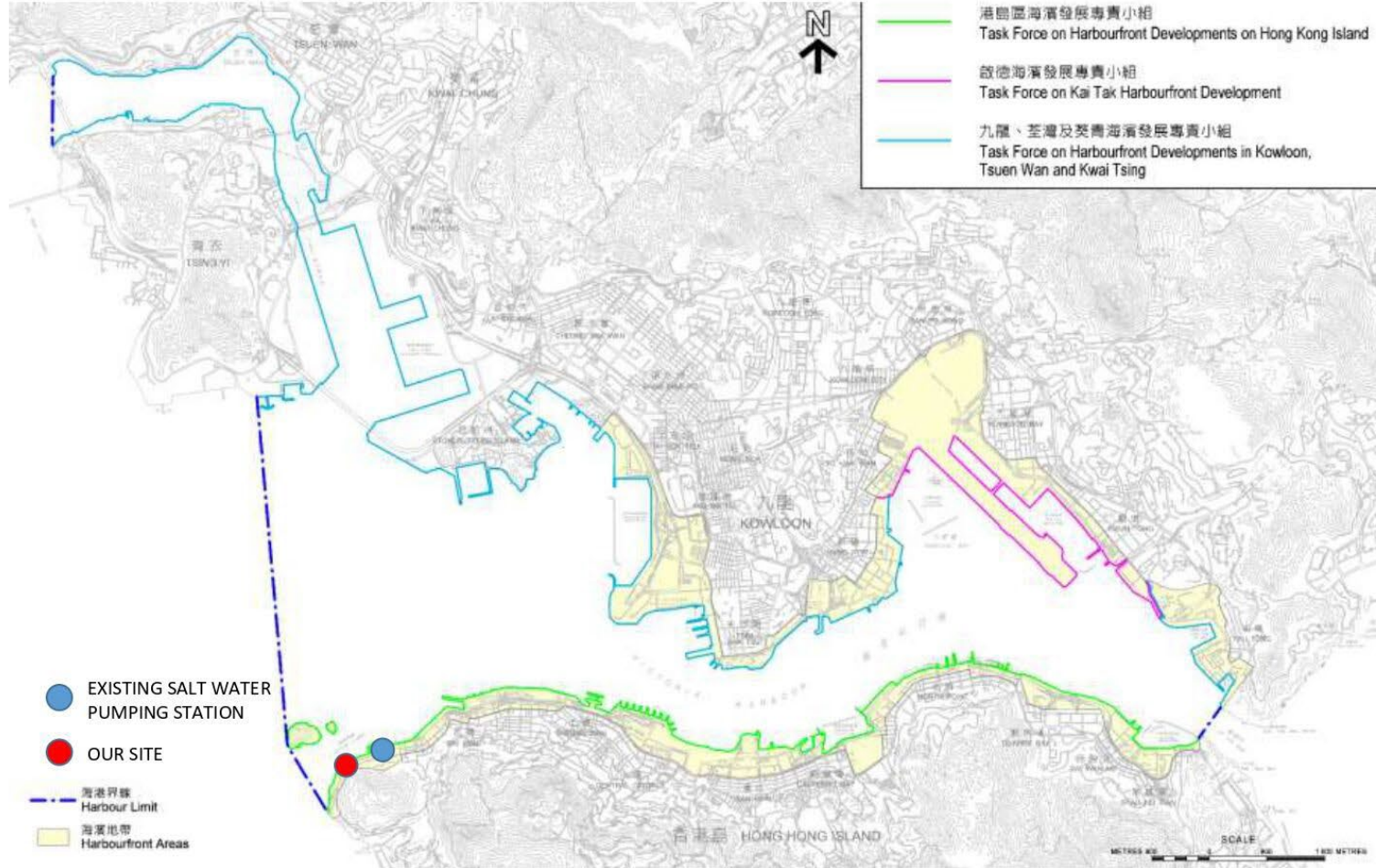

# AREA OF RESPONSIBILITY OF THE HARBOURFRONT COMMISSION TASK FORCES



# OZP (PLAN NO.: S/H1/24, DATE:03.10.2023)



# SITE PLAN



**SITE**

PEDESTRIAN CONNECTION FROM  
NEW FUTSAL PITCH TO WATERFRONT  
PROMENADE

EXISTING KENNEDY  
TOWN SALT WATER  
PUMPING STATION

--- SITE  
BOUNDARY

--- CONNECTIVITY

PROMENADE

WSD NEW  
PUMPING STATION

PUBLIC OPEN  
SPACE

# VICTORIA CITY BOUNDARY STONE

- SITE BOUNDARY
- ROUTE FROM MTR TO SITE
- ★ VICTORIA CITY BOUNDARY STONE



EXISTING KENNEDY TOWN SALT WATER PUMPING STATION



## 1) BOUNDARY STONE AT KENNEDY TOWN

IN 1903 THE GOVERNMENT OF HONG KONG INSTALLED 7 BOUNDARY STONES FOR THE CITY OF VICTORIA. THE WESTERMOST STONE IS LOCATED IN KENNEDY TOWN, INSIDE THE EXISTING FOOTBALL PITCH OF KENNEDY TOWN TEMPORARY RECREATION GROUND.



# CURRENT CONDITIONS



↓ Entrance



1

# CURRENT CONDITIONS



↓ Entrance



# CURRENT CONDITIONS



↓ Entrance





# CURRENT CONDITIONS



↓ Entrance



# CURRENT CONDITIONS



# CURRENT CONDITIONS



# CURRENT CONDITIONS



# CURRENT CONDITIONS



# CURRENT CONDITIONS



# EXISTING MANAGEMENT RESPONSIBILITY OF THE SITE AND ADJACENT AREAS

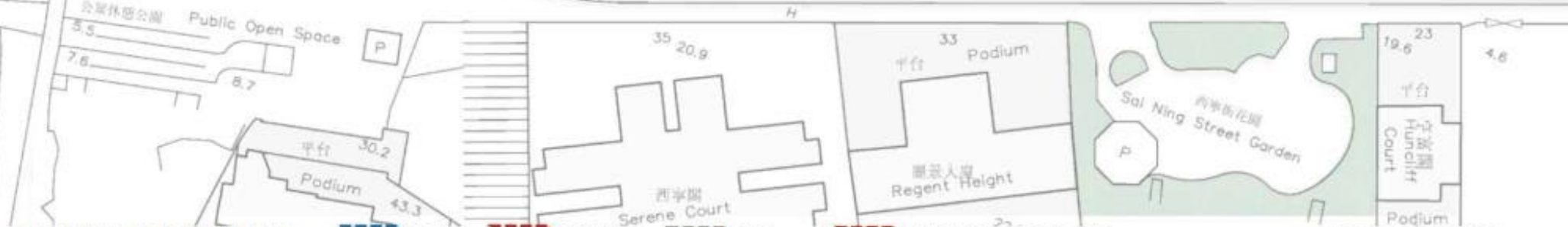

- EXISTING SITE PLAN**
- HAD**
- LCSD**
- TD**
- UNALLOCATED GOVERNMENT LAND**
- ROAD ZONE UNDER OZP**

# PROPOSED MASTER LAYOUT PLAN

環境保護署港島西  
廢物轉運站  
EPD Island West  
Transfer Station



七人足球場  
7-a-side Soccer Pitch

SAI NING STREET



# GROUND FLOOR PLAN



**1 MOVEABLE PLANTER**



**2 LANDSCAPE DECK  
OPENING ABOVE**



**3 SEATING WITH PLANTER**



**4 WIRE TRELLIS**

**5 TOILET BLOCK**

**6 PROMENADE**

SAI NING STREET

# BOUNDARY STONE

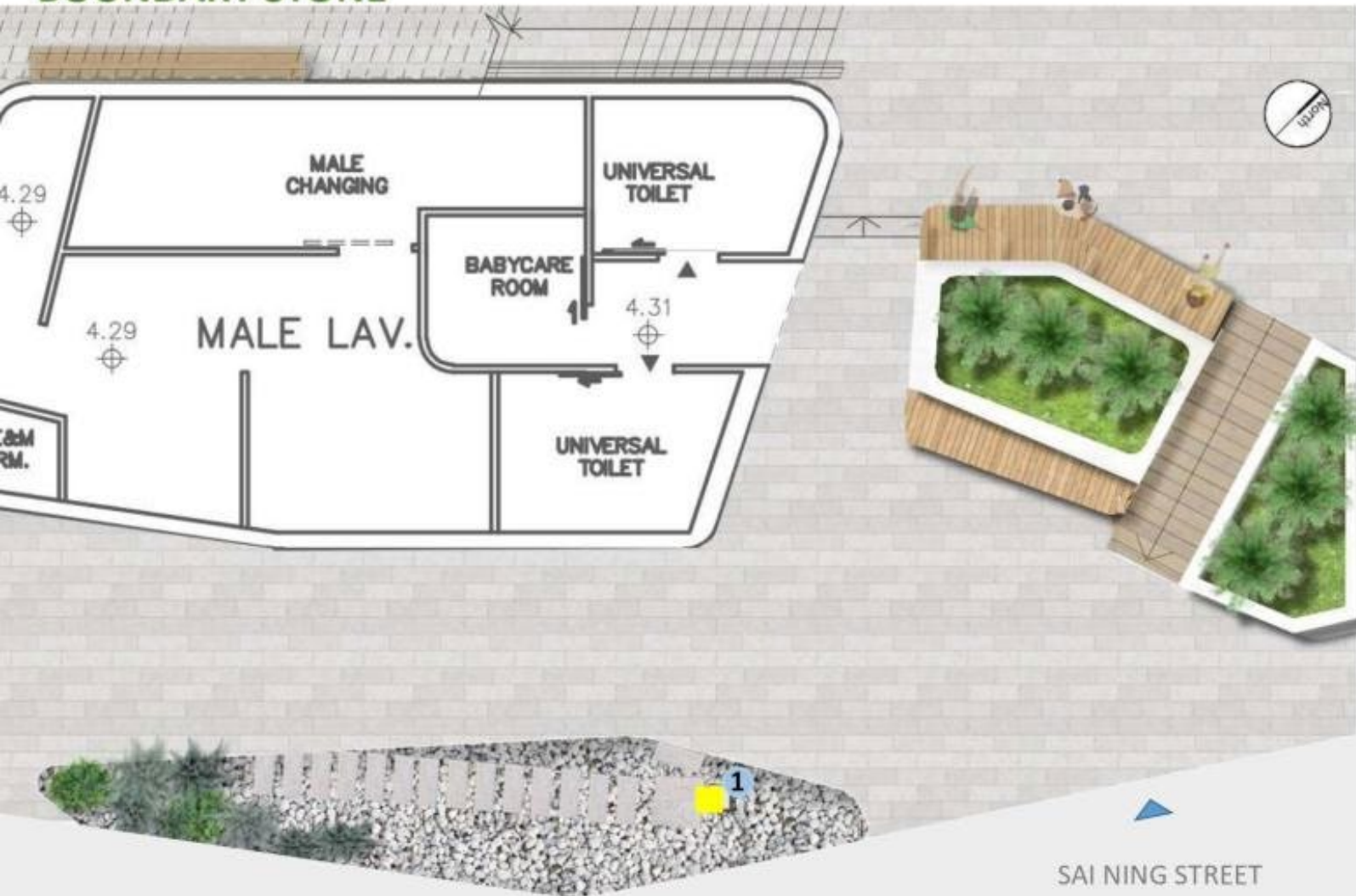

1 BOUNDARY STONE AREA

RAMF

SAI NING STREET

# ROOF PLAN



1 HARBOUR VIEWING DECK



2 SEATING PAVILIONS



3 SEATING



4 SEATING WITH PLANTER



5 LARGE FLEXIBLE LAWN

# PROPOSED MANAGEMENT RESPONSIBILITY OF THE SITE AND ADJACENT AREAS



GROUND FLOOR PLAN

HAD

LCSD

WSD

TD

ROAD ZONE UNDER OZP

# PROPOSED MANAGEMENT RESPONSIBILITY OF THE SITE AND ADJACENT AREAS

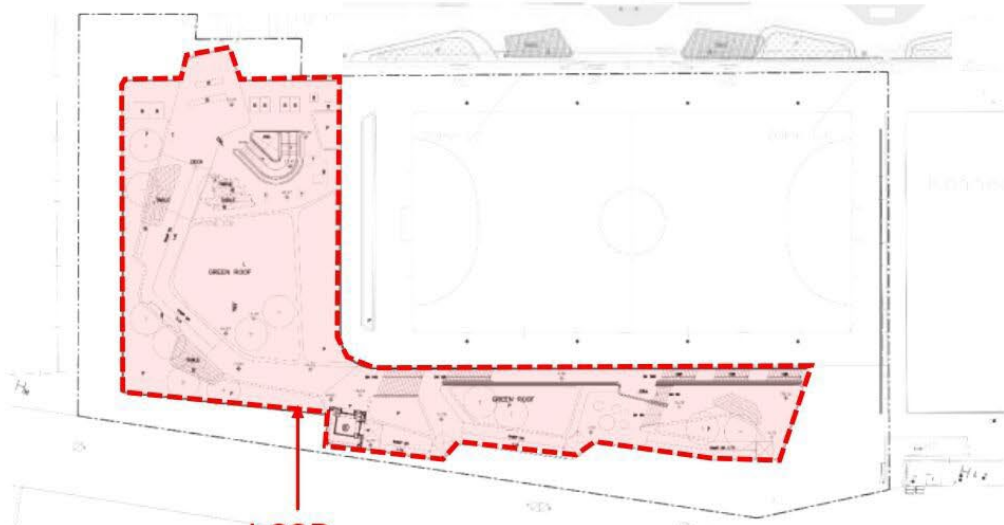

**LCSD**  
**(VIEWING DECK ON R/F)**

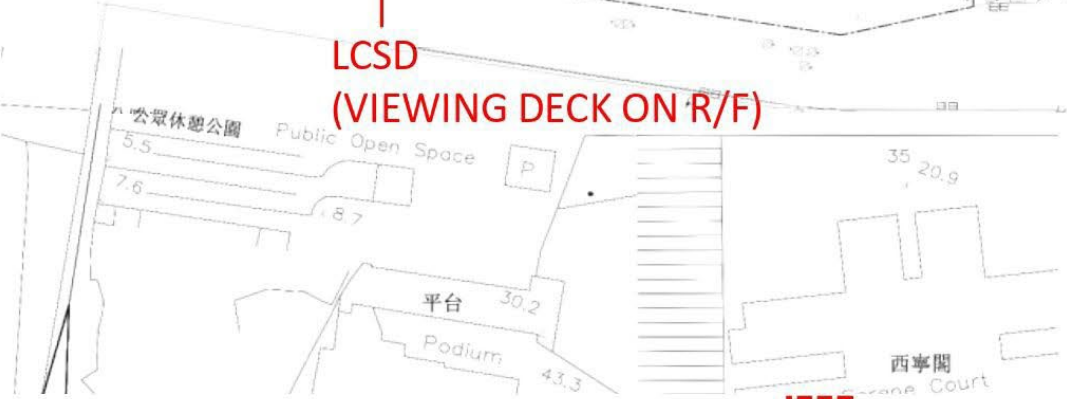
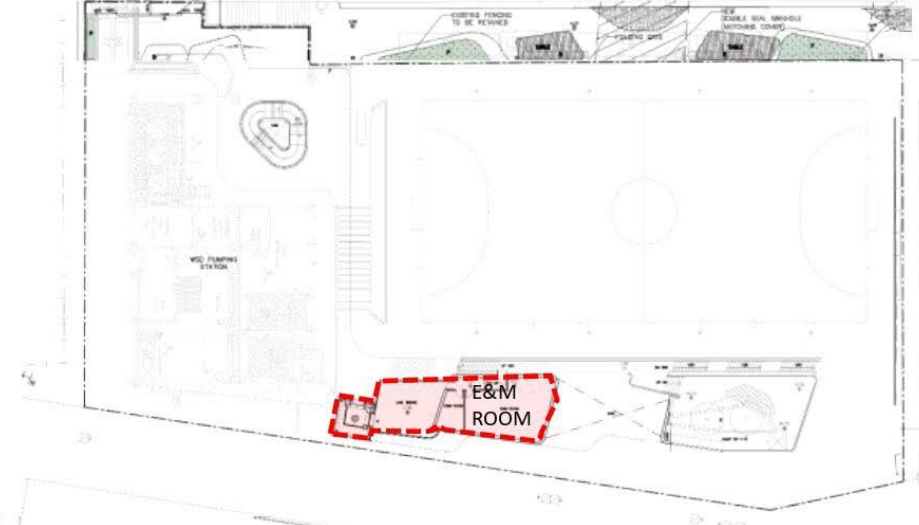

**ROOF PLAN**

**LCSD**

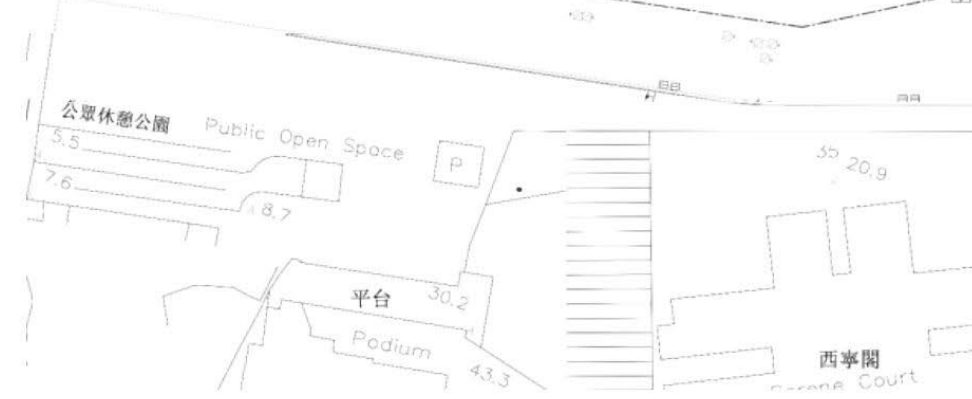

**MEZZANINE FLOOR PLAN**

# PROPOSED MANAGEMENT RESPONSIBILITY OF THE HARBOURFRONT AREA

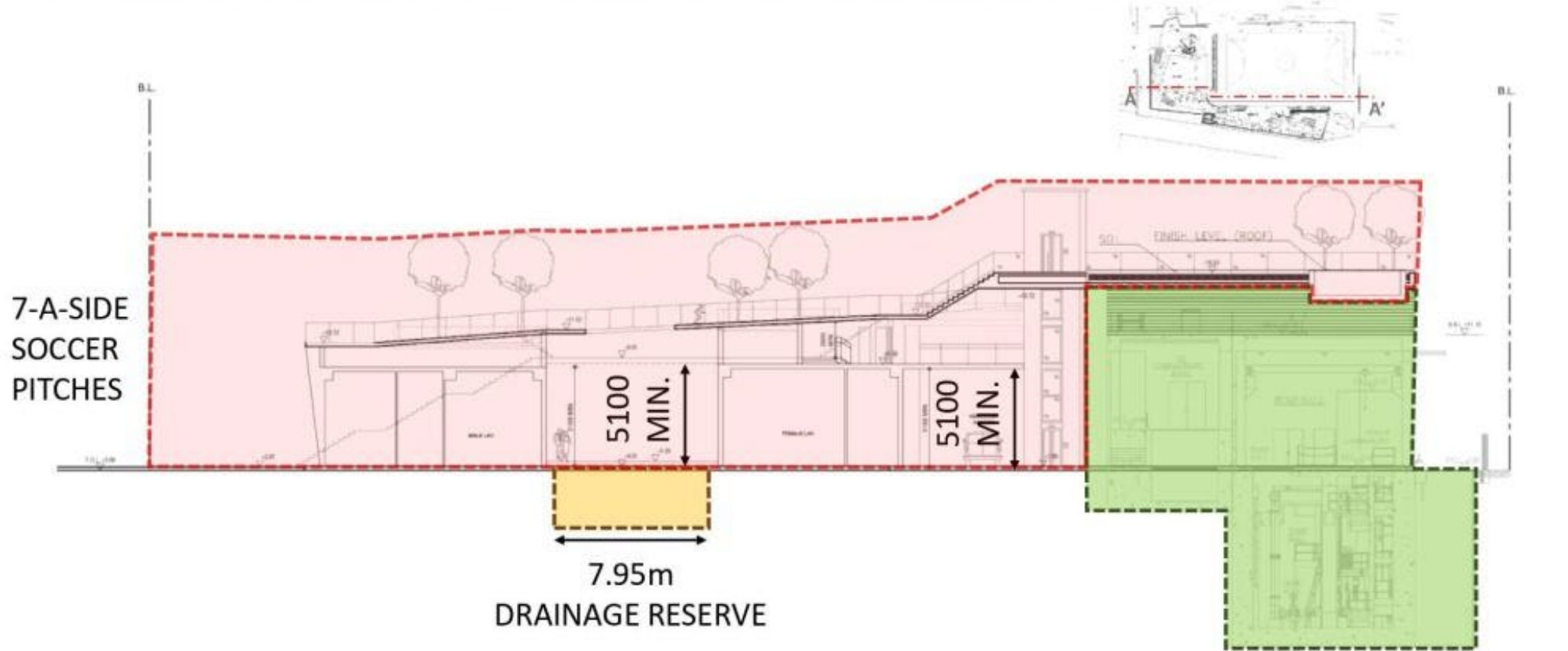

SECTION A-A'

LCSD

WSD

DSD

(DRAINAGE RESERVE)

# PUBLIC OPEN SPACE FACILITIES



**PROPOSED ROOF PLAN**



**PROPOSED GROUND FLOOR PLAN**

POS FACILITIES	SHELTER	BENCH & TABLE	TREES	GREEN AREA	DRINKING FOUNTAIN	FEMALE TOILET			MALE TOILET				AUT	UNI	BCR
						WC	BASIN	SHOWER ROOM	WC	URINAL	BASIN	SHOWER ROOM			
NO.	3	✓	19	✓	2	5	3	2	3	3	3	2	1	2	1
PROMENADE	4	✓	-	✓	-	-	-	-	-	-	-	-	-	-	-

# MAINTENANCE ACCESS

環境保護署港島西  
廢物轉運站  
EPD Island West  
Transfer Station

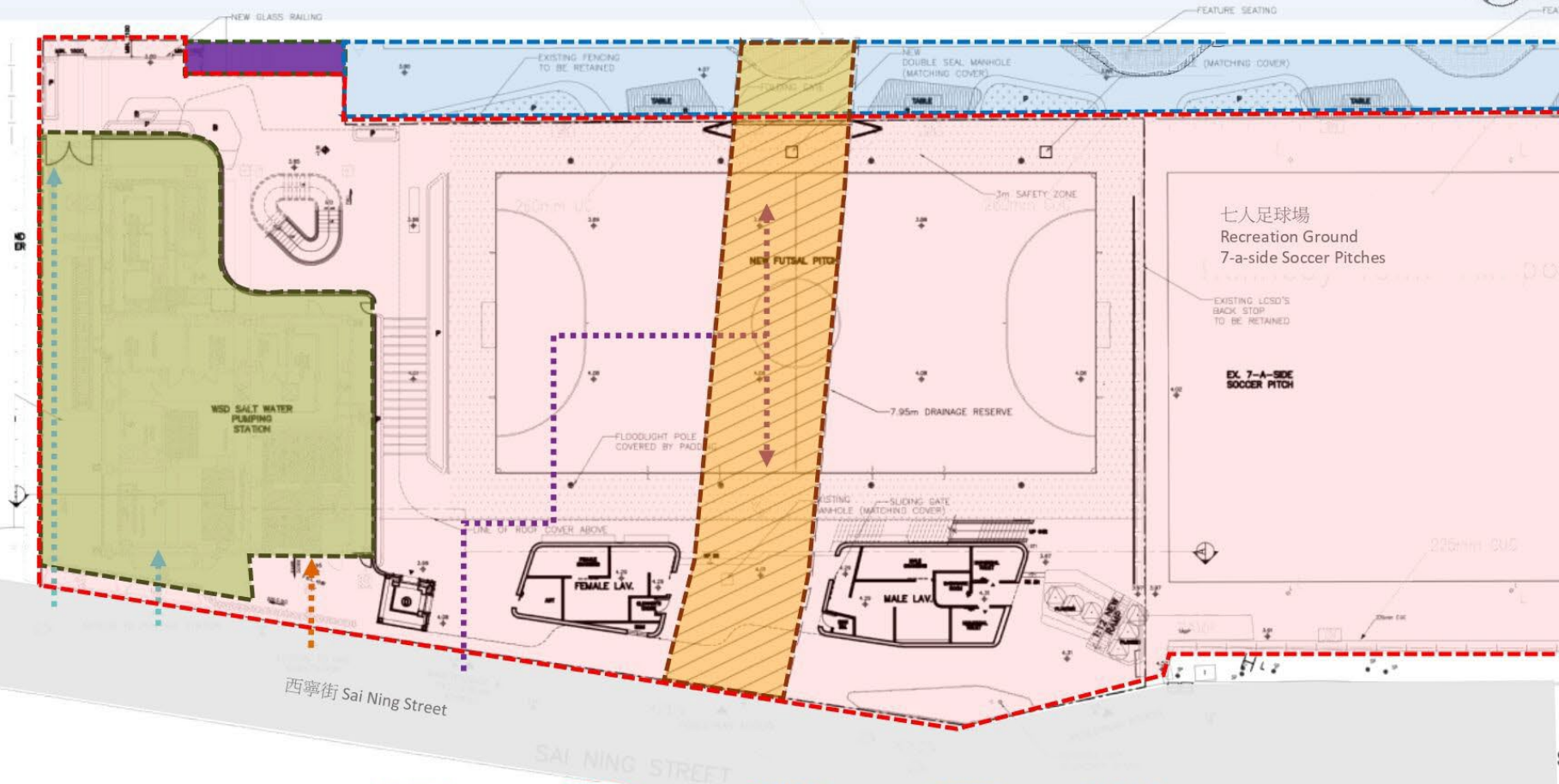



# EXISTING FENCING PLAN



— EXISTING FENCING

— BACKSTOP

# PROPOSED FENCING PLAN



- EPD FENCING
- FENCING
- WSD FACADE
- BACKSTOP

# GROUND FLOOR LEVEL BARRIER-FREE ACCESS

環境保護署港島西  
廢物轉運站  
EPD Island West  
Transfer Station

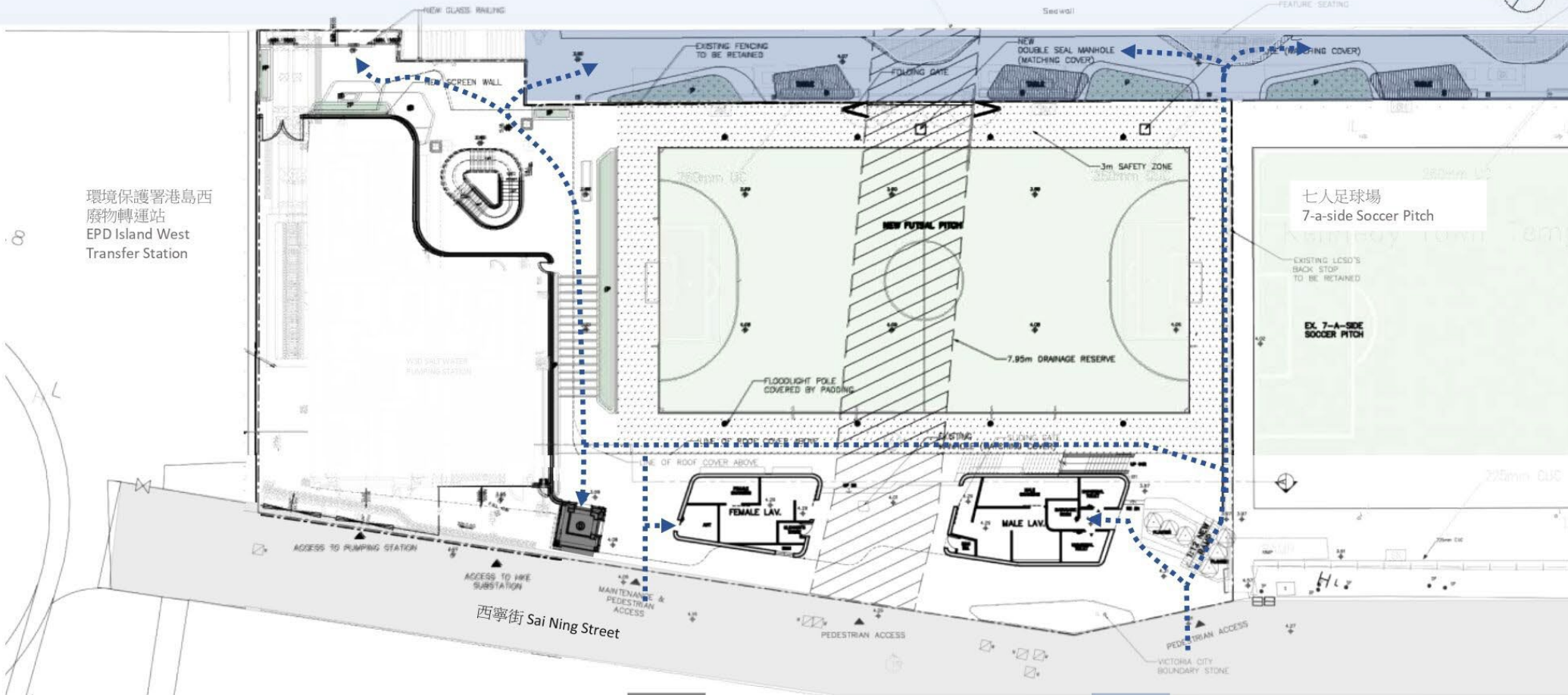

BARRIER FREE ACCESS



ACCESSIBLE LIFT

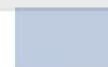

PROMENADE

# ROOF FLOOR BARRIER-FREE ACCESSIBILITY



環境保護署港島西  
廢物轉運站  
EPD Island West  
Transfer Station



七人足球場  
7-a-side Soccer Pitch

西寧街 Sai Ning Street



BARRIER-FREE ACCESS



POST CORNER LIFT

# DIAGRAMMATIC SECTION

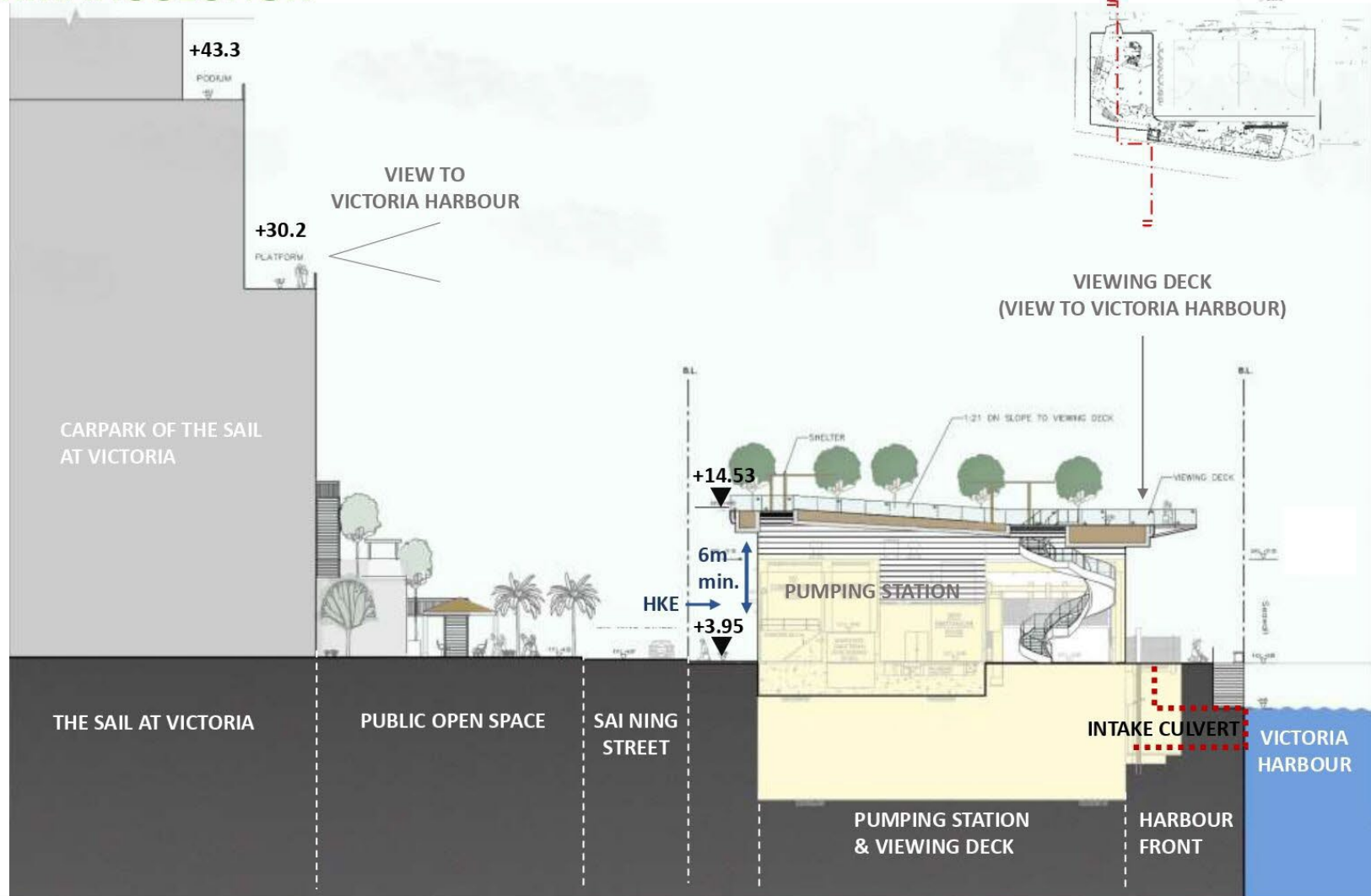

# BIRD EYE VIEW



# BIRD EYE VIEW



View from the sea



## VIEW FROM LANDSCAPE DECK





# LANDSCAPE DECK



# LANDSCAPE PROPOSAL

## PLANTING DESIGN THEME – COASTAL SCENERY – MOVEMENT OF WATER AND SAND



PLANTING DESIGN ABSTRACTS THE FORM OF THE WAVES AS THEY COME ASHORE AND THE COLOURS OF THE COASTAL LANDSCAPE. THE PLANTING DESIGN WILL ADOPT A BOLD WAVE-LIKE FORM OF CONTRASTING COLOUR, TEXTURE AND HABIT.

# TREE PLANTING (ROOF LEVEL)



## LEGEND

-  *Elaeocarpus hainanensis*  
水石榕
-  *Peltophorum tonkinense*  
銀珠
-  *Pongamia pinnata*  
水黃皮
-  *Syzygium hancei*  
韓氏蒲桃
-  Large Specimen Shrub

# TREE PLANTING (GROUND LEVEL)



## LEGEND

-  Transplanted Palm (approx. 2m in height)

# TREE PLANTING SPECIES



*Elaeocarpus hainanensis*  
水石榕



*Peltophorum tonkinense*  
銀珠



*Pongamia pinnata*  
水黃皮



*Syzygium hancei*  
韓氏蒲桃



# LARGE SPECIMEN SHRUBS



**Lagerstroemia speciosa**  
大花紫薇



**Murraya paniculata**  
九里香



**Osmanthus fragrans**  
桂花



# HARD LANDSCAPE MATERIAL PALETTE

**NATURAL GRANITE PAVING TILES- light grey (combination of four finishes)**  
**Main Landscape/ Pedestrian Footpaths / Planter kebs and walls**

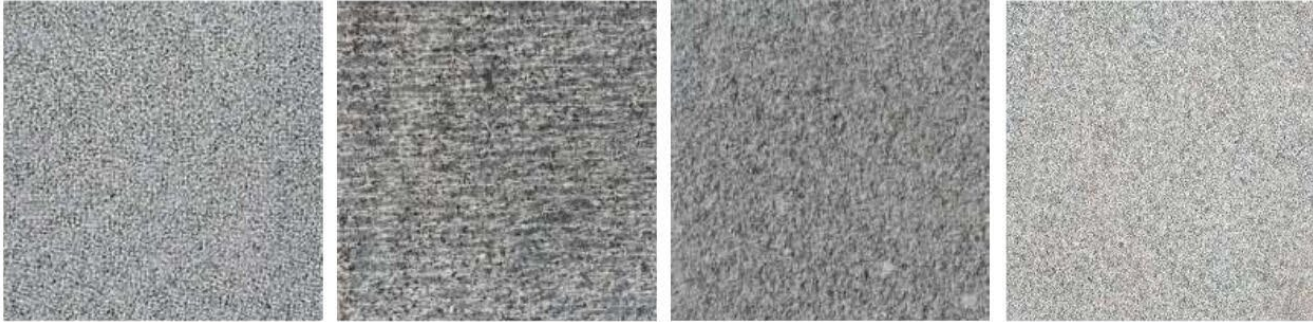

**RECYCLED PLASTIC COMPOSITE TIMBER Timber deck area / Terraced seating**



The paving will be an important element of the landscape design both in terms of its aesthetic appearance and in producing a hardwearing surface.

Non-slip paving materials will be utilised throughout the site and the proposed finishes and materials include subtle shades of natural granite for the paving main field area and the access footpaths. Recycled plastic composite wood will be used for the timber deck area and the terraced seating.

Wherever possible all landscape areas will cater for multiple use needs including people with impaired ability and access for the disabled in accordance with Building Department's Design Manual on 'Barrier Free Access (DMBFA), 2008 (2021 Edition)'.



## **PROPOSED ANCILLARY FACILITIES**

# ANCILLARY FACILITIES (ROOF FLOOR)

## LEGEND

-  PAVILION / SHELTER W/ BIPV PANEL
-  SEATING TERRACE / BENCH
-  PARK BENCH
-  TABLE
-  PARK FURNITURE
-  DRINKING FOUNTAIN
-  HAND WASHING FACILITY
-  DIGITAL INFO PANEL



# ANCILLARY FACILITIES (GROUND FLOOR)



- ### LEGEND
- PAVILION / SHELTER W/ BIPV PANEL
  - SEATING TERRACE / BENCH
  - PARK BENCH
  - TABLE
  - DRINKING FOUNTAIN
  - MOVABLE PLANTER
  - HAND WASHING FACILITY
  - SMART LAMP POLE
  - DIGITAL INFO PANEL
  - LAMP POLE WITH WIND TURBINE

SAI NING STREET

# ANCILLARY FACILITIES & SMART DESIGN FEATURES



DIGITAL INFORMATION PANEL



RUBBISH BIN



RECYCLING BIN



DRINKING FOUNTAIN AND  
WATER DISPENSING FACILITIES



HAND WASHING FACILITY

# PROPOSED LOW-CARBON & ENVIRONMENTAL FRIENDLY FEATURES



SMART LAMP POLE



BIPV PANEL ABOVE SHELTERS



LAMP POLE WITH WIND TURBINE

WATER SAVING DEVICES

# MURAL WALL



REFERENCE IMAGES

EXPLORING THE HISTORY AND LOCAL CULTURE OF KENNEDY TOWN THROUGH AN INNOVATIVE ARTWORK. THIS COULD TAKE THE FORM OF A MURAL ON THE WALL BEHIND THE STAIRCASE.

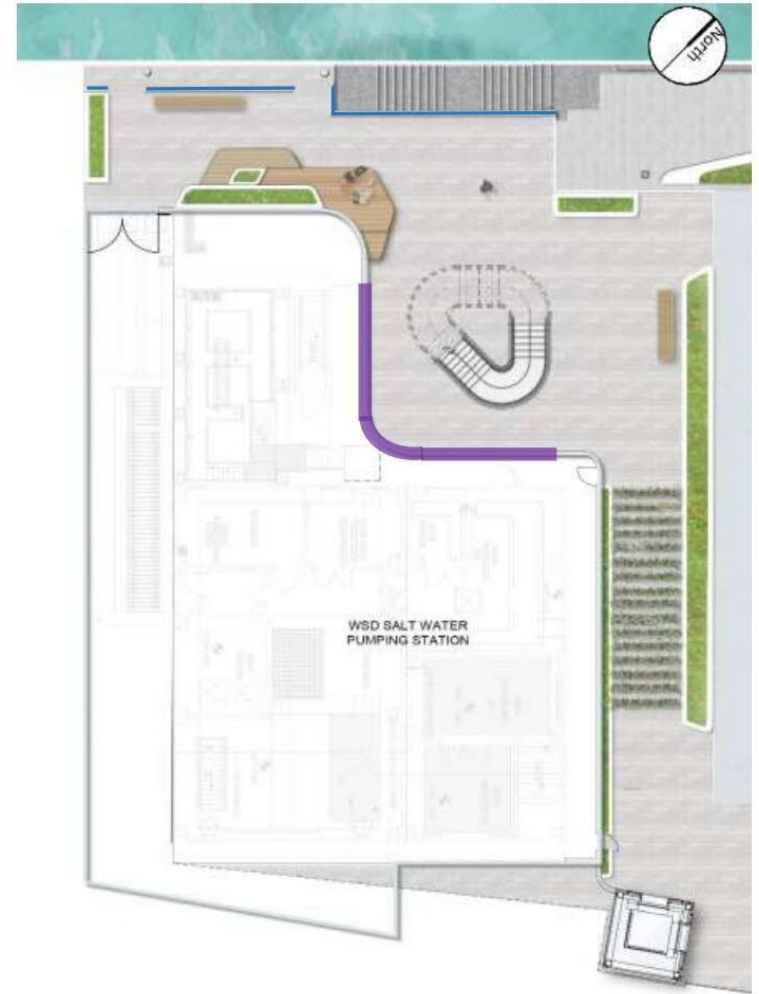

# GLASS RAILINGS WATERFRONT PROMENADE



REFERENCE IMAGES



EXISTING RAILING

## PROPOSED GLASS RAILINGS

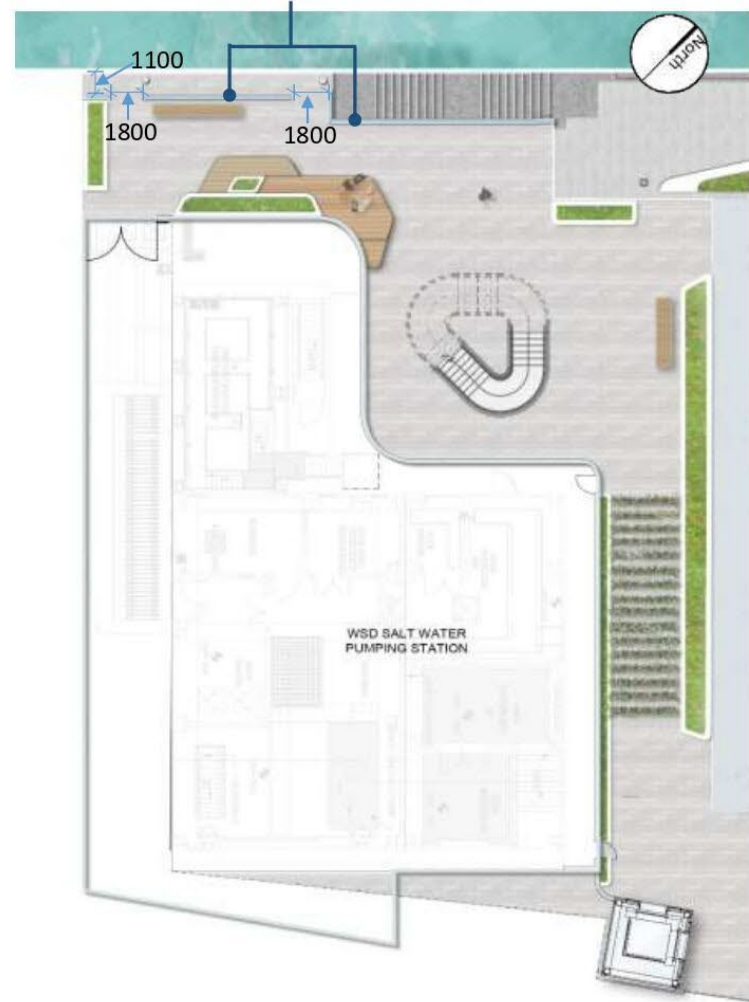

# TENTATIVE PROGRAMME

		COMMENCEMENT DATE	COMPLETION DATE
•	CONSTRUCTION OF THE NEW SALT WATER PUMPING STATION AND INTAKE CULVERT	Q3 2025	Q2 2029
•	DEMOLITION OF THE EXISTING KENNEDY TOWN SALT WATER PUMPING STATION	Q3 2029	Q4 2029
•	REINSTATEMENT WORKS FOR LCSD'S FACILITIES	Q3 2028	Q2 2030



# SUMMARY OF HARBOUR PLANNING PRINCIPLES

## 1. PRESERVING VICTORIA HARBOUR

- PRESERVATION OF HISTORICAL ARTEFACT AND OUR HARBOUR



## 2. STAKEHOLDER ENGAGEMENT

- COLLECTING THE VIEWS OF THE PUBLIC



## 3. SUSTAINABLE DEVELOPMENT

- GREEN AND SUSTAINABLE BUILDING DESIGNS



## 4. INTEGRATED PLANNING

- SMALL FOOTPRINT FOR MINIMAL IMPACT TO THE SITE



## 5. PROACTIVE HARBOUR ENHANCEMENT

- TO ENHANCE HONG KONG URBAN DESIGN TO THE INTERNATIONAL COMMUNITY



## 6. VIBRANT HARBOUR

- TO BALANCE THE USE OF THE HARBOUR TO PROVIDE BOTH A MARITIME AND LOGISTICS HUB



## 7. ACCESSIBLE HARBOUR

- UNRESTRICTED AND CONVENIENT VISUAL AND PHYSICAL ACCESS



## 8. PUBLIC ENJOYMENT

- BENCHES FOR RESTING AND TO ENJOY THE HARBOUR VIEW

- PRIVATE MANAGED OPEN SPACE AND PROMENADE TO PROMOTE COMFORT OF THE PEDESTRIANS AND VISITORS



**THANK YOU**